

**BEFORE THE STATE CORPORATION COMMISSION
OF THE STATE OF KANSAS**

IN THE MATTER OF THE APPLICATION OF)
EVERGY KANSAS CENTRAL, INC. FOR A)
CERTIFICATE OF PUBLIC CONVENIENCE)
AND AUTHORITY TO TRANSACT THE)
BUSINESS OF AN ELECTRIC PUBLIC UTILITY) Docket No. 22-EKCE-235-COC
DEFINED AS 115kV TRANSMISSION LINE)
PROJECT WR P26365 E EUREKA TO OTTER)
CREEK IN GREENWOOD COUNTY, KANSAS)

**AMENDED APPLICATION FOR A CERTIFICATE OF PUBLIC CONVENIENCE AND
AUTHORITY TO TRANSACT THE BUSINESS OF AN ELECTRIC PUBLIC UTILITY,
TRANSMISSION RIGHTS ONLY**

COMES NOW Evergy Kansas Central, Inc. d/b/a Evergy Kansas Central (“Evergy Kansas Central”), and in support of its Application for a Certificate of Public Convenience and Authority, for Transmission Rights only, states:

1. Evergy Kansas Central is a Kansas corporation authorized by the Commission to conduct the business of a public utility under the provisions of K.S.A. 66-104, and as such holds a Certificate of Convenience and Authority from this Commission to engage in the business of an electric public utility in the State of Kansas, thereby promoting public convenience.

2. Evergy Kansas Central seeks, subject to the Commission’s approval, transmission rights only in Butler Rural Electric Cooperative, Inc. (“Butler”) certified territory defined as the 115 kV Transmission Line Project, WR P26365 described below from the northernmost to southernmost extent:

GREENWOOD COUNTY, KANSAS

In the Butler County Coop territory in the far south edge of the SW ¼ of Section 35, Township 26S, Range 10E; thence continuing west for 0.45 miles of Section 35, Township 26S, Range 10E; thence SW and enters the NW ¼ of Section 2, Township 27S, Range 10E; thence south for 0.5 mile in Section 2, Township 27S, Range 10E in Greenwood County, Kansas. See Exhibit A.

3. Evergy Kansas Central is requesting transmission rights in the above territory for approximately 1 mile of new 115 kV transmission line. The entire project will be from the new Otter Creek substation into Eureka, making the system more reliable. The new line will be located within a new 125- foot right-of-way.

4. The purposed project will upgrade an old power system that was built in the 1970s and 1980s, that had little opportunity for maintenance due to being on a large radial feed that does not readily allow for maintenance outages. The East Eureka and Vaughn systems account for approximately 20MW of load and are fed out of West Emporia by more than 40 miles of 115kV line, for a total of about 800 MW-miles. There is no generation available in this area with minimal connections to other systems (34kV) for backup, making it a prime candidate to be considered for expansion to loop the facilities.

5. A study was done by Burns & McDonnell including feedback from landowners to determine the final route.

6. A copy of this application is being served on Butler by delivery of United States Mail, postage prepaid, addressed as follows:

Jeff Leckliter
Butler Rural Electric Cooperative, Inc.
216-218 South Vine Street
El Dorado, Kansas 67042

There is no other person or entity, corporate, municipal, or otherwise that requires notice of this Application.

THEREFORE, Evergy Kansas Central requests that an Order be issued, granting Evergy Kansas Central the authority for transmission rights only in the territory described in paragraph 2 above.

EVERGY KANSAS CENTRAL, INC.

BY: Cathryn Dinges
Cathryn J. Dinges, S.Ct. #20848
Sr Director and Regulatory Affairs Counsel
818 S. Kansas Avenue
P.O. Box 889
Topeka, Kansas 66601-0889
PHONE: (785) 575-8344
FAX: (785) 575-8136

ITS ATTORNEY

STATE OF KANSAS)
) ss
COUNTY OF SHAWNEE)

Cathryn J. Dinges, of lawful age, being first duly sworn upon oath, deposes and states:

That she is the attorney for the within named applicant, that she has read the above and foregoing Application and that the statements therein contained are true according to her knowledge and belief.

Cathryn Dinges
Cathryn J. Dinges

Subscribed and sworn to before me this 10th day of January 2022.

Leslie R. Wines
Notary Public

My Appointment Expires:

May 30, 2022

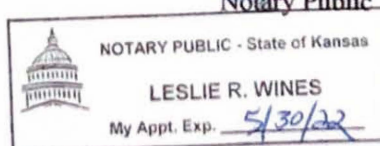

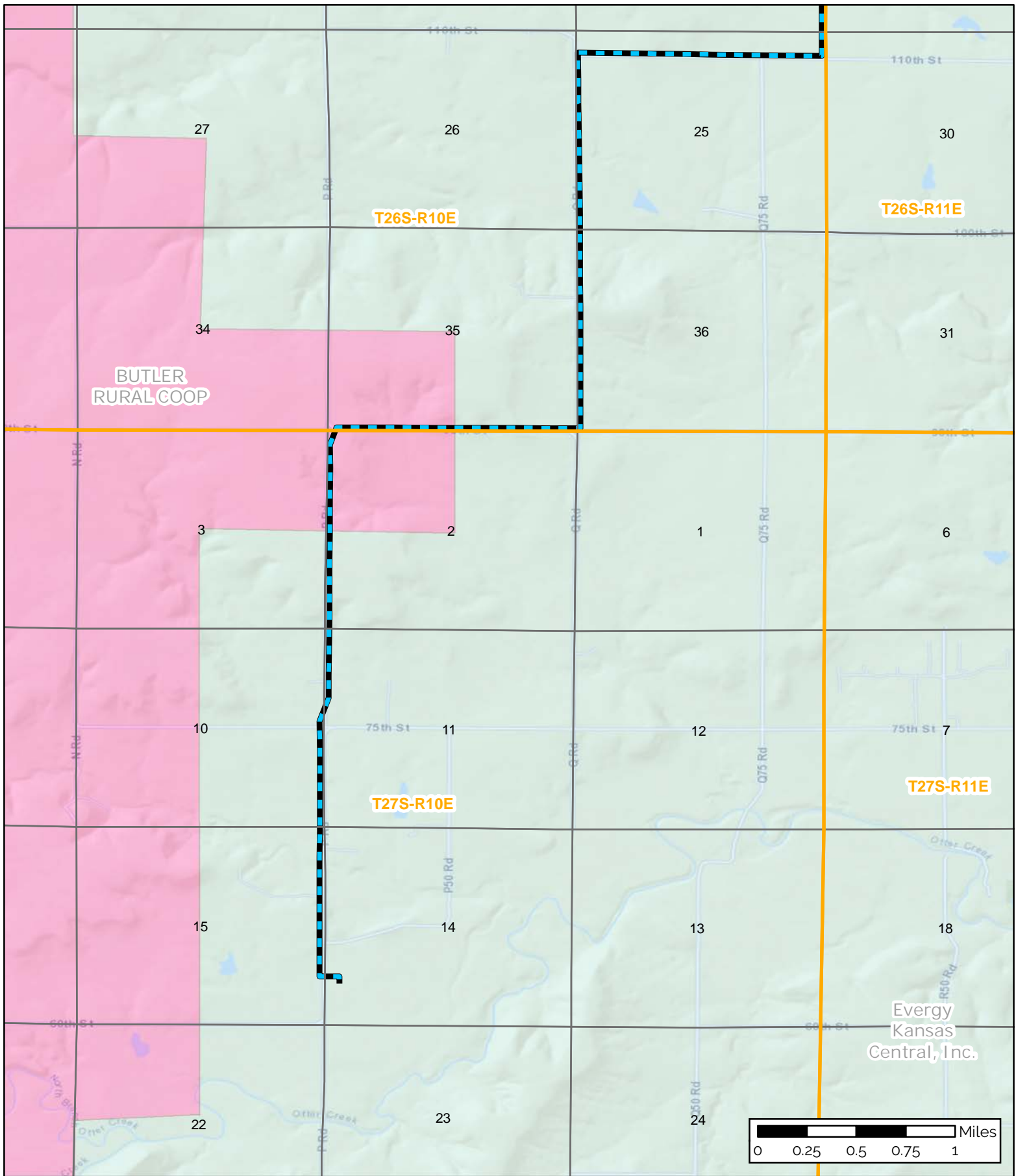

DESIGNED BY:	CP
DRAWN BY:	CP
CHECKED BY:	JK
APPROVED BY:	CC
DATE:	OCTOBER 2021

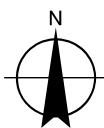

East Eureka to Otter Creek
Transmission Project
Greenwood County, Kansas



FIGURE
2 of 2

**East Eureka to
Otter Creek
RESA
EXHIBIT A**