

KANSAS CORPORATION COMMISSION  
OIL & GAS CONSERVATION DIVISION  
APPLICATION FOR INJECTION WELL

Disposal   
Enhanced Recovery:  Repressuring  
 Waterflood  
 Tertiary  
Date: \_\_\_\_\_  
Operator License Number: 35497 Exp 08/30/19  
Operator: Redbud Oil & Gas Operating, LLC  
Address: 16000 Stuebner Airline Road, Suite 320  
Spring, TX 77379  
Contact Person: Tom Kaetzer  
Phone: (832) 698-4901  
Email: tkaetzer@redbudinc.com

Permit Number: E-32,755 3-JE  
API Number: 15-125-32074-00-01  
**Well Location**  
SW - ~~NW~~ NW. NE Sec. 12 Twp. 31 S. R. 13  E  W  
371 feet from  N /  S Line of Section  
2550 feet from  E /  W Line of Section  
GPS Location: Lat: 37.3708439, Long: -95.9366777  
(e.g. xx.xxxxx) (e.g. -xxx.xxxxx)  
Datum:  NAD27  NAD83  WGS84  
Lease Description: See Attached  
Lease Name: Westfall Well Number: 2E-12  
Field Name: Cherokee Basin Coal  
County: Montgomery  
**Deepest Usable Water**  
Formation: \_\_\_\_\_  
Depth to Bottom of Formation: \_\_\_\_\_  
Received  
KANSAS CORPORATION COMMISSION  
OCT 29 2018  
CONSERVATION DIVISION  
WICHITA, KS

Check One:  Old Well Being Converted  Newly Drilled Well  Well to be Drilled  
Surface Elevation: 988 feet Well Total Depth: 1703 feet Plug Back Depth: 1450 feet  
Datum of top of injection formation: +/- +50 MSL feet (reference mean sea level)

**Injection Formation Description:**

Name	top / bottom	perf / open hole	depth
<u>Cattleman</u>	<u>1300 / 1314</u>	<u>perf</u>	<u>at 1303 to 1311 feet</u>

**List of Wells/Facilities Supplying Produced Saltwater or Other Fluids Approved by the Conservation Division:**  
(attach additional sheets if necessary)

Lease Operator	Lease/Facility Name	Lease/Facility Description	Well ID & Spot Location
<u>1. Redbud Oil &amp; Gas Operating</u>	<u>natural gas pipeline purchase</u>	<u>N/A</u>	<u>N/A</u>
<u>2. _____</u>	<u>_____</u>	<u>_____</u>	<u>_____</u>
<u>3. _____</u>	<u>_____</u>	<u>_____</u>	<u>_____</u>

Producing Formation	Strata Depth	Total Dissolved Solids (if available)
<u>1. Cattleman</u>	<u>1300 to 1314 feet</u>	<u>_____ mg/l</u>
<u>2. _____</u>	<u>_____ to _____ feet</u>	<u>_____ mg/l</u>
<u>3. _____</u>	<u>_____ to _____ feet</u>	<u>_____ mg/l</u>

Maximum Requested Liquid Injection Rate: \_\_\_\_\_ bbls / day; or  
Maximum Requested Gas Injection Rate: 250,000 scf / day. Type of Gas: Natural Gas  
Maximum Requested Injection Pressure: 1,000 psig

Paid \$200.00  
CK 1065  
10/30/18  
JK

**Well Completion**

Type:  Tubing & Packer     Packerless     Tubingless

	Conductor	Surface	Intermediate	Production	Tubing
Size		8-5/8"		4-1/2"	2-3/8"
Setting Depth		43'		1703'	1260'
Amount of Cement		4 sks		180 sks	
Top of Cement		Surface		Surface	
Bottom of Cement		43'		1703'	

If Alternate II cementing, complete the following:

Perforations / D.V. Tool at \_\_\_\_\_ feet, cemented to \_\_\_\_\_ feet with \_\_\_\_\_ sx.

Tubing: Type \_\_\_\_\_ Grade \_\_\_\_\_

Packer: Type \_\_\_\_\_ Depth \_\_\_\_\_

Annulus Corrosion Inhibitor: Type \_\_\_\_\_ Concentration \_\_\_\_\_

List Logs Enclosed: \_\_\_\_\_

Received  
KANSAS CORPORATION COMMISSION

OCT 29 2018

CONSERVATION DIVISION  
WICHITA, KS

**Well Sketch**

(To sketch installation, darken the appropriate lines, indicate cement, and show depths.)

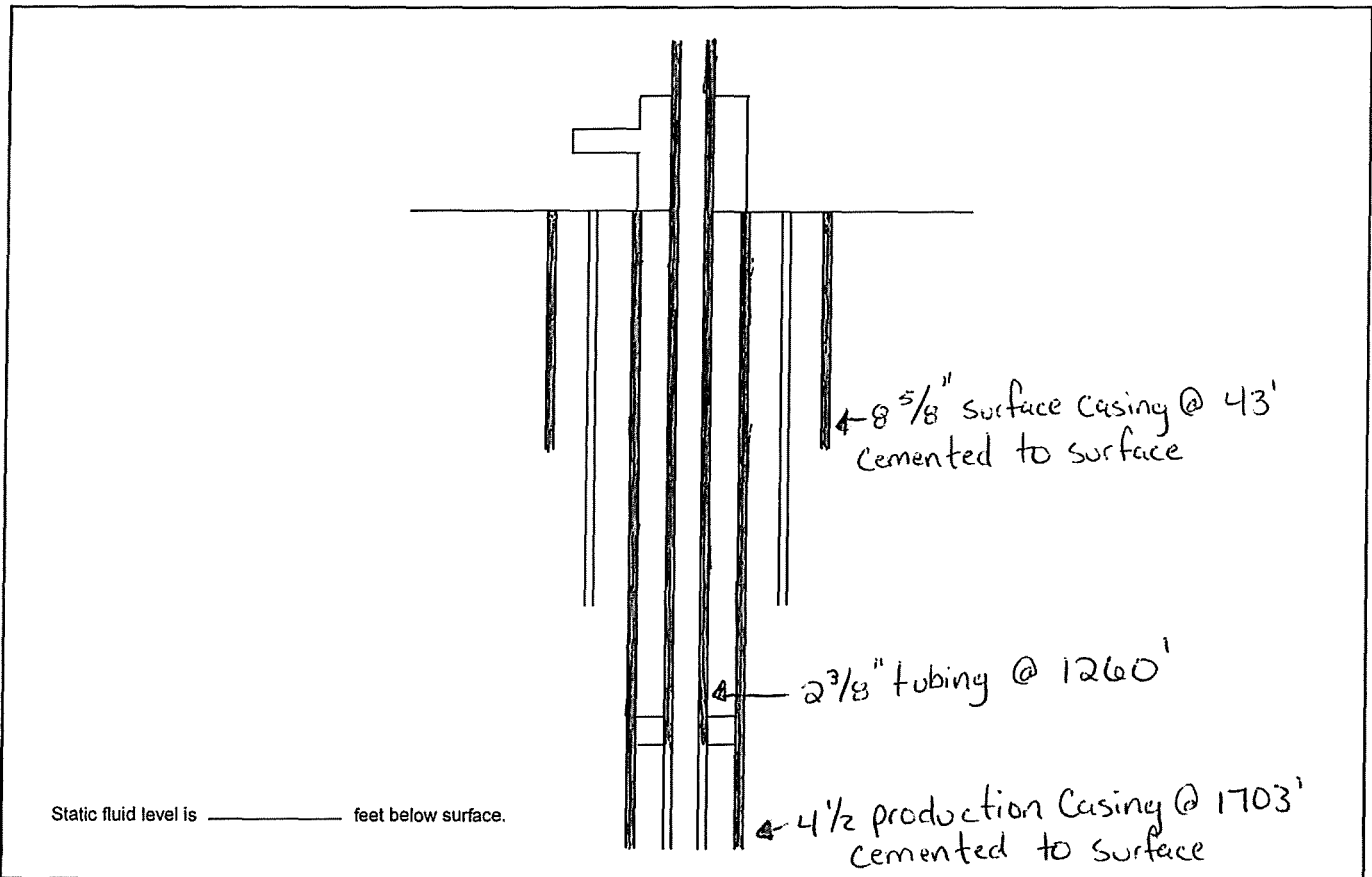

*Handwritten initials*

**Offset Operators, Unleased Mineral Owners and Landowners acreage**

(Attach additional sheets if necessary)

Name:

Legal Description of Leasehold:

Westfall Brothers LLC

Montgomery County, KS Township 31 South, Range 13E

Section 12 Except S/2NE/4 556 Acres

Section 1: S/2 & NW/4 490 Acres

Eagle Oak Land Development

Montgomery County, KS Township 31 South, Range 13E

Section 12: SW/4NE/4 & SW/4NE/4 79 Acres

Received  
KANSAS CORPORATION COMMISSION

OCT 29 2018

CONSERVATION DIVISION  
WICHITA, KS

I hereby certify that the statements made herein are true and correct to the best of my knowledge and belief.

*Tom Kart*  
Applicant or Duly Authorized Agent

Subscribed and sworn before me this 24th day of October, 2018

*Amy E. Ryan*  
Notary Public

My Commission Expires: June 16, 2022

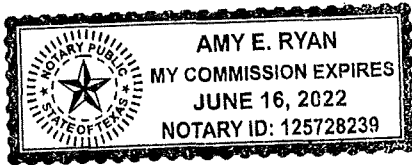

**Instructions:**

- Fully complete application, including page 4 (*plat map*) showing subject well and all known oil, gas and input wells, including wells being drilled, inactive wells, or dry holes, within one-half mile. Show lease names and operators or unleased mineral rights owners of all lands within one-half mile. Show well numbers and elevations of producing formation tops.
- Attach some type of log (*drillers log, electric log, etc.*).
- Attach some type of verification of cementing for surface casing, longstring, D.V. tool, perforations, etc. (*Cement ticket and job log, bond log, etc.*)
- Attach Affidavit of Notice.
- Fill in schematic drawing of subsurface facilities including: size, setting depth, amount of cement, measured or calculated tops of cement for each of surface, intermediate (*if any*) and production casing; size and setting depth of tubing and packer; geological zone of injection showing top and bottom of injection interval.
- The original and one copy of the application and all attachments shall be mailed to the State Corporation Commission, Conservation Division.
- Deliver or mail one (*1*) copy of the application to the landowner on whose land the injection well is located and to each operator or lessee of record and each unleased mineral rights owner within one-half mile of the applicant well.
- Approval of this application, if granted, is valid only as long as there are no substantial changes in operation set forth in the application. A substantial change requires the approval of a new application. **No injection well may be used without prior written authorization.**
- All application fees must accompany the application.

**Plat and Certificate of Injection Well Location and Surrounding Acreages**

Operator: 35497 Location of Well: SW NW NW NE  
 Lease: Westfall 371 feet from  N /  S Line of Section  
 Well Number: 2E-12 2550 feet from  E /  W Line of Section  
 County: Montgomery Sec. 12 Twp. 31 S. R. 13  East  West

**Plat**

Show the following information: applicant injection well, all producing wells, inactive wells, plugged wells, and other wells within a one-half mile radius, all lease boundaries, lease operators, unleased mineral rights owners, well numbers, and producing wells producing formation tops.

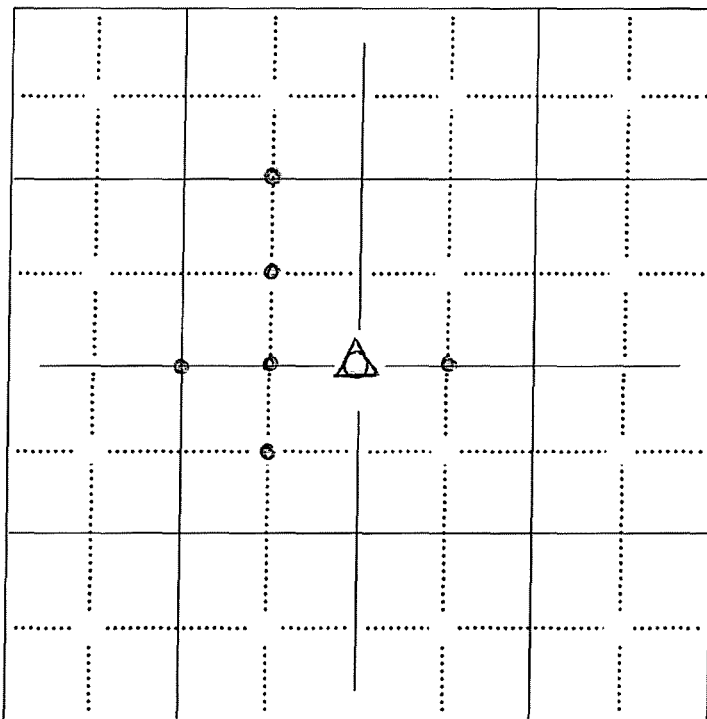

Received  
 KANSAS CORPORATION COMMISSION  
**OCT 29 2018**  
 CONSERVATION DIVISION  
 WICHITA, KS

- applicant well
- producing well
- plugged injection well
- D & A well
- other injection well
- temporary abandoned well
- plugged producer
- water supply well

The undersigned hereby certifies that he / she is a duly authorized agent for Redbud Oil & Gas Operating and that all of the information shown herein is true, complete and correct to the best of his / her knowledge.

[Signature]  
Applicant or Duly Authorized Agent

Subscribed and sworn before me this 24th day of October 2018

[Signature]  
Notary Public

My Commission Expires: June 16, 2022

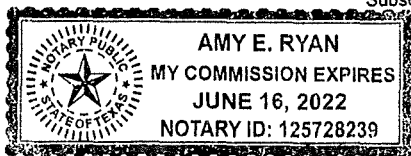

Received  
KANSAS CORPORATION COMMISSION

OCT 29 2018

CONSERVATION DIVISION  
WICHITA, KS

MERRICK #1-K

*INJ. Well*

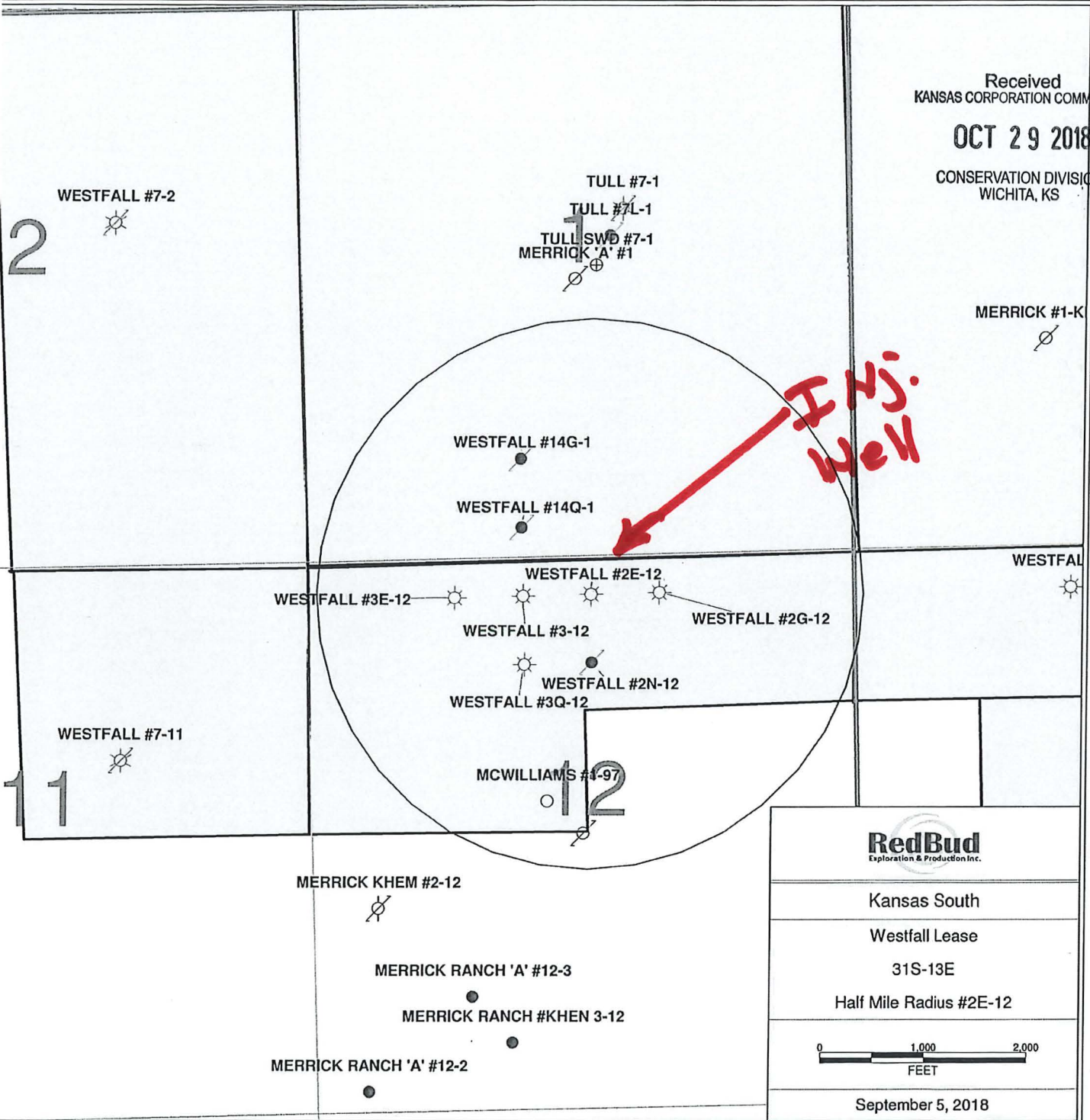

**RedBud**  
Exploration & Production Inc.

Kansas South

Westfall Lease

31S-13E

Half Mile Radius #2E-12



September 5, 2018

**Affidavit of Notice Served**

Re: Application for: Injection Well  
Well Name: Westfall 2E-12 Legal Location: 371' FNL, 2550 FEL, Sec.12-31S-13E

The undersigned hereby certifies that he / she is a duly authorized agent for the applicant, and that on the day 24th of October, 2018, a true and correct copy of the application referenced above was delivered or mailed to the following parties:

Note: A copy of this affidavit must be served as a part of the application.

Name	Address (Attach additional sheets if necessary)
Westfall Brothers, LLC	P.O. Box 418050, Kansas City, KS 64141
Eagle Oak Land Development	1715 CR 6200, Elk City, KS 67344

Received  
KANSAS CORPORATION COMMISSION  
**OCT 29 2018**  
CONSERVATION DIVISION  
WICHITA, KS

I further attest that notice of the filing of this application was published in the The Coffeyville Journal, the official county publication of Montgomery county. A copy of the affidavit of this publication is attached.

Signed this 24th day of October, 2018

[Signature]  
Applicant or Duly Authorized Agent

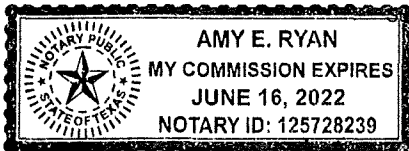

Subscribed and sworn to before me this 24th day of October

Amy E. Ryan  
Notary Public

My Commission Expires: June 16, 2022

Protests may be filed by any party having a valid interest in the application. Petitions for protests shall be in writing and shall clearly identify the name and address of the protestant and the title of the application. The petition shall include a clear and concise statement of the direct and substantial interest of the protestant in the proceedings, including the manner in which the protestant may be affected, and the nature, extent, character and grounds of the protest. Protestants shall serve the protest upon the applicant by mail or personal service at the same time or before the protestant files the protest with the Conservation Division. Protests must be filed within 30 days of the publication notice of the application.

# Affidavit of Publication

STATE OF KANSAS

Montgomery County, ss:

**Alana Justice**, being first duly sworn, deposes and says: That she is the **Advertising Director** of the  
***The Coffeyville Journal***

a twice weekly newspaper printed in the state of Kansas, and published in and of general circulation in Montgomery County, Kansas, with a general paid circulation on a twice weekly basis in Montgomery County, Kansas, and that said newspaper is not a trade, religious or fraternal publication.

Said newspaper is published at least 50 times a year, has been published continuously and uninterruptedly in said county and state for a period of more than five years prior to the first publication of said notice; and has been admitted at the post office of Coffeyville in said County as second class matter.

That the attached notice is a true copy thereof and was published in the regular and entire issue of said newspaper 1 time on , **September 26, 2018**.

*Alana Justice*

Subscribed to and sworn before me on this **1st** day of **October, 2018**.  
Printer's fee: **\$29.32**

*Jennifer L. Dufoe*

Notary Public

My commission expires: **March 23, 2022**

Received  
KANSAS CORPORATION COMMISSION

OCT 29 2018

CONSERVATION DIVISION  
WICHITA, KS



(First Published in the Coffeyville Journal September 26, 2018)

BEFORE THE STATE CORPORATION COMMISSION OF THE STATE OF KANSAS

NOTICE OF FILING OF APPLICATION

RE: Redbud Oil & Gas Operating, LLC—Application for order to permit injection of Natural gas into the Westfall 2E-12 oil well, located in Montgomery County, Kansas.

TO: All Oil and Gas Producers, Unleased Mineral Owners, Landowners, and all persons whosever concerned:

You, and each of you, are hereby notified that Redbud Oil & Gas Operating, LLC, has filed an application to commence injection of natural gas into the Cattleman formation at the Westfall 2E-12 oil well, located 371 feet from the North line and 2,550 feet from the East line of Section 12, Township 31 S, Range 13 E, Montgomery County, Kansas. The maximum requested injection rate is 250,000 SCF per day and the maximum requested injection pressure is 1000 psig.

Any persons who object or protest this application shall be required to file their objections or protest with the Conservation Division of the State Corporation Commission of the State of Kansas within Thirty (30) days from the date of the publication. These protests shall be filed pursuant to Commission regulations and must state specific reasons why the grant of the application may cause waste, violate correlative rights, or pollute the natural resources of the State of Kansas. If no protests are received, this application may be granted through a summary proceeding. If valid protests are received, this matter will be set for hearing.

All persons interested or concerned shall take notice of the foregoing and shall govern themselves accordingly.

Redbud Oil & Gas Operating, LLC  
16000 Stuebner Airline Road, Suite 320  
Spring, TX 77379  
SEPTEMBER 26, 2018