

BEFORE THE STATE CORPORATION COMMISSION OF THE STATE OF KANSAS

IN THE MATTER OF THE APPLICATION	}	DOCKET NO.
OF IGWT, INC., FOR THE ASSIGNMENT	}	
OF AND A LOCATION EXEMPTION FOR	}	18-CONS-3383-CWLE
THE VARNER FARMS 1 LOCATED 990'	}	
FNL AND 1500' FWL OF SECTION 33, TOWNSHIP	}	
25 SOUTH, RANGE 4 EAST BUTLER COUNTY	}	LICENSE NO. 3167
KANSAS.		

APPLICATION

COMES NOW IGWT, Inc., P.O. Box 550, Rose Hill, KS 67133, Applicant herein and respectfully states to the Commission as follows:

1. The Applicant Is the owner of oil and gas leasehold interests and operates wells located in Butler County, Kansas.
2. The Applicant proposes to drill the Varner Farms 1 at a location of 990 feet from the North line and 1500 feet from the West line of Section 33, Township 25 South, Range 4 East, Butler County, Kansas.
3. That Varner Farms 1 well will not be drilled at a regular location as proscribed by K.A.R. 82-3-108 in that it will be closer than 330 feet from a lease boundary line.
4. That the Applicant seeks to drill the Varner Farms 1 well at the requested location in order to avoid drilling within a draw running North and South through the Section which would require deviating the current flow path of surface water.

5. Applicant seeks to assign a full 10 acres to the Varner Farms 1 well and to receive a full allowable therefor.
6. The Varner Farms 1 has a market for the subject well and the production and sale from the Varner Farms 1 well will be in accordance with the rules and regulations of the Commission and for purposes permitted by the laws of the State of Kansas so as not to constitute waste.
7. Attached as Exhibit "1" is a listing of the names of Applicant's lessor(s) in the lease operated by Applicant that is situated less than the minimum distance from the proposed well location.
8. That the Applicant has sent by regular mail a copy of this Application and Notice of Pending Application to all persons listed on the attached Exhibit "1".
9. That attached hereto and made a part of this Application marked Exhibit "2" is a plat showing the property on which the Varner Farms 1 well is sought to be drilled and completed, partially drilled or permitted wells on the property and all adjacent property and wells.
10. That Applicant is causing the Notice of this Pending Application to be published as required by the Commission, in The Wichita Eagle and the Butler County Times Gazette newspapers. Said Notice provides that unless a written protest is received by the Commission within 15 days after the date of publication of said Notice, the Application in this matter will be granted administrative approval after the 15-day period.

WHEREFORE, Applicant prays that this cause be docketed and, in the event, that no protest is made to the Commission within the time period provided, an Order be entered granting the location exception and assignment of a full allowable at the

appropriate time to the Varner Farms 1 well and that Applicant be permitted to drill the well and complete in the Mississippi formation.

Respectfully submitted,

Kenton L. Hupp

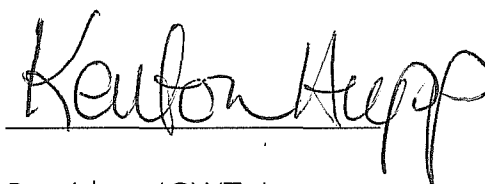
A handwritten signature in black ink that reads "Kenton Hupp". The signature is written in a cursive style and is positioned above a horizontal line.

President IGWT, Inc.

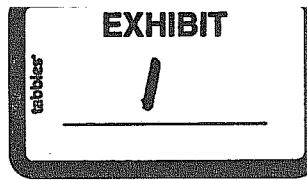

NAME	ADDRESS	CITY	ZIP	LEASEHOLD DESCRIPTION
1 Michael & Martha Treweeke	8114 NW Parallel St	Towanda, KS	67144-9132	SE/4 SEC 33-25S-4E
6 Max & Sherri Griffin	427 NW River Valley Rd	Towanda, KS	67144	NE/C SE/4 A TR SEC 32-25S-4E (21 ACRES)
8 Calvin & Carla Varner	9080 NW 10th	Towanda, KS	67144	E/2 SE/4 SEC 29-25S-4E
10 Paul & Sabrina Tillotson	8600 NW 10th St	Towanda, KS	67144	SE/C SW/4 A TR SEC 28-25S-4E (4.7 ACRES)
11 Marvin & Kara Nice	8524 NW 10th	Towanda, KS	67144	SW/4 A TR SEC 28-25S-4E (4.60 ACRES)
13 Ray & Mary Varner	8405 NW 10th	Towanda, KS	67144	NW/C NE/4 SEC 33-25S-4E (4.7 ACRES)
14 Varner Farms, Inc.	9769 SW Parallel St	Towanda, KS	67144	N/2 NE LESS A TR; NE NW SEC 33-25S-4E
15 Joseph & Valerie Hepburn	P.O. Box 451	Towanda, KS	67144-0451	NW/C NE/4 SEC 33-25S-4E(64.10 ACRES)
20 Robert Brown etal	203 Lark Hill Lane	Ballwin, Mo	63021-5047	S/2 NW/4 SEC 33-25S-4E
O1 Benjamin Giles	346 S. Lulu	Wichita, KS	67211	NW/4 NW/4 SEC 33-25S-4E

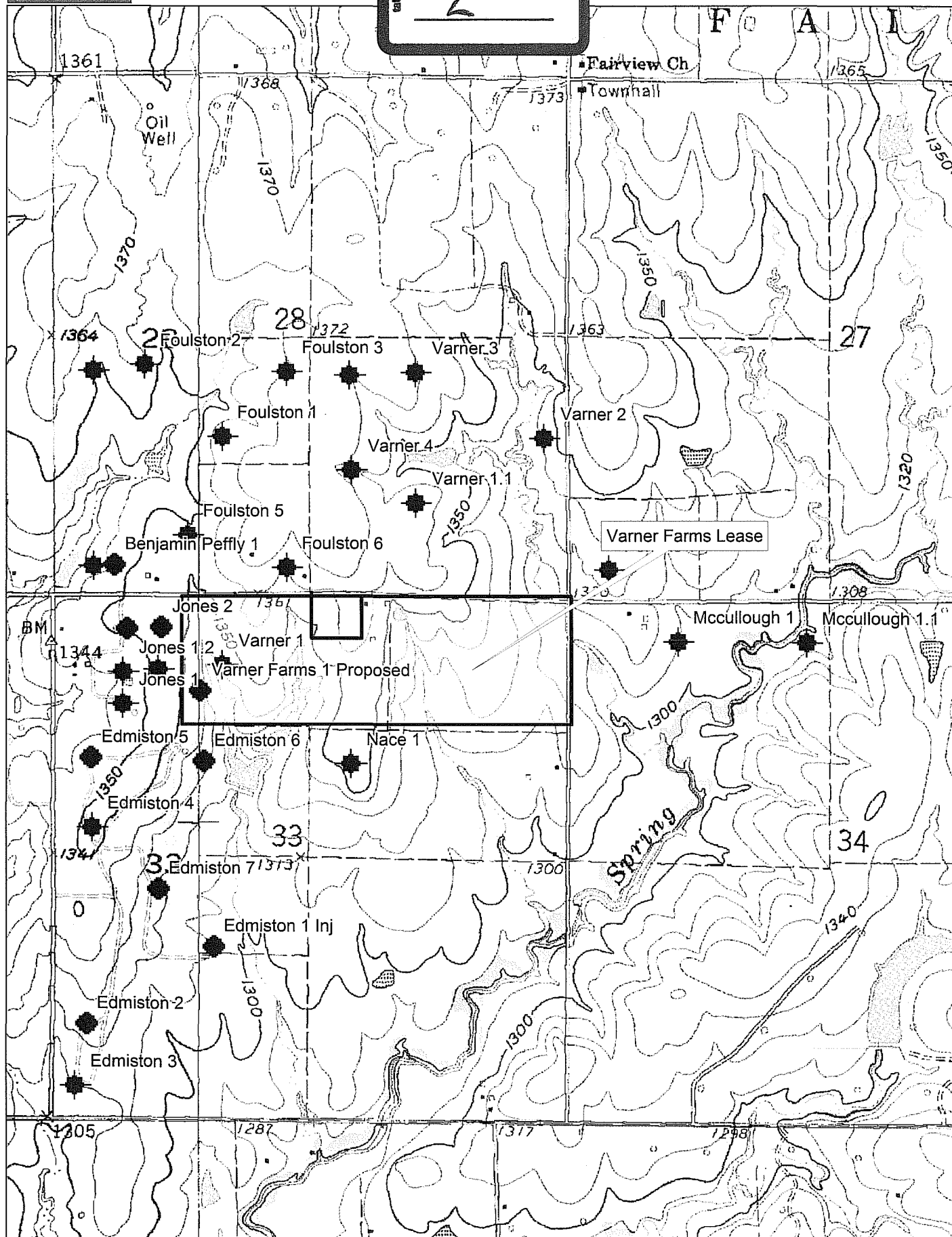

Data use subject to license.

© DeLorme. XMap® 7.

www.delorme.com



Scale 1 : 16,000

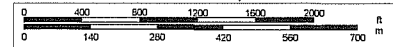

1" = 1,333.3 ft

Data Zoom 12-7

BEFORE THE STATE CORPORATION COMMISSION OF
THE STATE OF KANSAS

NOTICE OF FILING APPLICATION

RE: IN THE MATTER OF THE APPLICATION OF IGWT, INC. }
FOR A WELL LOCATION EXCEPTION FOR THE VARNER }
FARMS 1 WELL IN THE NW/4 OF SECTION 33, TOWNSHIP}
25 SOUTH, RANGE 4 EAST, BUTLER COUNTY, KANSAS }

TO: ALL OIL & GAS PRODUCERS, UNLEASED MINERAL OWNERS, LANDOWNERS, AND ALL PERSONS
WHOMEVER CONCERNED

You and each of you, are hereby notified that IGWT, Inc. has filed an application for a well location exemption for the Varner Farms 1 well to be located 990 feet from the North line and 1500 feet from the West line of Section Thirty-three (33), Township Twenty-five (25) South, Range Four (4) East, Butler County, Kansas.

Any person who objects to or protests this application shall be required to file their objections or protest with the Corporation commission of the State of Kansas within fifteen (15) days from the date of this publication. These protests shall be filed pursuant to Commission regulations and must state specific reason why granting the application may cause waste, violate correlative rights or pollute the natural resources of the State of Kansas.

All persons interested or concerned shall take notice of the foregoing and shall govern themselves accordingly.

IGWT, Inc.
P.O. Box 550
Rose Hill, KS 67133

For KCC Use:
Effective Date: _____
District # 2
SGA? ☐ Yes ☒ No

KANSAS CORPORATION COMMISSION
OIL & GAS CONSERVATION DIVISION

Form C-1
March 2010

Form must be Typed
Form must be Signed
All blanks must be Filled

NOTICE OF INTENT TO DRILL

Must be approved by KCC five (5) days prior to commencing well
Form KSONA-1, Certification of Compliance with the Kansas Surface Owner Notification Act, MUST be submitted with this form.

Expected Spud Date: 06/01/2018
month day year

OPERATOR: License# 3167
Name: IGWT, Inc.
Address 1: P.O. BOX 550
Address 2: _____
City: ROSE HILL State: KS Zip: 67133
Contact Person: Kenton Hupp
Phone: 316-265-5800

CONTRACTOR: License# 32701
Name: C & G Drilling, Inc.

Well Drilled For: ☒ Oil ☐ Gas ☐ Enh Rec ☐ Storage ☐ Disposal ☐ Seismic; # of Holes _____ ☐ Other: _____
Well Class: ☒ Infield ☐ Pool Ext. ☐ Wildcat ☐ Other _____
Type Equipment: ☒ Mud Rotary ☐ Air Rotary ☐ Cable

☐ If OWWO: old well information as follows: _____

Operator: _____
Well Name: _____
Original Completion Date: _____ Original Total Depth: _____

Directional, Deviated or Horizontal wellbore? ☐ Yes ☒ No
If Yes, true vertical depth: _____
Bottom Hole Location: _____
KCC DKT #: _____

Applying for WLE

Spot Description: _____
W2 - SW - NE - NW Sec. 33 Twp. 25 S. R. 4 ☒ E ☐ W
(0/0/0/0) 990 feet from ☒ N / ☐ S Line of Section
1500 feet from ☐ E / ☒ W Line of Section
Is SECTION: ☒ Regular ☐ Irregular?

(Note: Locate well on the Section Plat on reverse side)

County: Butler
Lease Name: WARNER FARMS Well #: 1
Field Name: PIERCE

Is this a Prorated / Spaced Field? ☐ Yes ☒ No
Target Formation(s): MISSISSIPPI

Nearest Lease or unit boundary line (in footage): 180
Ground Surface Elevation: 1340 Estimated feet MSL

Water well within one-quarter mile: ☐ Yes ☒ No
Public water supply well within one mile: ☐ Yes ☒ No

Depth to bottom of fresh water: 150
Depth to bottom of usable water: 180

Surface Pipe by Alternate: ☒ I ☐ II
Length of Surface Pipe Planned to be set: 200

Length of Conductor Pipe (if any): _____
Projected Total Depth: 2700

Formation at Total Depth: MISSISSIPPI

Water Source for Drilling Operations:
☐ Well ☐ Farm Pond ☒ Other: TRUCKED

DWR Permit #: _____

(Note: Apply for Permit with DWR ☐)

Will Cores be taken? ☐ Yes ☒ No
If Yes, proposed zone: _____

AFFIDAVIT

The undersigned hereby affirms that the drilling, completion and eventual plugging of this well will comply with K.S.A. 55 et. seq.

It is agreed that the following minimum requirements will be met:

1. Notify the appropriate district office **prior** to spudding of well;
2. A copy of the approved notice of intent to drill **shall be** posted on each drilling rig;
3. The minimum amount of surface pipe as specified below **shall be set** by circulating cement to the top; in all cases surface pipe **shall be set** through all unconsolidated materials plus a minimum of 20 feet into the underlying formation.
4. If the well is dry hole, an agreement between the operator and the district office on plug length and placement is necessary **prior to plugging**;
5. The appropriate district office will be notified before well is either plugged or production casing is cemented in;
6. If an ALTERNATE II COMPLETION, production pipe shall be cemented from below any usable water to surface within **120 DAYS** of spud date. Or pursuant to Appendix "B" Eastern Kansas surface casing order #133,891-C, which applies to the KCC District 3 area, alternate II cementing must be completed within 30 days of the spud date or the well shall be plugged. **In all cases, NOTIFY district office** prior to any cementing.

I hereby certify that the statements made herein are true and to the best of my knowledge and belief.

Date: _____ Signature of Operator or Agent: _____ Title: _____

For KCC Use ONLY

API # 15 - _____

Conductor pipe required 0 feet

Minimum surface pipe required 200 feet per ALT. ☒ I ☐ II

Approved by: _____

This authorization expires: _____
(This authorization void if drilling not started within 12 months of approval date.)

Spud date: _____ Agent: _____

Remember to:

- File Certification of Compliance with the Kansas Surface Owner Notification Act (KSONA-1) with Intent to Drill;
- File Drill Pit Application (form CDP-1) with Intent to Drill;
- File Completion Form ACO-1 within 120 days of spud date;
- File acreage attribution plat according to field proration orders;
- Notify appropriate district office 48 hours prior to workover or re-entry;
- Submit plugging report (CP-4) after plugging is completed (within 60 days);
- Obtain written approval before disposing or injecting salt water.
- If well will not be drilled or permit has expired (See: authorized expiration date) please check the box below and return to the address below.

☐ Well will not be drilled or Permit Expired Date: _____
Signature of Operator or Agent: _____

33 25 4 ☒ E ☐ W

For KCC Use ONLY

API # 15 - _____

IN ALL CASES PLOT THE INTENDED WELL ON THE PLAT BELOW

In all cases, please fully complete this side of the form. Include items 1 through 5 at the bottom of this page.

Operator: IGWT, Inc.

Lease: VARNER FARMS

Well Number: 1

Field: PIERCE

Number of Acres attributable to well: _____

QTR/QTR/QTR/QTR of acreage: W2 - SW - NE - NW

Location of Well: County: Butler

990 feet from ☒ N / ☐ S Line of Section1500 feet from ☐ E / ☒ W Line of SectionSec. 33 Twp. 25 S. R. 4 ☒ E ☐ WIs Section: ☒ Regular or ☐ Irregular

If Section is Irregular, locate well from nearest corner boundary.

Section corner used: ☐ NE ☐ NW ☐ SE ☐ SW**PLAT**

Show location of the well. Show footage to the nearest lease or unit boundary line. Show the predicted locations of lease roads, tank batteries, pipelines and electrical lines, as required by the Kansas Surface Owner Notice Act (House Bill 2032).

You may attach a separate plat if desired.

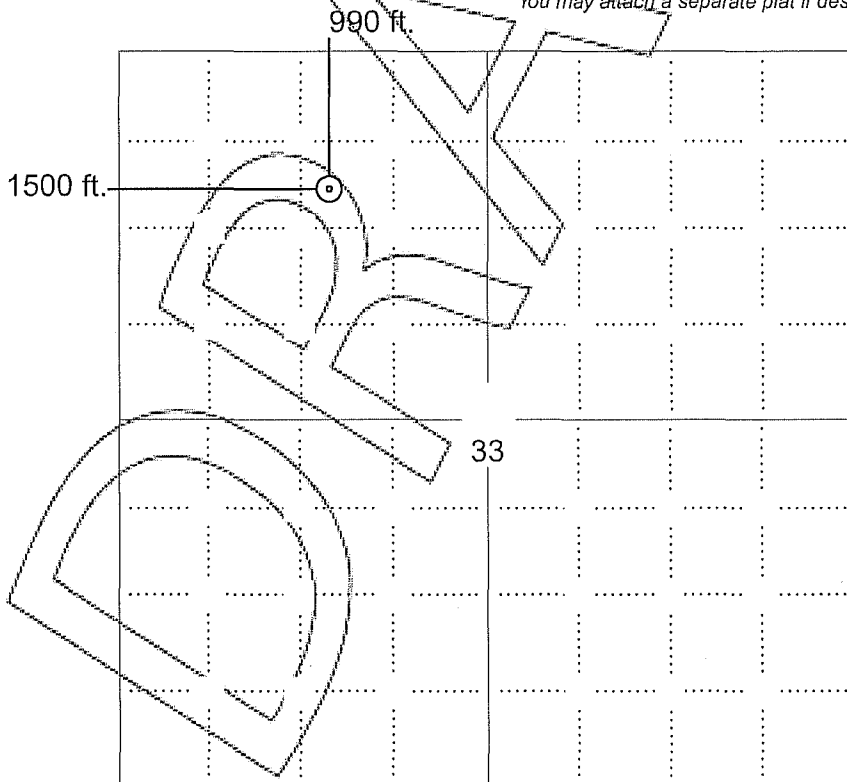
**LEGEND**

- ☐ Well Location
- ☐ Tank Battery Location
- ☐ Pipeline Location
- ☐ Electric Line Location
- ☐ Lease Road Location

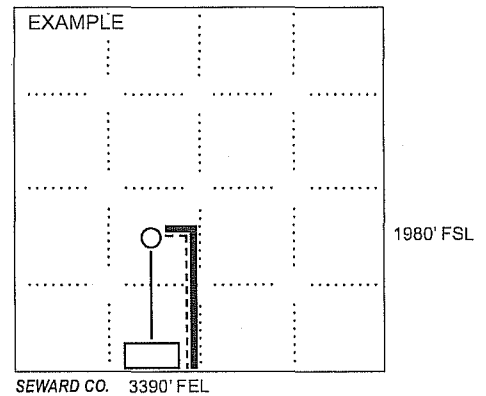
EXAMPLE**NOTE: In all cases locate the spot of the proposed drilling location.****In plotting the proposed location of the well, you must show:**

- The manner in which you are using the depicted plat by identifying section lines, i.e. 1 section, 1 section with 8 surrounding sections, 4 sections, etc.
- The distance of the proposed drilling location from the south / north and east / west outside section lines.
- The distance to the nearest lease or unit boundary line (in footage).
- If proposed location is located within a prorated or spaced field a certificate of acreage attribution plat must be attached: (CO-7 for oil wells; CG-8 for gas wells).
- The predicted locations of lease roads, tank batteries, pipelines, and electrical lines.

KANSAS CORPORATION COMMISSION
OIL & GAS CONSERVATION DIVISION

Form CDP-1
May 2010
Form must be Typed

APPLICATION FOR SURFACE PIT

Submit in Duplicate

Operator Name: IGWT, Inc.		License Number: 3167	
Operator Address: P.O. BOX 550		ROSE HILL KS 67133	
Contact Person: Kenton Hupp		Phone Number: 316-265-5800	
Lease Name & Well No.: VARNER FARMS 1		Pit Location (QQQQ): W2 - SW - NE - NW Sec. 33 Twp. 25 R. 4 <input checked="" type="checkbox"/> East <input type="checkbox"/> West 990 Feet from <input checked="" type="checkbox"/> North / <input type="checkbox"/> South Line of Section 1500 Feet from <input type="checkbox"/> East / <input checked="" type="checkbox"/> West Line of Section Butler County	
Type of Pit: <input type="checkbox"/> Emergency Pit <input type="checkbox"/> Burn Pit <input type="checkbox"/> Settling Pit <input checked="" type="checkbox"/> Drilling Pit <input type="checkbox"/> Workover Pit <input type="checkbox"/> Haul-Off Pit (If WP Supply API No. or Year Drilled)	Pit is: <input checked="" type="checkbox"/> Proposed <input type="checkbox"/> Existing If Existing, date constructed: Pit capacity: 10260 (bbls)		
Is the pit located in a Sensitive Ground Water Area? <input type="checkbox"/> Yes <input checked="" type="checkbox"/> No		Chloride concentration: _____ mg/l (For Emergency Pits and Settling Pits only)	
Is the bottom below ground level? <input checked="" type="checkbox"/> Yes <input type="checkbox"/> No		Artificial Liner? <input type="checkbox"/> Yes <input checked="" type="checkbox"/> No	
How is the pit lined if a plastic liner is not used? NATIVE CLAY			
Pit dimensions (all but working pits): 120 Length (feet) 120 Width (feet) Depth from ground level to deepest point: 4 (feet)		<input type="checkbox"/> N/A: Steel Pits <input type="checkbox"/> No Pit	
If the pit is lined give a brief description of the liner material, thickness and installation procedure.		Describe procedures for periodic maintenance and determining liner integrity, including any special monitoring.	
Distance to nearest water well within one-mile of pit: 2059 feet Depth of water well 147 feet		Depth to shallowest fresh water 30 feet. Source of information: <input type="checkbox"/> measured <input type="checkbox"/> well owner <input type="checkbox"/> electric log <input checked="" type="checkbox"/> KDWR	
Emergency, Settling and Burn Pits ONLY: Producing Formation: Number of producing wells on lease: Barrels of fluid produced daily: Does the slope from the tank battery allow all spilled fluids to flow into the pit? <input type="checkbox"/> Yes <input type="checkbox"/> No		Drilling, Workover and Haul-Off Pits ONLY: Type of material utilized in drilling/workover: MUD Number of working pits to be utilized: 1 Abandonment procedure: ALLOW TO DRY AND FILL IN Drill pits must be closed within 365 days of spud date.	
I hereby certify that the above statements are true and correct to the best of my knowledge and belief.			
Date		Signature of Applicant or Agent	

KCC OFFICE USE ONLY

☐ Liner ☐ Steel Pit ☐ RFAC ☐ RFAS

Date Received: 05/23/2018 Permit Number: Permit Date: Lease Inspection: ☐ Yes ☒ No

KANSAS CORPORATION COMMISSION
OIL & GAS CONSERVATION DIVISION

Form KSONA-1

January 2014

Form Must Be Typed
Form must be Signed
All blanks must be Filled

**CERTIFICATION OF COMPLIANCE WITH THE
KANSAS SURFACE OWNER NOTIFICATION ACT**

This form must be submitted with all Forms C-1 (Notice of Intent to Drill); CB-1 (Cathodic Protection Borehole Intent); T-1 (Request for Change of Operator Transfer of Injection or Surface Pit Permit); and CP-1 (Well Plugging Application). Any such form submitted without an accompanying Form KSONA-1 will be returned.

Select the corresponding form being filed: ☒ C-1 (Intent) ☐ CB-1 (Cathodic Protection Borehole Intent) ☐ T-1 (Transfer) ☐ CP-1 (Plugging Application)

OPERATOR: License # 3167
Name: IGWT, Inc.
Address 1: P.O. BOX 550
Address 2: _____
City: ROSE HILL State: KS Zip: 67133 + _____
Contact Person: KENTON HUPP
Phone: (316) 265-5800 Fax: (_____) _____
Email Address: _____

Well Location: _____
W2 SW NE NW Sec. 33 Twp. 25 S. R. 4 ☒ East ☐ West
County: Butler
Lease Name: VARNER FARMS Well #: 1

If filing a Form T-1 for multiple wells on a lease, enter the legal description of the lease below:

Surface Owner Information:

Name: VARNER FARMS
Address 1: 8405 NW 10TH ST
Address 2: _____
City: TOWANDA State: KS Zip: 67144 + _____

When filing a Form T-1 involving multiple surface owners, attach an additional sheet listing all of the information to the left for each surface owner. Surface owner information can be found in the records of the register of deeds for the county, and in the real estate property tax records of the county treasurer.

If this form is being submitted with a Form C-1 (Intent) or CB-1 (Cathodic Protection Borehole Intent), you must supply the surface owners and the KCC with a plat showing the predicted locations of lease roads, tank batteries, pipelines, and electrical lines. The locations shown on the plat are preliminary non-binding estimates. The locations may be entered on the Form C-1 plat, Form CB-1 plat, or a separate plat may be submitted.

Select one of the following:

☒ I certify that, pursuant to the Kansas Surface Owner Notice Act (House Bill 2032), I have provided the following to the surface owner(s) of the land upon which the subject well is or will be located: 1) a copy of the Form C-1, Form CB-1, Form T-1, or Form CP-1 that I am filing in connection with this form; 2) if the form being filed is a Form C-1 or Form CB-1, the plat(s) required by this form; and 3) my operator name, address, phone number, fax, and email address.

☐ I have not provided this information to the surface owner(s). I acknowledge that, because I have not provided this information, the KCC will be required to send this information to the surface owner(s). To mitigate the additional cost of the KCC performing this task, I acknowledge that I must provide the name and address of the surface owner by filling out the top section of this form and that I am being charged a \$30.00 handling fee, payable to the KCC, which is enclosed with this form.

If choosing the second option, submit payment of the \$30.00 handling fee with this form. If the fee is not received with this form, the KSONA-1 form and the associated Form C-1, Form CB-1, Form T-1, or Form CP-1 will be returned.

I hereby certify that the statements made herein are true and correct to the best of my knowledge and belief.

Date: _____ Signature of Operator or Agent: _____ Title: _____

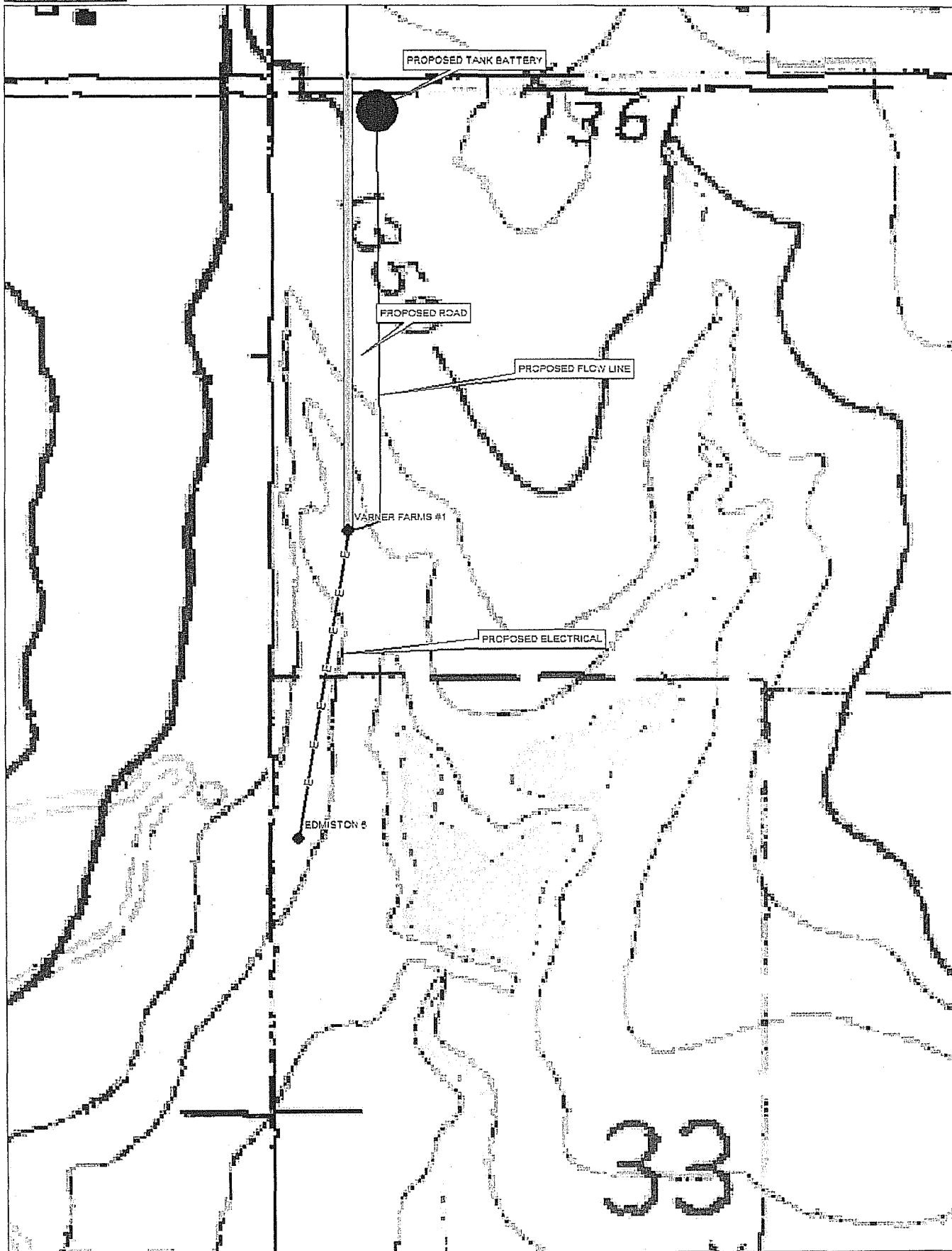

Data use subject to license.

© DeLorme. XMap® 7.

www.delorme.com

