

**BEFORE THE STATE CORPORATION COMMISSION
OF THE STATE OF KANSAS**

IN THE MATTER OF THE APPLICATION OF)
EVERGY KANSAS CENTRAL, INC. FOR A)
CERTIFICATE OF PUBLIC CONVENIENCE)
AND AUTHORITY TO TRANSACT THE)
BUSINESS OF AN ELECTRIC PUBLIC UTILITY))
DEFINED AS 115kV TRANSMISSION LINE)
PROJECT WR P26365 E EUREKA TO OTTER)
CREEK IN GREENWOOD COUNTY, KANSAS)

Docket No. 22-EKCE-235-COC

**APPLICATION FOR A CERTIFICATE OF PUBLIC CONVENIENCE AND
AUTHORITY TO TRANSACT THE BUSINESS OF AN ELECTRIC PUBLIC UTILITY,
TRANSMISSION RIGHTS ONLY**

COMES NOW Evergy Kansas Central, Inc. d/b/a Evergy Kansas Central (“Evergy Kansas Central”), and in support of its Application for a Certificate of Public Convenience and Authority, for Transmission Rights only, states:

1. Evergy Kansas Central is a Kansas corporation authorized by the Commission to conduct the business of a public utility under the provisions of K.S.A. 66-104, and as such holds a Certificate of Convenience and Authority from this Commission to engage in the business of an electric public utility in the State of Kansas, thereby promoting public convenience.

2. Evergy Kansas Central seeks, subject to the Commission’s approval, transmission rights only in Butler Rural Electric Cooperative, Inc. (“Butler”) certified territory defined as the 115 kV Transmission Line Project, WR P26365 described below from the northernmost to southernmost extent:

GREENWOOD COUNTY, KANSAS

Beginning in the Evergy Kansas Central’s territory at the existing East Eureka Substation in the SE ¼ of Section 35, Township 25S, Range 10E; thence east through the south portion of the SE ¼ of Section 35, Township 25S, Range 10E; thence east entering the SW ¼ of Section 36, Township 25S, Range 10E; thence east through the south part of Section 36, Township 25S, Range 10E; thence south in the SE ¼ of Section 36, Township 25S, Range 10E; thence entering the NE ¼ of Section 1, Township 26S, Range 10E; thence south through the far east part of Section 1, Township 26S, Range 10E; thence entering the NE ¼ of Section 12,

Township 26S, Range 10E continuing SE $\frac{1}{4}$ of Section 12, Township 26S, Range 10E; thence SE entering the SW $\frac{1}{4}$ of Section 7, Township 26S, Range 11E continuing SE for approximately 0.22 miles; thence south in the NW $\frac{1}{4}$ of Section 18, Township 26S, Range 11E; thence south through the west portion of Section 18, Township 26S, Range 11E; thence SW in the SW $\frac{1}{4}$ of Section 18, Township 26S, Range 11E; thence SE $\frac{1}{4}$ of Section 13, Township 26S, Range 10E; thence south through the east part of Section 13, Township 26S, Range 10E; thence east through Section 24, Township 26S, Range 10E; thence entering NE $\frac{1}{4}$ of Section 25, Township 26S, Range 10E; thence west through the N $\frac{1}{2}$ of Section 25, Township 26S, Range 10E; thence south in the NW $\frac{1}{4}$ of Section 25, Township 26S, Range 10E; thence south along the far west edge of Section 25, Township 26S, Range 10E; thence south along the far west edge of Section 36, Township 26S, Range 10E; thence west in the far SW corner of the SW $\frac{1}{4}$ of Section 36, Township 26S, Range 10E; thence west along the south edge of Section 35, Township 26S, Range 10E for 0.5 mile where it leaves the Everygy Kansas Central territory and enters the Butler County Coop territory.

The line enters the Butler County Coop territory in the far south edge of the SW $\frac{1}{4}$ of Section 35, Township 26S, Range 10E; thence continuing west for 0.45 miles of Section 35, Township 26S, Range 10E; thence SW and enters the NW $\frac{1}{4}$ of Section 2, Township 27S, Range 10E; thence south for 0.5 mile in Section 2, Township 27S, Range 10E and leaves the Butler County Coop territory and enters the Everygy Kansas Central territory.

The line enters Everygy Kansas Central territory in the SW $\frac{1}{4}$ of Section 2, Township 27S, Range 10E; thence south along the west edge of Section 2, Township 27S, Range 10E; thence along the west edge entering the NW $\frac{1}{4}$ of Section 11, Township 27S, Range 10E; thence SW in the SW $\frac{1}{4}$ of the NW $\frac{1}{4}$ of Section 11, Township 27S, Range 10E; thence entering the SE $\frac{1}{4}$ of the NE $\frac{1}{4}$ of Section 10, Township 27S, Range 10E; thence south along the east edge of Section 10, Township 27, Range 10E; thence south along the east edge of Section 15, Township 27S, Range 10E; thence east in the SE $\frac{1}{4}$ of Section 15, Township 27S, Range 10E; thence entering the SW $\frac{1}{4}$ of Section 14, Township 27S, Range 10E terminating at the Otter Creek substation located in the SW $\frac{1}{4}$ of Section 14, Township 27S, Range 10E in Greenwood County, Kansas. See Exhibit A.

3. Everygy Kansas Central is requesting transmission rights in the above territory for approximately 12.65 miles of new 115 kV transmission line from the new Otter Creek substation into Eureka, to make the system more reliable. The new lines will be located within a new 125-foot right-of-way.

4. The purposed project will upgrade an old power system that was built in the 1970s and 1980s, that had little opportunity for maintenance due to being on a large radial feed

that does not readily allow for maintenance outages. The East Eureka and Vaughn systems account for approximately 20MW of load and are fed out of West Emporia by more than 40 miles of 115kV line, for a total of about 800 MW-miles. There is no generation available in this area with minimal connections to other systems (34kV) for backup, making it a prime candidate to be considered for expansion to loop the facilities.

5. A study was done by Burns & McDonnell including feedback from landowners to determine the final route.

6. A copy of this application is being served on Butler by delivery of United States Mail, postage prepaid, addressed as follows:

Jeff Leckliter
Butler Rural Electric Cooperative, Inc.
216-218 South Vine Street
El Dorado, Kansas 67042

There is no other person or entity, corporate, municipal, or otherwise that requires notice of this Application.

THEREFORE, Evergy Kansas Central requests that an Order be issued, granting Evergy Kansas Central the authority for transmission rights only in the territory described in paragraph 2 above.

EVERGY KANSAS CENTRAL, INC.

BY: */s/ Cathryn J. Dinges*
Cathryn J. Dinges, S.Ct. #20848
Corporate Counsel
818 S. Kansas Avenue
P.O. Box 889
Topeka, Kansas 66601-0889
PHONE: (785) 575-8344
FAX: (785) 575-8136

ITS ATTORNEY

STATE OF MISSOURI)
)
COUNTY OF JACKSON) ss

Cathryn J. Dinges, of lawful age, being first duly sworn upon oath, deposes and states:

That she is the attorney for the within named applicant, that she has read the above and foregoing Application and that the statements therein contained are true according to her knowledge and belief.

Cathryn J. Dinges

Subscribed and sworn to before me this 29th day of November 2021.

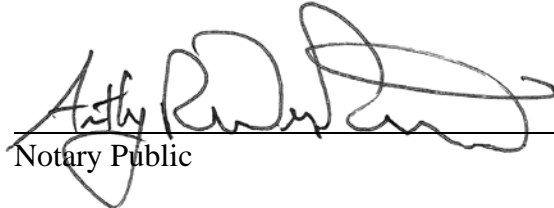
Notary Public

My Appointment Expires:

4/26/2025



CERTIFICATE OF SERVICE

I, the undersigned, hereby certify that a true and correct copy of the above was electronically served, hand-delivered or mailed, postage prepaid, this 29th day of November 2021 to:

CARLY MASENTHIN, LITIGATION COUNSEL
KANSAS CORPORATION COMMISSION
1500 SW ARROWHEAD RD
TOPEKA, KS 66604-4027
c.masenthin@kcc.ks.gov

TERRI PEMBERTON, LITIGATION COUNSEL
KANSAS CORPORATION COMMISSION
1500 SW ARROWHEAD RD
TOPEKA, KS 66604-4027
t.pemberton@kcc.ks.gov

with a courtesy copy (public only) to:

DAVID W. NICKEL, CONSUMER COUNSEL
CITIZENS' UTILITY RATEPAYER BOARD
1500 SW ARROWHEAD RD
TOPEKA, KS 66604
D.NICKEL@CURB.KANSAS.GOV

/s/ Cathryn Dinges

Cathryn J. Dinges
ATTORNEY EVERGY KANSAS
CENTRAL

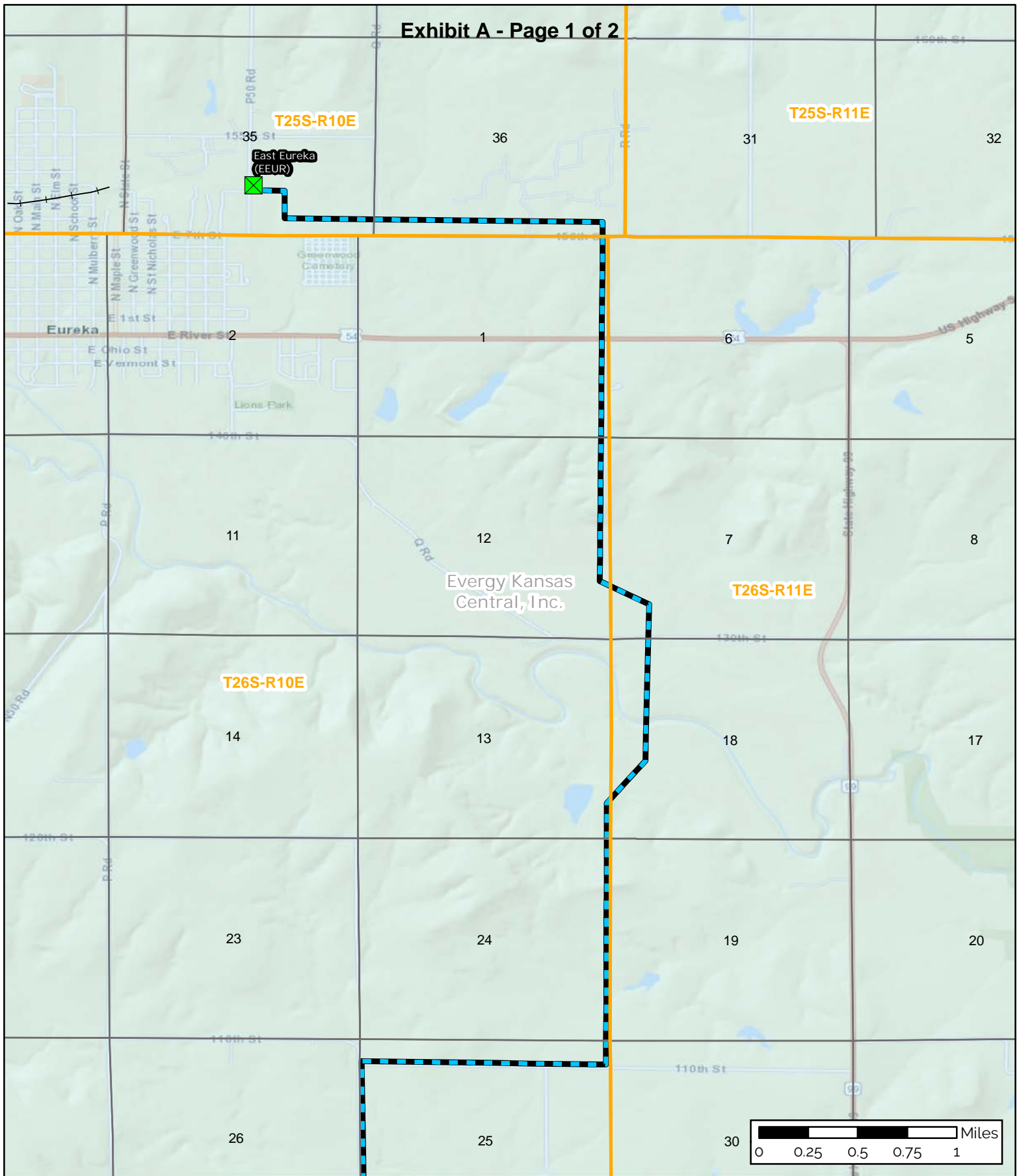

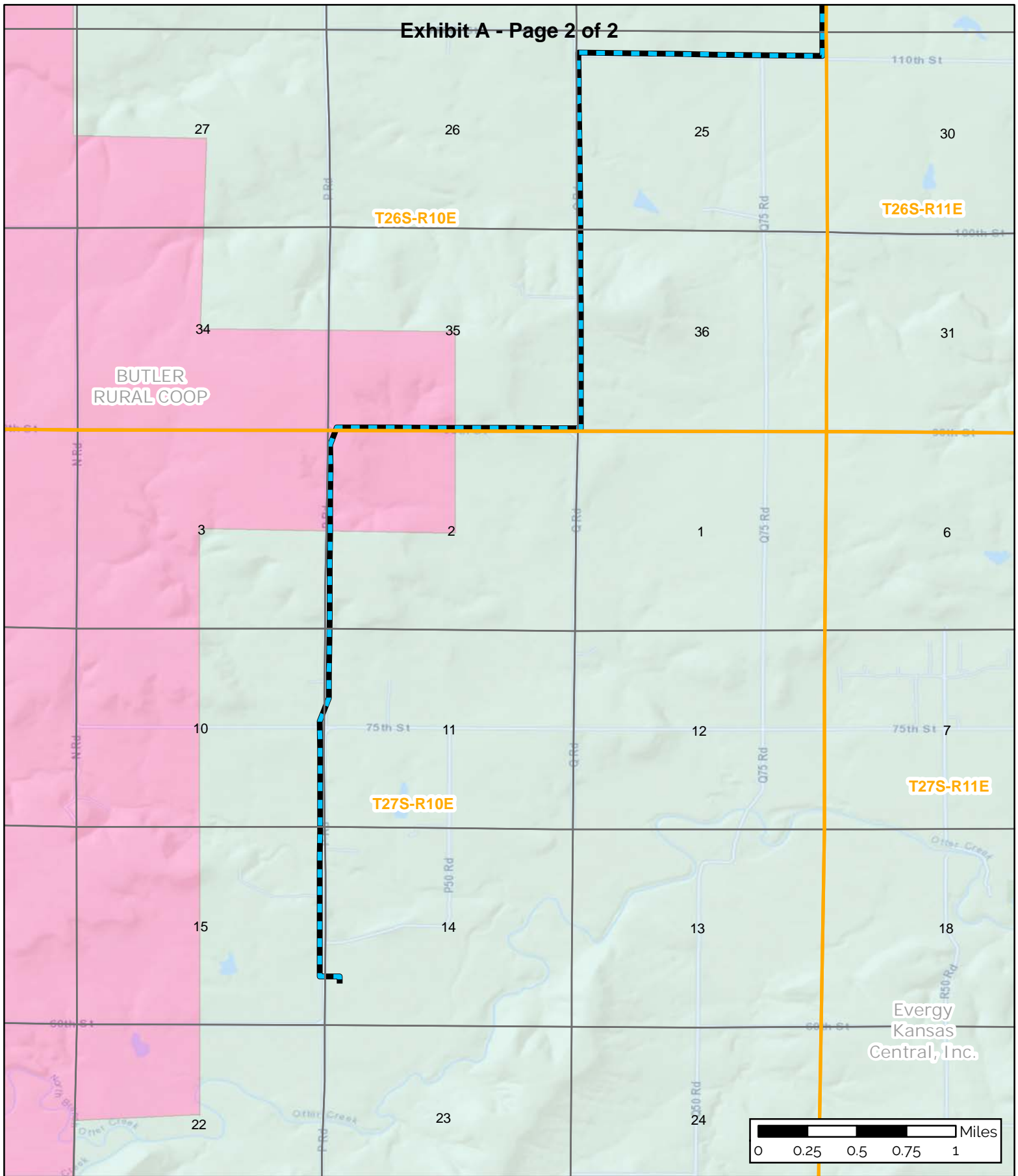

DESIGNED BY:	CP
DRAWN BY:	CP
CHECKED BY:	JK
APPROVED BY:	CC
DATE:	OCTOBER 2021

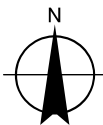

East Eureka to Otter Creek
Transmission Project
Greenwood County, Kansas



FIGURE
2 of 2

**East Eureka to
Otter Creek
RESA**

Evergy
Kansas
Central, Inc.