

**BEFORE THE CORPORATION COMMISSION
OF THE STATE OF KANSAS**

IN THE MATTER OF THE APPLICATION)	
OF L.D. DRILLING INC.)	DOCKET NO. 19-CONS- 3325-CEXC
FOR AN EXTENSION TO THE PIT CLOSURE)	
TIME REQUIREMENT OF K.A.R. 82-3-602 FOR)	LICENSE NO. 6039
ARENSMAN #2 WELL LOCATED)	
IN THE NW/4 OF SECTION 28-16-11W)	CONSERVATION DIVISION
BARTON COUNTY, KANSAS)	

APPLICATION

COMES NOW L.D. Drilling, Inc. ("Operator") in support of its application in the captioned matter states as follows:

1. Operator is licensed to do business in the State of Kansas. Applicant's address is 7 SW 26 Avenue, Great Bend, Kansas 67530.
2. Operator has been issued license no. 6039 by the Commission, which license expires on June 30, 2019.
3. Operator is the operator of the Arensman #2, API #009-26183-00-00 which is located in the NW/4 of Section 28-16S-11W, Barton County, Kansas.
4. Pursuant to K.A.R. 82-3-601a, Operator constructed temporary reserve and working pits in order to contain the drilling fluids associated with the drilling of Arensman #2 wellbore. The pits were constructed in August 2017.
5. The operator drilled the Arensman #2, with the spud date being August 26, 2017. Operator had an initial period of 365 days within which to close the drilling pits. Operator requested an extension of time from the Director in October of 2018 and an extension of time to close the pit was granted until January 12, 2019. The pit was checked a number of times, but

was not dry enough to fill. Barton County had unusually wet weather in 2018 and due to the wet conditions, the pit has been full of water and has been unable to be closed.

6. The Commission notified Operator that any further extension would need to be applied for under a Docket Number with the Commission and could no longer be granted by the Director. K.A.R. 82-3-602(a)-1 sets a 365 day limit to close all pits associated with the drilling of a new wellbore. K.A.R. 82-3-602(a)-2 allows for any extension of the pit closure by written request and approval of the director.

7. Operator requests this application be approved for the following reasons:

A. It is the accepted and preferred best practice by industry and landowners alike not to close any pits until they have thoroughly dried out. Closing pits early leads to future soil issues including collapse and erosion. The Arensman #2 drilling pits are still not dry as of the filing of this application.

B. The precipitation and moisture level in central Ks has been unusually high through-out much of 2018 and early 2019, preventing the Arensman #2 pits from properly drying.

C. It is the preferred practice of the Operator and many other operators to not close pits during the winter. The ground is typically frozen with the soil holding more moisture during the winter and spring months. Granting an extension to the pit closure deadline through the summer of 2019 would allow the Operator to wait and close the pits during the optimal hot, dry summer months.

8. The landowner and farm tenant have not made a request to close the pits and they are aware of the wet conditions in their field and the pits themselves.

9. Based on the foregoing, Operator requests that the Commission grant an exception to the 365 day deadline and subsequent 90-day extensions permitted by the Director in order to allow the subject pits to remain open and properly dry before being filled. Operator requests this extension be for 210 days from January 12, 2019, in order to allow for the subject pits to be filled during the hot, dry summer months.

10. There are oil and gas operators of record within a one-half mile radius of subject lands. Their contact information is as follows:

Kahan & Associates Inc.
PO Box 700780
Tulsa, Ok 74170-0780

Empire Energy Exp. LLC
380 Southpointe Blvd., Ste. 130
Canonsburg, PA 15317-8561

RJM Company Inc
PO Box 256
Claflin, Ks 67525-0265

Cla-Mar Oil Company, LLC
PO Box 506
Hays, Ks 67601-0506

11. The mineral owners covering lands within a one-half mile radius of the subject land are as follows:

Daniel R. Panzer Jr.
229 N Missouri Street
Kanopolis, Ks 67454-9540

Jennifer M Panzer
612 Grainfield
Manhattan, Ks 66502

Robert R Panzer Jr
1816 Avenue G
Ellsworth, Ks 67439-8508

Vernon Rous
1327 Douglas Dr
Hays, Ks 67601

Susan Klug
3425 w 10th Place
Lawrence, Ks 66049

Steve Rous
301 s 7th Ave
Fairview, OK 73737

Kathleen Kirmer
512 2nd
Claflin, Ks 67525

Calvin Rous
622 E 3rd
Hoisington, Ks 67544

Sheldon Rous
1779 NE 120 Ave
Claflin, Ks 67525

Kayleen Gaddis
103 A Street
Claflin, Ks 67525

Lamatsch Farms Partnership
2140 NE 130 Ave
Claflin, Kansas 67525

12. The surface owner of the land containing the Arensman #2 and pits is:

Daniel R. Panzer Jr.
229 N Missouri Street
Kanopolis, Ks 67454-9540

Jennifer M. Panzer
612 Grainfield
Manhattan, Ks 66502

13. The attached Exhibit A is a plat showing the pits location and grounds within a one-half mile radius.

14. Notice of this application and any required hearing will be published pursuant to K.A.R. 82-3-135a and K.A.R. 82-3-135.

WHEREFORE, Operator prays that this matter be granted administratively without a hearing, or in the alternative be set for hearing, and upon hearing that the Commission grant Operator's request, for a 210 day extension of time to the pit closure requirement set forth in K.A. R. 82-3-602.

Respectfully submitted,

By: 
Marilyn Davis, President
L.D. Drilling, Inc.
7 SW 26 Avenue
Great Bend, Ks 67530

EXHIBIT "A"

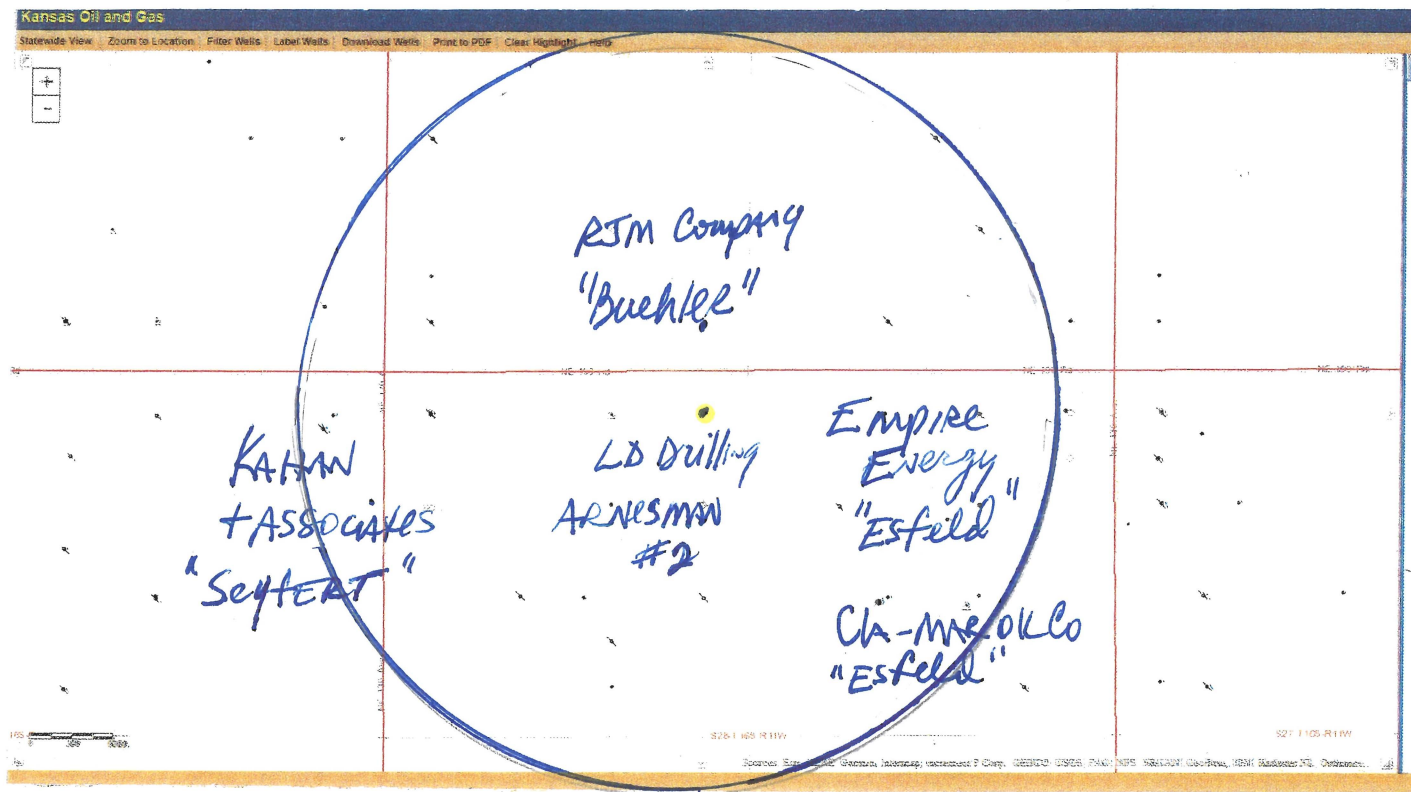

VERIFICATION

STATE OF KANSAS, COUNTY OF BARTON, ss.

Marilyn Davis, of lawful age and being first duly sworn, upon oath deposes and states:

Marilyn Davis is President of L. D. Drilling, Inc. the operator in the above-titled action, and has read the foregoing and knows the contents thereof, and that the statements therein contained are true and correct.

Marilyn Davis, President

SUBSCRIBED AND SWORN to before me on this 5th day of April, 2019.

My commission expires:

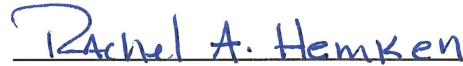

Notary Public

CERTIFICATE OF SERVICE

I hereby certify that on April 5, 2019, I electronically filed the foregoing Application with the Clerk of the Court using the e-filing system to the following:

Kahan & Associates Inc.
PO Box 700780
Tulsa, Ok 74170-0780

Empire Energy Exp. LLC
380 Southpointe Blvd., Ste. 130
Canonsburg, PA 15317-8561

RJM Company Inc
PO Box 256
Claflin, Ks 67525-0265

Cla-Mar Oil Company, LLC
PO Box 506
Hays. Ks 67601-0506

Daniel R. Panzer Jr.
229 N Missouri Street
Kanopolis, Ks 67454-9540

Jennifer M Panzer
612 Grainfield
Manhattan, Ks 66502

Robert R Panzer Jr
1816 Avenue G
Ellsworth, Ks 67439-8508

Vernon Rous
1327 Douglas Dr
Hays, Ks 67601

Susan Klug
3425 w 10th Place
Lawrence, Ks 66049

Steve Rous
301 s 7th Ave
Fairview, OK 73737

Kathleen Kirmer
512 2nd
Claflin, Ks 67525

Calvin Rous
622 E 3rd
Hoisington, Ks 67544

Sheldon Rous
1779 NE 120 Ave
Claflin, Ks 67525

Kayleen Gaddis
103 A Street
Claflin, Ks 67525

Lamatsch Farms Partnership
2140 NE 130 Ave
Claflin, Kansas 67525

By: Marilyn Davis
Marilyn Davis, President
L.D. Drilling, Inc.
7 SW 26 Avenue
Great Bend, Ks 67530