

Conservation Division  
District Office No. 2  
3450 N. Rock Road  
Building 600, Suite 601  
Wichita, KS 67226



Phone: 316-630-4000  
Fax: 316-630-4005  
<http://kcc.ks.gov/>

Mark Sievers, Chairman  
Ward Loyd, Commissioner  
Thomas E. Wright, Commissioner

Sam Brownback, Governor

December 23, 2011

Dynasty Drilling, LLC  
P.O. Box 4720  
Tulsa, OK 74159  
Attn: Jeremy Greenfield

KCC #34371

Re: Morehouse #3, SE NE NE, Sec. 4-21-3W, McPherson Co., KS  
API No. 15-113-04672-0000

Dear Mr. Greenfield,

The Temporary Abandonment Application that you filed on the Morehouse #3 was denied on May 23, 2011. The deadline of June 22, 2011 to bring the well into compliance has passed, and the well is currently in violation of K.A.R. 82-3-111. The Morehouse #3 has been inactive over 10 years and no longer qualifies for TA status.

At this time Dynasty Drilling, LLC must plug the well, return it to service, or file for an exception to the 10 year limitation in K.A.R. 82-3-111 to demonstrate why it is necessary to TA the Morehouse #3 for more than 10 years. The final deadline to bring the well into compliance is January 23, 2012. If the well is not brought into compliance by this date, the matter will be turned over to our legal staff with a recommendation the well be plugged. If you have any questions you can reach me at the number shown above.

Sincerely,

Jeff Klock  
District 2 Supervisor

cc: Shane Jones - PIRT II  
Dan Fox - Compliance Officer

Ryan

# COPY

## KANSAS CORPORATION COMMISSION OIL & GAS CONSERVATION DIVISION

Form CP-111  
March 2009  
Form must be Typed  
Form must be signed

### TEMPORARY ABANDONMENT WELL APPLICATION

All blanks must be complete

OPERATOR: License# 34371  
 Name: Dynasty Drilling, LLC  
 Address 1: P. O. Box 4720  
 Address 2: \_\_\_\_\_  
 City: Tulsa State: OK Zip: 74159 + \_\_\_\_\_  
 Contact Person: Jeremy Greenfield  
 Phone: (918) 287-8945  
 Contact Person Email: jgreenfield@lamamco.com  
 Field Contact Person: Terry Schmidt  
 Field Contact Person Phone: (620) 245-7383

API No. 15- 113-04,672  
 Spot Description: \_\_\_\_\_  
SE NE NE Sec. 4 Twp. 21 S. R. 3  E  W  
4,154 feet from  N /  S Line of Section  
384 feet from  E /  W Line of Section  
 GPS Location: Lat: 38.2579008, Long: -97.648449  
 County: Mc Pherson  
 Lease Name: Morehouse Well #: 3  
 Elevation: 1,448  GL  KB  
 Well Type: (check one)  Oil  Gas  OG  WSW  Other: \_\_\_\_\_  
 SWD Permit #: \_\_\_\_\_  ENHR Permit #: \_\_\_\_\_  
 Gas Storage Permit #: \_\_\_\_\_  
 Spud Date: May 1930 Date Shut-In: 1986

	Conductor	Surface	Production	Intermediate	Liner	Tubing
Size		15 1/2"	8 1/4" - 6 5/8"			2 3/8"
Setting Depth		135'	2,985' - 3,340'			2,985'
Amount of Cement		125 sxs	550 sxs			
Top of Cement		Surface				
Bottom of Cement		135'	3,340'			

Casing Fluid Level: 2,821' How Determined? Fluid Level Shot  
 Casing Squeeze(s): \_\_\_\_\_ to \_\_\_\_\_ w / \_\_\_\_\_ sacks of cement, \_\_\_\_\_ to \_\_\_\_\_ w / \_\_\_\_\_  
 Do you have a valid Oil & Gas Lease?  Yes  No  
 Depth and Type:  Junk in Hole at \_\_\_\_\_ Tools in Hole at \_\_\_\_\_ Casing Leaks:  Yes  No Depth of casing leak(s): \_\_\_\_\_  
 Type Completion:  ALT. I  ALT. II Depth of:  DV Tool: \_\_\_\_\_ w / 550 sacks of cement  Port Collar: \_\_\_\_\_ w / \_\_\_\_\_ sack of cement  
 Packer Type: \_\_\_\_\_ Size: \_\_\_\_\_ Inch Set at: \_\_\_\_\_ Feet  
 Total Depth: 3,426 Plug Back Depth: 3,061 Plug Back Method: Cement

**RECEIVED**  
**ADMITTED**  
Date \_\_\_\_\_

**RECEIVED**  
**KCC DISTRICT #2**  
**MAY 24 2011**

**Geological Data:**  
 Formation Name Formation Top Formation Base Completion Information  
 1. Mississippi Chat At: 2,985 to 2,995 Feet Perforation Interval \_\_\_\_\_ to \_\_\_\_\_ Feet or Open Hole Interval \_\_\_\_\_ to \_\_\_\_\_ Feet  
 2. Arbuckle Dolomite At: 3,420 to 3,426 Feet Perforation Interval \_\_\_\_\_ to \_\_\_\_\_ Feet or Open Hole Interval \_\_\_\_\_ to \_\_\_\_\_ Feet

**WICHITA, KS**

UNDER PENALTY OF PERJURY I HEREBY ATTEST THAT THE INFORMATION CONTAINED HEREIN IS TRUE AND CORRECT TO THE BEST OF MY KNOWLEDGE.

Date: May 17, 2011 Signature: [Signature] Title: Area Manager

<b>Do NOT Write in This Space - KCC USE ONLY</b>	Date Tested: _____	Results: _____	Date Plugged: _____	Date Repaired: _____	Date Put Back in Service: _____
Review Completed by: <u>[Signature]</u>	Comments: <u>Denial Down over 10 years</u>			TA Approved: <u>Y</u>	Denied <input checked="" type="checkbox"/>

Mail to the Appropriate KCC Conservation Office:

	KCC District Office #1 - 210 E. Frontview, Suite A, Dodge City, KS 67801	Phone 620.225.8888
	KCC District Office #2 - 3450 N. Rock Road, Building 600, Suite 601, Wichita, KS 67226	Phone 316.630.4000
	KCC District Office #3 - 1500 SW Seventh Street, Chanute, KS 66720	Phone 620.432.2300
	KCC District Office #4 - 2301 E. 13th Street, Hays, KS 67601-2651	Phone 785.625.0550
	Underground Porosity Gas Storage (UPGS) 8200 E. 34th Street Circle N., Suite 1003, Wichita, KS 67226	Phone 316.734.4933



Sam Brownback, Governor, Mark Sievers, Chairman, Ward Loyd, Commissioner, Thomas E. Wright, Commissioner

**TEMPORARY ABANDONMENT DENIED**

May 23, 2011  
KCC Lic.-34103

LAMAMCO DRILLING CO., A GENERAL PARTNERSHIP  
4444 E. 146TH ST N  
PO BOX 550  
SKIATOOK OK 74070

RE: API Well No. 15-113-04672-00-00  
MOREHOUSE 3  
4-21S-3W, SWSENE  
MCPHERSON County, Kansas

Dear Operator:

Your application for Temporary Abandonment (TA) of the well listed above is denied for the following reason(s):

**DENIED DOWN, OVER 10 YEARS**

In accordance with K.A.R. 82-3-111, this well must be plugged or returned to service by JUNE 27, 2011.

You may file an application for an exception to the 10-year limitation in K.A.R. 82-3-111 to demonstrate why it is necessary to TA the above well for more than ten (10) years. Your application for an exception is due by JUNE 22, 2011. All applications must be sent to the Kansas Corporation Commission Conservation Division at 130 South Market, Room 2078, Wichita, Kansas 67202.

You may contact me at the number below if you have any questions.

Very truly yours,

SHANE JONES  
KCC District # 2



CORPORATION COMMISSION

*Kathleen Sebelius, Governor Thomas E. Wright, Chairman Michael C. Moffet, Commissioner Joseph F. Harkins, Commissioner*

**TEMPORARY ABANDONMENT APPROVED**

May 22, 2008  
KCC Lic.-31302

JONES & BUCK DEVELOPMENT, A GENERAL PARTNERSHIP  
PO BOX 68  
SEDAN KS 67361-0068

RE: API Well No. 15-113-04672-00-00  
MOREHOUSE 3  
4-21S-3W, SWSENE  
MCPHERSON County, Kansas

Dear Operator:

Your temporary abandonment (TA) application for the well listed above has been approved. In accordance with K.A.R. 82-3-111 the TA status of this well will expire on MAY 22, 2009.

- If you return this well to service or plug it, please notify the District Office.
- If you sell this well you are required to file a Transfer of Operator form, T-1.
- If the well will remain temporarily abandoned, you must submit a new TA application, CP-111, before the expiration date.

You may contact me at the number below if you have any questions.

Very truly yours,

Michael Wilson  
KCC District # 2

**AFFIDAVIT**

STATE OF KANSAS \
- SS.
County of Sedgwick /

Mark Fletchall, of lawful age, being first duly sworn, deposeth and saith: That he is Record Clerk of The Wichita Eagle, a daily newspaper published in the City of Wichita, County of Sedgwick, State of Kansas, and having a general paid circulation on a daily basis in said County, which said newspaper has been continuously and uninterruptedly published in said County for more than one year prior to the first publication of the notice hereinafter mentioned, and which said newspaper has been entered as second class mail matter at the United States Post Office in Wichita, Kansas, and which said newspaper is not a trade, religious or fraternal publication and that a notice of a true copy is hereto attached was published in the regular and entire Morning issue of said The Wichita Eagle for 1 issues, that the first publication of said notice was

made as aforesaid on the 18th of

June A.D. 2011, with

subsequent publications being made on the following dates:

And affiant further says that he has personal knowledge of the statements above set forth and that they are true.

*Mark Fletchall*

Subscribed and sworn to before me this

20th day of June, 2011

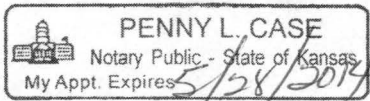

*Penny L. Case*
Notary Public Sedgwick County, Kansas

Printer's Fee : \$113.20

**LEGAL PUBLICATION**  
Published in The Wichita Eagle  
June 18, 2011 (3123997)  
**BEFORE THE STATE CORPORATION COMMISSION OF THE STATE OF KANSAS**  
**NOTICE OF FILING APPLICATION**  
**RE: DYNASTY DRILLING, LLC**  
Application for an exception to the 10 year time limitation of K.A.R. 82-3-111 for the Morehouse #3 well located in McPherson County, Kansas.  
TO: All Oil & Gas Producers, Unleased Mineral Interest Owners, Landowners, and all persons whomsoever concerned.  
You, and each of you, are hereby notified that Dynasty Drilling, LLC has filed an application for an exception to the 10 year time limitation of K.A.R. 82-3-111 for the Morehouse # 3 well (API #15-113-04,672), located approximately 4,154' FLS, 384' FEL in Section 4 - T21S - R3W, McPherson County, Kansas.  
Any persons who object with the Conservation Division of the State of Kansas within fifteen (15) days from the date of the publication, These protests shall be filed pursuant to Commission regulations and must state specific reasons why granting the application may cause waste, violate correlative rights or pollute the natural resources of the State of Kansas.  
All persons interested or concerned shall take notice of the foregoing and shall govern themselves accordingly. Information about this application can be obtained through the KCC at (316)337-6200 or by contacting the person listed below.  
Thomas H. Oast  
Agent (620)725-3200  
DYNASTY DRILLING, LLC  
P.O. Box 4720  
Tulsa, OK 74159  
(918)287-8945

**AFFIDAVIT OF PUBLICATION**

STATE OF KANSAS, McPHERSON COUNTY, ss:

Katie Sawyer, being first duly sworn, deposes and says: That she is Editor of:

**The McPherson Sentinel**

301 S. Main, P.O. Box 926, McPherson, KS 67460

a daily newspaper printed in the State of Kansas, and published in and of general circulation in McPherson County, Kansas, with a general paid circulation on a daily basis in McPherson County, Kansas, and that said newspaper is not a trade, religious or fraternal publication.

Said newspaper is a daily published at least weekly 50 times a year; has been so published continuously and uninterruptedly in said county and state for a period of more than five years prior to the first publication of said notice; and has been admitted at the post office of McPherson in said County as second class matter.

That the attached notice is a true copy thereof and was published in the regular and entire issue of said

newspaper for 1 consecutive day, the (week, days)

first publication thereof being made as aforesaid on

the 18 day of June, 2011, with subsequent publications being made on the following dates:

\_\_\_\_\_, 20\_\_\_\_, 20\_\_\_\_  
\_\_\_\_\_, 20\_\_\_\_, 20\_\_\_\_  
\_\_\_\_\_, 20\_\_\_\_, 20\_\_\_\_

Katie Sawyer  
Editor

Subscribed and sworn to before me this 20<sup>th</sup> day of

June, 2011.

Jane Drelling  
Notary Public

Printer's fee \$ 32.55

Additional copies \$ \_\_\_\_\_

**LEGAL PUBLICATION**  
BEFORE THE STATE CORPORATION COMMISSION OF THE STATE OF KANSAS  
NOTICE OF FILING APPLICATION  
RE: DYNASTY DRILLING, LLC  
Application for an exception to the 10 year time limitation of K.A.R. 82-3-111 for the Morehouse #3 well located in McPherson County, Kansas.  
TO: All Oil & Gas Producers, Unleased Mineral Interest Owners, Landowners and all persons whomever concerned.  
You, and each of you, are hereby notified that Dynasty Drilling, LLC has filed an application for an exception to the 10 year time limitation of K.A.R. 82-3-111 for the Morehouse #3 well (API #15-113-04,672), located approximately 4,154' FSL, 384' FEL in Section 4 - T21S - R3W, McPherson County, Kansas.  
Any persons who object to or protest this application shall be required to file there objections or protest with the Conservation Division of the State of Kansas within fifteen (15) days from the date of this publication. These protests shall be filed pursuant to Commission regulations and must state specific reasons why granting the application may cause waste, violate correlative rights of pollute the natural resources of the State of Kansas.  
All persons interested or concerned shall take notice of the foregoing and shall govern themselves accordingly. Information about this application can be obtained through the KCC at (316) 337-6200 or by contacting the person listed below.  
Thomas H. Oast  
Agent (620) 725-3200  
DYNASTY DRILLING, LLC  
P.O. Box 4720  
Tulsa, OK 74159  
(918) 287-8945  
Published in the McPherson Sentinel  
Saturday, June 18, 2011 (142)

NOTARY PUBLIC - State of Kansas  
JANELL DREILING  
My Appt. Exp. 12-18-11

### Kansas Oil and Gas

Kansas Geological Survey

Statewide View | Zoom to Location | Filter Wells | Label Wells | Download Wells | Print to PDF | Clear Highlight | Help

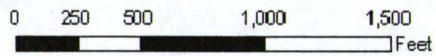

*more house lease  
well # 3*

# voshell

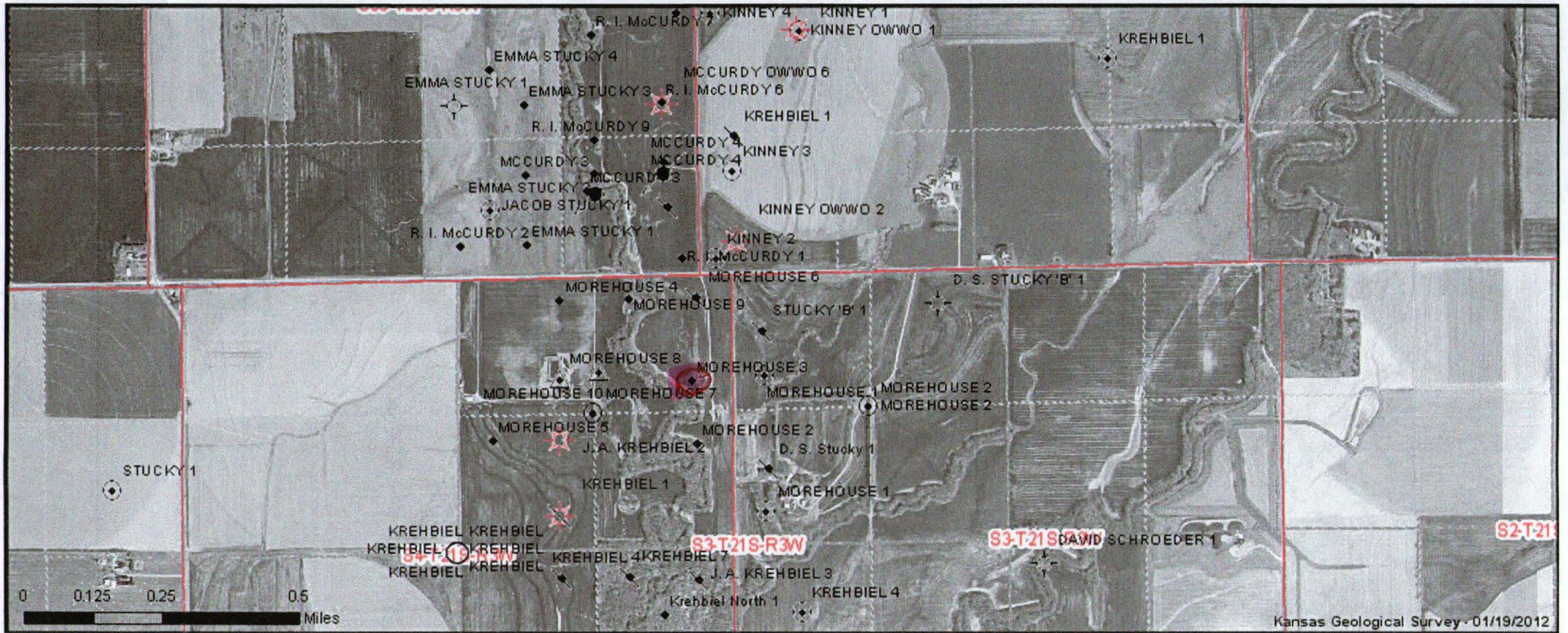

### Kansas Oil and Gas

Kansas Geological Survey

Statewide View | Zoom to Location | Filter Wells | Label Wells | Download Wells | Print to PDF | Clear Highlight | Help

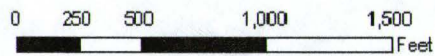
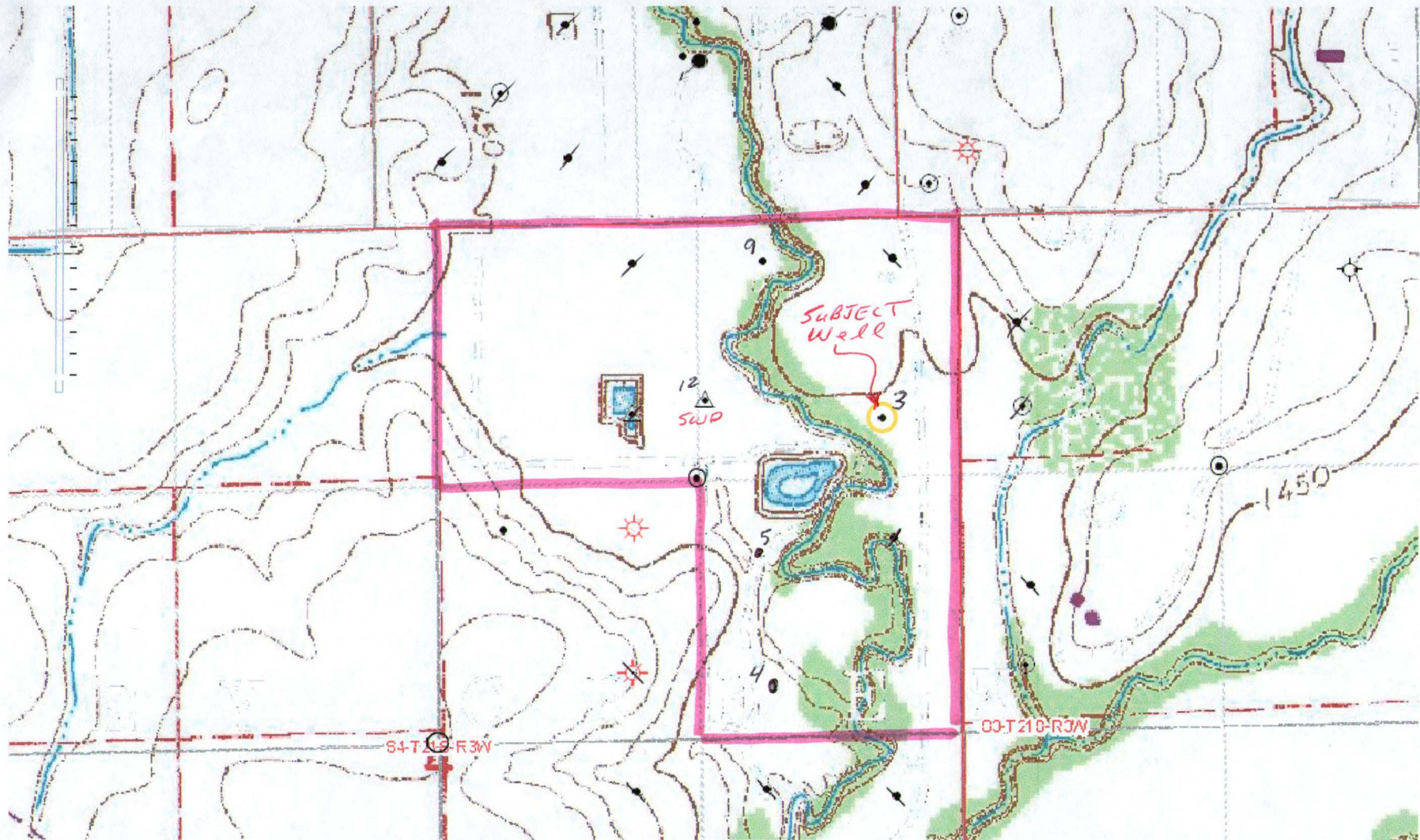

MOREHOUSE LEASE  
DYNASTY DRILLING, LLC

**Dynasty Drilling, LLC**  
**P.O. Box 4720**  
**Tulsa, OK 74159**  
**(918) 287-8945**

January 23, 2012

**RE: 10 Year Limitation Exception Application**  
**Dynasty Drilling, LLC**  
**Morehouse #3**  
**4,154 FSL, 384 FEL**  
**API #15-113-04,672**  
**Section 4 – T21S – R3W**  
**McPherson County, Kansas**

Dear Recipient:

Please find enclosed a copy of an *Application for an Exception to the 10 Year Limitation of K.A.R. 82-3-111*, on the above referenced well, as filed with the Kansas Corporation Commission (KCC) by Dynasty Drilling, LLC.

The applicant is required to deliver one (1) copy of this application to each operator of producing leasehold's and each unleased mineral rights owner within one-half mile of the applicant well radius. Thusly, a copy of this application has been provided to you.

If you feel this application has been incorrectly provided to you or should be forwarded to additional parties due to ownership changes, or if you have any questions concerning this application, please contact my office at (918) 440-6512 or call (918) 287-8945. You may also contact the Kansas Corporation Commission directly with any additional questions at (316) 337-6200.

Sincerely,

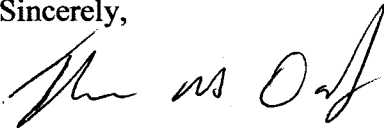

Thomas H. Oast  
Area Manager  
Dynasty Drilling, LLC

Encls.

*g 7 file*  
*Voshell*



Date: June 10, 1980

Subject: Krehbiel #7  
Section 4-21S-3W  
McPherson County, Kansas

From/Location: Deborah Bennett

To/Location: Jerry Pollock

I recommend that AOGC place the Krehbiel #7 back on pump. The subject well was TA'd in September 1974. Economic analysis (attached) indicates that this project has a present worth profit of 14 M\$, discounted at 15%, AFIT, and also has a 100% Investor's Rate of Return; based on recoverable reserves of 9.2 MBO and a 35% chance factor. The initial oil price would be 39.00\$/STB, as this lease receives stripper oil prices and the payout of the project is .87 years, AFIT.

Reserves were calculated from decline curve analysis, using an initial rate of 9 BOPD and a decline rate of 26% per year. The decline rates of wells in this area range from 10-20%; however, due to the probability of a high water cut, I increased this decline rate. The initial investment is 18.9 M\$; 2.4 M\$ of rig time and 16.5 M\$ to charge the lease with the test pumping unit to be transferred in (also to be credited as salvage at the end of the well life, approx. 7.5 years).

The great majority of wells in Section 4 were drilled in the 1930's. There were thirty-four (34) wells drilled, of which three (3) were dry holes. These wells were completed open hole in the Misener, Viola, Wilcox and Arbuckle formations; and, some, later perforated in the Miss. Chat. To date, there are only eight (8) wells producing of the original thirty-four (34). The attached plat indicates ARCO acreage in the area; the McCurdy lease, Section 33-20S-3W, the Moorehouse and Krehbiel leases, Section 4-21S-3W; all of which are part of the Voshell Salt Water Disposal System.

June 10, 1980  
Page 2

There are three (3) wells on the Krehbiel lease; #3, plugged and abandoned 5-79; #4, a gas well used to supply fuel for the Krehbiel, Moorehouse, McCurdy and Stucky (Section 28-20S-3W) leases; and #7, which was TA'd 9-74. The Viola still looks promising in offsets to the Krehbiel #7. The Moorehouse #4, 660' north of the subject well, is currently producing 9 BOPD, with a 95% water cut. Subsea depths of the Viola tops are within 3 feet in the two wells. In 1955, Brunson and Spines completed the Krehbiel 1-B, approximately 2000' south of ARCO's Krehbiel #7, and the Viola top being about 70' updip to our well. Production had declined in the Krehbiel 1-B to about 16 BOPD, but increased to 40-45 BOPD during the last year for no known reason (i.e., no rework had been done on the well).

Due to increased oil prices and the low cost involved for this venture, I believe the Krehbiel #7 should be placed back on pump, in spite of the low chance factor. Attached are a workover prognosis, economics and plat.

  
Deborah P. Bennett

DPB:bjh

108

*ack  
for DPB*

Attachments

cc: Clyde Bruce - Great Bend  
Jack Freeman - Woodward

WELL DATA SHEET

BASE A.E. Morehouse WELL NO. 3 POOL Voshell DATE September 1, 19

LOCATION SE-NW-NW Sec. 4 TWP. 21S RGE. 3W COUNTY McPherson STATE Kansas

Date Original Completed: May 19, 1930

Well Elevation: \_\_\_\_\_

Producing Formation: Wilcox  
Open Hole, Perfs. Fm. 3360 to 3380 Holes \_\_\_\_\_

Producing Formation: Arbuckle  
Open Hole, Perfs. Fm. 3420 to 3426 Holes \_\_\_\_\_

Producing Formation: \_\_\_\_\_  
Open Hole, Perfs. Fm. \_\_\_\_\_ to \_\_\_\_\_ Holes \_\_\_\_\_

INITIAL PROD. 800 BOPD from Wilcox  
340 BOPD from Arbuckle & trace

INITIAL TREAT: shot w/ 10 qts Nitro 3389-3396  
shot w/ 16 qts Nitro 3388-3396

SUBSEQUENT WORKOVERS OR RECONDITIONING

NO.	DESCRIPTION
<u>1-15-47</u>	<u>Deepen well from 3396' to 3426' (</u> <u>from Wilcox sd open to Arbuckle open</u> <u>hole. Both zones completed in open</u> <u>hole from 3340' to 3426'</u>
_____	_____
_____	_____
_____	_____
_____	_____
_____	_____
_____	_____
_____	_____
_____	_____
_____	_____
_____	_____
_____	_____
_____	_____

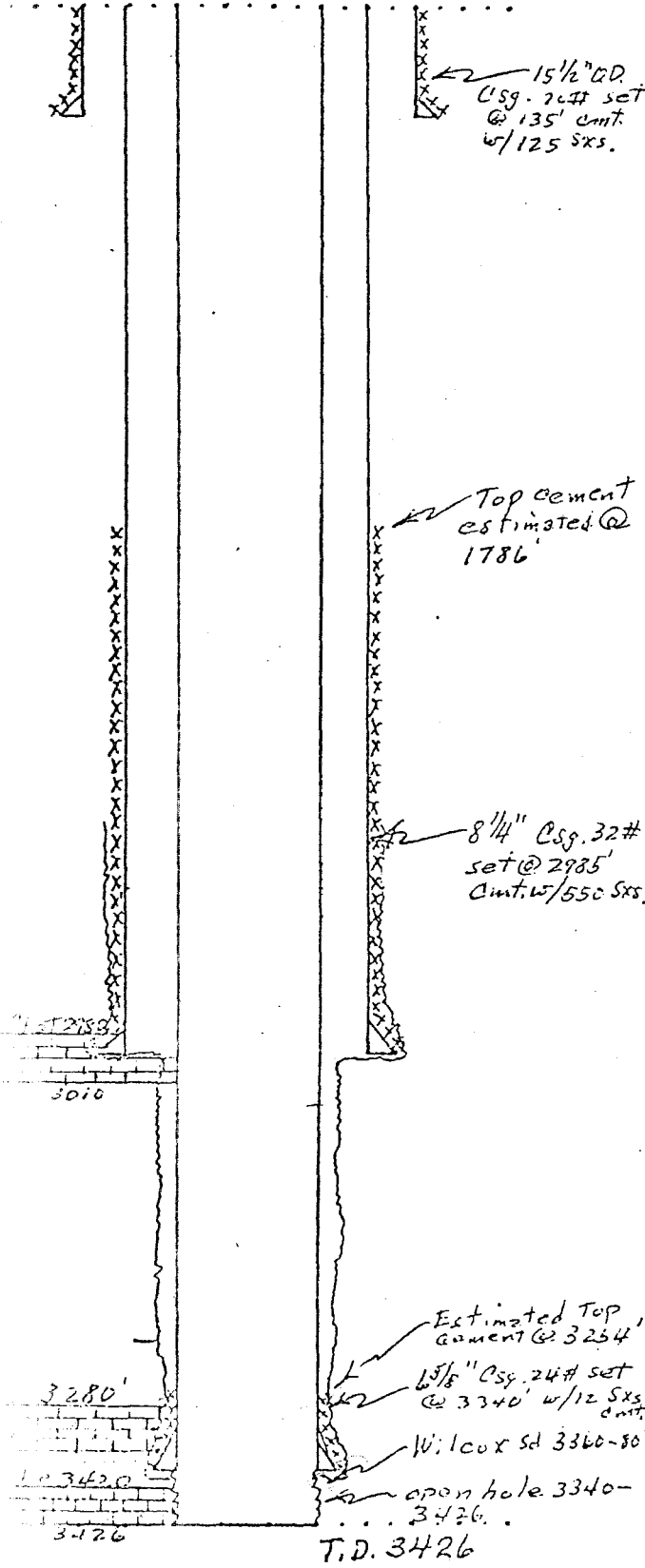

## INTER-OFFICE COMMUNICATION

Location Wichita, Kansas

September 13, 19 63

To Mr. Harold Weinland  
Great Bend, Kansas

Reply Attention:

Re: Your Memo of 8-28-63 --  
Shallow Gas Producing Formations -  
Voshell Pool

Dear Sir:

The logs in the area of the Voshell Pool have been examined for possible producing horizons other than Mississippian "Chat" and Arbuckle. The only zone found which offers any possibility is in the Lansing-Kansas City Formation at a depth of 2,502-10 feet on the Sinclair-Prairie No. 3 D. J. Stucky, NE NE SE section 28-20S-3W, McPherson County, Kansas. The same zone is also found on two other sets of logs in the area Hinkle No. 1 Goering, SW NW NW section 28-20S-3W, where the zone is found from 2,522-2,544 feet with 20 feet of porosity and the Brunson No. 1 Stucky, SW NW SE section 33-20S-3W, which shows porosity in the same zone from 2,560-2,580 feet with 8 feet of good porosity. A sample description of the Sinclair-Prairie No. 3 D. J. Stucky describes the formation as having good oolitic porosity with no stain. This zone is a borderline case and may make water, however, it should be tested before final abandonment of the leases.

Very truly yours,

H. A. Merrill

By:

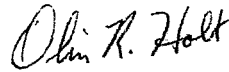

Olin R. Holt

QRH:HAM:ck

Mid-Continent District

AREA: Mid-Continent District

AFE No.: \_\_\_\_\_

LOC: Great Bend, Kansas

DATE: October 21, 1951

CASE, WELL NO. & FIELD: A.E. Morehouse Well No. 3 - Voshell

LOCATION: SE NE NE Section 4-21S-3W, McPherson County, Kansas

OBJECT: Plug back and recomplete in Mississippi Chat as gas well.

WELL

HISTORY: Completed May 19, 1930. Wilcox open hole 3340'-96', 15-1/2" csg. 70# @ 135' w/125 sacks, 8-1/4" 32# @ 2985' w/550 sacks, 6-5/8" 24# @ 3340' w/ 12 sacks. T.D. 3396'. January 1947 deepened to 3426' in Arbuckle. Top Arbuckle 3420'. Now producing 2 barrels oil and 190 barrels water per day.

PROCEDURE:

Move in casing pulling machine and pull rods, pump and tubing.  
Cut 6-5/8" casing at 3250' depth and retrieve from well. Stack separately from tubing and rods.  
Run tubing open ended to depth of 3130 feet and spot 35 sacks cement plug from 3130' to 3040 feet. WOCS  
Clean out well bore to top of hard cement.  
Spot 10 foot Hydromite plug (300 lbs.) with dump bailer on top of hard cement plug. Estimated top of plug should be at 3030'.  
Run tubing and packer set at 2970 feet and acidize Mississippi Chat from 2985'-3030' in open hole with 1000 gallons HCl.  
Swab back load and spurt acid water and test well.  
Retrieve packer and rerun tubing, rods and pump.  
Test well for gas productivity.

APPROVALS:

PREPARED BY:

H. A. Weinland  
Operations Engineer

H. A. Weinland

VOSHELL FIELD  
Producing Leases

<u>Lease &amp; Well No.</u>	<u>BOPD</u>	<u>BWPD</u>	<u>Formation</u>	<u>Comments</u>
<b>J.A. Krehbiel</b>				
#3	0	8	Mississippi	50 MCFD Gas
#4	0	0	Mississippi	50 MCFD Gas
#7	2.9	62	Arb. & Wilcox	Rec. Well be S.I.
<b>R.I. McCurdy</b>				
#3	4	185	Wilcox	
#4	4.9	95	Arb. & Wilcox	
#5	0	0	Mississippi	26 MCFD Gas
#7	7.9	369	Wilcox	
#8	7.9	421	Wilcox	
<b>A.E. Morehouse</b>				
#3	1.9	176	Arb. & Wilcox	To be recompleted
#4	16.9	132	Arb. & Wilcox	
#5	16.9	84	Arbuckle	
#6	0	0	Arb. & Wilcox	To be P&A - Csg. leak
#9	19.7	363	Arb. & Wilcox	
<b>D.J. Stucky</b>				
#1	<u>15.9</u>	<u>495</u>	Arbuckle	
<b>Total</b>	<b>98.9</b>	<b>2390</b>		

Estimated Remaining Reserves

<u>Lease</u>	<u>Gross</u>
J.A. Krehbiel	2000 Bbls.
R.I. McCurdy	49000 Bbls.
A.E. Morehouse	89000 Bbls. <i>Remaining</i>
D.J. Stucky	25000 Bbls.

Voshell Gross Remaining Oil Reserves

165000 Bbls.

(Est. Cost to electrify Eight Wells @ \$3,000 each - \$24,000)

*5000  
BOPD  
15.9  
315  
15.9  
2150*

*H.R. file* 

**Date:** October 21, 1971  
**To:** Mr. W. J. Rogers  
**From:** H. A. Weinland  
**Subject:** Recomplete A. E. Morehouse (3B-771B)  
Well No. 3 from Arbuckle and Wilcox  
Zones to Mississippi Chat Zone  
SE NE NE Sec. 4-T21S-R3W  
Voshell Field  
McPherson County, Kansas

I concur with Mr. J. J. Clark's proposal to recomplete A. E. Morehouse Well No. 3 in Mississippi Chat as a gas well. This well has depleted oil reserves in the Wilcox and Arbuckle formations. Present rate of production is 2 BOPD and 190 BWPD.

The casing record is shown on attached schematic sketch and indicates that 8-1/4" casing was set at 2985 feet and cemented with 550 sacks. The long string casing 6-5/8" O.D. was set at 3340 feet and cemented with only 12 sacks cement. Estimated top cement behind 6-5/8" casing is at 3254 feet.

It is recommended that 6-5/8" casing be pulled from well with an estimated recovery of approximately 3250 feet. A cement plug and Hydromite plug will be placed in open hole from 3130'-3030'. This plug will shut off Arbuckle and Wilcox formations and prevent extraneous water entry from below the Mississippi Chat. Detail recompletion prognosis is attached to this letter.

Total estimated cost is \$5600 with payout in 3.7 years and 13.6% rate of return.

*H. A. Weinland*

H. A. WEINLAND

HAW:lf

cc: H. F. Defenbaugh  
J. J. Clark  
File (2) ✓

*Apvd attached AFE  
and sent to HFD*

*10-28-71*

*WJF*

# K. G. S. LIBRARY

# COPY

WELL LOG BUREAU - KANSAS GEOLOGICAL SOCIETY

UNION NATIONAL BANK BLDG, WICHITA, KAN SAS

Location Sec NE  
225 ft Fr S.L. 257 ft fr E.L. E $\frac{1}{2}$  NE $\frac{1}{2}$  Sec. 4 T. 21 R. 3W.

Casing Record 10" Farm- A.E. Morehouse No. 1 County- McPherson

20" 8 $\frac{1}{4}$ " 3374' 2" Company- Sinclair Oil and Gas Co.  
15 $\frac{1}{2}$ " 129 65/8" Contr.- Mac & Stauffer.  
12 $\frac{1}{2}$ " 53/16" Comm.- 4-6-30 Comp.- 5-1-30

Total Depth 3425 Shot Quarts Between

Correspondence Regarding This Well Should Be Referred to

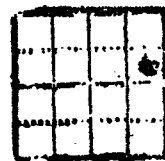

Figures Indicate Bottom of Formations.

Date Issued. 9-27-30

Elevation Initial Production 790 bbls

swabbed in 19 hours.

Depth.

Formation

soil	39
sand	69
shale	129
shale and lime&shells	329
lime and sand stone	620
shale	720
lime	800
shale	900
lime	950
shale and lime shells	1040
sdv shale	1260
shale and lime	1470
lime	1500
shale	1760
lime	1800
shale and stickey	1880
chalkey lime	1920
sdv lime	1950
shale stickey	2040
lime	2100
shale lime shells	2220
lime	2310
shale	2400
broken lime	2490
lime	2820
sdv shale	2850
gyp and shale	2910
sdv shale	2970
shale	3000
chalk white	3030
chat	3060
lime and chat	3090
lime	3120
lime red rock	3170
shale	3210
stickey shale	3250
slate and shale	3300
shale	3375
Viola lime	3379
sand	3410
sand	3425

Top Sand 3335'  
Bottom sand 3425'

MISS  
Kend

CSLM  
TD.

W/100 SXS

# K. G. S. LIBRARY

WELL LOG BUREAU - KANSAS GEOLOGICAL SOCIETY

UNION NATIONAL BANK BLDG, WICHITA, KANSAS

Location NE SE NE DEEPENING RECORD. Sec. 4 T. 21 R. 3W.  
990 fr S.L. 330 fr E.L. E $\frac{1}{2}$  NE $\frac{1}{2}$

Casing Record	10"	Farm- A.E. Morehouse	County- McPherson.
20"	8 $\frac{1}{4}$ " 3385	Company- Sinclair O&G Co.	No. 2
15 $\frac{1}{8}$ "	151 65/8"	Contr.- J.E. Mabee. Inc.	
12 $\frac{1}{8}$ "	53/16"	Comm.- 4-9-30	Comp.- 5-9-30
Total Depth	<b>3512</b>	Shot	Quarts Between

Correspondence Regarding This Well Should Be Referred to

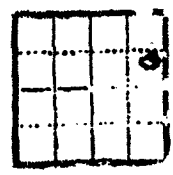

Figures Indicate Bottom of Formations. Initial Production 917 bbls  
Date Issued 8-31-35 swabbed 24 hrs.

Formation	Depth	Formation	Depth.
surface	20	shale	3195
water sand and shale	120	shale and lime shell	3255
sand and shale	148	shale	3385
lime and shale	151	lime	3387
shale and lime shells	700	shale	3399
lime	741	shale grey	3408
shale and lime shells	1451	show of oil	
shale and shells	1650	lime	hard 3425
lime	1700	lime	3430
shale and shells	1746	sdv white	3437
sdv shale	1760	lime	3458
sticky shale	1830	show of oil	
lime	1980	shale green	3465
shale	2015	Wilcox sand	3486
stic y shale	2100	shale blue	3488
lime	2200	Wilcox sand	3495
sand	2250	T.D.	
sdv shale	2375		
lime	2400	Top Wilcox sand 3465.	
sdv lime	2475	Bottom 3495.	
lime	2750		
shale	2785		
lime	2900	<b>DEEPENING RECORD.</b>	
shale and shells	2910		
lime	2920	Old T.D. 3495	
sdv lime	2970	Comm. 7-12-35 Comp. 7-25-35	
lime	2996	Prod. Pot. 345 B.O. 160 BW	
chat	3040	shale 3497- 3505 Arb.	
shale	3055	Lime siliceous 3512 T.D.	
shale and shell	3090		
shale and lime shells	3160	Top liner 3209	
		Bottom liner 3453	

STENCILED

WELL LOG BUREAU - KANSAS GEOLOGICAL SOCIETY

ORIGINAL

AUG 16

UNION NATIONAL BANK BLDG, WICHITA, KANSAS

WELL:  
UNION  
WICHITA

Location SW. SE NE

Sec. 4 T. 21 R. 3W.

Casing Record

10"  
20" 8 1/4" 3334'  
15 1/2" 126' 65/8"  
12 1/2" 53/16"

Farm- Morehouse No. 4  
Company- Sinclair Oil & Gas Co.  
Contr.- Mac & Stauffer.  
Comm.- 4/30/30. Comp.- 6/18/30.

County- McPherson.

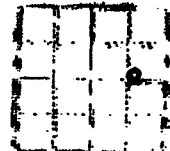

Total Depth 3437'  
Correspondence Regarding This Well Should Be Referred to

Shot Quarts Between

Figures Indicate Bottom of Formations.

Initial Production 520 bbls.  
Elevation

Date Issued. 8/16/1930

Formation Depth

slate	126
shale & lime shells	450
shale & lime	750
shale & lime	950
shale	1350
shale & lime	1500
shale	1700
brkn lime	1800
broken lime	1900
lime	2000
brkn lime	2070
lime	2100
lime	2130
shale	2160
lime & shale	2235
shale	2310
lime & shale	2370
sticky shale	2410
shale & lime	2470
shale	2520
Kansas City lime	2530
Kansas City lime	2730
lime	2800
shale	2900
shale	2945
brkn lime	2990
chat	3030
chat & lime	3070
lime & shale	3120
stickey shale	3170
shale	3200
shale	3230
shale	3280
shale	3334
lime Viola	3354
Hole reduced at 3350 from 8 1/4" to 6 5/8" csg.	
shale green	3356
Wilcox Sand	3365
Wilcox Sand	3367
Hole Filled up with oil.	
Wilcox sand	3405
Caving 3410	
sand	3410
lime top Sil lime	3429
lime hrd	3430
lime sft	3434
Sil. lime	3435
Sil lime	3437
Total Depth	3437

K. G. S. LIBRARY

Miss  
Kind

1/10

Will

As



SCREEN SETTING REPORT

KIND AND NUMBER OF SCRATCHERS USED

KIND AND NUMBER OF CENTRALIZERS USED

PACKER SET AT

DATE SET

SIZE AND KIND OF PACKER

1ST FEET

19

2ND FEET

19

DRILL STEM TESTS

DATE	PACKER SET AT DEPTH	FORMATION		SIZE CHOKE		TOOL OPEN MIN.	FORMATION PRES.		RECOVERY - FEET				WAS TEST SATIS.	
		FROM	TO	TOP	BOTTOM		FLOWING	SHUT-IN	OIL	WATER	MUD	OTHER		

WAS ANY JUNK EQUIPMENT TOOLS OR PIPE LEFT IN HOLE AT COMPLETION OF DRILLING?

REMARKS: Rig commenced 4/29/30, rig completed 5/8/30. Bowen Rig Contractor. Well completed June 9th swabbed 800 bbls. in 24 hrs. Well tested 12/19/36 24 bbls. oil 10 bbls. water.

PLUGBACK AND PLUGGING RECORD

DATE	TYPE PLUG	FROM	TO

APPROVED:

\_\_\_\_\_  
DISTRICT SUPERINTENDENT

\_\_\_\_\_  
DIVISION SUPERINTENDENT

\_\_\_\_\_  
ENGINEER - GEOLOGIST

(SHOW ALL MEASUREMENTS FROM SURFACE LEVEL)

FORMATION	TOTAL DEPTH	FORMATION	TOTAL DEPTH
Clay & Sand	100	Lime	2835
Sand & Shale	145	Shale	2945
Sand & <del>lime</del> Shale	355	Broken Lime	2965
Broken Lime	430	Shale	2985
Shale & shells	750	Chat	3060
Snad & lime	870	Shale & Shells	3086
Shale	1055	Shale	3135
Shale & Lime shells	1165	Viola Lime	3346
Shale & shells	1455	Lime	3357
Shale	1700	Shale & sand	3363 Green
Shale & shells	1900	Wilcox sand	3394
Lime & shale	1975	Green Shale	3409
Shale & lime shells	2035	Sandy Shale	3417
Lime	2185	Sand Hard	3424
Shale	2260		
Sand	2290		
Sand & Lime	2950		
Lime	2400		
Sand	2445		
Lime	2550		
Sand Lime	2595		
Lime	2750		
Broken Lime	2795		

Cleaned out 11/12/31 to 8/12/31 8 1/2" casing at 3341'. Production before 50 bbls. Prod. after 218 bbls. Wilcox 3363' to 3424'. Drillers-Long, Mason. Helper Kingsley & Brodgin. Well shot w/20 qts. cleaned out & completed for inc. of 168 bbls. 2/15/34 to 3/9/34 C.O. maws. before 3414 after 3424'. Pro. before 150 bbls. after 225 bbls. oil & 125 wate shot w/20 qts. 3378-3398' on 2/21/34 1 contr. lead woc

and filled up hole 1'. No water before CO & shooting had 125 bbls. wtr. in 24 hrs. afterwar inc. 75 bbls. oil and 125 bbls. s wtr.

CLEAN OUT RECORD. AE #1693 Prodn. 18 oil, 25-30 wtr. Tract Well Svc. moved in 8/12/1947. Cleaned out to bottom, 6 hrs. swab ter made 30 oil, 15 wtr. Est. well od for 70 bbls. oil & 30 wtr. daily. Completed work 8/22/1947. Later: on 24 hr. test made 6 oil & 76 wtr.

COPY

SINCLAIR OIL & GAS CO.  
A. R. Mer. house No. 8.

SEC. 4 T. 21 R. 3W  
SE NW NE  
330' fr SL 990' fr WL NW LF

DEEPENING RECORD  
CORRECTED LOG

Total Depth. 4430  
Comm. 6- 1-30 Comp. 7- 2-30  
Shot or Treated.  
Contractor. J.E. Mabee.  
Issued. 5-4-40

County McPherson.

CASING.

12 1/2" 150'  
6 5/8" 3336'  
5 1/2" 3510'

K. G. S. LIBRARY

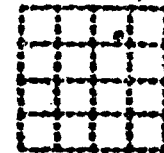

Elevation.

Production. 576 B.

Figures Indicate Bottom of Formations.

sand	90	lime	2649	sand & lime	4342
sand and gravel	150	lime & shale	2887	lime	4351
sand	200	shale & shells	2934	conglomerate	4353
sand and gravel	350	shale	2974	lime	4358
lime and shale	450	chat	3030	conglomerate	4418
lime shells & shale	810	shale	3245	granite Wash	4430
sandy shale	900	lime & shells	3280		
lime shells	960	lime	3287		
sandy shale	980	shale	3326	Total Depth.	
shale & shells	1150	lime Viola	3355	White drilling cement water	
shale & lime shells	1200	sand Wilcox	3382	broke thru at 3525.	
shale & lime shells	1330	shale green	3392	After C.C. to btm. fluid	
shale and lime shells	1500	Total Depth.		stood 600' fr Top and was	
shale sticky	1530			unable to swab down.	
shale & lime shells	1680	<u>DEEPENING RECORD.</u>		Tosted intake capacity	
shale sticky	1722	SINCLAIR PRAIRIE OIL CO.		on Oct. 2, 1939 pumped wtr	
sticky shale	1760	Comm. 5-29-39		into well. thru a 2 1/2"	
shale and shells	1787	Comp. 8- 1-39		line for 4 hrs. Took 225	
shale and shells	1837	Prod. Disposal Well.		bbl water an hr for 4hrs.	
shale & shells	1850	Kirk-Groon-Way -Cable		Fluid level remaining at	
lime	1867	dolomite	3404	600' so well did not fill	
shale and shells	1960	sand	3411	any. Began disposing of	
broken lime	2025	lime	3433	water from S.P.O. Co. loose	
lime shells	2058	shale blue	3435	into this well on April	
shale lime shells	2083	(Oil level 225)		13, 1940.	
lime	2090	lime	3501		
shale lime shells	2100	(water level at 1400)			
shale and shells	2158	hole caving at 3441.			
shells and shells	2288	sand	3506		
lime	2300	lime	3539		
sticky shale	2306	sdv lime	3555		
sticky shale	2341	lime	3702		
shale & shells	2354	sdv lime	3709		
shale	2365	lime	3793		
lime	2400	sdv lime	3801		
shale and shells	2426	sand white	3809		
lime	2456	sand	3816		
lime and shells	2504	lime	3928		
sticky shale	2530	lime	3974		
shale & lime	2582	sdv lime	3981		
sand hard	2592	broken lime	3988		
shale	2602	lime	4266		
shale and lime hard	2625	lime hard	4273		
shale and shells	2668	lime	4280		
lime and shale	2708	sdv lime	4296		
shale and shells	2728	lime	4303		
lime	2741	sdv lime	4308		
lime and shale	2818	lime	4317		
		sand	4323		
		lime	4330		
		lime and sand	4335		
		sand	4339		

## UNION NATIONAL BANK BLDG, WICHITA, KANSAS

Location NW NE NE.

Sec. 4 T. 21 R. 3W.

Casing Record  
 20" 10"  
 15 1/2" 8 1/4"  
 12 1/2" 156' 65/8"  
 12 1/2" 53/16"  
 Total Depth 3325'

Farm- Moorehouse No. 9  
 Company- Sinclair Oil & Gas Co.  
 Contr.- J. E. Noble  
 Comm.- 5/21/30  
 Shot Quarts Between  
 Comp.- 7/10/30.

County- McPherson.

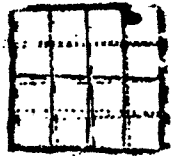

Figures Indicate Bottom of Formations.  
 Date Issued. 8/16/1930

Elevation  
 Initial Production 525 bbls.

Formation	Depth
sand & lime shells	158
shale & lime shells	666
shale & shells	920
shale & lime shells	1110
shale	1490
shale & shells	1550
lime	1575
shale & shells	1605
shale & shells	1725
broken lime	1835
broken lime	2000
lime	2060
shale & shells	2110
shale	2190
shale & lime shells	2270
shale & lime shells	2330
shale & lime	2410
sand	2500
shale & lime	2545
lime	2600
lime	2750
shale & lime	2770
lime	2820
shale & lime	2855
shale	2890
shale	2980
chat	3040
shale	3212
shale	3219
lime	3227
shale	3247
cherty dolomite	3260
lime Viola	3290
shale green & sand	3298
sand	3325
Total Depth	3325'

K. G. S. LIBRARY

**Subject Property**

A

Parcel ID :	0592320400000001000	<a href="#">Click here to locate on Map</a>
Owner Name :	Peterson, Milruth A Trust	No property photo available
Location :	1459 CHISHOLM RD, McPherson, KS 67460.	
Legal Desc :	S04, T21, R03, ACRES 111.3, E2 NE4 & NW4 NE4 LESS R/W.	

*The legal description displayed above is not adequate for use in legal documents*

**Owner Information**

Owner :	Mailing Address :
Peterson, Milruth A Trust	505 S Estates Dr Salina, KS 67401
KREHBIEL, PAUL R & CONNIE	
KREHBIEL, DARRELL K & MARY LIV TRUST - TTEE	

**Property Details**

Property Type :	Property Status :	Taxing Unit :	Neighborhood Code :
Agricultural Use	Active	251	963.L

**Market Land Details**

Actual Width :	Eff Width :	Eff Depth :	Acres :	Square Feet :

No Permit Details found.

**Value Details**

Current Final Value (Agricultural) :	Year :	2011
	Land :	\$17,620
	Building :	\$0
	Total :	\$17,620

**Deed Book/Page**

Book / Page List and Misc Legal Description Info :

Book/Page D652/3661 D652/3648 D652/3255 M647/6785 D231/606 D203/647

No Sale Details found. (Please log in to view this data.)

**Subject Property**

B

Parcel ID : 0592320300000003000

[Click here to locate on Map](#)

Owner Name : STUCKY, CLARENE H TRUST TTEE

No property photo available

Location : 00000 CHISHOLM RD, McPherson, KS 67460.

Legal Desc : S03, T21, R03, ACRES 141.2, NW4 LESS ROW & EX THAT PT OF TR CA SW/C NW4 TH E320' FOR POB TH SELY49' S122' SELY94' NELY145' ELY122' NELY356' NLY586' W448' SWLY124' W185' SELY 540' TO POB.

*The legal description displayed above is not adequate for use in legal documents*

**Owner Information**

Owner :

Mailing Address :

STUCKY, CLARENE H TRUST TTEE

532 PARK CT MOUNDRIDGE, KS 67107

**Property Details**

Property Type :

Property Status :

Taxing Unit :

Neighborhood Code :

Agricultural Use

Active

250

963.L

**Market Land Details**

Actual Width :

Eff Width :

Eff Depth :

Acres :

Square Feet :

No Permit Details found.

**Value Details**

Current Final Value (Agricultural) :

Year : 2011

Land : \$26,710

Building : \$0

Total : \$26,710

**Deed Book/Page**

Book / Page List and Misc Legal Description Info :

Book/Page D258/189 D231/235 D230/606 D230/604

No Sale Details found. (Please log in to view this data.)

**Subject Property**

C

Parcel ID :	0592320300000003010	<a href="#">Click here to locate on Map</a>
Owner Name :	KOLLER, JEFFERY W &REBECCA	No property photo available
Location :	1537 CHISHOLM RD, McPherson, KS 67460.	
Legal Desc :	S03, T21, R03, ACRES 10.9, CA SW/C NW4 TH E320' FOR POB TH SELY49' S122' SELY94' NELY145' ELY122' NELY356' NLY586' W448' SWLY124' W185' SELY540' TO POB.	

*The legal description displayed above is not adequate for use in legal documents*

**Owner Information**

Owner :	Mailing Address :
KOLLER, JEFFERY W &REBECCA	1537 CHISHOLM RD MCPHERSON, KS 67460

**Property Details**

Property Type :	Property Status :	Taxing Unit :	Neighborhood Code :
Residential	Active	250	963.L

**Market Land Details**

Actual Width :	Eff Width :	Eff Depth :	Acres :	Square Feet :
			10.93	

No Permit Details found.

**Value Details**

Current Final Value (Residential) :	Year :	2011
	Land :	\$53,710
	Building :	\$95,620
	Total :	\$149,330

**Deed Book/Page**

Book / Page List and Misc Legal Description Info :

Book/Page D256/259 D256/255 D255/491

No Sale Details found. (Please log in to view this data.)

**Subject Property**

D

Parcel ID :	0592320300000005000	<a href="#">Click here to locate on Map</a>
Owner Name :	STUCKY, CLARENE H TRUST ETAL - TTEE	No property photo available
Location :	00000 CHEYENNE RD, McPherson, KS 67460.	
Legal Desc :	S03, T21, R03, ACRES 76.5, W2 SW4 LESS ROW & EX THAT PT O F TR CA SW/C NW4 TH E320' FOR POB TH SELY49' S122' SELY94' NELY145' ELY122' NELY356' NLY586' W448' SWLY124' W185' SELY540' TO POB.	

*The legal description displayed above is not adequate for use in legal documents*

**Owner Information**

Owner :	Mailing Address :
STUCKY, CLARENE H TRUST ETAL - TTEE	532 PARK CT MOUNDRIDGE, KS 67107

**Property Details**

Property Type :	Property Status :	Taxing Unit :	Neighborhood Code :
Agricultural Use	Active	250	963.L

**Market Land Details**

Actual Width :	Eff Width :	Eff Depth :	Acres :	Square Feet :
----------------	-------------	-------------	---------	---------------

No Permit Details found.

**Value Details**

Current Final Value (Agricultural) :	Year :	2011
	Land :	\$13,280
	Building :	\$0
	Total :	\$13,280

**Deed Book/Page**

Book / Page List and Misc Legal Description Info :
Book/Page D258/189 D228/056 D203/435 D193/625

No Sale Details found. (Please log in to view this data.)

**Subject Property**



Parcel ID : 0592320400000004010

[Click here to locate on Map](#)

Owner Name : ELDER, TERRY D & ANNETTE J

No property photo available

Location : 00000 CHEYENNE RD, McPherson, KS 67460.

Legal Desc : S04, T21, R03, ACRES 79.3, E2SE4 LESS ROW.

*The legal description displayed above is not adequate for use in legal documents*

**Owner Information**

Owner :

Mailing Address :

ELDER, TERRY D & ANNETTE J

416 LIBERTY DR MCPHERSON, KS 67460

**Property Details**

Property Type :

Property Status :

Taxing Unit :

Neighborhood Code :

Agricultural Use

Active

251

963.L

**Market Land Details**

Actual Width :

Eff Width :

Eff Depth :

Acres :

Square Feet :

No Permit Details found.

**Value Details**

Current Final Value (Agricultural) :

Year : 2011

Land : \$7,440

Building : \$0

Total : \$7,440

**Deed Book/Page**

Book / Page List and Misc Legal Description Info :

Book/Page D651/1265 D617/167 D247/350

Book :

Page :

651xxx

1265

No Sale Details found. (Please log in to view this data.)

**Subject Property**

F

Parcel ID : 0592320400000004020

[Click here to locate on Map](#)

Owner Name : STUCKY, JAMES E & TERRY S

No property photo available

Location : 1460 CHEYENNE RD, McPherson, KS 67460.

Legal Desc : S04 , T21 , R03 , ACRES 118.9 , SW4NE4 & W2SE4 LESS ROW.

*The legal description displayed above is not adequate for use in legal documents*

**Owner Information**

Owner :

Mailing Address :

STUCKY, JAMES E & TERRY S

1460 CHEYENNE RD MCPHERSON, KS  
67460

**Property Details**

Property Type :

Property Status :

Taxing Unit :

Neighborhood Code :

Residential

Active

251

963.L

**Market Land Details**

Actual Width :

Eff Width :

Eff Depth :

Acres :

Square Feet :

.89

**Permit Details**

Number :

Date :

Amount :

Purpose :

20925

6/2/2009

\$120,000

**Value Details**

Current Final Value (Agricultural) :

Year :

2011

Land :

\$22,680

Building :

\$0

Total :

\$22,680

Current Final Value (Farm Homesite) :

Year :

2011

Land :

\$11,540

Building :

\$132,590

Total :

\$144,130

**Deed Book/Page**

Book / Page List and Misc Legal Description Info :

Book/Page D643/4971 D643/1259 D617/357 D617/170

No Sale Details found. (Please log in to view this data.)

**Subject Property**

G

Parcel ID : 0592320400000002000

[Click here to locate on Map](#)

Owner Name : G & D TRUST; CASE, GALEN & DAVID TTEE

No property photo available

Location : 00000 CHISHOLM RD, McPherson, KS 67460.

Legal Desc : S04 , T21 , R03 , ACRES 152.5 , NW4 LESS ROW.

*The legal description displayed above is not adequate for use in legal documents*

**Owner Information**

Owner :

Mailing Address :

G & D TRUST; CASE, GALEN & DAVID  
TTEE

681 14TH AVE MCPHERSON, KS 67460

**Property Details**

Property Type :

Property Status :

Taxing Unit :

Neighborhood Code :

Agricultural Use

Active

252

963.L

**Market Land Details**

Actual Width :

Eff Width :

Eff Depth :

Acres :

Square Feet :

No Permit Details found.

**Value Details**

Current Final Value (Agricultural) :

Year : 2011

Land : \$35,810

Building : \$0

Total : \$35,810

**Deed Book/Page**

Book / Page List and Misc Legal Description Info :

Book/Page M641/9825 D641/455\* D640/9867 D210/023

No Sale Details found. (Please log in to view this data.)

**Subject Property**

H

Parcel ID :	0591883300000005000	<a href="#">Click here to locate on Map</a>
Owner Name :	GERING, WARREN G & DIANE	No property photo available
Location :	00000 CHISHOLM RD, McPherson, KS 67460.	
Legal Desc :	S33 , T20 , R03 , ACRES 80.1 , W2 SE4 LESS R/W.	

*The legal description displayed above is not adequate for use in legal documents*

**Owner Information**

Owner :	Mailing Address :
GERING, WARREN G & DIANE	269 WEBER RD RITZVILLE, WA 99169

**Property Details**

Property Type :	Property Status :	Taxing Unit :	Neighborhood Code :
Agricultural Use	Active	201	963.C

**Market Land Details**

Actual Width :	Eff Width :	Eff Depth :	Acres :	Square Feet :
----------------	-------------	-------------	---------	---------------

No Permit Details found.

**Value Details**

Current Final Value (Agricultural) :	Year :	2011
	Land :	\$15,600
	Building :	\$0
	Total :	\$15,600

**Deed Book/Page**

Book / Page List and Misc Legal Description Info :
Book/Page M644/3316 95PR/2786 D228/567 D199/126

No Sale Details found. (Please log in to view this data.)

**Subject Property**

I

Parcel ID :	0591883300000006000	<a href="#">Click here to locate on Map</a>
Owner Name :	Peterson, Milruth A Trust	No property photo available
Location :	00000 15TH AVE, McPherson, KS 67460.	
Legal Desc :	S33, T20, R03, ACRES 78.3, E2 SE4 LESS R/W.	

*The legal description displayed above is not adequate for use in legal documents*

**Owner Information**

Owner :	Mailing Address :
Peterson, Milruth A Trust	505 S Estates Dr Salina, KS 67401
KREHBIEL, PAUL R & CONNIE	
KREHBIEL, DARRELL K & MARY LIV TRUST - TTEE	

**Property Details**

Property Type :	Property Status :	Taxing Unit :	Neighborhood Code :
Agricultural Use	Active	201	963.C

**Market Land Details**

Actual Width :	Eff Width :	Eff Depth :	Acres :	Square Feet :

No Permit Details found.

**Value Details**

Current Final Value (Agricultural) :	Year :	2011
	Land :	\$13,840
	Building :	\$0
	Total :	\$13,840

**Deed Book/Page**

Book / Page List and Misc Legal Description Info :

Book/Page D652/3661 D652/3648 D652/3255 M647/6785 D231/606 D109/153

No Sale Details found. (Please log in to view this data.)

**Subject Property**

J

Parcel ID :	0591883400000005020	<a href="#">Click here to locate on Map</a>
Owner Name :	KREHBIEL, DARRELL K & MARY LIV TRUST - TTEE	No property photo available
Location :	00000 CHISHOLM RD, McPherson, KS 67460.	
Legal Desc :	S34, T20, R03, ACRES 72.3, CA SW/C SE4SE4 FOR POB TH W926 NWLY232.7' W479.9' N701.3' W91 .2' WLY230.7' SLY502.2' E344.3 S397.4' W1157' N1335' E2650' S1324' TO POB LESS ROW.	

*The legal description displayed above is not adequate for use in legal documents*

**Owner Information**

Owner :	Mailing Address :
KREHBIEL, DARRELL K & MARY LIV TRUST - TTEE	26002 ROSE LN CHANTILLY, VA 20152

**Property Details**

Property Type :	Property Status :	Taxing Unit :	Neighborhood Code :
Agricultural Use	Active	201	963.C

**Market Land Details**

Actual Width :	Eff Width :	Eff Depth :	Acres :	Square Feet :
----------------	-------------	-------------	---------	---------------

No Permit Details found.

**Value Details**

Current Final Value (Agricultural) :	Year :	2011
	Land :	\$15,620
	Building :	\$0
	Total :	\$15,620

**Deed Book/Page**

Book / Page List and Misc Legal Description Info :
Book/Page D642/7115 D210/124 D206/176 D206/090

No Sale Details found. (Please log in to view this data.)

**Subject Property**



Parcel ID :	0591883400000003000	<a href="#">Click here to locate on Map</a>
Owner Name :	KREHBIEL, PAUL R & CONNIE	No property photo available
Location :	00000 15TH AVE, McPherson, KS 67460.	
Legal Desc :	S34 , T20 , R03 , ACRES 78.3 , W2 SW4 LESS R/WS.	

*The legal description displayed above is not adequate for use in legal documents*

**Owner Information**

Owner :	Mailing Address :
KREHBIEL, PAUL R & CONNIE	8031 BOSTON SCHOOL RD MINIER, IL 61759

**Property Details**

Property Type :	Property Status :	Taxing Unit :	Neighborhood Code :
Agricultural Use	Active	201	963.C

**Market Land Details**

Actual Width :	Eff Width :	Eff Depth :	Acres :	Square Feet :
----------------	-------------	-------------	---------	---------------

No Permit Details found.

**Value Details**

Current Final Value (Agricultural) :	Year :	2011
	Land :	\$19,830
	Building :	\$0
	Total :	\$19,830

**Deed Book/Page**

Book / Page List and Misc Legal Description Info :
Book/Page D210/122 D206/175 D206/091

No Sale Details found. (Please log in to view this data.)

**Subject Property**

L

Parcel ID :	0591883400000005010	<a href="#">Click here to locate on Map</a>
Owner Name :	KAUFMAN, ROBERT L & JOLENE	No property photo available
Location :	1548 CHISHOLM RD, McPherson, KS 67460.	
Legal Desc :	S34 , T20 , R03 , ACRES 4.3 , CA SW/C SW4 TH E2484' FOR POB TH N397.4' W344.3' NLY502.2' NELY230.7' E91.2' S927.2' W30' TO POB LESS ROW	

*The legal description displayed above is not adequate for use in legal documents*

**Owner Information**

Owner :	Mailing Address :
KAUFMAN, ROBERT L & JOLENE	1842 IRON HORSE RD MCPHERSON, KS 67460

**Property Details**

Property Type :	Property Status :	Taxing Unit :	Neighborhood Code :
Residential	Active	201	963.C

**Market Land Details**

Actual Width :	Eff Width :	Eff Depth :	Acres :	Square Feet :
			3.81	

No Permit Details found.

**Value Details**

Current Final Value (Agricultural) :	Year :	2011
	Land :	\$120
	Building :	\$13,060
	Total :	\$13,180
Current Final Value (Farm Homesite) :	Year :	2011
	Land :	\$23,800
	Building :	\$96,700
	Total :	\$120,500

**Deed Book/Page**

Book / Page List and Misc Legal Description Info :

Book/Page D640/9522

**No Sale Details found. (Please log in to view this data.)**

**Subject Property**

M

Parcel ID : 0591883400000005000

[Click here to locate on Map](#)

Owner Name : KAUFMAN, STACY L & TONYA

No property photo available

Location : 1556 CHISHOLM RD, McPherson, KS 67460.

Legal Desc : S34 , T20 , R03 , ACRES 2.2 , CA SW/C SW4 TH E2514' FOR POB TH N225.9' E479.9' SELY232.7' W539.9' TO POB LESS ROW.

*The legal description displayed above is not adequate for use in legal documents*

**Owner Information**

Owner :

Mailing Address :

KAUFMAN, STACY L & TONYA

1556 CHISHOLM RD MCPHERSON, KS  
67460

**Property Details**

Property Type :

Property Status :

Taxing Unit :

Neighborhood Code :

Residential

Active

201

963.C

**Market Land Details**

Actual Width :

Eff Width :

Eff Depth :

Acres :

Square Feet :

.69

No Permit Details found.

**Value Details**

Current Final Value (Agricultural) :

Year :

2011

Land :

\$320

Building :

\$10,790

Total :

\$11,110

Current Final Value (Farm Homesite) :

Year :

2011

Land :

\$10,700

Building :

\$164,040

Total :

\$174,740

**Deed Book/Page**

Book / Page List and Misc Legal Description Info :

No Sale Details found. (Please log in to view this data.)

**Subject Property**



Parcel ID :	0592320300000006020	<a href="#">Click here to locate on Map</a>
Owner Name :	KOLLER, JEFFERY W & REBECCA	No property photo available
Location :	00000 CHEYENNE RD, Moundridge, KS 67107.	
Legal Desc :	S03 , T21 , R03 , ACRES 45.1 , E2SW4 & W2SE4 LYING N & W OF TURKEY CR	

*The legal description displayed above is not adequate for use in legal documents*

**Owner Information**

Owner :	Mailing Address :
KOLLER, JEFFERY W & REBECCA	1537 CHISHOLM RD MCPHERSON, KS 67460

**Property Details**

Property Type :	Property Status :	Taxing Unit :	Neighborhood Code :
Agricultural Use	Active	250	963.L

**Market Land Details**

Actual Width :	Eff Width :	Eff Depth :	Acres :	Square Feet :
----------------	-------------	-------------	---------	---------------

No Permit Details found.

**Value Details**

Current Final Value (Agricultural) :	Year :	2011
	Land :	\$8,320
	Building :	\$0
	Total :	\$8,320

**Deed Book/Page**

Book / Page List and Misc Legal Description Info :
Book/Page D264/227

No Sale Details found. (Please log in to view this data.)