

1500 SW Arrowhead Road  
Topeka, KS 66604-4027



202106011502527482  
Filed Date: 06/01/2021  
State Corporation Commission  
of Kansas

Phone: 785-271-3100  
Fax: 785-271-3354  
<http://kcc.ks.gov/>

Andrew J. French, Chairperson  
Dwight D. Keen, Commissioner  
Susan K. Duffy, Commissioner

Laura Kelly, Governor

June 1, 2021

Oscar Mattocks - Operations Agent  
Caney Valley Electric Coop. Assn., Inc.  
P.O. Box 308  
Cedar Vale, KS 67024

Dear Mr. Mattocks:

Your EL No. 39894 has been reviewed and approved. Enclosed is a copy of the location map bearing the approval notation and the date of approval.

A handwritten signature in blue ink that reads "Jason W. Kerr". The signature is written in a cursive style with a long, sweeping underline.

Jason W. Kerr  
Electric Utility Engineer Technician

JWK:can  
Enc.

MAR 25 2021

KANSAS CORPORATION COMMISSION  
UTILITIES DIVISION

Utilities Division

## OFFICIAL FORM "EL"

Before the State Corporation Commission of the State of Kansas

In The Matter of The Application of: The Caney Valley Electric Cooperative Assn., Inc. "EL" No. 39894  
Applicant Assigned by the Commission

## Location of Proposed Electric Supply Line Construction

Section: 29 Township: 33S Range: 10E  
County: Chautauqua Applicant's Unique Identification No.: 4073  
Describe briefly: Retire 2,425 ft primary line

\* Applicant's identification of application and related papers.

## APPLICATION

Comes now The Caney Valley Electric Cooperative Association, Inc.  
ApplicantOf Cedar Vale, KS, A Corporation  
City/State Corporation, Partnership, Individual or Municipality

requesting the Commission to approve the operating characteristics, physical properties and location of proposed electric line, or change in electric line construction, located outside the corporate limit of any city, as shown on the accompanying map and as hereinafter more fully described.

The operating characteristics of this line are to be:

Operating Voltage 7.2K Volts, 1 Phase, 60 Hertz, Design Load 30 kiloWatts,  
Design Voltage \_\_\_\_\_ Volts, Phase-to-Phase Voltage \_\_\_\_\_ Volts, Number of Conductors \_\_\_\_\_  
7.2/12.4 KV - connected Y to neutral - two wires - all poles grounded

Type of configuration [e.g. grounded wye] and points of grounding.

The description of the location and points between which said proposed line is to be installed and operated are as follows:

Retire 2,425 ft. primary line in the NE 1/4 of Section 29, Twp. 33, Range 10, in Chautauqua County, as shown in red on attached sketch.

## Physical Properties of Line

Structures: Kind SPW, Height (ft) 35, Class 6 Conductor: Type ACSR, Size 4, Average Span (ft): 303  
(See NOTE below) (e.g., ACSR)Has clearance been provided for other utilities? ☒ Yes ☐ NoCost estimate: \$ 8,000.00 Number and type of customers: 3 rural commercial - oil accounts

NOTE - Please use the following abbreviations for predominate structure kind:

SPW - Single Pole, Wood SPF - Single Pole, Fiberglass TS - Tower, Steel SPS - Single Pole, Steel HFW - H-Frame, Wood  
O - Other (please explain): \_\_\_\_\_ SPC - Single Pole, Concrete HFS - H-Frame, Steel N/A - Not Applicable

Name:	Address:

Is a Railroad within 1/2 mile of the contemplated construction? ☐ Yes ☒ No

- Whenever the proposed line is to be located on private right-of-way, the land owner's lawful consent will be obtained;
- "Inductive coordination" has been or will be complied with as related specifically in K.A.R. 82-12-9;
- All utilities and railroads listed above have been notified in writing (a copy of which is attached) as provided in K.A.R. 82-12-5 and that such notice contains the statement that "if there is any objection to the Applicant's proposed line construction, such objection shall be forwarded to the State Corporation Commission within the time specified in K.A.R. 82-12-5 from date of notice."

Signed at: Cedar Vale, KS, this 10 day of August, 2020  
City, State Day Month Year

*Applicant*

Lear Mattocks

Signature and Title of Officer

Oscar Mattocks, Operations Agent

**Submit 1 copy of Application along with:**

- Detailed map (scale not less than 1 inch per mile). On map, please provide locations of existing applicant-owned lines in sufficient detail to determine relative location(s) of proposed line(s).
- Copies of all notices to other utilities.
- Cost breakdown of "cost estimate" by units of property.

**Submit completed documents into Docket 21-GIME-005-CPL**

Email ESR! shapefile to: [shapefile@kcc.ks.gov](mailto:shapefile@kcc.ks.gov)

- Shapefile fields should contain: Company Name, County, Work Order No., Section, Township, Range, and Phase.

**FOR OFFICIAL KCC USE ONLY**

**APPROVED**

Plotted by:  
**By Jason Kerr at 10:11 am, May 24, 2021**

Date Approved: April 8, 2021



APPROVED  
THE STATE CORPORATION COMMISSION  
OF KANSAS

EL 39894

DATE April 8, 2021

By [Signature] Engineer

**The Caney Valley Electric Cooperative Ass'n., Inc.**

Phone 758-2262

August 10, 2020

Cedar Vale, Kansas 67024

Gentlemen:

To conform with Rule 202 of the Wire Stringing Rules of the State Corporation Commission, we are notifying you of the proposed changes in our electric supply line as described below. If there is an objection to this proposed change, such objection should be forwarded to the State Corporation Commission within the time specified in Rule 202(A) of the Wire Stringing Rules.

Very truly yours, [Signature]

THE CANEY VALLEY ELECTRIC COOP. ASS'N., Inc

Oscar Mattocks,  
Operations Agent

Nature of Change Retire 2,425' Primary Line

Land Description  
County Chautauqua  
Township 33  
Range 10  
Section 29

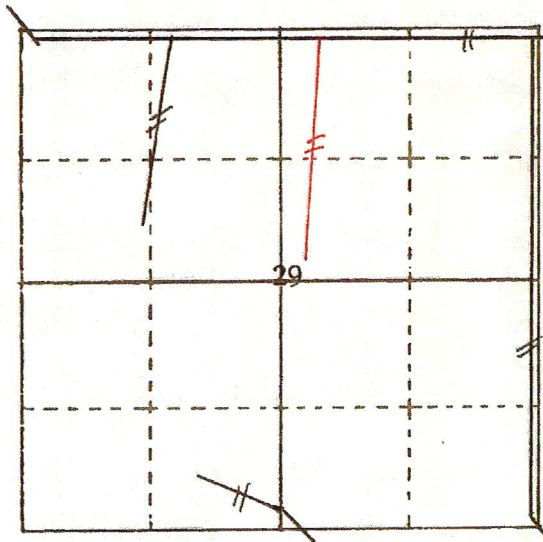

Line Characteristics  
Voltage 7200  
Phase 1Ø  
Cycle 60

EL 39894

**The Caney Valley Electric Cooperative Ass'n., Inc.**

Phone 758-2262

August 10, 2020

Cedar Vale, Kansas 67024

Gentlemen:

To conform with Rule 202 of the Wire Stringing Rules of the State Corporation Commission, we are notifying you of the proposed changes in our electric supply line as described below. If there is an objection to this proposed change, such objection should be forwarded to the State Corporation Commission withing the time specified in Rule 202(A) of the Wire Stringing Rules.

Very truly yours, *Oscar Mattocks*

THE CANEY VALLEY ELECTRIC COOP. ASS'N., Inc

Oscar Mattocks,  
Operations Agent

Nature of Change Retire 2,425' Primary Line

**Land Description**

County Chautauqua

Township 33

Range 10

Section 29

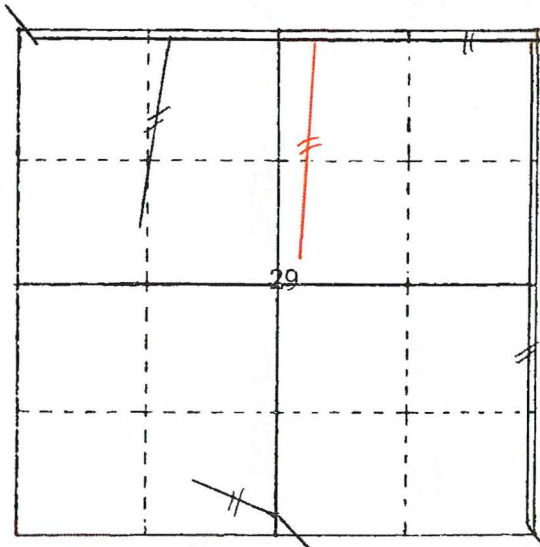

**Line Characteristics**

Voltage 7200

Phase 1Ø

Cycle 60