

**BEFORE THE STATE CORPORATION COMMISSION
OF THE STATE OF KANSAS**

IN THE MATTER OF THE APPLICATION OF)
EVERGY KANSAS CENTRAL, INC. FOR A)
CERTIFICATE OF PUBLIC CONVENIENCE)
AND AUTHORITY TO TRANSACT THE)
BUSINESS OF AN ELECTRIC PUBLIC UTILITY))
DEFINED AS MIDIAN TO TC BURNS TAP)
TRANSMISSION LINE PROJECT IN)
BUTLER COUNTY, KANSAS)

Docket No. 20-WSEE-234-COC

**APPLICATION FOR A CERTIFICATE OF PUBLIC CONVENIENCE AND
AUTHORITY TO TRANSACT THE BUSINESS OF AN ELECTRIC PUBLIC UTILITY,
TRANSMISSION RIGHTS ONLY**

COMES NOW, Evergy Kansas Central Inc. d/b/a Evergy Kansas Central (“Evergy Kansas Central”), and in support of its Application for a Certificate of Public Convenience and Authority, for Transmission Rights only, states:

1. Evergy Kansas Central is a Kansas corporation authorized by the Commission to conduct the business of a public utility under the provisions of K.S.A. 66-104, and as such holds a Certificate of Convenience and Authority from this Commission to engage in the business of an electric public utility in the State of Kansas, thereby promoting public convenience.

2. Evergy Kansas Central seeks, subject to the Commission’s approval, transmission rights only in the Butler Rural Electric Cooperative, Inc. (Butler Rural Electric) certified territory described below:

BUTLER COUNTY, KANSAS

Beginning in the Evergy Kansas Central service area, the southern section of the route will begin at the Midian Substation, in the NE/4 S6-T26S-R5E. The line extends northeast through the E/2 S31-T25S-R5E, the E/2 S30-T25S-R5E, the W/2 S20-T25S-R5E, the SW/4 & NE/4 S17-T25S-R5E and the E/2 S8-T25S-R5E. The line turns more northeast and goes through the SW/4 & NE/4 S4-T25S-R5E and the SE/4 S33-T24S-R5E. The line then enters the SW/4 S34-T24S-R5E and the bottom part of the NW/4 S34-T24S-R5E where the Evergy Kansas Central service area ends.

The line continues northeast and enters the Butler Rural Electric service area in the NW/4 S34-T24S-R5E and turns north in the same ¼ section. The line continues north through the middle of S27-T24S-R5E and S22-T24S-R5E. The line enters the middle of S15-T24S-

R5E, turns northeast in the NE/4 of that section and enters the SE/4 S10-T24S-R5E and continues through the NW/4-S11-T24S-R5E. This line rebuild ends in the northern edge of the NW/4 S11-T24S-R5E at the TC Burns Tap.

3. Evergy Kansas Central is requesting transmission rights in the above territory replacing aging infrastructure and converting to new voltage to serve a new customer. See Maps Exhibit A and B.

4. A copy of this application is being served on Butler Rural Electric by delivery of United States Mail, postage prepaid, addressed as follows:

Butler Rural Electric Cooperative, Inc.
Jeff Leckliter
216-218 South Vine Street
P. O. Box 1242
El Dorado, Kansas 67042

There is no other person or entity, corporate, municipal or otherwise that requires notice of this Application.

THEREFORE, Evergy Kansas Central requests that an Order be issued, granting Evergy Kansas Central the authority for transmission rights only in the territory described in paragraph 2 above.

Evergy Kansas Central, Inc.

BY:

Cathryn J. Dinges
Cathryn J. Dinges, S.Ct. #20848
Corporate Counsel
818 S. Kansas Avenue
P.O. Box 889
Topeka, Kansas 66601-0889
PHONE: (785) 575-8344
FAX: (785) 575-8136

ITS ATTORNEY

STATE OF KANSAS)
)
COUNTY OF SHAWNEE) ss

Cathryn J. Dinges, of lawful age, being first duly sworn upon oath, deposes and states:

That she is the attorney for the within named applicant, that she has read the above and foregoing Application and that the statements therein contained are true according to her knowledge and belief.

Cathryn J. Dinges
Cathryn J. Dinges

Subscribed and sworn to before me this 26th day of November 2019.

Leslie R. Wines
Notary Public

My Appointment Expires:

May 30, 2022

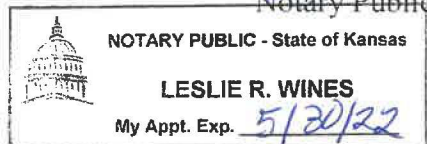

SCC FORM "EL" APPLICATION SKETCH

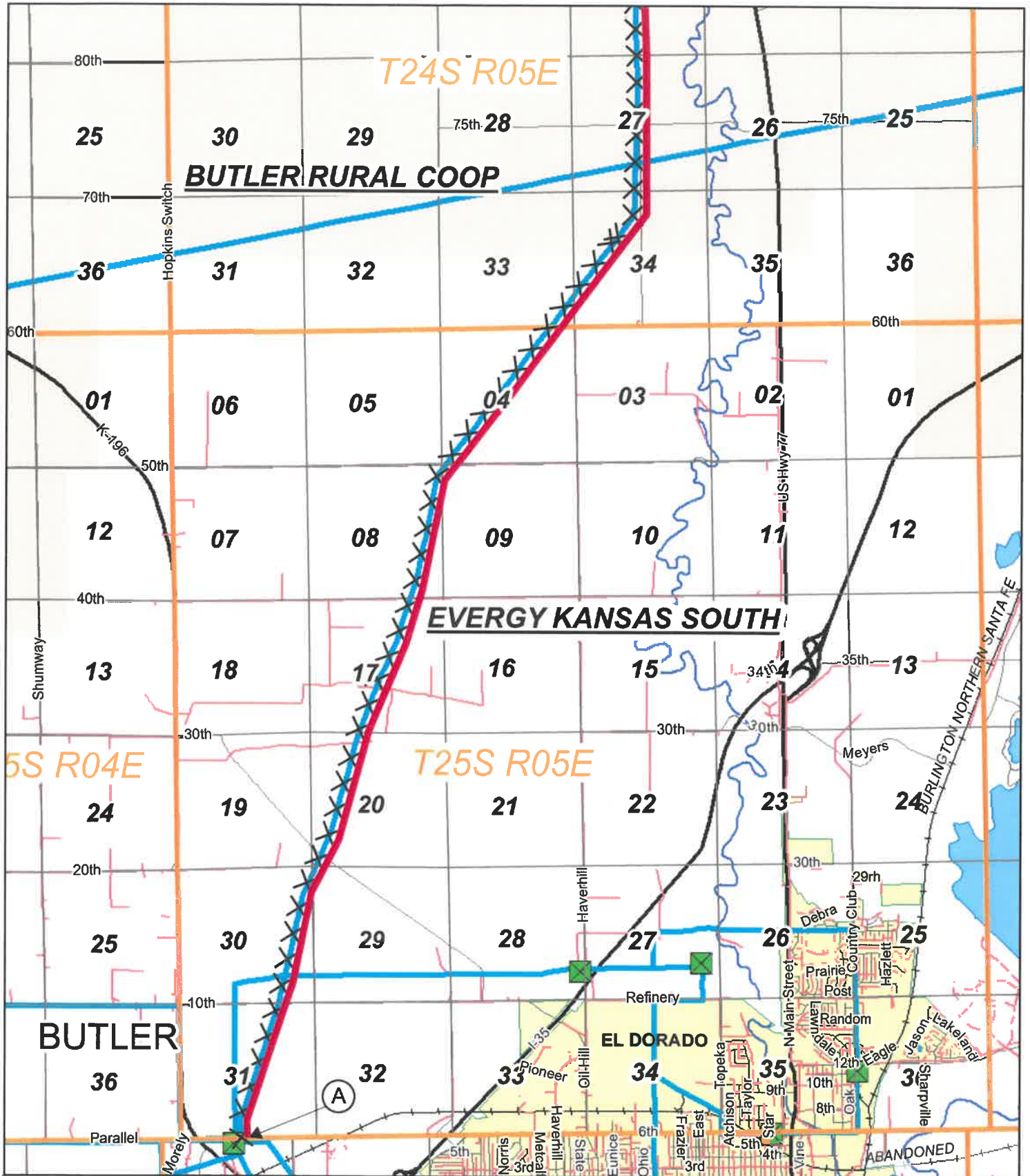

Think Safety!



Removal & Installation of 138,000 kV Transmission

BY Jessica Keck

WR # P25417

Crew HQ 3301

Date 10/15/2019

Scale 1" = 2,640'

Page 1

Proposed

Application Number L-3648

SCC FORM "EL" APPLICATION SKETCH

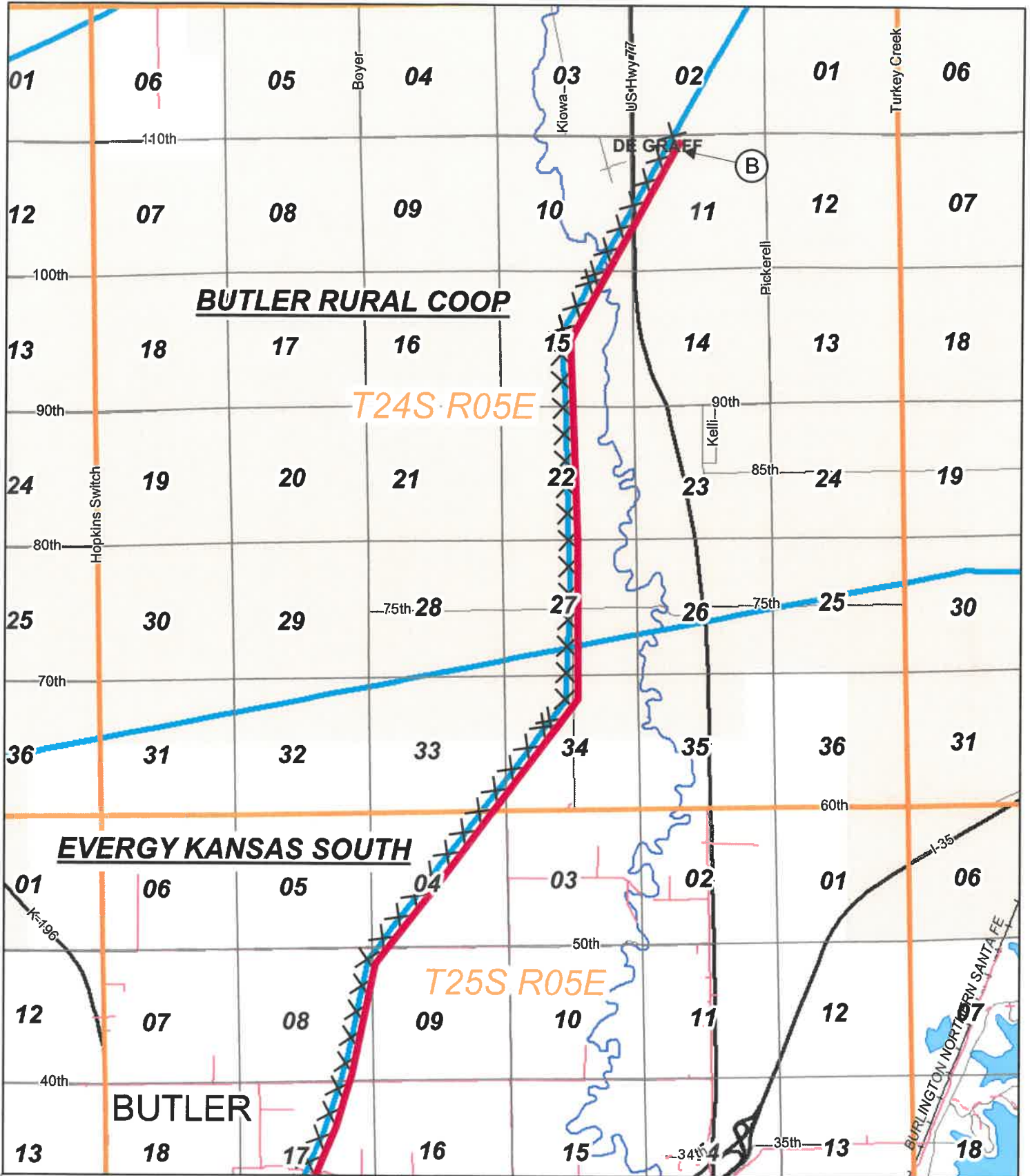

Think Safety!



Removal & Installation of 138,000 kV Transmission

BY Jessica Keck

WR # P25417

Crew HQ 3301

Date 10/15/2019

Scale 1" = 2,640'

Page 1

Proposed

Application Number L-3648