

2012-05-09 14:58:27  
Kansas Corporation Commission  
767 Patricia Peterson-Calk

KANSAS CORPORATION COMMISSION  
OIL & GAS CONSERVATION DIVISION  
**APPLICATION FOR INJECTION WELL**

Form U-1  
November 2011  
Form must be Typed  
Form must be Signed  
All blanks must be Filled

Disposal ☐

Enhanced Recovery: ☒ Repressuring

☐ Waterflood

☐ Tertiary

Date 04/02/2012

Operator License Number: 33960

Operator: Steven A. Leis

Address: 1092 Osage Rd.

Yates Center, KS 66783

Contact Person: Steven A. Leis

Phone: 620-330-6328

Email: hayllr@yahoo.com

Permit Number: E-21983

API Number: 15-207-23932

**Well Location**

NE - NE - NW - SE Sec. 28 Twp 25 S R 15 ☒ E ☐ W

1320 feet from ☐ N / ☒ S Line of Section

2540 feet from ☒ E / ☐ W Line of Section

GPS Location: Lat: \_\_\_\_\_, Long: \_\_\_\_\_  
(e.g. xx xxxxx) (e.g. -xxx xxxxx)

Datum: ☒ NAD27 ☐ NAD83 ☐ WGS84

Lease Description: SE4 S28-T25S-R15E

Lease Name: Hartzler Well Number: 33

Field Name: Yates Center

County: Woodson

**Deepest Usable Water**

Formation: n/a

Depth to Bottom of Formation: 200+

Check One: ☒ Old Well Being Converted

☐ Newly Drilled Well

☐ Well to be Drilled

Surface Elevation: 1136 feet Well Total Depth: 1210 feet Plug Back Depth: 1205 feet

Datum of top of injection formation: 1,140 (-4) feet (reference mean sea level)

**Injection Formation Description:**

Name	top / bottom	perf / open hole	depth
Upper Squirrel	1140 / 1145	Perf.	1140 to 1145 feet
Lower Squirrel	1159 / 1164	Perf.	1159 to 1164 feet

**List of Wells/Facilities Supplying Produced Saltwater or Other Fluids Approved by the Conservation Division:**  
(attach additional sheets if necessary)

Lease Operator	Lease/Facility Name	Lease/Facility Description	Well ID & Spot Location
1. Steven A. Leis	Hartzler	SE4 S28-T25S-R15E	All Producing Wells
2.			
3.			

Producing Formation	Strata Depth	Total Dissolved Solids (if available)
1. Squirrel	1140 to 1164 feet	n/a mg/l
2.	to feet	mg/l
3.	to feet	mg/l

Maximum Requested Liquid Injection Rate: 0-50 bbls / day, or

Maximum Requested Gas Injection Rate: n/a scf / day Type of Gas: \_\_\_\_\_

Maximum Requested Injection Pressure: 0-500 psig

KCC CONSERVATION  
PAID

APR 30 2012

AMT. \$ 250.00

#3878

## Well Completion

Type

☐

Tubing &amp; Packer

☒

Packerless

☐

Tubingless

	Conductor	Surface	Intermediate	Production	Tubing
Size		6 1/4"		2 1/2"	
Setting Depth		50'		1209'	
Amount of Cement		15 Sacks		140 Sacks Est.	
Top of Cement		Surface		Surface	
Bottom of Cement		50'		1209'	

If Alternate II cementing, complete the following

Perforations / D V Tool at n/a feet, cemented to n/a feet with n/a sxTubing Type 2.5" 6.5# Grade J-55Packer Type n/a Depth 1209'Annulus Corrosion Inhibitor Type n/a Concentration n/aList Logs Enclosed Gamma Ray/Neutron

## Well Sketch

(To sketch installation darken the appropriate lines, indicate cement, and show depths.)

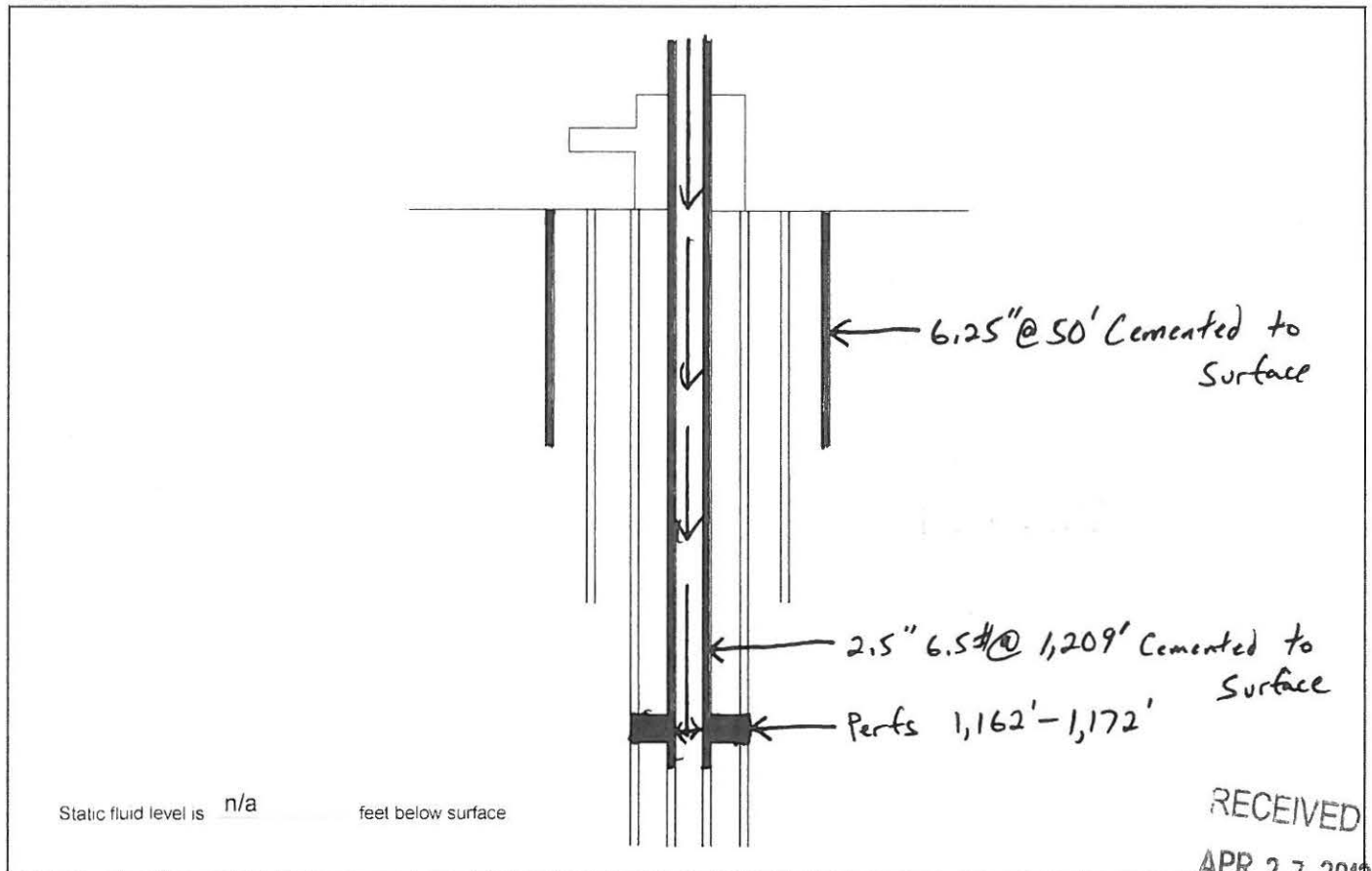

RECEIVED

APR 27 2012

KCC WICHITA

(Attach additional sheets if necessary)

Name

### Legal Description of Leasehold

See Attached

I hereby certify that the statements made herein are true and correct to the best of my knowledge and belief

Applicant or Duly Authorized Agent

Subscribed and sworn before me this 18th day of April 2012

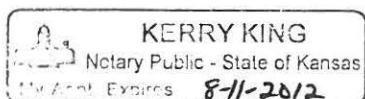

Notary Public

My Commission Expires 8-11-2012

1. Fully complete application, including page 4 (*plat map*) showing subject well and all known oil, gas and input wells, including wells being drilled, inactive wells, or dry holes, within one-half mile. Show lease names and operators or unleased mineral rights owners of all lands within one-half mile. Show well numbers and elevations of producing formation tops.
2. Attach some type of log (*drillers log, electric log, etc.*).
3. Attach some type of verification of cementing for surface casing, longstring, D.V. tool, perforations, etc. (*Cement ticket and job log, bond log, etc.*)
4. Attach Affidavit of Notice.
5. Fill in schematic drawing of subsurface facilities including: size, setting depth, amount of cement, measured or calculated tops of cement for each of surface, intermediate (*if any*) and production casing, size and setting depth of tubing and packer, geological zone of injection showing top and bottom of injection interval.
6. The original and one copy of the application and all attachments shall be mailed to the State Corporation Commission, Conservation Division.
7. Deliver or mail one (1) copy of the application to the landowner on whose land the injection well is located and to each operator or lessee of record and each unleased mineral rights owner within one-half mile of the applicant well.
8. Approval of this application, if granted, is valid only as long as there are no substantial changes in operation set forth in the application. A substantial change requires the approval of a new application. ***No injection well may be used without prior written authorization.***
9. All application fees must accompany the application.

RECEIVED  
APR 27 2012  
KCC WICHITA

Steven A. Leis  
1092 Osage Rd.  
Yates Center, KS 66783

I. LAND OWNERS

1. **L.D. & Cheryl McCormick**, 1266 80<sup>th</sup> Rd., Yates Center, Kansas 66783

Legal Description: S2, Section 28-T25S-R15E, Woodson County

2. **Barbara Herder Trust**, 16794 Logans Lake Rd., Boonville, MO 65233

Legal Description: NW4, Section 28-T25S-R15E, Woodson County

3. **Sandra Link**, Box 116, Williamsburg, KS 66095

Legal Description: NE4 Section 28-T25S-R15E, Woodson County

4. **Charles E. & Mary Ann Hill**, 1025 Prescott Dr., Lawrence, KS 66049

Legal Description: N2 SW4, Section 27-T25S-R15E, Woodson County

5. **Lois & Harold Dunning**, 17100 140<sup>th</sup> Rd., Erie, KS 66733

Legal Description: S2 SW4, Section 27-T25S-R15E, Woodson County

6. **Michael Wharry**, 1208 Jay Road, Yates Center, Kansas 66783

Legal Description: N2, Section 27-T25S-R15E, Woodson County

7. **Ernest & Eula Eggers**, 1019 Kansas St., Humboldt, KS 66748

Legal Description: NE4, Section 33-T25S-R15E &  
NW4, Section 34-T25S-R15E, Woodson County

8. **Alice Smith Estate**, 4 E. Jackson Ave., Iola, KS 66749

Legal Description: NW4, Section 33-T25S-R15E

II. OPERATORS

9. **Sage, Larry George**, P.O. Box 12, Virgil, KS 66870-0012

Legal Description: NE4 Section 28-T25S-15E &  
NW4 Section 27-T25S-15E, Woodson County

10. **T.J. Oil**, 120 N. Main St., Yates Center, KS 66783

Legal Description: NW4, Section 33-T25S-R15E, Woodson County

RECEIVED  
APR 27 2012  
KCC WICHITA



**Plat and Certificate of Injection Well Location and Surrounding Acreages**

Operator Steven A. Leis Location of Well SW SW SE  
 Lease Hartzler 420 feet from ☐ N / ☒ S Line of Section  
 Well Number 23 2100 feet from ☒ E / ☐ W Line of Section  
 County Woodson Sec 28 Twp 25 S R 15 ☒ East ☐ West

**Plat**

Show the following information: applicant injection well, all producing wells, inactive wells, plugged wells, and other wells within a one-half mile radius, all lease boundaries, lease operators, unleased mineral rights owners, well numbers, and producing wells producing formation tops

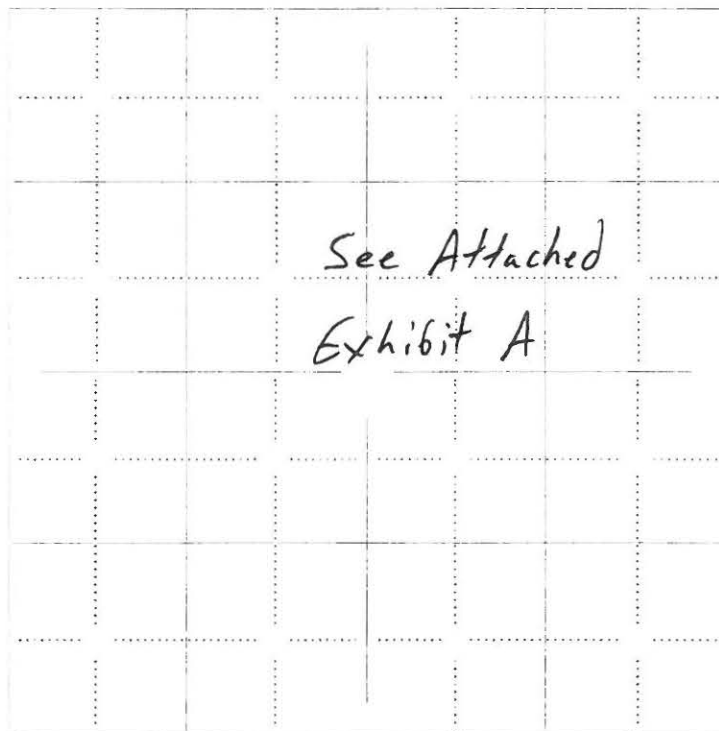

applicant well

producing well

plugged injection well

D &amp; A well

other injection well

temporary abandoned well

plugged producer

water supply well

The undersigned hereby certifies that he / she is a duly authorized agent for  
 shown herein is true, complete and correct to the best of his / her knowledge

and that all of the information

Applicant or Duly Authorized Agent

Subscribed and sworn before me this 18th day of April, 2012

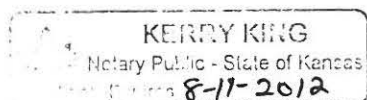

Notary Public

My Commission Expires 8-11-2012

RECEIVED

APR 27 2012

KCC WICHITA

Statewide View | Zoom to Location | Filter Wells | Label Wells | Download Wells | Print to PDF | Clear Highlight | Help

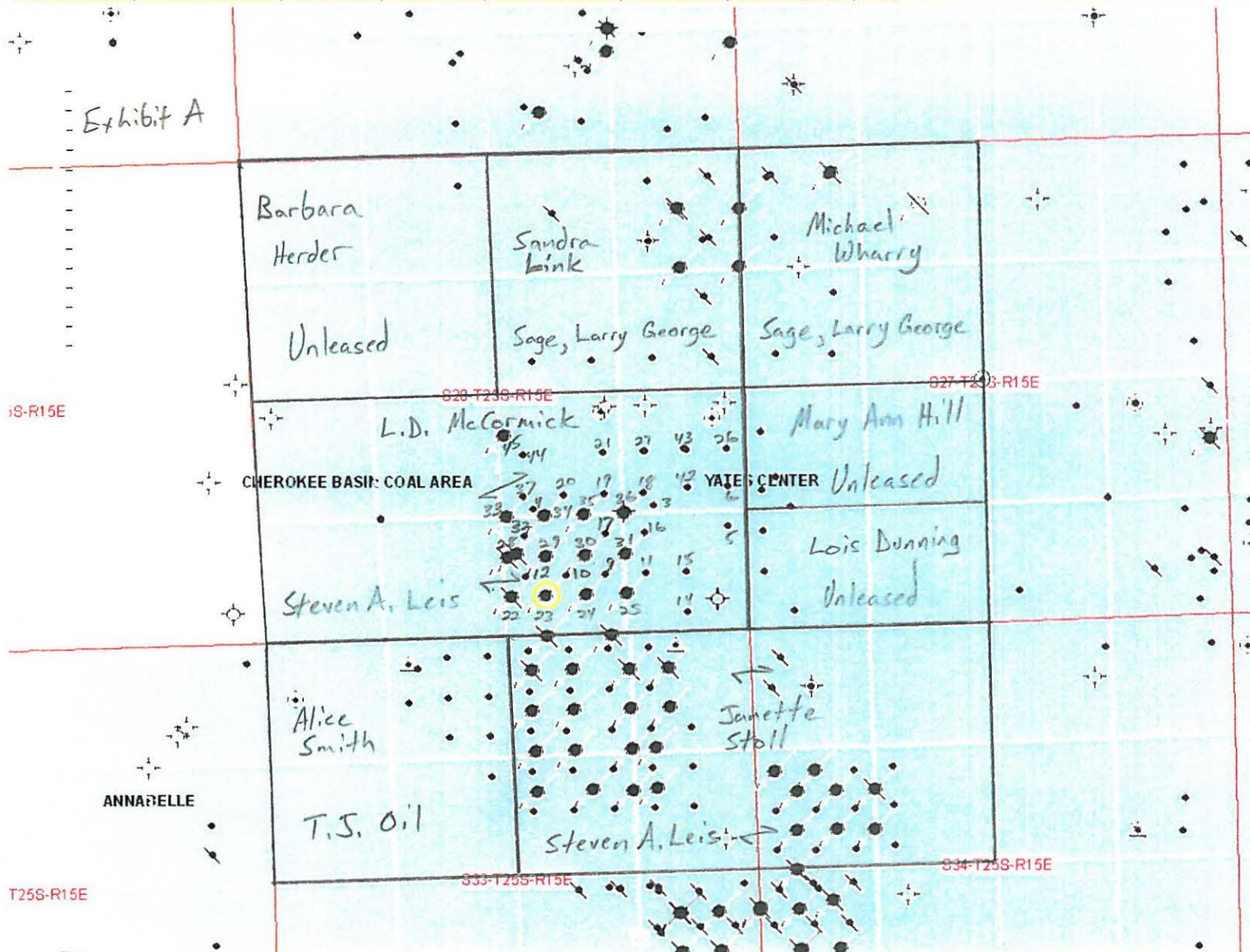

Layers Info Legend Links

#### OIL or GAS WELL

API: 15-207-23899  
 Lease: HARTZLER  
 Well: 23  
 Original Operator: W. B. MITCHELL JR  
 Current Operator: Leis, John E.  
 Field: YATES CENTER  
 Location: T25S R15E Sec. 28  
 NE SW SW SE  
 420 North, 2220 West  
 from SE corner  
 Longitude: -95.7643108  
 Latitude: 37.8370482  
 County: Woodson  
 Permit Date: Oct-14-1982  
 Spud Date:  
 Completion Date:  
 Plugging Date:  
 Well Type: EOR  
 Status: Authorized Injection Well  
 Total Depth: 1200  
 Elevation: 1129.0000 est.  
 Producing Formation:  
 IP Oil (bbl):  
 IP Water (bbl):  
 IP Gas (mcf):

#### Links:

- [Full KGS Database Entry](#)

RECEIVED  
 APR 27 2012  
 KCC WICHITA

0 0.125 0.25 0.5  
 Miles

**Affidavit of Notice Served**Re: Application for Steven A. LeisWell Name Harztler #23Legal Location SW SW SE S28-T25S-R15EThe undersigned hereby certifies that he / she is a duly authorized agent for the applicant and that on the day 18th of April2012 a true and correct copy of the application referenced above was delivered or mailed to the following parties.*Note: A copy of this affidavit must be served as a part of the application.*

Name

Address (Attach additional sheets if necessary)

**See Attached**

I further attest that notice of the filing of this application was published in the The Yates Center News, the official county publication of Woodson County county. A copy of the affidavit of this publication is attached.

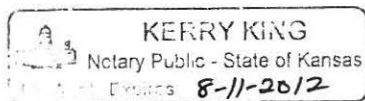
Signed this 18th day of April, 2012  
Applicant or Duty Authorized AgentSubscribed and sworn to before me this 18th day of April, 2012  
Notary PublicMy Commission Expires 8-11-2012

Protests may be filed by any party having a valid interest in the application. Petitions for protests shall be in writing and shall clearly identify the name and address of the protestant and the title of the application. The petition shall include a clear and concise statement of the direct and substantial interest of the protestant in the proceedings, including the manner in which the protestant may be affected, and the nature, extent, character and grounds of the protest. Protestants shall serve the protest upon the applicant by mail or personal service at the same time or before the protestant files the protest with the Conservation Division. Protests must be filed within 30 days of the publication notice of the application.

Mail to: KCC - Conservation Division, 130 S. Market - Room 2078, Wichita, Kansas 67202

**RECEIVED**  
**APR 27 2012**  
**KCC WICHITA**

Steven A. Leis  
1092 Osage Rd.  
Yates Center, KS 66783

I. LAND OWNERS

1. **L.D. & Cheryl McCormick**, 1266 80<sup>th</sup> Rd., Yates Center, Kansas 66783

Legal Description: S2, Section 28-T25S-R15E, Woodson County

2. **Barbara Herder Trust**, 16794 Logans Lake Rd., Boonville, MO 65233

Legal Description: NW4, Section 28-T25S-R15E, Woodson County

3. **Sandra Link**, Box 116, Williamsburg, KS 66095

Legal Description: NE4 Section 28-T25S-R15E, Woodson County

4. **Charles E. & Mary Ann Hill**, 1025 Prescott Dr., Lawrence, KS 66049

Legal Description: N2 SW4, Section 27-T25S-R15E, Woodson County

5. **Lois & Harold Dunning**, 17100 140<sup>th</sup> Rd., Erie, KS 66733

Legal Description: S2 SW4, Section 27-T25S-R15E, Woodson County

6. **Michael Wharry**, 1208 Jay Road, Yates Center, Kansas 66783

Legal Description: N2, Section 27-T25S-R15E, Woodson County

7. **Ernest & Eula Eggers**, 1019 Kansas St., Humboldt, KS 66748

Legal Description: NE4, Section 33-T25S-R15E &  
NW4, Section 34-T25S-R15E, Woodson County

8. **Alice Smith Estate**, 4 E. Jackson Ave., Iola, KS 66749

Legal Description: NW4, Section 33-T25S-R15E

II. OPERATORS

9. **Sage, Larry George**, P.O. Box 12, Virgil, KS 66870-0012

Legal Description: NE4 Section 28-T25S-15E &  
NW4 Section 27-T25S-15E, Woodson County

10. **T.J. Oil**, 120 N. Main St., Yates Center, KS 66783

Legal Description: NW4, Section 33-T25S-R15E, Woodson County

RECEIVED  
APR 27 2012  
KCC WICHITA



# Affidavit of Publication

STATE OF KANSAS,  
WOODSON COUNTY, ss:

Stewart Braden, being first duly sworn, deposes and says; That he is Publisher of The Yates Center NEWS, a weekly newspaper printed in the State of Kansas, and published in and of general circulation in Woodson County, Kansas, with a general circulation in Woodson County, Kansas, with a general paid circulation on a weekly basis in Woodson County, Kansas, and that said newspaper is not a trade, religious or fraternal publication.

Said newspaper is a weekly, published at least weekly 50 times a year; has been so published continuously and uninterrupted in said county and state for a period of more than five years prior to the first publication of said notice; and has been admitted at the post office in Yates Center in said County as second class matter.

The attached notice is a true copy thereof and was published in the regular and entire issue of said newspaper for.../..... consecutive weeks, the first publication thereof being made as afore said on the...19.....day of...April....., 2012, with subsequent publication being made on the following dates:

2nd Publication was made on the.....day of....., 20.....

3rd Publication was made on the.....day of....., 20.....

4th Publication was made on the.....day of....., 20.....

5th Publication was made on the.....day of....., 20.....

6th Publication was made on the.....day of....., 20.....

(Sign) Stewart Braden

Printer's Fees \$ 59.00

Affidavit, Notary's Fees \$ 2.50

Additional Copies \$ .....

Total Fee \$ 61.50

Subscribed and sworn to before me on this 20 day of April, 2012.

(Sign) Theodore Scott Lowder  
Notary Public

My appointment expires: Feb. 28, 2015

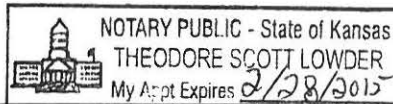

No.....

Plaintiff  
vs.

Defendant

Examined and approved:

Date.....

Judge

## Public Notice

(First published in The Yates Center NEWS on Thursday, April 19, 2012) 16-ltc

### BEFORE THE STATE CORPORATION COMMISSION OF THE STATE OF KANSAS NOTICE OF FILING APPLICATION

RE: Steven A. Leis - Application for a permit to authorize the enhanced recovery of saltwater into the Hartzler Lease, well #23; located in Woodson County, KS.  
TO: All Oil & Gas Producers, Unleased Mineral Interest Owners, Landowners, and all persons whomever concerned.

You, and each of you, are hereby notified that Steven A. Leis has filed an application to commence the injection of saltwater into the Squirrel formation on the Hartzler Lease, well #23; 420 feet from the South Line, 2100 feet from the East line located in the Southeast quarter of section 28, Township 25 S, Range 15E, Woodson County, KS., with a maximum operating pressure of 500 psig and a maximum injection rate of 50 bbls per day.

Any persons who object to or protest this application shall be required to file their objections or protests with the Conservation Division of the State Corporation Commission of the State of Kansas within fifteen [15] days from the date of the publication. These protests shall be filed pursuant to Commission regulations and must state specific reasons why the grant of the application may cause waste, violate correlative rights, or pollute the natural resources of the State of Kansas.

All persons interested of concerned shall take notice of the foregoing and shall govern themselves accordingly.

Steven A. Leis  
1092 Osage Rd.  
Yates Center, KS 66783  
620-330-6328

RECEIVED  
APR 27 2012

KCC WICHITA

KANSAS CORPORATION COMMISSION  
OIL & GAS CONSERVATION DIVISION  
APPLICATION FOR INJECTION WELL

Form U-1  
November 2011  
Form must be Typed  
Form must be Signed  
All blanks must be Filled

Disposal ☐

Enhanced Recovery ☒ Repressuring

☐ Waterflood

☐ Tertiary

Date: 04/02/2012

Operator License Number 33960

Operator Steven A. Leis

Address 1092 Osage Rd.

Yates Center, KS 66783

Contact Person Steven A. Leis

Phone 620-330-6328

Email: hayllr@yahoo.com

Permit Number: E-21983

API Number 15-207-23920

Well Location (5/19/83 APPROVAL DATE ON RBDMS)

NW SW SE Sec 28 Twp 25 S R 15 ☒ E ☐ W

860 feet from ☐ N / ☒ S Line of Section

2150 feet from ☒ E / ☐ W Line of Section

GPS Location Lat: 37.83818 Long: 095.76443  
(e.g. xx.xxxxx) (e.g. -xxx.xxxxx)

Datum: ☒ NAD27 ☐ NAD83 ☐ WGS84

Lease Description SE4 S28-T25S-R15E

Lease Name Hartzler Well Number 29

Field Name Yates Center

County Woodson

Deepest Usable Water

Formation n/a

Depth to Bottom of Formation 200+

Check One ☒ Old Well Being Converted ☐ Newly Drilled Well ☐ Well to be Drilled

Surface Elevation 1129 feet Well Total Depth 1225 feet Plug Back Depth 1220 feet

Datum of top of injection formation: 1,168 (-39) feet (reference mean sea level)

**Injection Formation Description:**

Name	top / bottom	perf / open hole	depth
Squirrel	1168 / 1176	Perf.	at 1168 to 1176 feet
			at to feet

**List of Wells/Facilities Supplying Produced Saltwater or Other Fluids Approved by the Conservation Division:**

(attach additional sheets if necessary)

Lease Operator	Lease/Facility Name	Lease/Facility Description	Well ID & Spot Location
1 Steven A. Leis	Hartzler	SE4 S28-T25S-R15E	All Producing Wells
2			
3			

Producing Formation	Strata Depth	Total Dissolved Solids (if available)
1 Squirrel	1140 to 1176 feet	n/a mg/l
2	to feet	mg/l
3	to feet	mg/l

Maximum Requested Liquid Injection Rate: 0-50 bbls / day, or

Maximum Requested Gas Injection Rate: n/a scf / day Type of Gas

Maximum Requested Injection Pressure: 0-500 psig

Mail to: KCC - Conservation Division, 130 S. Market - Room 2078, Wichita, Kansas 67202

RECEIVED  
APR 27 2012  
KCC WICHITA



**Well Completion**Type ☐ Tubing & Packer ☒ Packerless ☐ Tubingless

	Conductor	Surface	Intermediate	Production	Tubing
Size		6 1/4"		2 1/2"	
Setting Depth		50'		1220'	
Amount of Cement		15 Sacks		140 Sacks Est.	
Top of Cement		Surface		Surface	
Bottom of Cement		50'		1220'	

If Alternate II cementing, complete the following

Perforations / D.V. Tool at n/a feet, cemented to n/a feet with n/a sxTubing Type 2.5" 6.5# Grade J-55Packer Type n/a Depth 1220'Annulus Corrosion Inhibitor Type n/a Concentration n/aList Logs Enclosed Gamma Ray/Neutron**Well Sketch**

(To sketch installation, darken the appropriate lines, indicate cement, and show depths.)

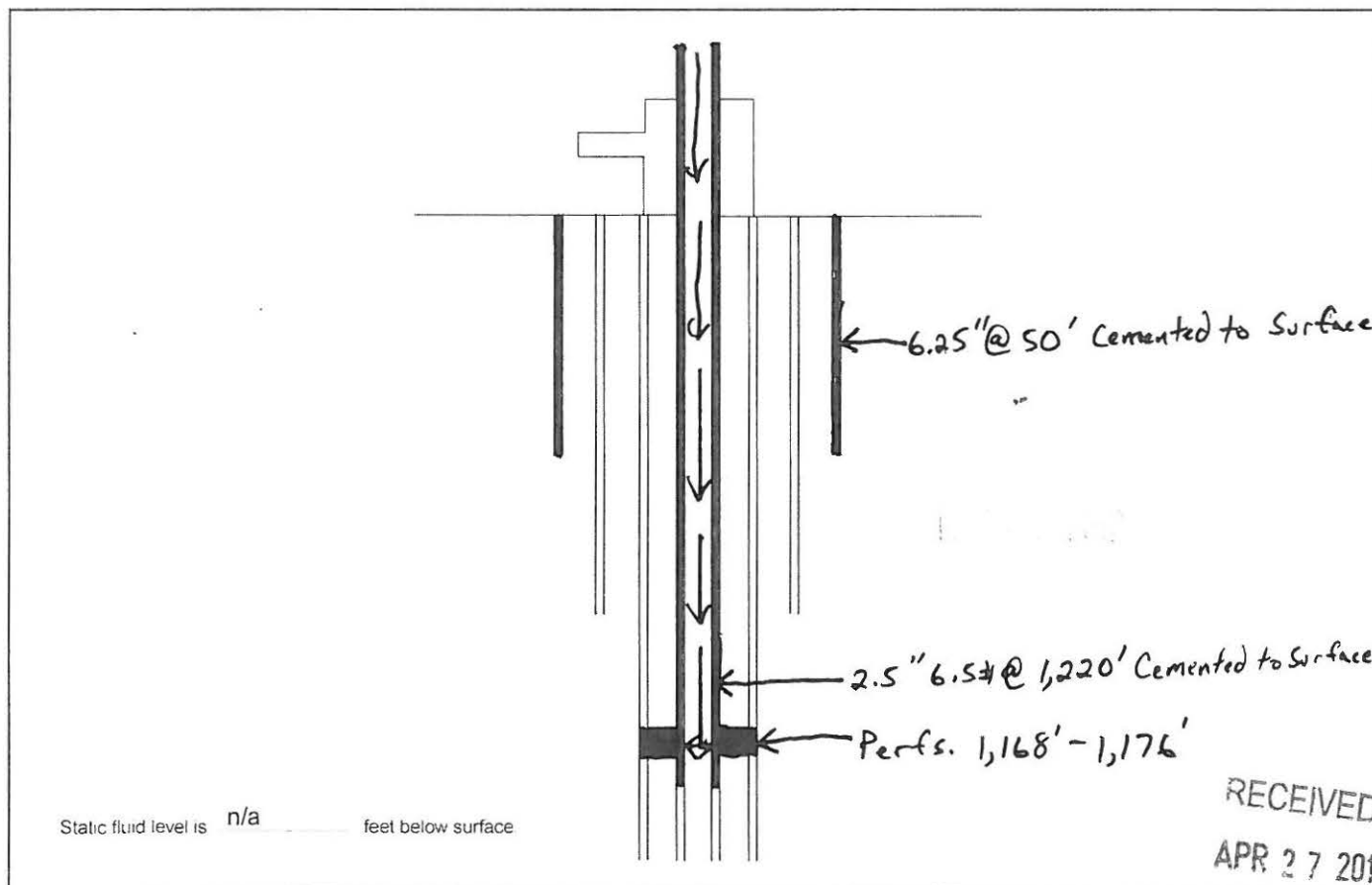

RECEIVED

APR 27 2012

KCC WICHITA

(Attach additional sheets if necessary)

### Legal Description of Leasehold

See Attached

Applicant or Duly Authorized Agent

Subscribed and sworn before me this 18th day of April 2012



*Kenny Kig*  
Notary Public

My Commission Expires 8-11-2012

1. Fully complete application, including page 4 (*plat map*) showing subject well and all known oil, gas and input wells, including wells being drilled, inactive wells, or dry holes, within one-half mile. Show lease names and operators or unleased mineral rights owners of all lands within one-half mile. Show well numbers and elevations of producing formation tops.
2. Attach some type of log (*drillers log electric log, etc.*).
3. Attach some type of verification of cementing for surface casing, longstring, D.V. tool, perforations, etc. (*Cement ticket and job log, bond log, etc.*)
4. Attach Affidavit of Notice
5. Fill in schematic drawing of subsurface facilities including size, setting depth, amount of cement, measured or calculated tops of cement for each of surface, intermediate (*if any*) and production casing, size and setting depth of tubing and packer, geological zone of injection showing top and bottom of injection interval
6. The original and one copy of the application and all attachments shall be mailed to the State Corporation Commission, Conservation Division
7. Deliver or mail one (*1*) copy of the application to the landowner on whose land the injection well is located and to each operator or lessee of record and each unleased mineral rights owner within one-half mile of the applicant well.
8. Approval of this application, if granted, is valid only as long as there are no substantial changes in operation set forth in the application. A substantial change requires the approval of a new application. **No injection well may be used without prior written authorization.**
9. All application fees must accompany the application.

RECEIVED  
APR 27 2012  
KCC WICHITA

Steven A. Leis  
1092 Osage Rd.  
Yates Center, KS 66783

I. LAND OWNERS

1. **L.D. & Cheryl McCormick**, 1266 80<sup>th</sup> Rd., Yates Center, Kansas 66783

Legal Description: S2, Section 28-T25S-R15E, Woodson County

2. **Barbara Herder Trust**, 16794 Logans Lake Rd., Boonville, MO 65233

Legal Description: NW4, Section 28-T25S-R15E, Woodson County

3. **Sandra Link**, Box 116, Williamsburg, KS 66095

Legal Description: NE4 Section 28-T25S-R15E, Woodson County

4. **Charles E. & Mary Ann Hill**, 1025 Prescott Dr., Lawrence, KS 66049

Legal Description: N2 SW4, Section 27-T25S-R15E, Woodson County

5. **Lois & Harold Dunning**, 17100 140<sup>th</sup> Rd., Erie, KS 66733

Legal Description: S2 SW4, Section 27-T25S-R15E, Woodson County

6. **Michael Wharry**, 1208 Jay Road, Yates Center, Kansas 66783

Legal Description: N2, Section 27-T25S-R15E, Woodson County

7. **Ernest & Eula Eggers**, 1019 Kansas St., Humboldt, KS 66748

Legal Description: NE4, Section 33-T25S-R15E &  
NW4, Section 34-T25S-R15E, Woodson County

8. **Alice Smith Estate**, 4 E. Jackson Ave., Iola, KS 66749

Legal Description: NW4, Section 33-T25S-R15E

II. OPERATORS

9. **Sage, Larry George**, P.O. Box 12, Virgil, KS 66870-0012

Legal Description: NE4 Section 28-T25S-15E &  
NW4 Section 27-T25S-15E, Woodson County

10. **T.J. Oil**, 120 N. Main St., Yates Center, KS 66783

Legal Description: NW4, Section 33-T25S-R15E, Woodson County

RECEIVED  
APR 27 2012  
KCC WICHITA

**Plat and Certificate of Injection Well Location and Surrounding Acreages**

Operator Steven A. Leis Location of Well NW SW SE  
 Lease Hartzler 860 feet from ☐ N / ☒ S Line of Section  
 Well Number 29 2150 feet from ☒ E / ☐ W Line of Section  
 County Woodson Sec. 28 Twp 25 S R 15 ☒ East ☐ West

**Plat**

Show the following information: applicant injection well, all producing wells, inactive wells, plugged wells, and other wells within a one-half mile radius, all lease boundaries, lease operators, unleased mineral rights owners, well numbers, and producing wells producing formation tops

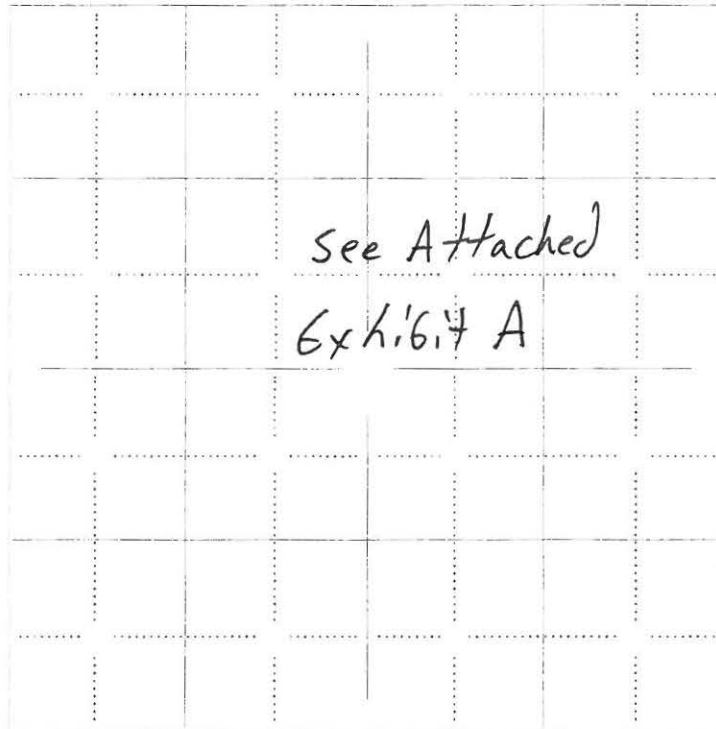

applicant well

producing well

plugged injection well

D &amp; A well

other injection well

temporary abandoned well

plugged producer

water supply well

The undersigned hereby certifies that he / she is a duly authorized agent for \_\_\_\_\_, and that all of the information shown herein is true, complete and correct to the best of his / her knowledge

Applicant or Duly Authorized Agent

Subscribed and sworn before me this 18th day of April, 2012

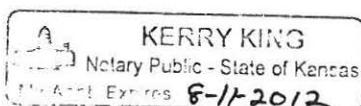

Notary Public

My Commission Expires 8-11-2012

RECEIVED  
 APR 27 2012  
 KCC WICHITA





## Affidavit of Notice Served

Re: Application for Steven A. Leis

Well Name Harztler #29

Legal Location NW SW SE S28-T25S-R15E

The undersigned hereby certifies that he / she is a duly authorized agent for the applicant and that on the day 18th of April

2012, a true and correct copy of the application referenced above was delivered or mailed to the following parties

Note: A copy of this affidavit must be served as a part of the application.

Name

Address (Attach additional sheets if necessary)

See Attached

I further attest that notice of the filing of this application was published in the The Yates Center News, the official county publication of Woodson County, county. A copy of the affidavit of this publication is attached.

Signed this 18th day of April 2012

  
Applicant or Duly Authorized Agent

Subscribed and sworn to before me this 18th day of April 2012

  
Notary Public

My Commission Expires 8-11-2012

Protests may be filed by any party having a valid interest in the application. Petitions for protests shall be in writing and shall clearly identify the name and address of the protestant and the title of the application. The petition shall include a clear and concise statement of the direct and substantial interest of the protestant in the proceedings, including the manner in which the protestant may be affected, and the nature, extent, character and grounds of the protest. Protestants shall serve the protest upon the applicant by mail or personal service at the same time or before the protestant files the protest with the Conservation Division. Protests must be filed within 30 days of the publication notice of the application.

Mail to: KCC - Conservation Division, 130 S. Market - Room 2078, Wichita, Kansas 67202

RECEIVED  
APR 27 2012  
KCC WICHITA



Steven A. Leis  
1092 Osage Rd.  
Yates Center, KS 66783

I. LAND OWNERS

1. **L.D. & Cheryl McCormick**, 1266 80<sup>th</sup> Rd., Yates Center, Kansas 66783

Legal Description: S2, Section 28-T25S-R15E, Woodson County

2. **Barbara Herder Trust**, 16794 Logans Lake Rd., Boonville, MO 65233

Legal Description: NW4, Section 28-T25S-R15E, Woodson County

3. **Sandra Link**, Box 116, Williamsburg, KS 66095

Legal Description: NE4 Section 28-T25S-R15E, Woodson County

4. **Charles E. & Mary Ann Hill**, 1025 Prescott Dr., Lawrence, KS 66049

Legal Description: N2 SW4, Section 27-T25S-R15E, Woodson County

5. **Lois & Harold Dunning**, 17100 140<sup>th</sup> Rd., Erie, KS 66733

Legal Description: S2 SW4, Section 27-T25S-R15E, Woodson County

6. **Michael Wharry**, 1208 Jay Road, Yates Center, Kansas 66783

Legal Description: N2, Section 27-T25S-R15E, Woodson County

7. **Ernest & Eula Eggers**, 1019 Kansas St., Humboldt, KS 66748

Legal Description: NE4, Section 33-T25S-R15E &  
NW4, Section 34-T25S-R15E, Woodson County

8. **Alice Smith Estate**, 4 E. Jackson Ave., Iola, KS 66749

Legal Description: NW4, Section 33-T25S-R15E

II. OPERATORS

9. **Sage, Larry George**, P.O. Box 12, Virgil, KS 66870-0012

Legal Description: NE4 Section 28-T25S-15E &  
NW4 Section 27-T25S-15E, Woodson County

10. **T.J. Oil**, 120 N. Main St., Yates Center, KS 66783

Legal Description: NW4, Section 33-T25S-R15E, Woodson County

RECEIVED  
APR 27 2012  
KCC WICHITA

# Affidavit of Publication

STATE OF KANSAS,  
WOODSON COUNTY, ss:

Stewart Braden, being first duly sworn, deposes and says; That he is Publisher of The Yates Center NEWS, a weekly newspaper printed in the State of Kansas, and published in and of general circulation in Woodson County, Kansas, with a general circulation in Woodson County, Kansas, with a general paid circulation on a weekly basis in Woodson County, Kansas, and that said newspaper is not a trade, religious or fraternal publication.

Said newspaper is a weekly, published at least weekly 50 times a year; has been so published continuously and uninterrupted in said county and state for a period of more than five years prior to the first publication of said notice; and has been admitted at the post office in Yates Center in said County as second class matter.

The attached notice is a true copy thereof and was published in the regular and entire issue of said newspaper for.....1..... consecutive weeks, the first publication thereof being made as

afore said on the.....19.....day of.....April....., 2012....., with subsequent publication being made on the following dates:

2nd Publication was made on the.....day of....., 20.....

3rd Publication was made on the.....day of....., 20.....

4th Publication was made on the.....day of....., 20.....

5th Publication was made on the.....day of....., 20.....

6th Publication was made on the.....day of....., 20.....

(Sign).....Stewart Braden.....

Printer's Fees \$ . 59.00 .....

Affidavit, Notary's Fees \$ . 2.50 .....

Additional Copies \$ . .....

Total Fee \$ . 61.50 .....

Subscribed and sworn to before me on this.....20.....day of.....April....., 2012.....

(Sign).....[Signature].....  
Notary Public

My appointment expires:.....Feb. 28, 2015.....

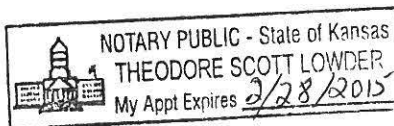

No.....

Plaintiff  
vs.

Defendant

Examined and approved:

Date.....

Judge

(First published in The Yates Center NEWS on Thursday, April 19, 2012) 16-ltc

BEFORE THE STATE  
CORPORATION  
COMMISSION OF THE  
STATE OF KANSAS  
NOTICE OF FILING  
APPLICATION

RE: Steven A. Leis - Application for a permit to authorize the enhanced recovery of saltwater into the Hartzler Lease, well #29; located in Woodson County, KS.  
TO: All Oil & Gas Producers, Unleased Mineral Interest Owners, Landowners, and all persons whomever concerned.

You, and each of you, are hereby notified that Steven A. Leis has filed an application to commence the injection of saltwater into the Squirrel formation on the Hartzler Lease, well #29; 860 feet from the South Line, 2150 feet from the East line located in the Southeast quarter of section 28, Township 25 S, Range 15E, Woodson County, KS., with a maximum operating pressure of 500 psig and a maximum injection rate of 50 bbls per day.

Any persons who object to or protest this application shall be required to file their objections or protests with the Conservation Division of the State Corporation Commission of the State of Kansas within fifteen [15] days from the date of the publication. These protests shall be filed pursuant to Commission regulations and must state specific reasons why the grant of the application may cause waste, violate correlative rights, or pollute the natural resources of the State of Kansas.

All persons interested of concerned shall take notice of the foregoing and shall govern themselves accordingly.

Steven A. Leis  
1092 Osage Rd.  
Yates Center, KS 66783  
620-330-6328

RECEIVED  
APR 27 2012

KCC WICHITA

KANSAS CORPORATION COMMISSION  
OIL & GAS CONSERVATION DIVISION  
APPLICATION FOR INJECTION WELL

Form U-1  
November 2011  
Form must be Typed  
Form must be Signed  
All blanks must be Filled

Disposal ☐

Enhanced Recovery ☒ Repressuring

☐ Waterflood

☐ Tertiary

Date 04/02/2012

Operator License Number 33960

Operator Steven A. Leis

Address 1092 Osage Rd.

Yates Center, KS 66783

Contact Person Steven A. Leis

Phone 620-330-6328

Email haylr@yahoo.com

Permit Number E-21983

API Number 15-207-23929

Well Location (5/19/83 APPROVAL DATE ON RPDMS)

NW SE SE Sec 28 Twp 25 S R 15 ☒ E ☐ W

860 feet from ☐ N ☒ S Line of Section

1760 feet from ☒ E ☐ W Line of Section

GPS Location Lat 37.83815 Long 095.76307  
(e.g. xxx xxxxx)

Datum ☒ NAD27 ☐ NAD83 ☐ WGS84

Lease Description SE4 S28-T25S-R15E

Lease Name Hartzler Well Number 30

Field Name Yates Center

County Woodson

Deepest Usable Water

Formation n/a

Depth to Bottom of Formation 200+

Check One ☒ Old Well Being Converted ☐ Newly Drilled Well ☐ Well to be Drilled

Surface Elevation 1132 feet Well Total Depth 1229 feet Plug Back Depth 1224 feet

Datum of top of injection formation 1,174 (-42) feet (reference mean sea level)

**Injection Formation Description:**

Name	top / bottom	perf / open hole	depth
Squirrel	1174 / 1182	Perf.	at 1174 to 1182 feet
			at to feet

**List of Wells/Facilities Supplying Produced Saltwater or Other Fluids Approved by the Conservation Division:**

(attach additional sheets if necessary)

Lease Operator	Lease/Facility Name	Lease/Facility Description	Well ID & Spot Location
1 Steven A. Leis	Hartzler	SE4 S28-T25S-R15E	All Producing Wells
2			
3			

Producing Formation	Strata Depth	Total Dissolved Solids (if available)
1 Squirrel	1140 to 1182 feet	n/a mg/l
2	to feet	mg/l
3	to feet	mg/l

Maximum Requested Liquid Injection Rate 0-50 bbls / day, or

Maximum Requested Gas Injection Rate n/a scf / day Type of Gas

Maximum Requested Injection Pressure 0-500 psig

Mail to: KCC - Conservation Division, 130 S. Market - Room 2078, Wichita, Kansas 67202

RECEIVED  
APR 27 2012  
KCC WICHITA

## Well Completion

Type ☐ Tubing & Packer ☒ Packerless ☐ Tubingless

	Conductor	Surface	Intermediate	Production	Tubing
Size		6 1/4"		2 1/2"	
Setting Depth		50'		1224'	
Amount of Cement		15 Sacks		140 Sacks Est.	
Top of Cement		Surface		Surface	
Bottom of Cement		50'		1224'	

If Alternate II cementing, complete the following

Perforations / D V Tool at n/a feet, cemented to n/a feet with n/a sxTubing Type 2.5" 6.5# Grade J-55Packer Type n/a Depth 1224'Annulus Corrosion Inhibitor Type n/a Concentration n/aList Logs Enclosed Gamma Ray/Neutron

## Well Sketch

(To sketch installation, darken the appropriate lines, indicate cement and show depths.)

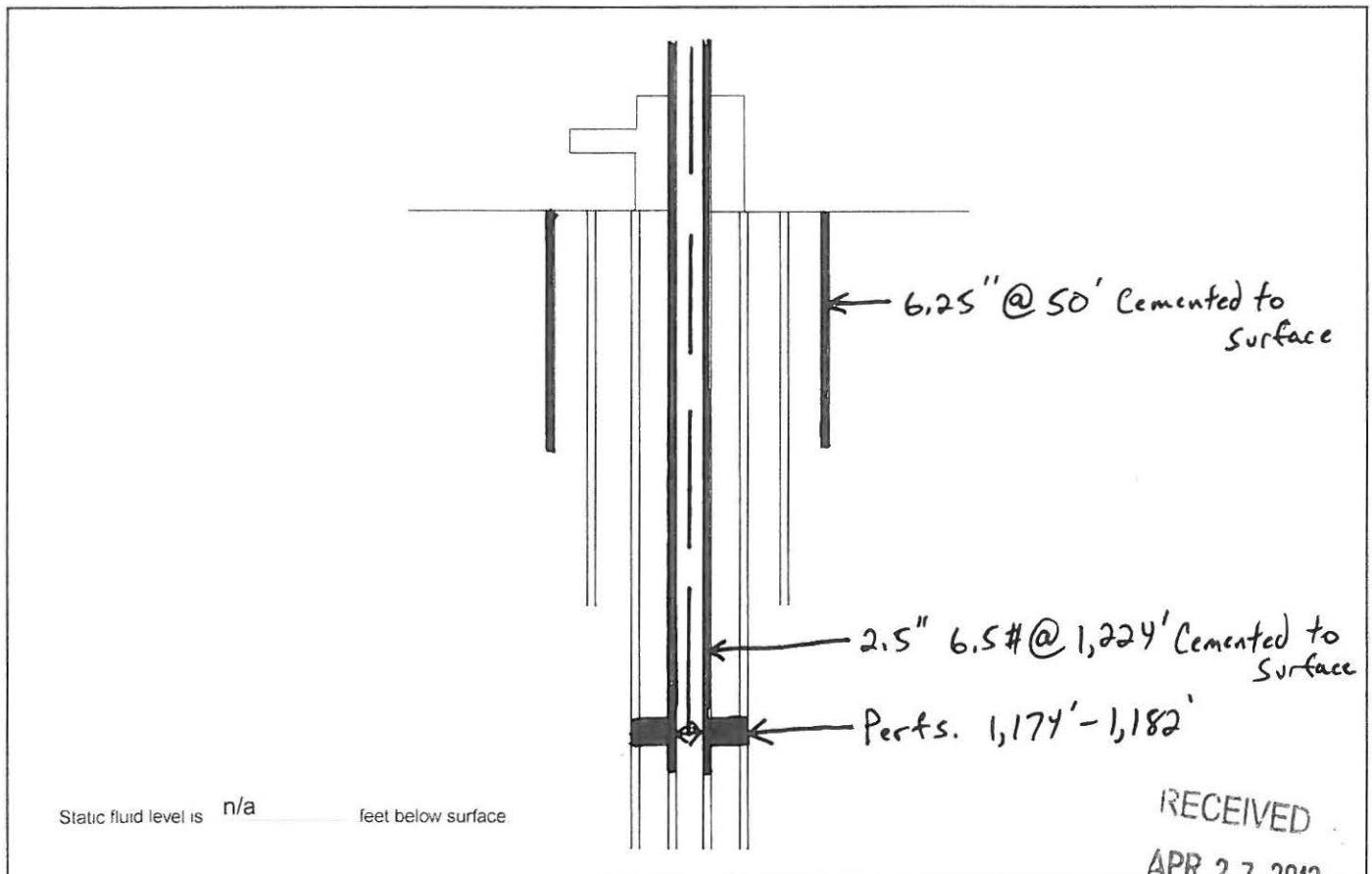

(Attach additional sheets if necessary)

### Legal Description of Leasehold

See Attached

best of my knowledge and belief



Applicant or Duly Authorized Agent

Subscribed and sworn before me this 18th day of April 2012



Harry H  
Notary Public

My Commission Expires 8-11-2012

1. Fully complete application including page 4 (*plat map*) showing subject well and all known oil, gas and input wells, including wells being drilled, inactive wells, or dry holes, within one-half mile. Show lease names and operators or unleased mineral rights owners of all lands within one-half mile. Show well numbers and elevations of producing formation tops.
2. Attach some type of log (*drillers log, electric log, etc.*).
3. Attach some type of verification of cementing for surface casing, longstring, D.V. tool, perforations, etc. (*Cement ticket and job log, bond log, etc.*)
4. Attach Affidavit of Notice
5. Fill in schematic drawing of subsurface facilities including size, setting depth, amount of cement, measured or calculated tops of cement for each of surface, intermediate (*if any*) and production casing, size and setting depth of tubing and packer, geological zone of injection showing top and bottom of injection interval.
6. The original and one copy of the application and all attachments shall be mailed to the State Corporation Commission, Conservation Division.
7. Deliver or mail one (*1*) copy of the application to the landowner on whose land the injection well is located and to each operator or lessee of record and each unleased mineral rights owner within one-half mile of the applicant well.
8. Approval of this application, if granted, is valid only as long as there are no substantial changes in operation set forth in the application. A substantial change requires the approval of a new application. ***No injection well may be used without prior written authorization.***
9. All application fees must accompany the application.

RECEIVED  
APR 27 2012  
KCC WICHITA

Steven A. Leis  
1092 Osage Rd.  
Yates Center, KS 66783

I. LAND OWNERS

1. **L.D. & Cheryl McCormick**, 1266 80<sup>th</sup> Rd., Yates Center, Kansas 66783

Legal Description: S2, Section 28-T25S-R15E, Woodson County

2. **Barbara Herder Trust**, 16794 Logans Lake Rd., Boonville, MO 65233

Legal Description: NW4, Section 28-T25S-R15E, Woodson County

3. **Sandra Link**, Box 116, Williamsburg, KS 66095

Legal Description: NE4 Section 28-T25S-R15E, Woodson County

4. **Charles E. & Mary Ann Hill**, 1025 Prescott Dr., Lawrence, KS 66049

Legal Description: N2 SW4, Section 27-T25S-R15E, Woodson County

5. **Lois & Harold Dunning**, 17100 140<sup>th</sup> Rd., Erie, KS 66733

Legal Description: S2 SW4, Section 27-T25S-R15E, Woodson County

6. **Michael Wharry**, 1208 Jay Road, Yates Center, Kansas 66783

Legal Description: N2, Section 27-T25S-R15E, Woodson County

7. **Ernest & Eula Eggers**, 1019 Kansas St., Humboldt, KS 66748

Legal Description: NE4, Section 33-T25S-R15E &  
NW4, Section 34-T25S-R15E, Woodson County

8. **Alice Smith Estate**, 4 E. Jackson Ave., Iola, KS 66749

Legal Description: NW4, Section 33-T25S-R15E

II. OPERATORS

9. **Sage, Larry George**, P.O. Box 12, Virgil, KS 66870-0012

Legal Description: NE4 Section 28-T25S-15E &  
NW4 Section 27-T25S-15E, Woodson County

10. **T.J. Oil**, 120 N. Main St., Yates Center, KS 66783

Legal Description: NW4, Section 33-T25S-R15E, Woodson County

RECEIVED  
APR 27 2012  
KCC WICHITA



**Plat and Certificate of Injection Well Location and Surrounding Acreages**

Operator Steven A. Leis Location of Well NW SE SE  
 Lease Hartzler 860 feet from ☐ N / ☒ S Line of Section  
 Well Number 30 1760 feet from ☒ E / ☐ W Line of Section  
 County Woodson Sec 28 Twp 25 S R 15 ☒ East ☐ West

**Plat**

Show the following information: applicant injection well, all producing wells, inactive wells, plugged wells, and other wells within a one-half mile radius, all lease boundaries, lease operators, unleased mineral rights owners, well numbers, and producing wells producing formation tops.

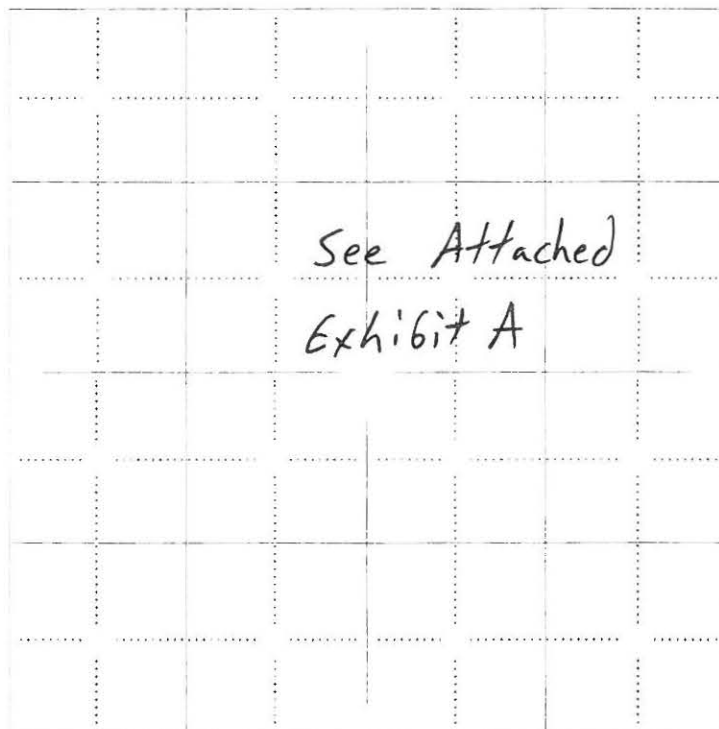

applicant well

producing well

plugged injection well

D &amp; A well

other injection well

temporary abandoned well

plugged producer

water supply well

The undersigned hereby certifies that he / she is a duly authorized agent for  
 shown herein is true, complete and correct to the best of his / her knowledge

Applicant or Duly Authorized Agent

Subscribed and sworn before me this 18th day of April, 2012

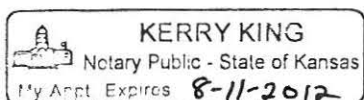

Notary Public

My Commission Expires 8-11-2012

RECEIVED  
 APR 27 2012  
 KCC WICHITA

Statewide View | Zoom to Location | Filter Wells | Label Wells | Download Wells | Print to PDF | Clear Highlight | Help

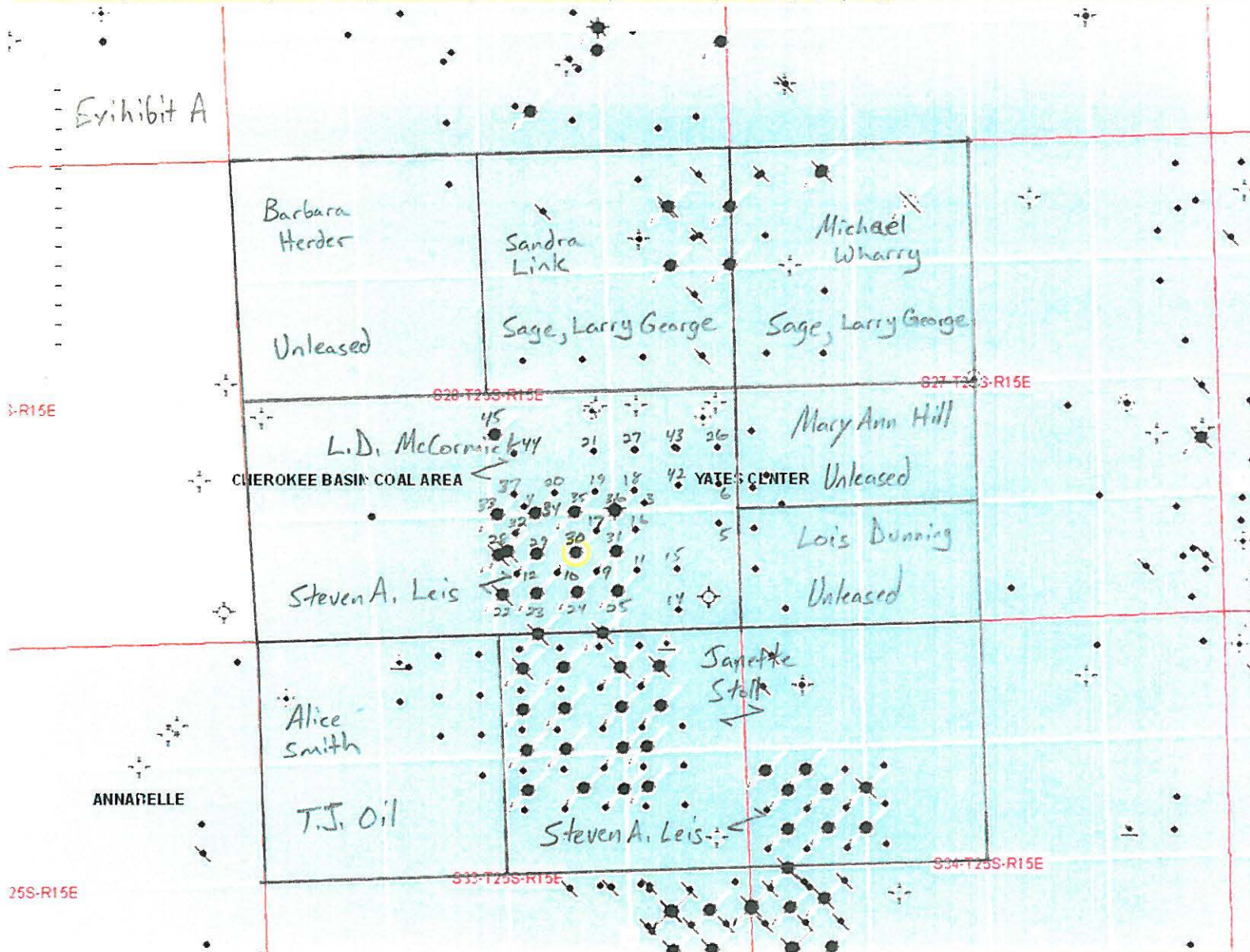

Layers Info Legend Links

#### OIL or GAS WELL

API: 15-207-23929-0001  
 Lease: HARTZLER  
 Well: 30  
 Original Operator:  
 Current Operator: Leis, John E.  
 Field:  
 Location: T25S R15E Sec. 28  
 SW NE SW SE  
 860 North, 1780 West  
 from SE corner  
 Longitude: -95.7627763  
 Latitude: 37.8382523  
 County: Woodson  
 Permit Date:  
 Spud Date:  
 Completion Date:  
 Plugging Date:  
 Well Type: EOR  
 Status: Authorized Injection Well  
 Total Depth:  
 Elevation: 1134.0000 est.  
 Producing Formation:  
 IP Oil (bbl):  
 IP Water (bbl):  
 IP Gas (mcf):

#### Links:

- [Full KGS Database Entry](#)

RECEIVED  
 APR 27 2012  
 KCC WICHITA

## Affidavit of Notice Served

Re: Application for Steven A. LeisWell Name Harzler #30Legal Location NW SE SE S28-T25S-R15EThe undersigned hereby certifies that he / she is a duly authorized agent for the applicant, and that on the day 18th of April2012, a true and correct copy of the application referenced above was delivered or mailed to the following parties:

Note: A copy of this affidavit must be served as a part of the application.

Name

Address (Attach additional sheets if necessary)

See Attached

I further attest that notice of the filing of this application was published in the The Yates Center News, the official county publication of Woodson County county. A copy of the affidavit of this publication is attached.

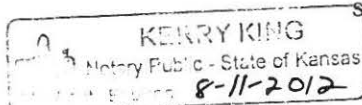
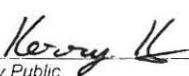
Signed this 18th day of April, 2012  
Applicant or Duty Authorized AgentSubscribed and sworn to before me this 18th day of April, 2012  
Notary PublicMy Commission Expires 8-11-2012

Protests may be filed by any party having a valid interest in the application. Petitions for protests shall be in writing and shall clearly identify the name and address of the protestant and the title of the application. The petition shall include a clear and concise statement of the direct and substantial interest of the protestant in the proceedings, including the manner in which the protestant may be affected, and the nature, extent, character and grounds of the protest. Protestants shall serve the protest upon the applicant by mail or personal service at the same time or before the protestant files the protest with the Conservation Division. Protests must be filed within 30 days of the publication notice of the application.

Mail to: KCC - Conservation Division, 130 S. Market - Room 2078, Wichita, Kansas 67202

RECEIVED  
APR 27 2012  
KCC WICHITA

Steven A. Leis  
1092 Osage Rd.  
Yates Center, KS 66783

I. LAND OWNERS

1. **L.D. & Cheryl McCormick**, 1266 80<sup>th</sup> Rd., Yates Center, Kansas 66783

Legal Description: S2, Section 28-T25S-R15E, Woodson County

2. **Barbara Herder Trust**, 16794 Logans Lake Rd., Boonville, MO 65233

Legal Description: NW4, Section 28-T25S-R15E, Woodson County

3. **Sandra Link**, Box 116, Williamsburg, KS 66095

Legal Description: NE4 Section 28-T25S-R15E, Woodson County

4. **Charles E. & Mary Ann Hill**, 1025 Prescott Dr., Lawrence, KS 66049

Legal Description: N2 SW4, Section 27-T25S-R15E, Woodson County

5. **Lois & Harold Dunning**, 17100 140<sup>th</sup> Rd., Erie, KS 66733

Legal Description: S2 SW4, Section 27-T25S-R15E, Woodson County

6. **Michael Wharry**, 1208 Jay Road, Yates Center, Kansas 66783

Legal Description: N2, Section 27-T25S-R15E, Woodson County

7. **Ernest & Eula Eggers**, 1019 Kansas St., Humboldt, KS 66748

Legal Description: NE4, Section 33-T25S-R15E &  
NW4, Section 34-T25S-R15E, Woodson County

8. **Alice Smith Estate**, 4 E. Jackson Ave., Iola, KS 66749

Legal Description: NW4, Section 33-T25S-R15E

II. OPERATORS

9. **Sage, Larry George**, P.O. Box 12, Virgil, KS 66870-0012

Legal Description: NE4 Section 28-T25S-15E &  
NW4 Section 27-T25S-15E, Woodson County

10. **T.J. Oil**, 120 N. Main St., Yates Center, KS 66783

Legal Description: NW4, Section 33-T25S-R15E, Woodson County

RECEIVED  
APR 27 2012  
KCC WICHITA



# Affidavit of Publication

STATE OF KANSAS,  
WOODSON COUNTY, ss:

Stewart Braden, being first duly sworn, deposes and says; That he is Publisher of The Yates Center NEWS, a weekly newspaper printed in the State of Kansas, and published in and of general circulation in Woodson County, Kansas, with a general circulation in Woodson County, Kansas, with a general paid circulation on a weekly basis in Woodson County, Kansas, and that said newspaper is not a trade, religious or fraternal publication.

Said newspaper is a weekly, published at least weekly 50 times a year; has been so published continuously and uninterrupted in said county and state for a period of more than five years prior to the first publication of said notice; and has been admitted at the post office in Yates Center in said County as second class matter.

The attached notice is a true copy thereof and was published in the regular and entire issue of said newspaper for..... consecutive weeks, the first publication thereof being made as afore said on the.....19.....day of.....April....., 20..12....., with subsequent publication being made on the following dates:

2nd Publication was made on the.....day of....., 20.....

3rd Publication was made on the.....day of....., 20.....

4th Publication was made on the.....day of....., 20.....

5th Publication was made on the.....day of....., 20.....

6th Publication was made on the.....day of....., 20.....

(Sign).....*Stewart Braden*.....

Printer's Fees \$ .59.00.....

Affidavit, Notary's Fees \$ ...2.50.....

Additional Copies \$ .....  
Total Fee \$ ...61.50.....

Subscribed and sworn to before me on this..20..day of..April.., 20..12..

(Sign).....*Notary Public*.....

My appointment expires: Feb. 28, 2015

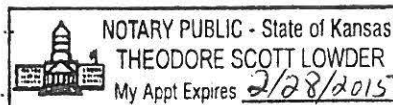

No.....

Plaintiff

vs.

Defendant

Examined and approved:

Date.....

Judge

RECEIVED

APR 27 2012

KCC WICHITA

## Public Notice

(First published in The Yates Center NEWS on Thursday, April 19, 2012) 16-1tc

### BEFORE THE STATE CORPORATION COMMISSION OF THE STATE OF KANSAS NOTICE OF FILING APPLICATION

RE: Steven A. Leis - Application for a permit to authorize the enhanced recovery of saltwater into the Hartzler Lease, well #30; located in Woodson County, KS.  
TO: All Oil & Gas Producers, Unleased Mineral Interest Owners, Landowners, and all persons whomever concerned.

You, and each of you, are hereby notified that Steven A. Leis has filed an application to commence the injection of saltwater into the Squirrel formation on the Hartzler Lease, well #30; 860 feet from the South Line, 1760 feet from the East line located in the Southeast quarter of section 28, Township 25 S, Range 15E, Woodson County, KS., with a maximum operating pressure of 500 psig and a maximum injection rate of 50 bbls per day.

Any persons who object to or protest this application shall be required to file their objections or protests with the Conservation Division of the State Corporation Commission of the State of Kansas within fifteen [15] days from the date of the publication. These protests shall be filed pursuant to Commission regulations and must state specific reasons why the grant of the application may cause waste, violate correlative rights, or pollute the natural resources of the State of Kansas.

All persons interested of concerned shall take notice of the foregoing and shall govern themselves accordingly.

Steven A. Leis  
1092 Osage Rd.  
Yates Center, KS 66783  
620-330-6328

KANSAS CORPORATION COMMISSION  
OIL & GAS CONSERVATION DIVISION  
APPLICATION FOR INJECTION WELL

Form U-1  
November 2011  
Form must be Typed  
Form must be Signed  
All blanks must be Filled

Disposal ☐  
Enhanced Recovery: ☒ Repressuring  
☐ Waterflood  
☐ Tertiary  
Date 04/02/2012  
Operator License Number 33960  
Operator Steven A. Leis  
Address 1092 Osage Rd.  
Yates Center, KS 66783  
Contact Person Steven A. Leis  
Phone 620-330-6328  
Email haylr@yahoo.com

Permit Number E-21983  
API Number 15-207-23932  
Well Location (5/19/83 APPROVAL DATE ON RBDM)  
NE - NE - NW - SE Sec 28 Twp 25 S R 15 ☒ E ☐ W  
1320 feet from ☐ N / ☒ S Line of Section  
2540 feet from ☒ E / ☐ W Line of Section  
GPS Location: Lat (e.g. xx.xxxxx) Long (e.g. xxx.xxxxx)  
Datum ☒ NAD27 ☐ NAD83 ☐ WGS84  
Lease Description SE4 S28-T25S-R15E  
Lease Name Hartzler Well Number 33  
Field Name Yates Center  
County Woodson  
Deepest Usable Water  
Formation n/a  
Depth to Bottom of Formation 200+

Check One ☒ Old Well Being Converted ☐ Newly Drilled Well ☐ Well to be Drilled  
Surface Elevation 1136 feet Well Total Depth 1210 feet Plug Back Depth 1205 feet  
Datum of top of injection formation 1,140 (-4) feet (reference mean sea level)

Injection Formation Description:

Name	top / bottom	perf / open hole	depth
Upper Squirrel	1140 / 1145	Perf. at 1140 to 1145 feet	
Lower Squirrel	1159 / 1164	Perf. at 1159 to 1164 feet	

List of Wells/Facilities Supplying Produced Saltwater or Other Fluids Approved by the Conservation Division:  
(attach additional sheets if necessary)

Lease Operator	Lease/Facility Name	Lease/Facility Description	Well ID & Spot Location
1. Steven A. Leis	Hartzler	SE4 S28-T25S-R15E	All Producing Wells
2.			
3.			

Producing Formation	Strata Depth	Total Dissolved Solids (if available)
1. Squirrel	1140 to 1164 feet	n/a mg/l
2.	to feet	mg/l
3.	to feet	mg/l

Maximum Requested Liquid Injection Rate 0-50 bbls / day, or  
Maximum Requested Gas Injection Rate n/a scf / day Type of Gas  
Maximum Requested Injection Pressure 0-500 psig

Mail to: KCC - Conservation Division, 130 S. Market - Room 2078, Wichita, Kansas 67202

RECEIVED  
APR 27 2012  
KCC WICHITA  
1250.0000 3878



## Well Completion

Type ☐ Tubing & Packer ☒ Packerless ☐ Tubingless

	Conductor	Surface	Intermediate	Production	Tubing
Size		6 1/4"		2 1/2"	
Setting Depth		50'		1205'	
Amount of Cement		15 Sacks		140 Sacks Est.	
Top of Cement		Surface		Surface	
Bottom of Cement		50'		1205'	

If Alternate II cementing, complete the following

Perforations / D V Tool at n/a feet, cemented to n/a feet with n/a sxTubing Type 2.5" 6.5# Grade J-55Packer Type n/a Depth 1205'Annulus Corrosion Inhibitor Type n/a Concentration n/aList Logs Enclosed Gamma Ray/Neutron

## Well Sketch

(To sketch installation, darken the appropriate lines, indicate cement, and show depths.)

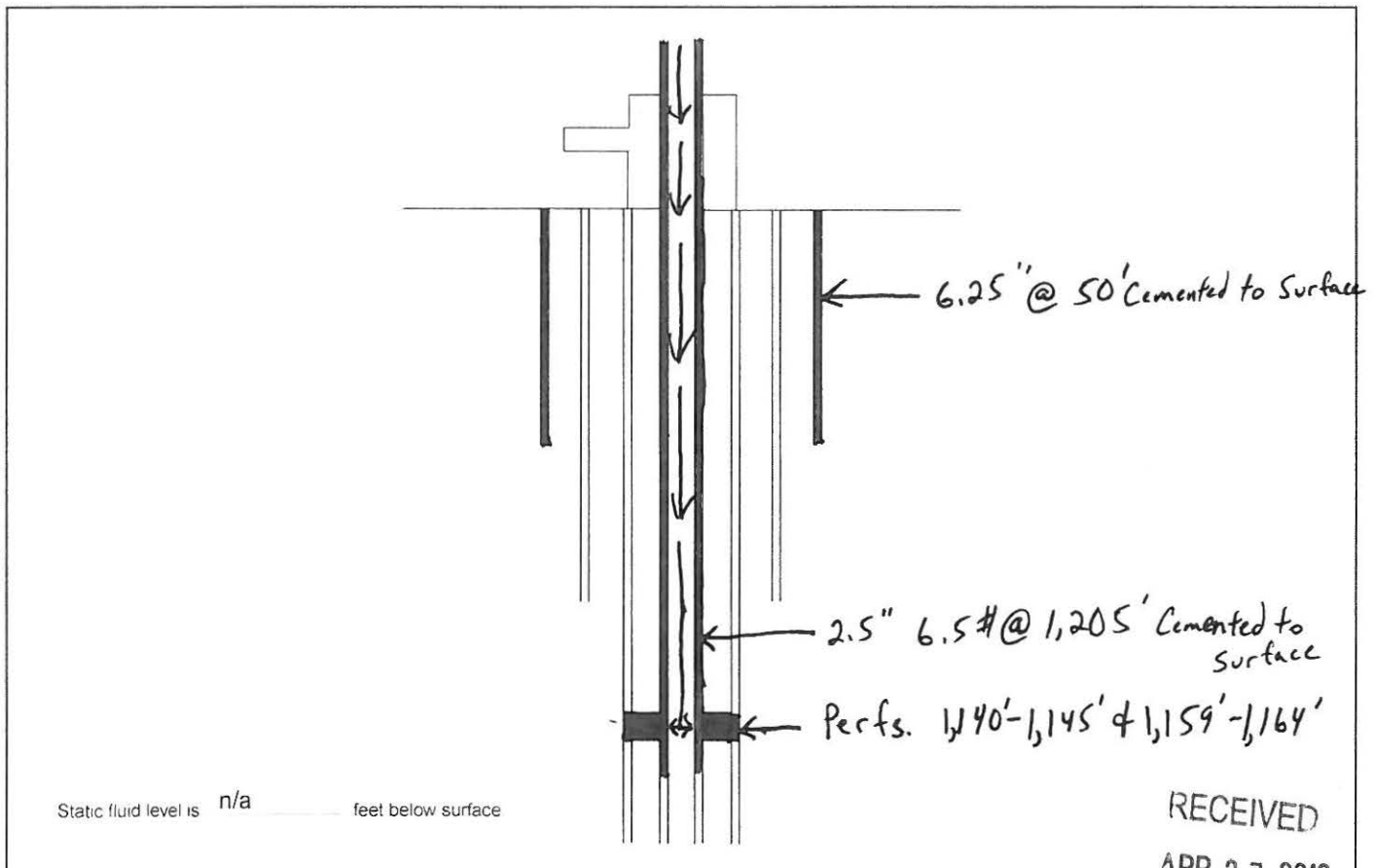
RECEIVED  
APR 27 2012  
KCC WICHITA

(Attach additional sheets if necessary)

Name \_\_\_\_\_

### Legal Description of Leasehold

See Attached

I hereby certify that the statements made herein are true and correct to the best of my knowledge and belief

Applicant or Duty Authorized Agent

Subscribed and sworn before me this 18th day of April 2012



Kerry King  
Notary Public

My Commission Expires 8-11-2012

**Instructions:**

1. Fully complete application, including page 4 (*plat map*) showing subject well and all known oil, gas and input wells, including wells being drilled, inactive wells, or dry holes, within one-half mile. Show lease names and operators or unleased mineral rights owners of all lands within one-half mile. Show well numbers and elevations of producing formation tops.
2. Attach some type of log (*drillers log, electric log, etc.*).
3. Attach some type of verification of cementing for surface casing, longstring, D V tool, perforations, etc. (*Cement ticket and job log, bond log, etc.*)
4. Attach Affidavit of Notice.
5. Fill in schematic drawing of subsurface facilities including: size, setting depth, amount of cement, measured or calculated tops of cement for each of surface, intermediate (*if any*) and production casing, size and setting depth of tubing and packer, geological zone of injection showing top and bottom of injection interval.
6. The original and one copy of the application and all attachments shall be mailed to the State Corporation Commission, Conservation Division.
7. Deliver or mail one (1) copy of the application to the landowner on whose land the injection well is located and to each operator or lessee of record and each unleased mineral rights owner within one-half mile of the applicant well.
8. Approval of this application, if granted, is valid only as long as there are no substantial changes in operation set forth in the application. A substantial change requires the approval of a new application. ***No injection well may be used without prior written authorization.***
9. All application fees must accompany the application.

RECEIVED  
APR 27 2012  
KCC WICHITA

Steven A. Leis  
1092 Osage Rd.  
Yates Center, KS 66783

I. LAND OWNERS

1. **L.D. & Cheryl McCormick**, 1266 80<sup>th</sup> Rd., Yates Center, Kansas 66783

Legal Description: S2, Section 28-T25S-R15E, Woodson County

2. **Barbara Herder Trust**, 16794 Logans Lake Rd., Boonville, MO 65233

Legal Description: NW4, Section 28-T25S-R15E, Woodson County

3. **Sandra Link**, Box 116, Williamsburg, KS 66095

Legal Description: NE4 Section 28-T25S-R15E, Woodson County

4. **Charles E. & Mary Ann Hill**, 1025 Prescott Dr., Lawrence, KS 66049

Legal Description: N2 SW4, Section 27-T25S-R15E, Woodson County

5. **Lois & Harold Dunning**, 17100 140<sup>th</sup> Rd., Erie, KS 66733

Legal Description: S2 SW4, Section 27-T25S-R15E, Woodson County

6. **Michael Wharry**, 1208 Jay Road, Yates Center, Kansas 66783

Legal Description: N2, Section 27-T25S-R15E, Woodson County

7. **Ernest & Eula Eggers**, 1019 Kansas St., Humboldt, KS 66748

Legal Description: NE4, Section 33-T25S-R15E &  
NW4, Section 34-T25S-R15E, Woodson County

8. **Alice Smith Estate**, 4 E. Jackson Ave., Iola, KS 66749

Legal Description: NW4, Section 33-T25S-R15E

II. OPERATORS

9. **Sage, Larry George**, P.O. Box 12, Virgil, KS 66870-0012

Legal Description: NE4 Section 28-T25S-15E &  
NW4 Section 27-T25S-15E, Woodson County

10. **T.J. Oil**, 120 N. Main St., Yates Center, KS 66783

Legal Description: NW4, Section 33-T25S-R15E, Woodson County

RECEIVED  
APR 27 2012  
KCC WICHITA

## Plat and Certificate of Injection Well Location and Surrounding Acreages

Operator Steven A. Leis Location of Well NE NE NW SE  
 Lease Hartzler 1320 feet from ☐ N / ☒ S Line of Section  
 Well Number 33 2540 feet from ☒ E / ☐ W Line of Section  
 County Woodson Sec 28 Twp 25 S R 15 ☒ East ☐ West

## Plat

Show the following information, applicant injection well, all producing wells, inactive wells, plugged wells, and other wells within a one-half mile radius, all lease boundaries, lease operators, unleased mineral rights owners, well numbers, and producing wells producing formation tops

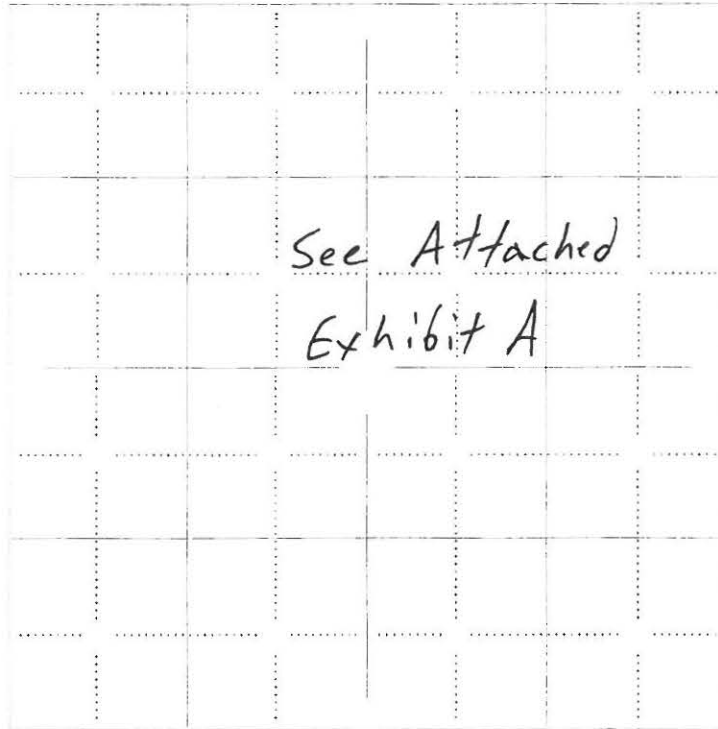

applicant well

producing well

plugged injection well

D &amp; A well

other injection well

temporary abandoned well

plugged producer

water supply well

The undersigned hereby certifies that he / she is a duly authorized agent for \_\_\_\_\_, and that all of the information shown herein is true, complete and correct to the best of his / her knowledge

Applicant or Duly Authorized Agent

Subscribed and sworn before me this 18th day of April, 2012

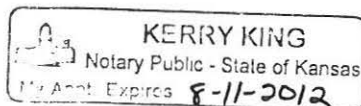

Notary Public

My Commission Expires 8-11-2012

RECEIVED  
 APR 27 2012  
 KCC WICHITA

Statewide View | Zoom to Location | Filter Wells | Label Wells | Download Wells | Print to PDF | Clear Highlight | Help

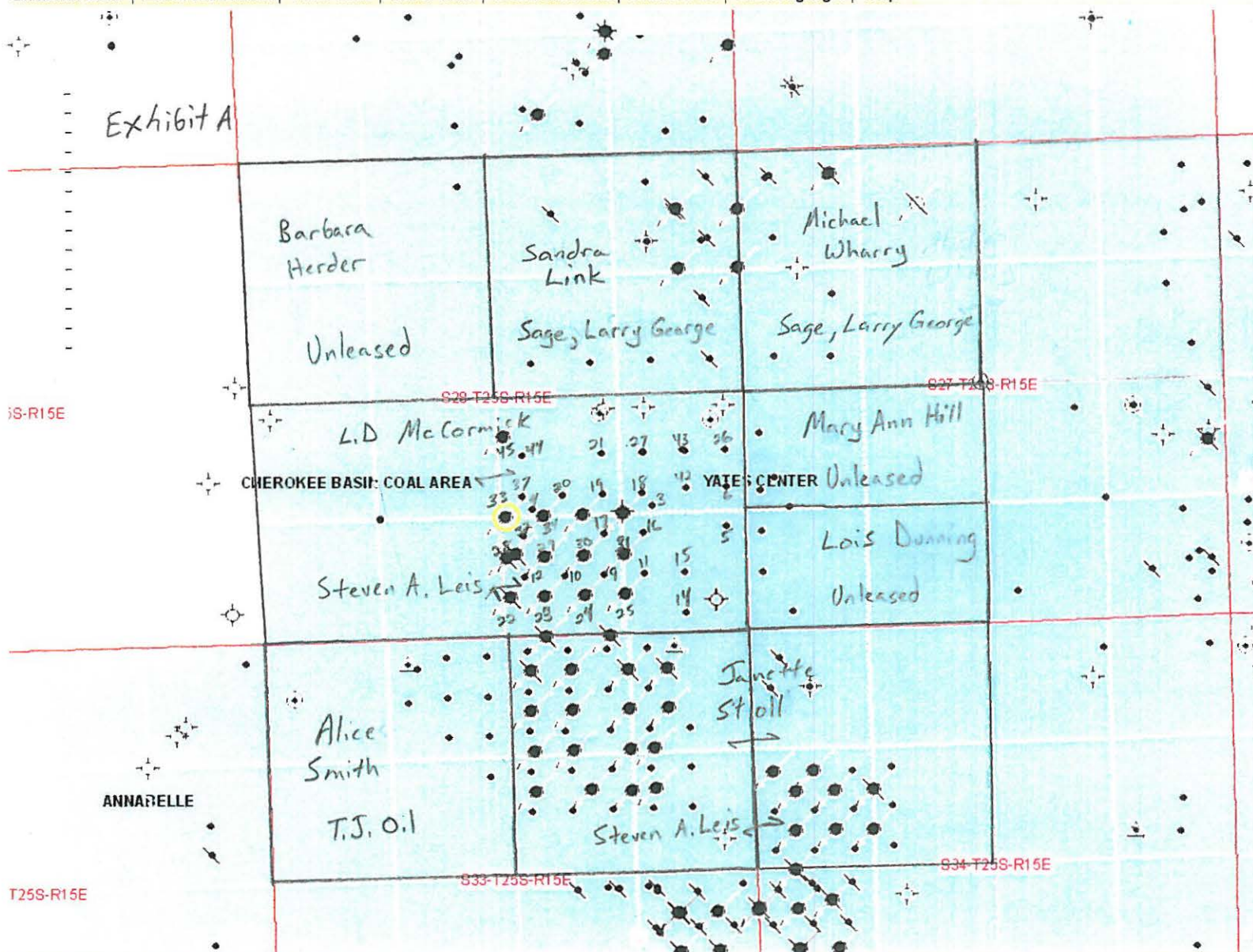

Layers Info Legend Links

#### OIL or GAS WELL

API: 15-207-23932-0001  
 Lease: HARTZLER  
 Well: 33  
 Original Operator:  
 Current Operator: Leis, John E.  
 Field: YATES CENTER  
 T25S R15E Sec. 28  
 NW NW SW SE  
 1300 North, 2630 West  
 from SE corner  
 Longitude: -95.7657068  
 Latitude: 37.8394676  
 County: Woodson  
 Permit Date:  
 Spud Date:  
 Completion Date:  
 Plugging Date:  
 Well Type: EOR  
 Status: Authorized Injection Well  
 Total Depth:  
 Elevation: 1112.0000 est.  
 Producing Formation:  
 IP Oil (bbl):  
 IP Water (bbl):  
 IP Gas (mcf):

#### Links:

- [Full KGS Database Entry](#)

0 0.125 0.25 0.5 Miles

RECEIVED  
 APR 27 2012  
 KCC WICHITA



## Affidavit of Notice Served

Re: Application for Steven A. LeisWell Name Harztler #33Legal Location NE NE NW SE S28-T25S-R15EThe undersigned hereby certifies that he / she is a duly authorized agent for the applicant and that on the day 18th of April2012 a true and correct copy of the application referenced above was delivered or mailed to the following parties



Note: A copy of this affidavit must be served as a part of the application

Name

Address (Attach additional sheets if necessary)

See Attached

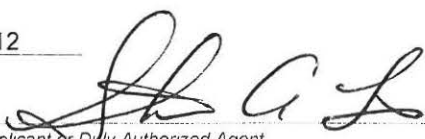
I further attest that notice of the filing of this application was published in the The Yates Center News, the official county publication of Woodson County county. A copy of the affidavit of this publication is attached

Signed this 18th day of April, 2012  
Applicant or Duly Authorized AgentSubscribed and sworn to before me this 18th day of April, 2012  
Notary PublicMy Commission Expires 8-11-2012

Protests may be filed by any party having a valid interest in the application. Petitions for protests shall be in writing and shall clearly identify the name and address of the protestant and the title of the application. The petition shall include a clear and concise statement of the direct and substantial interest of the protestant in the proceedings, including the manner in which the protestant may be affected, and the nature, extent, character and grounds of the protest. Protestants shall serve the protest upon the applicant by mail or personal service at the same time or before the protestant files the protest with the Conservation Division. Protests must be filed within 30 days of the publication notice of the application.

Mail to: KCC - Conservation Division, 130 S. Market - Room 2078, Wichita, Kansas 67202

RECEIVED  
APR 27 2012  
KCC WICHITA

Steven A. Leis  
1092 Osage Rd.  
Yates Center, KS 66783

I. LAND OWNERS

1. **L.D. & Cheryl McCormick**, 1266 80<sup>th</sup> Rd., Yates Center, Kansas 66783

Legal Description: S2, Section 28-T25S-R15E, Woodson County

2. **Barbara Herder Trust**, 16794 Logans Lake Rd., Boonville, MO 65233

Legal Description: NW4, Section 28-T25S-R15E, Woodson County

3. **Sandra Link**, Box 116, Williamsburg, KS 66095

Legal Description: NE4 Section 28-T25S-R15E, Woodson County

4. **Charles E. & Mary Ann Hill**, 1025 Prescott Dr., Lawrence, KS 66049

Legal Description: N2 SW4, Section 27-T25S-R15E, Woodson County

5. **Lois & Harold Dunning**, 17100 140<sup>th</sup> Rd., Erie, KS 66733

Legal Description: S2 SW4, Section 27-T25S-R15E, Woodson County

6. **Michael Wharry**, 1208 Jay Road, Yates Center, Kansas 66783

Legal Description: N2, Section 27-T25S-R15E, Woodson County

7. **Ernest & Eula Eggers**, 1019 Kansas St., Humboldt, KS 66748

Legal Description: NE4, Section 33-T25S-R15E &  
NW4, Section 34-T25S-R15E, Woodson County

8. **Alice Smith Estate**, 4 E. Jackson Ave., Iola, KS 66749

Legal Description: NW4, Section 33-T25S-R15E

II. OPERATORS

9. **Sage, Larry George**, P.O. Box 12, Virgil, KS 66870-0012

Legal Description: NE4 Section 28-T25S-15E &  
NW4 Section 27-T25S-15E, Woodson County

10. **T.J. Oil**, 120 N. Main St., Yates Center, KS 66783

Legal Description: NW4, Section 33-T25S-R15E, Woodson County

RECEIVED  
APR 27 2012  
KCC WICHITA



# Affidavit of Publication

STATE OF KANSAS,  
WOODSON COUNTY, ss:

Stewart Braden, being first duly sworn, deposes and says; That he is Publisher of The Yates Center NEWS, a weekly newspaper printed in the State of Kansas, and published in and of general circulation in Woodson County, Kansas, with a general circulation in Woodson County, Kansas, with a general paid circulation on a weekly basis in Woodson County, Kansas, and that said newspaper is not a trade, religious or fraternal publication.

Said newspaper is a weekly, published at least weekly 50 times a year; has been so published continuously and uninterrupted in said county and state for a period of more than five years prior to the first publication of said notice; and has been admitted at the post office in Yates Center in said County as second class matter.

The attached notice is a true copy thereof and was published in the regular and entire issue of said newspaper for.....1..... consecutive weeks, the first publication thereof being made as afore said on the.....19.....day of.....April....., 2012....., with subsequent publication being made on the following dates:

2nd Publication was made on the.....day of....., 20.....

3rd Publication was made on the.....day of....., 20.....

4th Publication was made on the.....day of....., 20.....

5th Publication was made on the.....day of....., 20.....

6th Publication was made on the.....day of....., 20.....

(Sign) Stewart Braden

Printer's Fees \$ 59.00

Affidavit, Notary's Fees \$ 2.50

Additional Copies \$

Total Fee \$ 61.50

Subscribed and sworn to before me on this 20 day of April, 2012.

(Sign) Theodore Scott Lowder  
Notary Public

My appointment expires: Feb 28, 2015

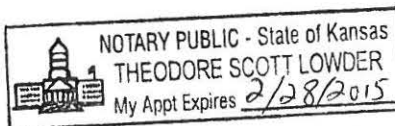

No.....

Plaintiff  
vs.

Defendant

Examined and approved:

Date.....

Judge

RECEIVED

APR 27 2012

KCC WICHITA

## Public Notice

(First published in The Yates Center NEWS on Thursday, April 19, 2012) 16-1tc

### BEFORE THE STATE CORPORATION COMMISSION OF THE STATE OF KANSAS NOTICE OF FILING APPLICATION

RE: Steven A. Leis - Application for a permit to authorize the enhanced recovery of saltwater into the Hartzler Lease, well #33; located in Woodson County, KS.

TO: All Oil & Gas Producers, Unleased Mineral Interest Owners, Landowners, and all persons whomever concerned.

You, and each of you, are hereby notified that Steven A. Leis has filed an application to commence the injection of saltwater into the Squirrel formation on the Hartzler Lease, well #33; 1320 feet from the South Line, 2540 feet from the East line located in the Southeast quarter of section 28, Township 25 S, Range 15E, Woodson County, KS., with a maximum operating pressure of 500 psig and a maximum injection rate of 50 bbls per day.

Any persons who object to or protest this application shall be required to file their objections or protests with the Conservation Division of the State Corporation Commission of the State of Kansas within fifteen [15] days from the date of the publication. These protests shall be filed pursuant to Commission regulations and must state specific reasons why the grant of the application may cause waste, violate correlative rights, or pollute the natural resources of the State of Kansas.

All persons interested of concerned shall take notice of the foregoing and shall govern themselves accordingly.

Steven A. Leis  
1092 Osage Rd.  
Yates Center, KS 66783  
620-330-6328

KANSAS CORPORATION COMMISSION  
OIL & GAS CONSERVATION DIVISION  
APPLICATION FOR INJECTION WELL

Form U-1  
November 2011  
Form must be Typed  
Form must be Signed  
All blanks must be Filled

Disposal ☐  
Enhanced Recovery ☒ Repressuring  
☐ Waterflood  
☐ Tertiary  
Date 04/02/2012  
Operator License Number 33960  
Operator Steven A. Leis  
Address 1092 Osage Rd.  
Yates Center, KS 66783  
Contact Person Steven A. Leis  
Phone 620-330-6328  
Email haylr@yahoo.com

Permit Number E-21983  
API Number 15-207-23933  
Well Location (5/19/83 APPROVAL DATE ON RBDMS)  
NW - NE - NW. SE Sec 28 Twp 25 S R 15 ☒ E ☐ W  
1320 feet from ☐ N / ☒ S Line of Section  
2100 feet from ☒ E / ☐ W Line of Section  
GPS Location Lat (e.g. xx xxxxx) Long (e.g. -xxx xxxxx)  
Datum ☒ NAD27 ☐ NAD83 ☐ WGS84  
Lease Description SE4 S28-T25S-R15E  
Lease Name Hartzler Well Number 34  
Field Name Yates Center  
County Woodson  
Deepest Usable Water  
Formation n/a  
Depth to Bottom of Formation 200+

Check One ☒ Old Well Being Converted ☐ Newly Drilled Well ☐ Well to be Drilled  
Surface Elevation 1135 feet Well Total Depth 1224 feet Plug Back Depth 1217 feet  
Datum of top of injection formation 1164 (-29) feet (reference mean sea level)

**Injection Formation Description:**

Name	top / bottom	perf / open hole	depth
Squirrel	1164 / 1173	Perf.	1164 to 1173 feet

**List of Wells/Facilities Supplying Produced Saltwater or Other Fluids Approved by the Conservation Division:**  
(attach additional sheets if necessary)

Lease Operator	Lease/Facility Name	Lease/Facility Description	Well ID & Spot Location
1. Steven A. Leis	Hartzler	SE4 S28-T25S-R15E	All Producing Wells
2.			
3.			

Producing Formation	Strata Depth	Total Dissolved Solids (if available)
1. Squirrel	1140 to 1182 feet	n/a
2.		
3.		

Maximum Requested Liquid Injection Rate 0-50 bbls / day, or  
Maximum Requested Gas Injection Rate n/a scf / day Type of Gas  
Maximum Requested Injection Pressure 0-500 psig

Mail to: KCC - Conservation Division, 130 S. Market - Room 2078, Wichita, Kansas 67202

RECEIVED  
APR 27 2012  
KCC WICHITA

**Well Completion**Type ☐ Tubing & Packer ☒ Packerless ☐ Tubingless

	Conductor	Surface	Intermediate	Production	Tubing
Size		6 1/4"		2 1/2"	
Setting Depth		50'		1217'	
Amount of Cement		15 Sacks		140 Sacks Est.	
Top of Cement		Surface		Surface	
Bottom of Cement		50'		1217'	

If Alternate II cementing, complete the following

Perforations / D V Tool at n/a feet, cemented to n/a feet with n/a sxTubing Type 2.5" 6.5# Grade J-55Packer Type n/a Depth 1217'Annulus Corrosion Inhibitor Type n/a Concentration n/aList Logs Enclosed Gamma Ray/Neutron**Well Sketch**

(To sketch installation, darken the appropriate lines, indicate cement and show depths.)

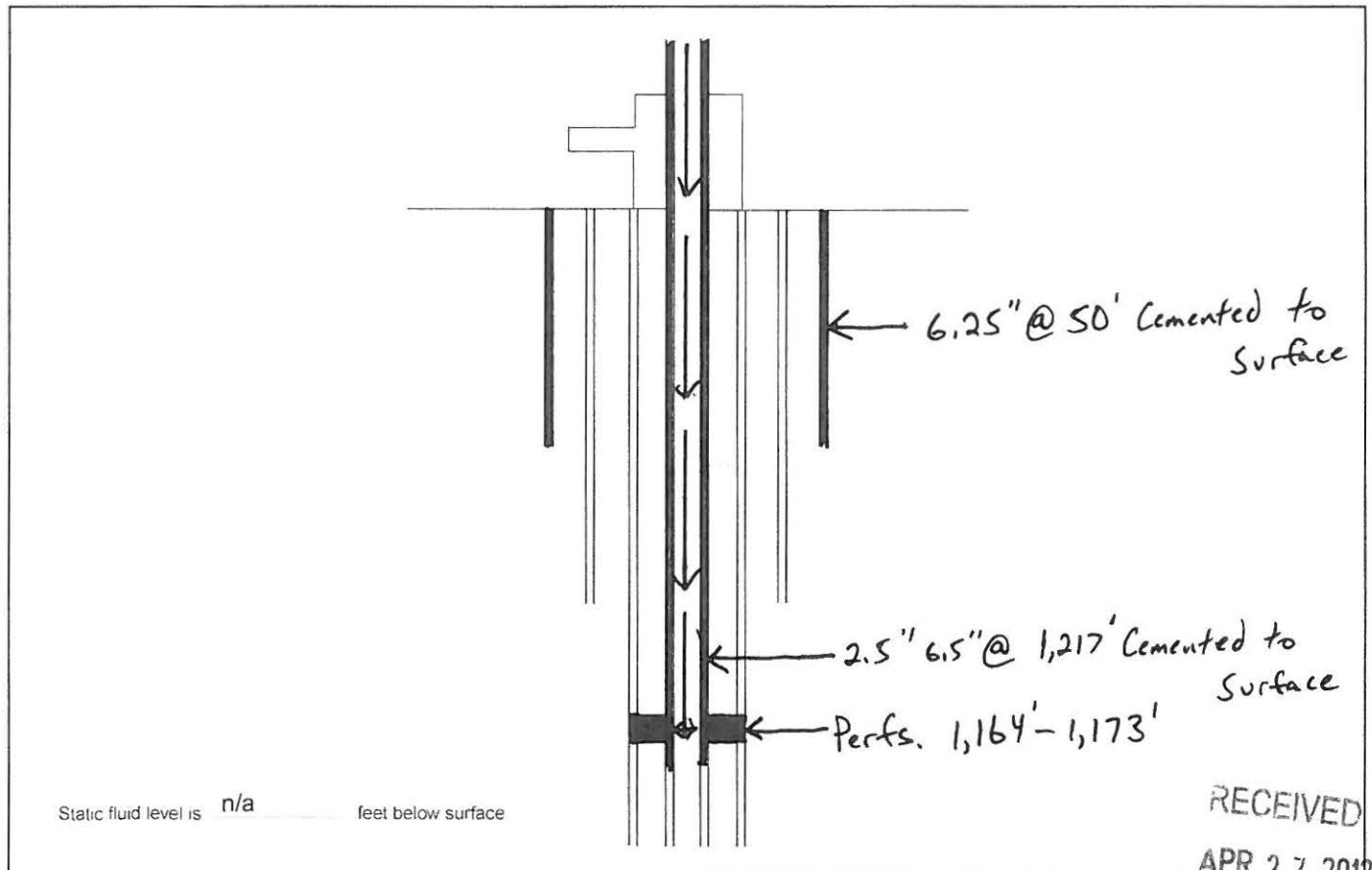

RECEIVED

APR 27 2012

KCC WICHITA

**Offset Operators, Unleased Mineral Owners and Landowners acreage**

(Attach additional sheets if necessary)

Name

Legal Description of Leasehold

See Attached

I hereby certify that the statements made herein are true and correct to the best of my knowledge and belief

Applicant or Duty Authorized Agent

Subscribed and sworn before me this 18th day of April, 2012

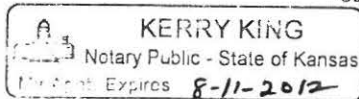

Notary Public

My Commission Expires

8-11-2012

**Instructions:**

1. Fully complete application, including page 4 (plat map) showing subject well and all known oil, gas and input wells, including wells being drilled, inactive wells, or dry holes, within one-half mile. Show lease names and operators or unleased mineral rights owners of all lands within one-half mile. Show well numbers and elevations of producing formation tops.
2. Attach some type of log (drillers log, electric log, etc.).
3. Attach some type of verification of cementing for surface casing, longstring, D V tool, perforations, etc. (Cement ticket and job log, bond log, etc.).
4. Attach Affidavit of Notice.
5. Fill in schematic drawing of subsurface facilities including: size, setting depth, amount of cement, measured or calculated tops of cement for each of surface, intermediate (if any) and production casing, size and setting depth of tubing and packer, geological zone of injection showing top and bottom of injection interval.
6. The original and one copy of the application and all attachments shall be mailed to the State Corporation Commission, Conservation Division.
7. Deliver or mail one (1) copy of the application to the landowner on whose land the injection well is located and to each operator or lessee of record and each unleased mineral rights owner within one-half mile of the applicant well.
8. Approval of this application, if granted, is valid only as long as there are no substantial changes in operation set forth in the application. A substantial change requires the approval of a new application. **No injection well may be used without prior written authorization.**
9. All application fees must accompany the application.

RECEIVED  
APR 27 2012  
KCC WICHITA

Steven A. Leis  
1092 Osage Rd.  
Yates Center, KS 66783

I. LAND OWNERS

1. **L.D. & Cheryl McCormick**, 1266 80<sup>th</sup> Rd., Yates Center, Kansas 66783

Legal Description: S2, Section 28-T25S-R15E, Woodson County

2. **Barbara Herder Trust**, 16794 Logans Lake Rd., Boonville, MO 65233

Legal Description: NW4, Section 28-T25S-R15E, Woodson County

3. **Sandra Link**, Box 116, Williamsburg, KS 66095

Legal Description: NE4 Section 28-T25S-R15E, Woodson County

4. **Charles E. & Mary Ann Hill**, 1025 Prescott Dr., Lawrence, KS 66049

Legal Description: N2 SW4, Section 27-T25S-R15E, Woodson County

5. **Lois & Harold Dunning**, 17100 140<sup>th</sup> Rd., Erie, KS 66733

Legal Description: S2 SW4, Section 27-T25S-R15E, Woodson County

6. **Michael Wharry**, 1208 Jay Road, Yates Center, Kansas 66783

Legal Description: N2, Section 27-T25S-R15E, Woodson County

7. **Ernest & Eula Eggers**, 1019 Kansas St., Humboldt, KS 66748

Legal Description: NE4, Section 33-T25S-R15E &  
NW4, Section 34-T25S-R15E, Woodson County

8. **Alice Smith Estate**, 4 E. Jackson Ave., Iola, KS 66749

Legal Description: NW4, Section 33-T25S-R15E

II. OPERATORS

9. **Sage, Larry George**, P.O. Box 12, Virgil, KS 66870-0012

Legal Description: NE4 Section 28-T25S-15E &  
NW4 Section 27-T25S-15E, Woodson County

10. **T.J. Oil**, 120 N. Main St., Yates Center, KS 66783

Legal Description: NW4, Section 33-T25S-R15E, Woodson County

RECEIVED  
APR 27 2012  
KCC WICHITA



**Plat and Certificate of Injection Well Location and Surrounding Acreages**

Operator Steven A. Leis Location of Well NW NE NW SE  
 Lease Hartzler 1320 feet from ☐ N / ☒ S Line of Section  
 Well Number 34 2100 feet from ☒ E / ☐ W Line of Section  
 County Woodson Sec 28 Twp 25 S R. 15 ☒ East ☐ West

**Plat**

Show the following information: applicant injection well, all producing wells, inactive wells, plugged wells, and other wells within a one-half mile radius, all lease boundaries, lease operators, unleased mineral rights owners, well numbers, and producing wells producing formation tops

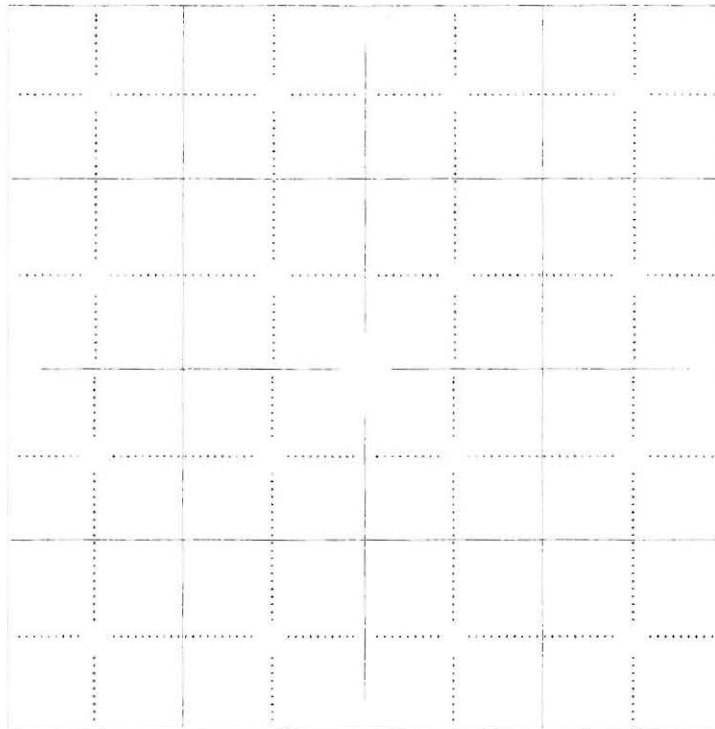

applicant well

producing well

plugged injection well

D &amp; A well

other injection well

temporary abandoned well

plugged producer

water supply well

The undersigned hereby certifies that he / she is a duly authorized agent for \_\_\_\_\_, and that all of the information shown herein is true, complete and correct to the best of his / her knowledge

Applicant or Duly Authorized Agent

Subscribed and sworn before me this 18th day of April, 2012

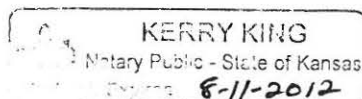

Notary Public

My Commission Expires 8-11-2012

RECEIVED  
APR 27 2012  
KCC WICHITA

Statewide View | Zoom to Location | Filter Wells | Label Wells | Download Wells | Print to PDF | Clear Highlight | Help

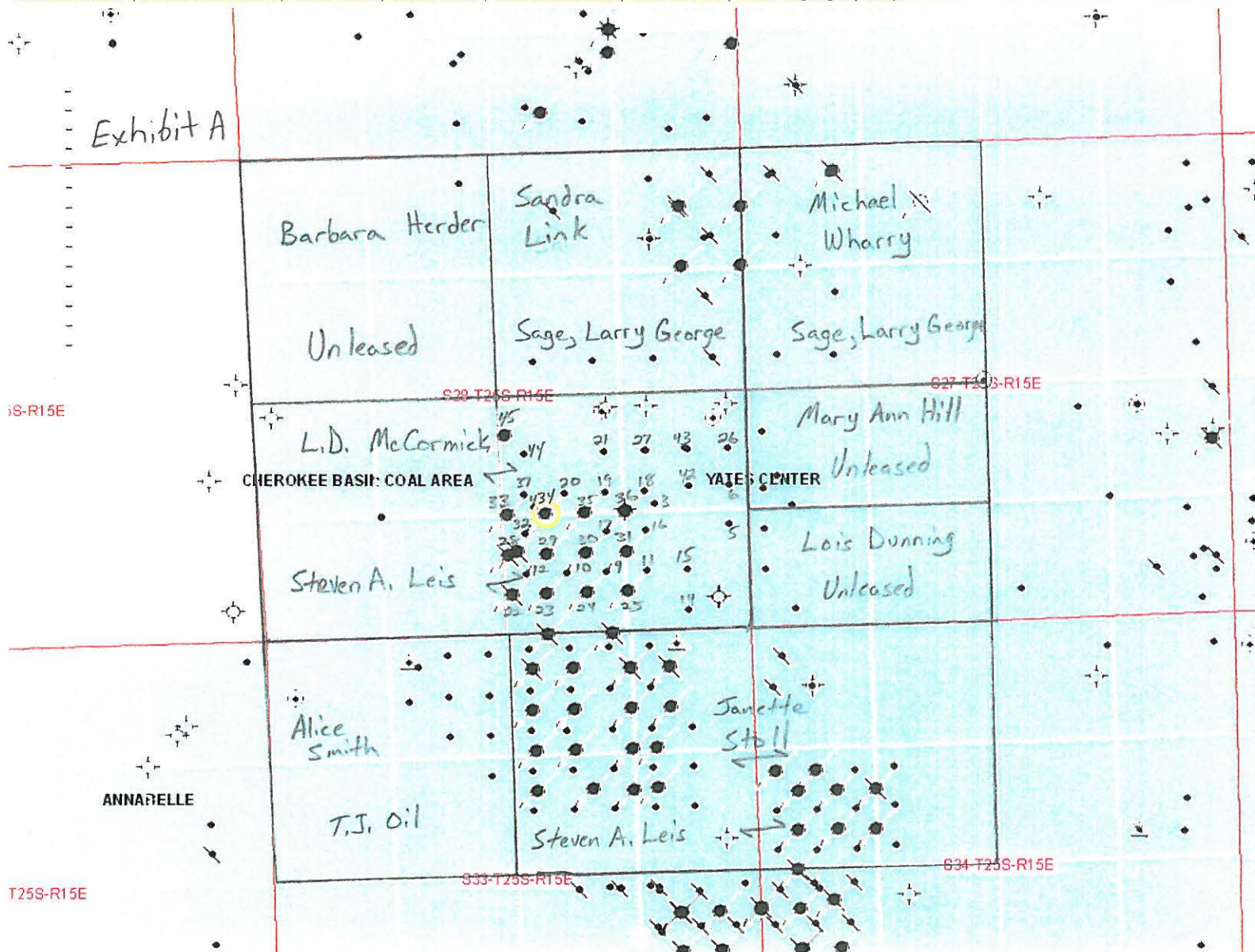

Layers Info Legend Links

#### OIL or GAS WELL

API: 15-207-23933-0001  
 Lease: HARTZLER  
 Well: 34  
 Original Operator:  
 Current Operator: Leis, John E.  
 Field: YATES CENTER  
 T25S R15E Sec. 28  
 NE NW SW SE  
 1300 North, 2220 West  
 from SE corner  
 Longitude: -95.7642877  
 Latitude: 37.8394640  
 County: Woodson  
 Permit Date:  
 Spud Date:  
 Completion Date:  
 Plugging Date:  
 Well Type: EOR  
 Status: Authorized Injection Well  
 Total Depth:  
 Elevation: 1113.0000 est.  
 Producing Formation:  
 IP Oil (bbl):  
 IP Water (bbl):  
 IP Gas (mcf):

#### Links:

- [Full KGS Database Entry](#)

RECEIVED  
 APR 27 2012  
 KCC WICHITA

0 0.125 0.25 0.5 Miles

## Affidavit of Notice Served

Re: Application for Steven A. Leis

Well Name Harztler #34

Legal Location NW NE NW SE S28-T25S-R15E

The undersigned hereby certifies that he / she is a duly authorized agent for the applicant and that on the day 18th of April

2012 a true and correct copy of the application referenced above was delivered or mailed to the following parties

Note A copy of this affidavit must be served as a part of the application

Name

Address (Attach additional sheets if necessary)

See Attached

I further attest that notice of the filing of this application was published in the The Yates Center News, the official county publication of Woodson County county. A copy of the affidavit of this publication is attached

Signed this 18th day of April 2012

  
Applicant or Duty Authorized Agent

Subscribed and sworn to before me this 18th day of April 2012

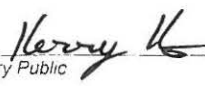
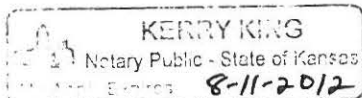
  
Notary Public

My Commission Expires 8-11-2012

Protests may be filed by any party having a valid interest in the application. Petitions for protests shall be in writing and shall clearly identify the name and address of the protestant and the title of the application. The petition shall include a clear and concise statement of the direct and substantial interest of the protestant in the proceedings, including the manner in which the protestant may be affected, and the nature, extent, character and grounds of the protest. Protestants shall serve the protest upon the applicant by mail or personal service at the same time or before the protestant files the protest with the Conservation Division. Protests must be filed within 30 days of the publication notice of the application.

Mail to: KCC - Conservation Division, 130 S. Market - Room 2078, Wichita, Kansas 67202

RECEIVED  
APR 27 2012  
KCC WICHITA

Steven A. Leis  
1092 Osage Rd.  
Yates Center, KS 66783

I. LAND OWNERS

1. **L.D. & Cheryl McCormick**, 1266 80<sup>th</sup> Rd., Yates Center, Kansas 66783

Legal Description: S2, Section 28-T25S-R15E, Woodson County

2. **Barbara Herder Trust**, 16794 Logans Lake Rd., Boonville, MO 65233

Legal Description: NW4, Section 28-T25S-R15E, Woodson County

3. **Sandra Link**, Box 116, Williamsburg, KS 66095

Legal Description: NE4 Section 28-T25S-R15E, Woodson County

4. **Charles E. & Mary Ann Hill**, 1025 Prescott Dr., Lawrence, KS 66049

Legal Description: N2 SW4, Section 27-T25S-R15E, Woodson County

5. **Lois & Harold Dunning**, 17100 140<sup>th</sup> Rd., Erie, KS 66733

Legal Description: S2 SW4, Section 27-T25S-R15E, Woodson County

6. **Michael Wharry**, 1208 Jay Road, Yates Center, Kansas 66783

Legal Description: N2, Section 27-T25S-R15E, Woodson County

7. **Ernest & Eula Eggers**, 1019 Kansas St., Humboldt, KS 66748

Legal Description: NE4, Section 33-T25S-R15E &  
NW4, Section 34-T25S-R15E, Woodson County

8. **Alice Smith Estate**, 4 E. Jackson Ave., Iola, KS 66749

Legal Description: NW4, Section 33-T25S-R15E

II. OPERATORS

9. **Sage, Larry George**, P.O. Box 12, Virgil, KS 66870-0012

Legal Description: NE4 Section 28-T25S-15E &  
NW4 Section 27-T25S-15E, Woodson County

10. **T.J. Oil**, 120 N. Main St., Yates Center, KS 66783

Legal Description: NW4, Section 33-T25S-R15E, Woodson County

RECEIVED  
APR 27 2012  
KCC WICHITA



# Affidavit of Publication

STATE OF KANSAS,  
WOODSON COUNTY, ss:

Stewart Braden, being first duly sworn, deposes and says; That he is Publisher of The Yates Center NEWS, a weekly newspaper printed in the State of Kansas, and published in and of general circulation in Woodson County, Kansas, with a general circulation in Woodson County, Kansas, with a general paid circulation on a weekly basis in Woodson County, Kansas, and that said newspaper is not a trade, religious or fraternal publication.

Said newspaper is a weekly, published at least weekly 50 times a year; has been so published continuously and uninterrupted in said county and state for a period of more than five years prior to the first publication of said notice; and has been admitted at the post office in Yates Center in said County as second class matter.

The attached notice is a true copy thereof and was published in the regular and entire issue of said newspaper for.....1..... consecutive weeks, the first publication thereof being made as

afore said on the.....19.....day of.....april....., 2012....., with subsequent publication being made on the following dates:

2nd Publication was made on the.....day of....., 20.....

3rd Publication was made on the.....day of....., 20.....

4th Publication was made on the.....day of....., 20.....

5th Publication was made on the.....day of....., 20.....

6th Publication was made on the.....day of....., 20.....

(Sign).....*Stewart Braden*.....

Printer's Fees \$ 59.00

Affidavit, Notary's Fees \$ 2.50

Additional Copies \$

Total Fee \$ 61.50

Subscribed and sworn to before me on this.....20.....day of.....April....., 2012.....

(Sign).....*Theodore Scott Lowder*.....  
Notary Public

My appointment expires:.....Feb 28, 2015.....

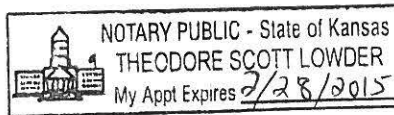

No.....

Plaintiff  
vs.

Defendant

Examined and approved:

Date.....

Judge

## Public Notice

(First published in The Yates Center NEWS on Thursday, April 19, 2012) 16-1tc

### BEFORE THE STATE CORPORATION COMMISSION OF THE STATE OF KANSAS NOTICE OF FILING APPLICATION

RE: Steven A. Leis - Application for a permit to authorize the enhanced recovery of saltwater into the Hartzler Lease, well #34; located in Woodson County, KS.  
TO: All Oil & Gas Producers, Unleased Mineral Interest Owners, Landowners, and all persons whomever concerned.

You, and each of you, are hereby notified that Steven A. Leis has filed an application to commence the injection of saltwater into the Squirrel formation on the Hartzler Lease, well #34; 1320 feet from the South Line, 2100 feet from the East line located in the Southeast quarter of section 28, Township 25 S, Range 15E, Woodson County, KS., with a maximum operating pressure of 500 psig and a maximum injection rate of 50 bbls per day.

Any persons who object to or protest this application shall be required to file their objections or protests with the Conservation Division of the State Corporation Commission of the State of Kansas within fifteen [15] days from the date of the publication. These protests shall be filed pursuant to Commission regulations and must state specific reasons why the grant of the application may cause waste, violate correlative rights, or pollute the natural resources of the State of Kansas.

All persons interested of concerned shall take notice of the foregoing and shall govern themselves accordingly.

Steven A. Leis  
1092 Osage Rd.  
Yates Center, KS 66783  
620-330-6328

RECEIVED

APR 27 2012

KCC WICHITA