

**THE STATE CORPORATION COMMISSION
OF THE STATE OF KANSAS**

Before Commissioners: Andrew J. French, Chairperson
 Dwight D. Keen
 Susan K. Duffy

In the matter of the failure of Prairie Gas)	Docket No.: 21-CONS-3199-CPEN
Operating, LLC (Operator) to comply with)	
K.A.R. 82-3-111 at twenty-seven wells in)	CONSERVATION DIVISION
Greeley and Hamilton Counties, Kansas.)	
)	License No.: 35442

PENALTY ORDER

The Commission finds Operator has violated K.A.R. 82-3-111 at the captioned wells, assesses a \$20,000 penalty, directs Operator to bring the wells into compliance, and further rules as more fully described below.

I. JURISDICTION

1. K.S.A. 74-623 provides the Commission exclusive jurisdiction and authority to regulate oil and gas activities in Kansas. K.S.A. 55-152 provides the Commission with jurisdiction to regulate the construction, operation, and abandonment of any well, and also the protection of the usable water of this state from any actual or potential pollution from any well. The Commission has licensing authority under K.S.A. 55-155.

2. K.S.A. 55-162 and K.S.A. 55-164 provide the Commission authority to issue penalty orders for violations of Chapter 55 of the Kansas Statutes Annotated, or of any rule, regulation, or order of the Commission. Under K.S.A. 55-164, a penalty order may include a monetary penalty of up to \$10,000, the penalty must constitute a substantial and actual economic deterrent to the violation, and each day of a continuing violation constitutes a separate violation.

3. K.A.R. 82-3-111 provides that within 90 days after operations cease on any well, the operator of that well shall plug the well, return the well to service, or file an application with

the Conservation Division requesting temporary abandonment (TA) status. If not plugged or returned to service, the operator must obtain TA approval; TA status may be denied by the Conservation Division if necessary to prevent pollution. A well shut-in for 10 years or more cannot be granted TA status without the operator filing an application for an exception pursuant to K.A.R. 82-3-100 and approval from the Commission. K.A.R. 82-3-111(e) provides a TA exemption for certain wells fully equipped and capable of production.

II. FINDINGS OF FACT

4. Operator is licensed to conduct oil and gas activities in Kansas.
5. Operator is responsible for the care and control of the following wells (Subject Wells):
 - a. Adams #1, API #15-071-20107, located in Section 2, Township 17 South, Range 40 West, Greeley County, Kansas;
 - b. Barker #1-10, API #15-071-20840-00-00, located in Section 10, Township 19 South, Range 40 West, Greeley County, Kansas;
 - c. Burske #2, API #15-071-20659-00-00, located in Section 2, Township 20 South, Range, 40 West, Greeley County, Kansas;
 - d. Chester #1, API #15-071-20087-00-00, located in Section 19, Township 17 South, Range 40 West, Greeley County, Kansas;
 - e. Clift #1-9, API #15-071-20103-00-00, located in Section 9, Township 19 South, Range 40 West, Greeley County, Kansas;
 - f. Clift B #3-34, API #15-071-20822-00-00, located in Section 34, Township 18 South, Range 40 West, Greeley County, Kansas;
 - g. Drake #3-27, API #15-071-20804-00-00, located in Section 27, Township 20 South, Range 40 West, Greeley County, Kansas;
 - h. Floyd A #1, API #15-071-20047-00-00, located in Section 25, Township 19 South, Range 40 West, Greeley County, Kansas;
 - i. Foster #1, API #15-071-20136-00-00, located in Section 7, Township 20 South, Range 39 West, Greeley County, Kansas;

- j. Gibb #1, API #15-071-20151-00-00, located in Section 28, Township 17 South, Range 40 West, Greeley County Kansas;
- k. Hermann #1, API #15-075-20704-00-00, located in Section 9, Township 23 South, Range 40 West, Hamilton County, Kansas;
- l. Hoffman G #32-1, API #15-071-20357-00-00, located in Section 32, Township 18 South, Range 40 West, Greeley County, Kansas;
- m. Kuttler #1, API #15-071-20299-00-00, located in Section 4, Township 20 South, Range 39 West, Greeley County, Kansas;
- n. Kuttler A #1, API #15-071-20224-00-00, located in Section 29, Township 19 South, Range 39 West, Greeley County, Kansas;
- o. Kuttler B #1, API #15-071-20231-00-00, located in Section 33, Township 19 South, Range 39 West, Greeley County, Kansas;
- p. Kuttler D #1, API #15-071-20238, located in Section 20, Township 19 South, Range 39 West, Greeley County, Kansas;
- q. Kuttler E #1, API #15-071-20240, located in Section 29, Township 19 South, Range 39 West, Greeley County, Kansas;
- r. Kuttler G #1, API #15-071-20753, located in Section 29, Township 19 South, Range 39 West, Greeley County, Kansas;
- s. Kuttler H #1, API #15-071-20755-00-00, located in Section 29, Township 19 South, Range 39 West, Greeley County, Kansas;
- t. Nickelson #1-4, API #15-071-20617-00-01, located in Section 4, Township 20 South, Range 39 West, Greeley County, Kansas;
- u. Ross #2, API #15-071-20182-00-00, located in Section 5, Township 18 South, Range 39 West, Greeley County, Kansas;
- v. Sandifer #2, API #15-071-20752-00-00, located in Section 33, Township 19 South, Range 39 West, Greeley County, Kansas;
- w. Sandifer A #1, API #15-071-20379-00-00, located in Section 33, Township 19 South, Range 39 West, Greeley County, Kansas;
- x. Sell A #2-3, API #15-071-20821-00-00, located in Section 3, Township 19 South, Range 40 West, Greeley County, Kansas;
- y. Spears #2, API #15-071-20246-00-00, located in Section 5, Township 20 South, Range 40 West, Greeley County, Kansas;

- z. Sugar #1, API #15-075-20793, located in Section 24, Township 23 South, Range 40 West, Hamilton County, Kansas; and
- aa. West #1, API #15-071-20180-00-00, located in Section 28, Township 19 South, Range 40 West, Greeley County, Kansas.

6. Because Commission records indicated the Subject Wells: (1) had been inactive and unplugged for longer than the 90 days allowed by K.A.R. 82-3-111; (2) were not exempt pursuant to K.A.R. 82-3-111(e), and (3) had not been approved for TA status, Commission Staff sent the following Notice of Violation (NOV) letters to Operator. The NOV letters collectively addressed all of the Subject Wells, and required Operator's compliance with K.A.R. 82-3-111:

- a. On June 16, 2020, an NOV letter regarding the Floyd A #1, requiring compliance with K.A.R. 82-3-111 by July 16, 2020;
- b. On July 21, 2020, NOV letters regarding the Chester #1, Kuttler #1, and Ross #2, requiring compliance with K.A.R. 82-3-111 by August 20, 2020;
- c. On September 8, 2020, an NOV letter regarding the Hermann #1, requiring compliance with K.A.R. 82-3-111 by October 6, 2020;
- d. On October 20, 2020, an NOV letter regarding the Foster #1, requiring compliance with K.A.R. 82-3-111 by November 19, 2020;
- e. On November 10, 2020, NOV letters regarding the Barker #1-10, Burske #2, Clift B #3-34, Drake #3-27, Kuttler H #1, Nickelson #1-4, Sandifer #2, Spears #2, and West #1, requiring compliance with K.A.R. 82-3-111 by December 8, 2020;
- f. On December 11, 2020, NOV letters regarding the Adams #1, Kuttler D #1, Kuttler E #1, Kuttler G #1, and Sugar #1, requiring compliance with K.A.R. 82-3-111 by January 8, 2021;
- g. On January 5, 2021, an NOV letter regarding the Hoffman G #32-1, requiring compliance with K.A.R. 82-3-111 by February 4, 2021;
- h. On January 12, 2021, NOV letters regarding the Clift #1-9 and Gibb #1, requiring compliance with K.A.R. 82-3-111 by February 9, 2021; and

- i. On January 22, 2021, NOV letters regarding the Kuttler A #1, Kuttler B #1, Sandifer A #1 and Sell A #2-3, requiring compliance with K.A.R. 82-3-111 by February 19, 2021.¹

7. Upon expiration of the respective deadlines in Staff's letters, Staff inspected the Subject Wells, verifying the wells continued to be inactive and unplugged without TA status.²

8. Operator obtained its license in March 2017. Since then, Operator has been penalized in the following seventeen dockets: 18-CONS-3125-CPEN, 18-CONS-3128-CPEN, 18-CONS-3181-CPEN, 18-CONS-3203-CPEN, 18-CONS-3253-CPEN, 18-CONS-3278-CPEN, 18-CONS-3327-CPEN, 19-CONS-3050-CPEN, 19-CONS-3059-CPEN, 19-CONS-3265-CPEN, 19-CONS-3396-CPEN, 20-CONS-3007-CPEN, 20-CONS-3018-CPEN, 20-CONS-3117-CPEN, 20-CONS-3129-CPEN, 20-CONS-3144-CPEN, and 20-CONS-3220-CPEN. Operator's license was suspended for non-compliance with the Commission's penalty orders in ten of those dockets. Further, nine of the seventeen dockets involved K.A.R. 82-3-111 violations; of those, four resulted in license suspensions for non-compliance with the Commission's penalty orders.³

III. CONCLUSIONS OF LAW

9. The Commission has jurisdiction over Operator and this matter under K.S.A. 74-623 and K.S.A. 55-152.

10. Operator has committed 27 violations of K.A.R. 82-3-111 because the Subject Wells have been inactive in excess of the time allowed by regulation without being plugged, returned to service, or approved for TA status.⁴

11. K.S.A 55-164 provides that Commission penalties "shall constitute an actual and substantial economic deterrent to the violation for which the penalty is assessed." Given

¹ See Exhibit A (containing all NOV letters).

² See Exhibit B.

³ To reach these findings, the Commission takes administrative notice of its records. See K.A.R. 82-1-230(h).

⁴ K.S.A. 55-164; K.A.R. 82-3-111(b).

Operator's previous violations, the number of wells currently in violation of K.A.R. 82-3-111, and the extended timeframes involved, a heightened penalty is necessary to provide the actual and substantial economic deterrent contemplated in K.S.A. 55-164.

THEREFORE, THE COMMISSION ORDERS:

- A. Operator shall pay a \$20,000 penalty.
- B. Operator shall plug the Subject Wells, or return the wells to service, or obtain TA status for the wells if eligible.
- C. Commission Staff may require Staff-witnessed static fluid level measurements before a Subject Well is returned to service. A Subject Well may not be returned to service if (1) any measurement has shown fluid in the wellbore at or above the appropriate minimum surface casing requirement described in Table I of the Commission's August 1, 1991, Order in Docket 34,780, (2) any measurement has shown fluid in the wellbore at or above any salt formation or other corrosive formation, or (3) in the opinion of Staff, variation in measurements indicates the possibility of a casing leak. Provided, however, a Subject Well may be returned to service upon (1) passing a casing integrity test after issuance of this Penalty Order to the satisfaction of Staff, or (2) Staff providing written, well-specific authorization after issuance of this Penalty Order.
- D. Operator may request a hearing on the above issues by submitting a written request, pursuant to K.S.A. 55-164, K.S.A. 77-537, and K.S.A. 77-542, to the Commission at 266 N. Main St., Suite 220, Wichita, Kansas 67202, within 30 days from the date of service of this Order. A request for hearing must comply with K.A.R. 82-1-219.
- E. Failure to timely request a hearing will result in a waiver of Operator's right to a hearing. If no party timely requests a hearing, then this Order shall become final. If Operator is not in compliance with this Order and the Order is final, then Operator's license shall be

suspended without further notice and shall remain suspended until Operator complies. The notice and opportunity for a hearing on this Order shall constitute the notice required by K.S.A. 77-512 regarding license suspension. A party may petition for reconsideration of a final order pursuant to the requirements and time limits established by K.S.A. 77-529(a)(1).⁵.

F. Credit card payments may be made by calling the Conservation Division at 316-337-6200. Checks and money orders shall be payable to the Kansas Corporation Commission. Payments shall be mailed to the Kansas Corporation Commission at 266 N. Main St., Suite 220, Wichita, Kansas 67202. Payments must reference the docket number of this proceeding.

BY THE COMMISSION IT IS SO ORDERED.

French, Chairperson; Keen, Commissioner; Duffy, Commissioner

Dated: 04/13/2021



Lynn M. Retz
Executive Director

Mailed Date: 04/13/2021

KAM

⁵ See K.S.A. 55-162; K.S.A. 55-164; K.S.A. 55-606; K.S.A. 55-707; K.S.A. 77-503(c); K.S.A. 77-531(b).

Conservation Division
District Office No. 1
210 E. Frontview, Suite A
Dodge City, KS 67801



Phone: 620-682-7933
<http://kcc.ks.gov/>

Susan K. Duffy, Clerk
Shari Peist Albracht, Commissioner
Dwight D. Keen, Commissioner

Laura Kelly, Governor

June 16, 2020

Glade Inhofe
Prairie Gas Operating, LLC
114 E. 5TH ST., SUITE 100
PO BOX 2170
TULSA, OK 74101-2170

Re: Temporary Abandonment
API 15-071-20047-00-00
FLOYD A 1
NW/4 Sec.25-19S-40W
Greeley County, Kansas

Dear Glade Inhofe:

Your application for Temporary Abandonment (TA) for the above-listed well is denied for the following reasons(s):

High Fluid Level

Pursuant to K.A.R. 82-3-111, the well must be plugged, or returned to service, or obtain temporary abandonment status by 07/16/2020.

This deadline does NOT override any compliance deadline given to you in any Commission Order.

You may contact me if you have any questions.

Sincerely,
Michael Maier
KCC DISTRICT 1

Conservation Division
District Office No. 1
210 E. Frontview, Suite A
Dodge City, KS 67801



Phone: 620-682-7923
<http://kcc.ks.gov/>

Susan K. Duffy, Chair
Dwight D. Keen, Commissioner
Andrew J. French, Commissioner

Laura Kelly, Governor

July 21, 2020

**Glade Inhofe
Prairie Gas Operating, LLC
114 E. 5TH ST., SUITE 100
PO BOX 2170
TULSA, OK 74101-2170**

**Re: Temporary Abandonment
API 15-071-20087-00-00
CHESTER 1
SE/4 Sec.19-17S-40W
Greeley County, Kansas**

Dear Glade Inhofe:

Your application for Temporary Abandonment (TA) for the above-listed well is denied for the following reasons(s):

High Fluid Level

Pursuant to K.A.R. 82-3-111, the well must be plugged, or returned to service, or obtain temporary abandonment status by 08/20/2020.

This deadline does NOT override any compliance deadline given to you in any Commission Order.

You may contact me if you have any questions.

**Sincerely,
Michael Maier
KCC DISTRICT 1**

Conservation Division
District Office No. 1
210 E. Frontview, Suite A
Dodge City, KS 67801



Phone: 620-682-7933
<http://kcc.ks.gov/>

Susan K. Dully, Chair
Dwight D. Keen, Commissioner
Andrew J. French, Commissioner

Laura Kelly, Governor

July 21, 2020

Glade Inhofe
Prairie Gas Operating, LLC
114 E. 5TH ST., SUITE 100
PO BOX 2170
TULSA, OK 74101-2170

Re: Temporary Abandonment
API 15-071-20299-00-00
KUTTLER 1
NW/4 Sec.04-20S-39W
Greeley County, Kansas

Dear Glade Inhofe:

Your application for Temporary Abandonment (TA) for the above-listed well is denied for the following reasons(s):

High Fluid Level

Pursuant to K.A.R. 82-3-111, the well must be plugged, or returned to service, or obtain temporary abandonment status by 08/20/2020.

This deadline does NOT override any compliance deadline given to you in any Commission Order.

You may contact me if you have any questions.

Sincerely,
Michael Maier
KCC DISTRICT 1

Conservation Division
District Office No. 1
210 E. Frontview, Suite A
Dodge City, KS 67801



Phone: 620-682-7933
<http://kcc.ks.gov/>

Susan K. Duffy, Chair
Dwight D. Keen, Commissioner
Andrew J. French, Commissioner

Laura Kelly, Governor

July 21, 2020

Glade Inhofe
Prairie Gas Operating, LLC
114 E. 5TH ST., SUITE 100
PO BOX 2170
TULSA, OK 74101-2170

Re: Temporary Abandonment
API 15-071-20172-00-00
ROSS 2
NW/4 Sec.05-18S-39W
Greeley County, Kansas

Dear Glade Inhofe:

Your application for Temporary Abandonment (TA) for the above-listed well is denied for the following reasons(s):

High Fluid Level

Pursuant to K.A.R. 82-3-111, the well must be plugged, or returned to service, or obtain temporary abandonment status by 08/20/2020.

This deadline does NOT override any compliance deadline given to you in any Commission Order.

You may contact me if you have any questions.

Sincerely,
Michael Maier
KCC DISTRICT 1



Susan K. Duffy, Chair
Dwight D. Keen, Commissioner
Andrew J. French, Commissioner

Corporation Commission

Laura Kelly, Governor

NOTICE OF VIOLATION

September 08, 2020
KCC Lic.-35442

PRAIRIE GAS OPERATING, LLC
114 E. 5TH ST., SUITE 100
PO BOX 2170
TULSA OK 74101-2170

RE: **TEMPORARY ABANDONMENT**
API Well No. 15-075-20704-00-00
HERMANN 1
9-23S-40W, SE
HAMILTON County, Kansas

Operator:

On September 03, 2020, a lease inspection documented a probable violation of the following regulation at the referenced well:

- K.A.R. 82-3-111. Within 90 days after operations cease on a well, the operator must return the well to service, plug the well, or obtain approval for temporary abandonment status.

**Failure to remedy this violation
by OCTOBER 06, 2020
shall be punishable by a \$100 penalty.**

You may contact me if you have any questions.

Sincerely,

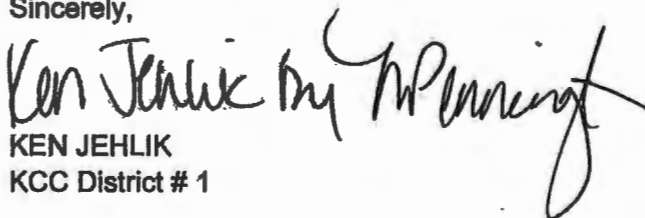
KEN JEHLIK
KCC District # 1

Conservation Division
District Office No. 1
210 E. Frontview, Suite A
Dodge City, KS 67801



Phone: 620-682-7933
<http://kcc.ks.gov/>

Steven K. Duffy, Chair
Dwight D. Keen, Commissioner
Andrew J. Fischl, Commissioner

Laura Kelly, Governor

October 20, 2020

Kristin Dinelli
Prairie Gas Operating, LLC
114 E. 5TH ST.
SUITE 100
TULSA, OK 74103

Re: Temporary Abandonment
API 15-071-20136-00-00
FOSTER 1
NW/4 Sec.07-20S-39W
Greeley County, Kansas

Dear Kristin Dinelli:

Your application for Temporary Abandonment (TA) for the above-listed well is denied for the following reasons(s):

High Fluid Level

Pursuant to K.A.R. 82-3-111, the well must be plugged, or returned to service, or obtain temporary abandonment status by 11/19/2020.

This deadline does NOT override any compliance deadline given to you in any Commission Order.

You may contact me if you have any questions.

Sincerely,
Michael Maier
KCC DISTRICT 1



Susan K. Duffy, Chair
Dwight D. Keen, Commissioner
Andrew J. French, Commissioner

Corporation Commission

Laura Kelly, Governor

NOTICE OF VIOLATION

PRAIRIE GAS OPERATING, LLC
114 E. 5TH ST., SUITE 100
PO BOX 2170
TULSA OK, 74101

November 10, 2020
KCC Lic. 35442

RE: TEMPORARY ABANDONMENT
API Well No. 15-071-20840-00-00
BARKER 1-10
10-19S-40W, S2SWSE
GREELEY County, Kansas

Operator:

On November 10, 2020, a file review documented a probable violation of the following regulation at the referenced well:

- K.A.R. 82-3-111. Within 90 days after operations cease on a well, the operator must return the well to service, plug the well, or obtain approval for temporary abandonment status.

**Failure to remedy this violation
by DECEMBER 08, 2020
shall be punishable by a \$100 penalty.**

You may contact me if you have any questions.

Sincerely,

MICHAEL MAIER
KCC District # 1



Susan K. Duffy, Chair
Dwight D. Keen, Commissioner
Andrew J. French, Commissioner

Corporation Commission

Laura Kelly, Governor

NOTICE OF VIOLATION

PRAIRIE GAS OPERATING, LLC
114 E. 5TH ST., SUITE 100
PO BOX 2170
TULSA OK, 74101

November 10, 2020
KCC Lic. 35442

RE: TEMPORARY ABANDONMENT
API Well No. 15-071-20659-00-00
BURSKE 2
2-20S-40W, E2E2SE
GREELEY County, Kansas

Operator:

On November 10, 2020, a file review documented a probable violation of the following regulation at the referenced well:

- K.A.R. 82-3-111. Within 90 days after operations cease on a well, the operator must return the well to service, plug the well, or obtain approval for temporary abandonment status.

**Failure to remedy this violation
by DECEMBER 08, 2020
shall be punishable by a \$100 penalty.**

You may contact me if you have any questions.

Sincerely,

MICHAEL MAIER
KCC District # 1



Susan K. Duffy, Chair
Dwight D. Keen, Commissioner
Andrew J. French, Commissioner

Corporation Commission

Laura Kelly, Governor

NOTICE OF VIOLATION

PRAIRIE GAS OPERATING, LLC
114 E. 5TH ST., SUITE 100
PO BOX 2170
TULSA OK, 74101

November 10, 2020
KCC Lic, 35442

RE: TEMPORARY ABANDONMENT
API Well No. 15-071-20822-00-00
CLIFT B 3-34
34-18S-40W, SE
GREELEY County, Kansas

Operator:

On November 10, 2020, a file review documented a probable violation of the following regulation at the referenced well:

► K.A.R. 82-3-111. Within 90 days after operations cease on a well, the operator must return the well to service, plug the well, or obtain approval for temporary abandonment status.

**Failure to remedy this violation
by DECEMBER 08, 2020
shall be punishable by a \$100 penalty.**

You may contact me if you have any questions.

Sincerely,

MICHAEL MAIER
KCC District # 1



Susan K. Duffy, Chair
Dwight D. Keen, Commissioner
Andrew J. French, Commissioner

Corporation Commission

Laura Kelly, Governor

NOTICE OF VIOLATION

PRAIRIE GAS OPERATING, LLC
114 E. 5TH ST., SUITE 100
PO BOX 2170
TULSA OK, 74101

November 10, 2020
KCC Lic. 35442

RE: **TEMPORARY ABANDONMENT**
API Well No. 15-071-20804-00-00
DRAKE 3-27
27-20S-40W, NWSW
GREELEY County, Kansas

Operator:

On November 10, 2020, a file review documented a probable violation of the following regulation at the referenced well:

- K.A.R. 82-3-111. Within 90 days after operations cease on a well, the operator must return the well to service, plug the well, or obtain approval for temporary abandonment status.

**Failure to remedy this violation
by DECEMBER 08, 2020
shall be punishable by a \$100 penalty.**

You may contact me if you have any questions.

Sincerely,

MICHAEL MAIER
KCC District # 1



Susan K. Duffy, Chair
Dwight D. Keen, Commissioner
Andrew J. French, Commissioner

Corporation Commission

Laura Kelly, Governor

NOTICE OF VIOLATION

PRAIRIE GAS OPERATING, LLC
114 E. 5TH ST., SUITE 100
PO BOX 2170
TULSA OK, 74101

November 10, 2020
KCC Lic. 35442

RE: **TEMPORARY ABANDONMENT**
API Well No. 15-071-20755-00-00
KUTTLER H 1
29-19S-39W, E2NENW
GREELEY County, Kansas

Operator:

On November 10, 2020, a file review documented a probable violation of the following regulation at the referenced well:

- K.A.R. 82-3-111. Within 90 days after operations cease on a well, the operator must return the well to service, plug the well, or obtain approval for temporary abandonment status.

**Failure to remedy this violation
by DECEMBER 08, 2020
shall be punishable by a \$100 penalty.**

You may contact me if you have any questions.

Sincerely,

MICHAEL MAIER
KCC District # 1



Susan K. Duffy, Chair
Dwight D. Keen, Commissioner
Andrew J. French, Commissioner

Corporation Commission

Laura Kelly, Governor

NOTICE OF VIOLATION

PRAIRIE GAS OPERATING, LLC
114 E. 5TH ST., SUITE 100
PO BOX 2170
TULSA OK, 74101

November 10, 2020
KCC Lic. 35442

RE: **TEMPORARY ABANDONMENT**
API Well No. 15-071-20617-00-01
NICKELSON 1-4
4-20S-39W, NE
GREELEY County, Kansas

Operator:

On November 10, 2020, a file review documented a probable violation of the following regulation at the referenced well:

- K.A.R. 82-3-111. Within 90 days after operations cease on a well, the operator must return the well to service, plug the well, or obtain approval for temporary abandonment status.

**Failure to remedy this violation
by DECEMBER 08, 2020
shall be punishable by a \$100 penalty.**

You may contact me if you have any questions.

Sincerely,

MICHAEL MAIER
KCC District # 1



Susan K. Duffy, Chair
Dwight D. Keen, Commissioner
Andrew J. French, Commissioner

Corporation Commission

Laura Kelly, Governor

NOTICE OF VIOLATION

PRAIRIE GAS OPERATING, LLC
114 E. 5TH ST., SUITE 100
PO BOX 2170
TULSA OK, 74101

November 10, 2020
KCC Lic. 35442

RE: **TEMPORARY ABANDONMENT**
API Well No. 15-071-20752-00-00
SANDIFER 2
33-19S-39W, S2SWNE
GREELEY County, Kansas

Operator:

On November 10, 2020, a file review documented a probable violation of the following regulation at the referenced well:

* K.A.R. 82-3-111, Within 90 days after operations cease on a well, the operator must return the well to service, plug the well, or obtain approval for temporary abandonment status.

**Failure to remedy this violation
by DECEMBER 08, 2020
shall be punishable by a \$100 penalty.**

You may contact me if you have any questions.

Sincerely,

MICHAEL MAIER
KCC District # 1



Susan K. Duffy, Chair
Dwight D. Keen, Commissioner
Andrew J. French, Commissioner

Corporation Commission

Laura Kelly, Governor

NOTICE OF VIOLATION

PRAIRIE GAS OPERATING, LLC
114 E. 5TH ST., SUITE 100
PO BOX 2170
TULSA OK, 74101

November 10, 2020
KCC Lic. 35442

RE: **TEMPORARY ABANDONMENT**
API Well No. 15-071-20246-00-00
SPEARS 2
5-20S-40W, SWNE
GREELEY County, Kansas

Operator:

On November 10, 2020, a file review documented a probable violation of the following regulation at the referenced well:

- K.A.R. 82-3-111. Within 90 days after operations cease on a well, the operator must return the well to service, plug the well, or obtain approval for temporary abandonment status.

**Failure to remedy this violation
by DECEMBER 08, 2020
shall be punishable by a \$100 penalty.**

You may contact me if you have any questions.

Sincerely,

MICHAEL MAIER
KCC District # 1



Susan K. Duffy, Chair
Dwight D. Keen, Commissioner
Andrew J. French, Commissioner

Corporation Commission

Laura Kelly, Secretary

NOTICE OF VIOLATION

PRAIRIE GAS OPERATING, LLC
114 E. 5TH ST., SUITE 100
PO BOX 2170
TULSA OK, 74101

November 10, 2020
KCC Lic. 35442

RE: **TEMPORARY ABANDONMENT**
API Well No. 15-071-20180-00-00
WEST 1
28-19S-40W, NW
GREELEY County, Kansas

Operator:

On November 10, 2020, a file review documented a probable violation of the following regulation at the referenced well:

- K.A.R. 82-3-111. Within 90 days after operations cease on a well, the operator must return the well to service, plug the well, or obtain approval for temporary abandonment status.

**Failure to remedy this violation
by DECEMBER 08, 2020
shall be punishable by a \$100 penalty.**

You may contact me if you have any questions.

Sincerely,

MICHAEL MAIER
KCC District # 1



Susan K. Duffy, Chair
Dwight D. Keen, Commissioner
Andrew J. French, Commissioner

Corporation Commission

Laura Kelly, Governor

NOTICE OF VIOLATION

December 11, 2020

KCC Lic.-35442

PRAIRIE GAS OPERATING, LLC
114 E. 5TH ST., SUITE 100
PO BOX 2170
TULSA OK 74101-2170

RE: **TEMPORARY ABANDONMENT**
API Well No. 15-071-20107-00-00
ADAMS 1
2-17S-40W, SW
GREELEY County, Kansas

Operator:

On December 11, 2020, a file review documented a probable violation of the following regulation at the referenced well:

- K.A.R. 82-3-111. Within 90 days after operations cease on a well, the operator must return the well to service, plug the well, or obtain approval for temporary abandonment status.

**Failure to remedy this violation
by JANUARY 08, 2021
shall be punishable by a \$100 penalty.**

You may contact me if you have any questions.

Sincerely,

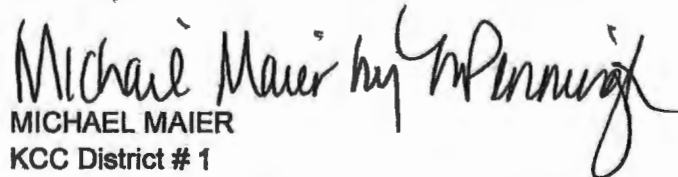
MICHAEL MAIER
KCC District # 1



Susan K. Duffy, Chair
Dwight D. Keen, Commissioner
Andrew J. French, Commissioner

Corporation Commission

Laura Kelly, Governor

NOTICE OF VIOLATION

December 11, 2020
KCC Lic.-35442

PRAIRIE GAS OPERATING, LLC
114 E. 5TH ST., SUITE 100
PO BOX 2170
TULSA OK 74101-2170

RE: TEMPORARY ABANDONMENT
API Well No. 15-071-20238-00-00
KUTTLER D 1
20-19S-39W, SW
GREELEY County, Kansas

Operator:

On December 11, 2020, a file review documented a probable violation of the following regulation at the referenced well:

• K.A.R. 82-3-111. Within 90 days after operations cease on a well, the operator must return the well to service, plug the well, or obtain approval for temporary abandonment status.

**Failure to remedy this violation
by JANUARY 08, 2021
shall be punishable by a \$100 penalty.**

You may contact me if you have any questions.

Sincerely,

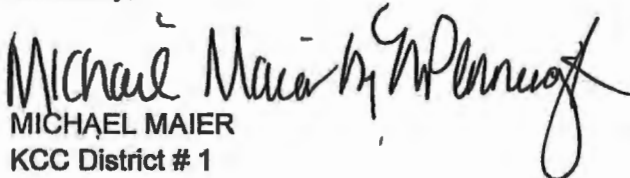
MICHAEL MAIER
KCC District # 1



Susan K. Duffy, Chair
Dwight D. Keen, Commissioner
Andrew J. French, Commissioner

Corporation Commission

Laura Kelly, Governor

NOTICE OF VIOLATION

December 11, 2020

KCC Lic.-35442

PRAIRIE GAS OPERATING, LLC
114 E. 5TH ST., SUITE 100
PO BOX 2170
TULSA OK 74101-2170

RE: **TEMPORARY ABANDONMENT**
API Well No. 15-071-20240-00-00
KUTTLER E 1
29-19S-39W, NENE
GREELEY County, Kansas

Operator:

On December 11, 2020, a file review documented a probable violation of the following regulation at the referenced well:

- K.A.R. 82-3-111. Within 90 days after operations cease on a well, the operator must return the well to service, plug the well, or obtain approval for temporary abandonment status.

**Failure to remedy this violation
by JANUARY 08, 2021
shall be punishable by a \$100 penalty.**

You may contact me if you have any questions.

Sincerely,

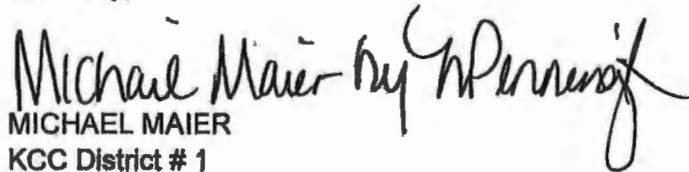
MICHAEL MAIER
KCC District # 1



Susan K. Duffy, Chair
Dwight D. Keen, Commissioner
Andrew J. French, Commissioner

Corporation Commission

Laura Kelly, Governor

NOTICE OF VIOLATION

December 11, 2020

KCC Lic.-35442

PRAIRIE GAS OPERATING, LLC
114 E. 5TH ST., SUITE 100
PO BOX 2170
TULSA OK 74101-2170

RE: **TEMPORARY ABANDONMENT**
API Well No. 15-071-20753-00-00
KUTTLER G 1
29-19S-39W, SWNWESW
GREELEY County, Kansas

Operator:

On December 11, 2020, a file review documented a probable violation of the following regulation at the referenced well:

- K.A.R. 82-3-111. Within 90 days after operations cease on a well, the operator must return the well to service, plug the well, or obtain approval for temporary abandonment status.

**Failure to remedy this violation
by JANUARY 08, 2021
shall be punishable by a \$100 penalty.**

You may contact me if you have any questions.

Sincerely,

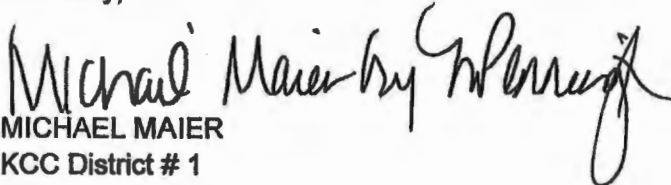
MICHAEL MAIER
KCC District # 1



Susan K. Diffy, Chair
Dwight D. Keen, Commissioner
Andrew J. French, Commissioner

Corporation Commission

Laura Kelly, Governor

NOTICE OF VIOLATION

December 11, 2020

KCC Lic.-35442

PRAIRIE GAS OPERATING, LLC
114 E. 5TH ST., SUITE 100
PO BOX 2170
TULSA OK 74101-2170

RE: **TEMPORARY ABANDONMENT**
API Well No. 15-075-20793-00-00
SUGAR 1
24-23S-40W, NENW
HAMILTON County, Kansas

Operator:

On December 11, 2020, a file review documented a probable violation of the following regulation at the referenced well:

- K.A.R. 82-3-111. Within 90 days after operations cease on a well, the operator must return the well to service, plug the well, or obtain approval for temporary abandonment status.

**Failure to remedy this violation
by JANUARY 08, 2021
shall be punishable by a \$100 penalty.**

You may contact me if you have any questions.

Sincerely,

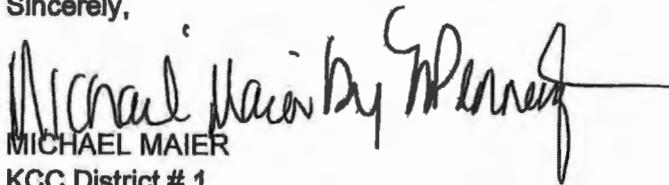
MICHAEL MAIER
KCC District # 1

Conservation Division
District Office No. 1
210 E. Frontview, Suite A
Dodge City, KS 67801



Phone: 620-682-7933
<http://kcc.ks.gov/>

Susan K. Duffy, Chair
Dwight D. Keen, Commissioner
Andrew J. French, Commissioner

Laura Kelly, Governor

January 05, 2021

Neal Hensley
Prairie Gas Operating, LLC
PO BOX 2170
PO BOX 2170
TULSA, OK 74101-2170

Re: Temporary Abandonment
API 15-071-20357-00-00
HOFFMAN G 32-1
SW/4 Sec.32-18S-40W
Greeley County, Kansas

Dear Neal Hensley:

Your application for Temporary Abandonment (TA) for the above-listed well is denied for the following reasons(s):

Needs a witnessed fluid level shot

Pursuant to K.A.R. 82-3-111, the well must be plugged, or returned to service, or obtain temporary abandonment status by 02/04/2021.

This deadline does NOT override any compliance deadline given to you in any Commission Order.

You may contact me if you have any questions.

Sincerely,
Michael Maier
KCC DISTRICT 1



Susan K. Duffy, Chair
Dwight D. Keen, Commissioner
Andrew J. French, Commissioner

Corporation Commission

Laura Kelly, Governor

NOTICE OF VIOLATION

January 12, 2021
KCC Lic.-35442

PRAIRIE GAS OPERATING, LLC
114 E. 5TH ST., SUITE 100
PO BOX 2170
TULSA OK 74101-2170

RE: TEMPORARY ABANDONMENT
API Well No. 15-071-20103-00-00
CLIFT 1-9
9-19S-40W, NE
GREELEY County, Kansas

Operator:

On January 12, 2021, a file review documented a probable violation of the following regulation at the referenced well:

- K.A.R. 82-3-111. Within 90 days after operations cease on a well, the operator must return the well to service, plug the well, or obtain approval for temporary abandonment status.

**Failure to remedy this violation
by FEBRUARY 09, 2021
shall be punishable by a \$100 penalty.**

You may contact me if you have any questions.

Sincerely,

MICHAEL MAIER
KCC District # 1



Susan K. Duffy, Chair
Dwight D. Keen, Commissioner
Andrew J. French, Commissioner

Corporation Commission

Laura Kelly, Governor

NOTICE OF VIOLATION

PRAIRIE GAS OPERATING, LLC
114 E. 5TH ST., SUITE 100
PO BOX 2170
TULSA OK 74101-2170

January 12, 2021
KCC Lic.-35442

RE: TEMPORARY ABANDONMENT
API Well No. 15-071-20151-00-00
GIBB 1
28-17S-40W, NWNWNW
GREELEY County, Kansas

Operator:

On January 12, 2021, a file review documented a probable violation of the following regulation at the referenced well:

- K.A.R. 82-3-111. Within 90 days after operations cease on a well, the operator must return the well to service, plug the well, or obtain approval for temporary abandonment status.

**Failure to remedy this violation
by FEBRUARY 09, 2021
shall be punishable by a \$100 penalty.**

You may contact me if you have any questions.

Sincerely,

MICHAEL MAIER
KCC District # 1



Andrew J. French, Chairman
Dwight D. Keen, Commissioner
Susan K. Duffy, Commissioner

Corporation Commission

Laura Kelly, Governor

NOTICE OF VIOLATION

January 22, 2021

KCC Lic. 35442

PRAIRIE GAS OPERATING, LLC
114 E. 5TH ST., SUITE 100
PO BOX 2170
TULSA OK 74101-2170

RE: **TEMPORARY ABANDONMENT**
API Well No. 15-071-20224-00-00
KUTTLER A 1
29-19S-39W, SE
GREELEY County, Kansas

Operator:

On January 13, 2021, a lease inspection documented a probable violation of the following regulation at the referenced well:

- K.A.R. 82-3-111. Within 90 days after operations cease on a well, the operator must return the well to service, plug the well, or obtain approval for temporary abandonment status.

**Failure to remedy this violation
by FEBRUARY 19, 2021
shall be punishable by a \$100 penalty.**

You may contact me if you have any questions.

Sincerely,

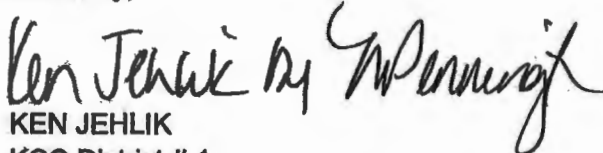
KEN JEHLIK
KCC District # 1



Andrew J. French, Chairman
Dwight D. Keen, Commissioner
Susan K. Duffy, Commissioner

Corporation Commission

Laura Kelly, Governor

NOTICE OF VIOLATION

January 22, 2021

KCC Lic.-35442

PRAIRIE GAS OPERATING, LLC
114 E. 5TH ST., SUITE 100
PO BOX 2170
TULSA OK 74101-2170

RE: TEMPORARY ABANDONMENT
API Well No. 15-071-20231-00-00
KUTTLE B 1
33-19S-39W, SW
GREELEY County, Kansas

Operator:

On January 13, 2021, a lease inspection documented a probable violation of the following regulation at the referenced well:

- K.A.R. 82-3-111. Within 90 days after operations cease on a well, the operator must return the well to service, plug the well, or obtain approval for temporary abandonment status.

**Failure to remedy this violation
by FEBRUARY 19, 2021
shall be punishable by a \$100 penalty.**

You may contact me if you have any questions.

Sincerely,

KEN JEHLIK
KCC District # 1



Andrew J. French, Chairman
Dwight D. Keen, Commissioner
Susan K. Duffy, Commissioner

Corporation Commission

Laura Kelly, Governor

NOTICE OF VIOLATION

January 22, 2021
KCC Lic.-35442

PRAIRIE GAS OPERATING, LLC
114 E. 5TH ST., SUITE 100
PO BOX 2170
TULSA OK 74101-2170

RE: **TEMPORARY ABANDONMENT**
API Well No. 15-071-20379-00-00
SANDIFER A 1
33-19S-39W, NW
GREELEY County, Kansas

Operator:

On January 13, 2021, a lease inspection documented a probable violation of the following regulation at the referenced well:

- K.A.R. 82-3-111. Within 90 days after operations cease on a well, the operator must return the well to service, plug the well, or obtain approval for temporary abandonment status.

**Failure to remedy this violation
by FEBRUARY 19, 2021
shall be punishable by a \$100 penalty.**

You may contact me if you have any questions.

Sincerely,

KEN JEHLIK
KCC District # 1



Andrew J. French, Chairman
Dwight D. Keen, Commissioner
Susan K. Duffy, Commissioner

Corporation Commission

Laura Kelly, Governor

NOTICE OF VIOLATION

PRAIRIE GAS OPERATING, LLC
114 E. 5TH ST., SUITE 100
PO BOX 2170
TULSA OK 74101-2170

January 22, 2021
KCC Lic.-35442

RE: **TEMPORARY ABANDONMENT**
API Well No. 15-071-20821-00-00
SELL A 2-3
3-19S-40W, SW
GREELEY County, Kansas

Operator:

On January 13, 2021, a lease inspection documented a probable violation of the following regulation at the referenced well:

- K.A.R. 82-3-111. Within 90 days after operations cease on a well, the operator must return the well to service, plug the well, or obtain approval for temporary abandonment status.

**Failure to remedy this violation
by FEBRUARY 19, 2021
shall be punishable by a \$100 penalty.**

You may contact me if you have any questions.

Sincerely,

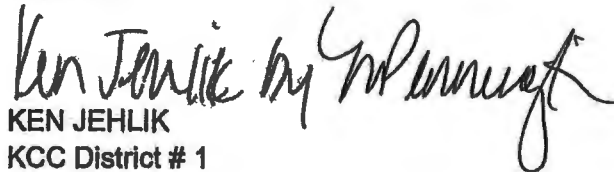
KEN JEHLIK
KCC District # 1

KCC OIL/GAS REGULATORY OFFICES

Date: 01/13/21

District: 01

Case #: _____

☒ New Situation

☐ Lease Inspection

☐ Response to Request

☐ Complaint

☐ Follow-Up

☒ Field Report

Operator License No: 35442

API Well Number: 15-071-20107-00-00

Op Name: Prairie Gas Operating, LLC

Spot: NE SW SW Sec 2 Twp 17 S Rng 40 ☐ E / ☒ W

Address 1: 114 E. 5th ST, Ste 100

1217 Feet from ☐ N / ☒ S Line of Section

Address 2: P.O. Box 2170

4029 Feet from ☒ E / ☐ W Line of Section

City: Tulsa

GPS: Lat: 38.59965 Long: 101.71095 Date: 9/3/19

State: Okla Zip Code: 74101 -2170

Lease Name: Adams Well #: 1

Operator Phone #: (817) 681-7600

County: Greeley

Reason for Investigation:

Check current status

Problem:

Last KGS production 8/18. No response to NOV letter dated 12-11-20 to file a current TA application. Deadline for action was 1-08-21.
License was suspended and all wells shut in 10-21-20.

Persons Contacted:

None

Findings:

1-13-21 Pumping unit w/ elec motor. Power shut off.
210 bbl open top FG water tank 40' SW
Meter run 60' south. 0 mcf flow. EGM battery removed. Valves are closed and padlocked shut by the pipeline.

Action/Recommendations:

Follow Up Required ☐ Yes ☐ No ☒ N

Date: _____

Send to legal

Verification Sources:

Photos Taken: Yes 2

☒ RBDMS

☒ KGS

☒ TA Program

☐ T-I Database

☐ District Files

☐ Courthouse

☐ Other: _____

By: Ken Jehlik

ECRS

Retain 1 Copy District Office
Send 1 Copy to Conservation Division

Form: 02/22/2008

Prairie Gas Adams #1 SW 27-40 Greeley Co. Pumping unit

11/13/21

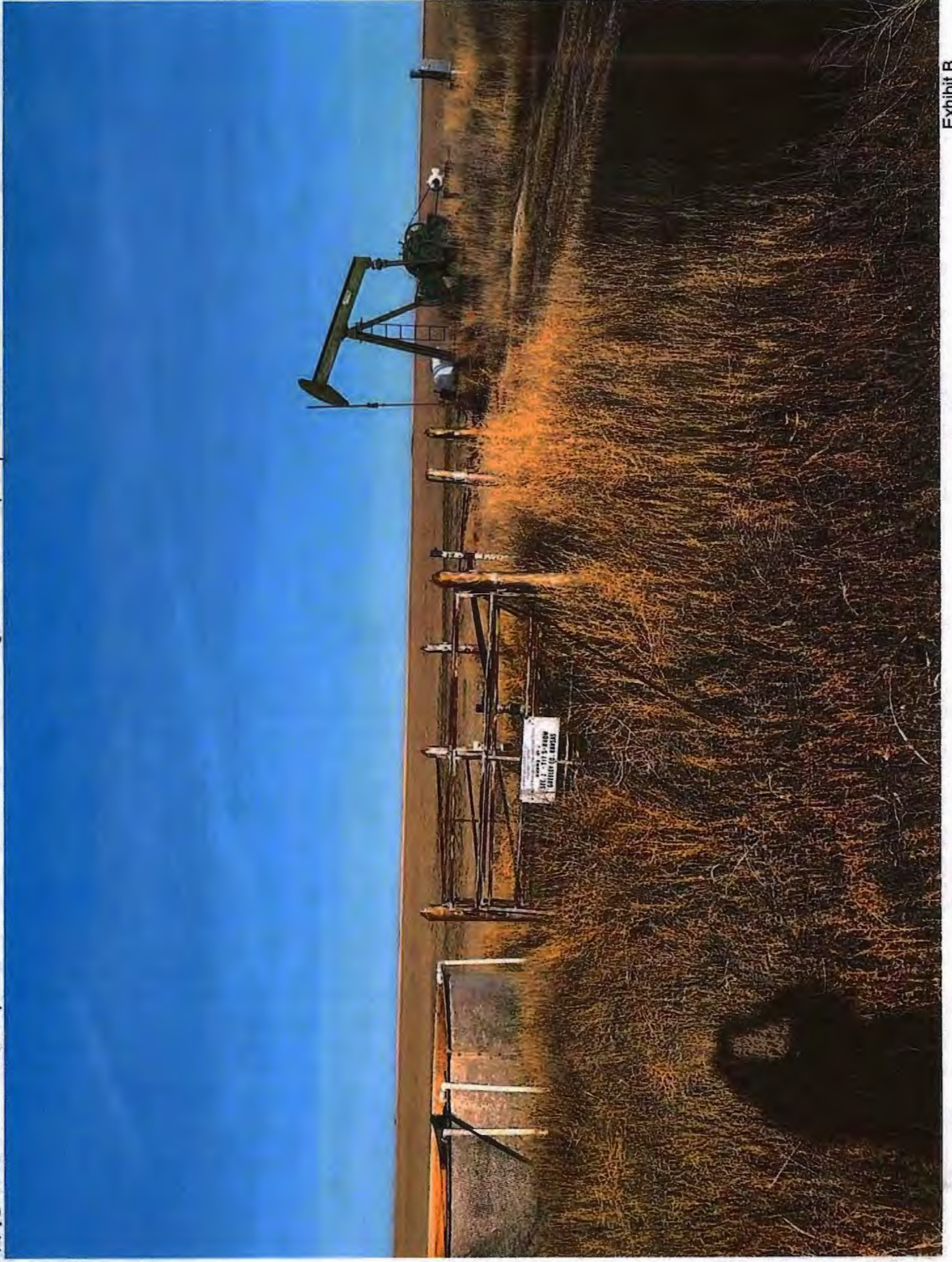

Praine Gas Adams #1 SW 27-40 Bradley Co. Closed meter run valve

1/13/21



KCC OIL/GAS REGULATORY OFFICES

Date: 12/22/20

District: 01

Case #: _____

- ☒ New Situation
☒ Response to Request
☐ Follow-Up

- ☒ Lease Inspection
☐ Complaint
☐ Field Report

Operator License No: 35442
 Op Name: Prairie Gas Operating, LLC
 Address 1: 114 E. 5th ST, Ste 100
 Address 2: P.O. Box 2170
 City: Tulsa
 State: Okla Zip Code: 74101 -2170
 Operator Phone #: (817) 681-7600

API Well Number: 15-071-20840-00-00
 Spôt: SE SW SE Sec 10 Twp 19 S Rng 40 ☐ E / ☒ W
137 Feet from ☐ N / ☒ S Line of Section
1992 Feet from ☒ E / ☐ W Line of Section
 GPS: Lat: 38.40868 Long: 101.72202 Date: 12/22/20
 Lease Name: Barker Well #: 1-10
 County: Greeley

Reason for Investigation:

Check gas well status. The legal dept has requested a current field lease inspection.

Problem:

No response to a NOV letter dated 11-10-20 to file a CP-111
 Operator license was suspended 10-9-20 and all wells that were producing were shut in 10-21-20.

Persons Contacted:

Findings:

Pumping unit with electric motor. Power shut off. All wellhead valves closed.
 Dont see the meter run.
 No water tank. Water goes direct to a disposal.

Last KGS gas production was 4/16
 Last fluid level shot was 10-1-19 (1550'). Shot again on 10-19-20. FL= 1228'. Usable water~ 1350'. HIGH
 FLUID LEVEL. Witnessed by KJ. Probable Cedar Hills csg leak.
 NOV letter to file a TA dated 11-10-20 with a deadline of 12-8-20.

Action/Recommendations:

Follow Up Required ☐ Yes ☐ No ☒

Date: _____

Send to legal

Verification Sources:

Photos Taken: Yes 1

<input type="checkbox"/> RBDMS	<input type="checkbox"/> KGS	<input type="checkbox"/> TA Program
<input type="checkbox"/> T-1 Database	<input type="checkbox"/> District Files	<input type="checkbox"/> Courthouse
<input type="checkbox"/> Other: _____		

By: Ken Jehlik
ECRS

Retain 1 Copy District Office
 Send 1 Copy to Conservation Division

Form: 02/22/2008



December 22, 2020

Prairie Gas Operating, L.L.C.

Barker #1-10

SE-SW-SE 10-19S-40W, Greeley County

Pumping unit with power shut off.

KCC OIL/GAS REGULATORY OFFICES

Date: 12/22/20

District: 01

Case #: _____

☒ New Situation

☒ Lease Inspection

☒ Response to Request

☐ Complaint

☐ Follow-Up

☐ Field Report

Operator License No: 35442

API Well Number: 15-071-20659-00-00

Op Name: Prairie Gas Operating, LLC

Spot: NE SE SE Sec 2 Twp 20 S Rng 40 ☐ E / ☒ W

Address 1: 114 E. 5th ST, Ste 100

1271 Feet from ☐ N / ☒ S Line of Section

Address 2: P.O. Box 2170

327 Feet from ☒ E / ☐ W Line of Section

City: Tulsa

GPS: Lat: 38.33880 Long: 101.69760 Date: 12/22/20

State: Okla Zip Code: 74101 -2170

Lease Name: Burske Well #: 2

Operator Phone #: (817) 681-7600

County: Greeley

Reason for Investigation:

Check gas well status. The legal dept has requested a current field lease inspection.

Problem:

No response to a NOV letter dated 11-10-20 to file a CP-111
Operator license was suspended 10-9-20 and all wells that were producing were shut in 10-21-20.

Persons Contacted:

Findings:

Pumping unit with electric motor. Down. Power shut off.
200 bbl netted FG water tank 40' south
Meter run 45' south. Valves open. 0 mcf flow

Last KGS gas production was 4/19
Last fluid level shot was 10-1-19 (2480')
NOV letter to file a TA dated 11-10-20 with a deadline of 12-8-20.

Action/Recommendations:

Follow Up Required ☐ Yes ☐ No ☒

Date: _____

Send to legal

Verification Sources:

Photos Taken: Yes 2

<input type="checkbox"/> RBDMS	<input type="checkbox"/> KGS	<input type="checkbox"/> TA Program
<input type="checkbox"/> T-I Database	<input type="checkbox"/> District Files	<input type="checkbox"/> Courthouse
<input type="checkbox"/> Other: _____		

By: Ken Jehlik

ECRS

Retain 1 Copy District Office
Send 1 Copy to Conservation Division

Form: 02/22/2008



December 22, 2020

Prairie Gas Operating, L.L.C.

Burske #2

NE-SE-SE 2-20S-40W, Greeley County

Pumping unit with power shut off.

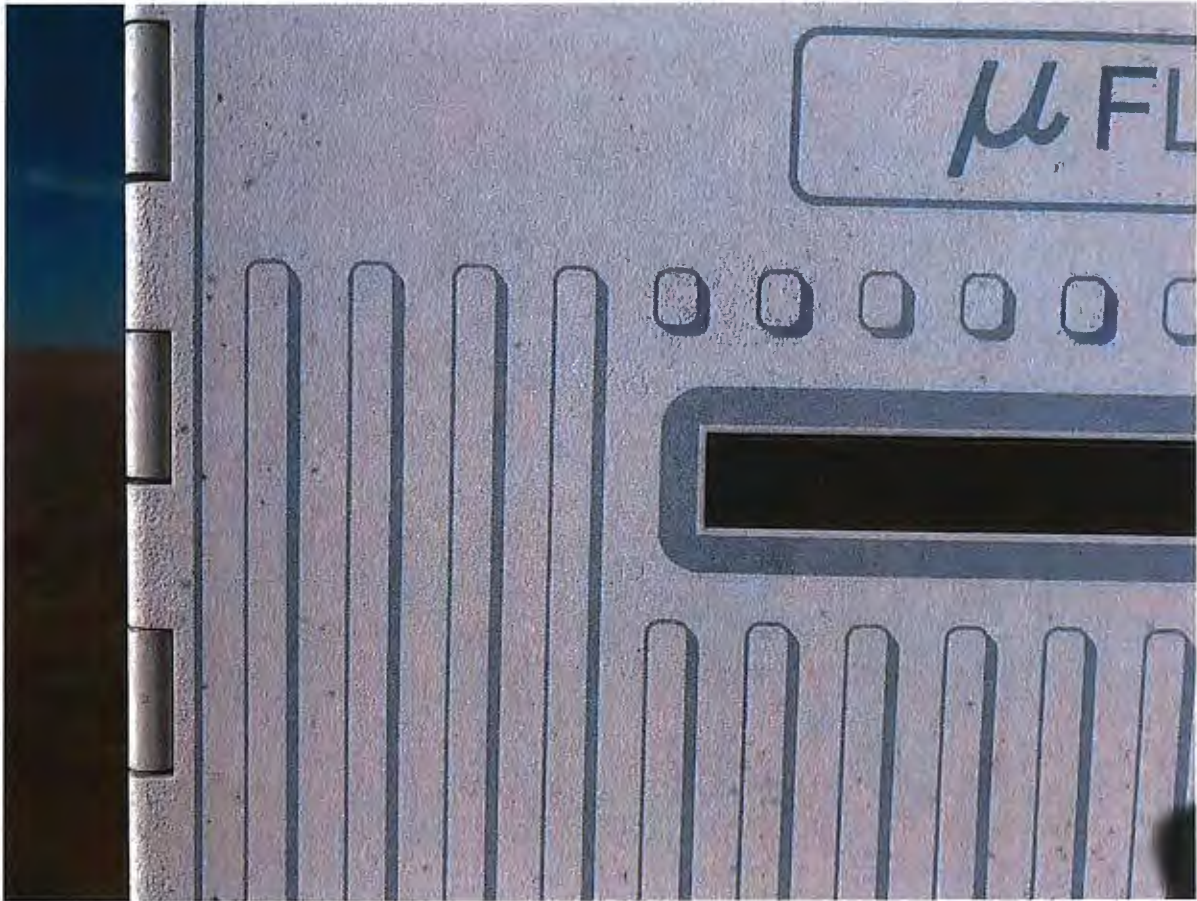

December 22, 2020

Prairie Gas Operating, L.L.C.

Burske #2

NE-SE-SE 2-20S-40W, Greeley County

Digital gas meter showing zero MCF gas flow.

KCC OIL/GAS REGULATORY OFFICES

Date: 09/01/20

District: 01

Case #: _____

☒ New Situation

☐ Lease Inspection

☐ Response to Request

☐ Complaint

☐ Follow-Up

☒ Field Report

Operator License No: 35442

API Well Number: 15-071-20087-00-00

Op Name: Prairie Gas Operating, LLC

Spot: SW NE SE Sec 19 Twp 17 S Rng 40 ☐ E / ☒ W

Address 1: 114 E 5th ST, Ste 100

1329 Feet from ☐ N / ☒ S Line of Section

Address 2: P.O. Box 2170

1324 Feet from ☒ E / ☐ W Line of Section

City: Tulsa

GPS: Lat: 38.55644 Long: 101.77573 Date: 9/1/20

State: Okla Zip Code: 74101 -2170

Lease Name: Chester Well #: 1

Operator Phone #: (817) 681-7600

County: Greeley

Reason for Investigation:

Check gas well status

Problem:

No response to denied TA letter dated 7-21-20 for a high fluid level of 1670'. Fluid level was shot 7-13-20. Deadline to bring well in to compliance was 8-20-20.

Persons Contacted:

None

Findings:

9-1-20 Free flowing gas well with no lift equipment.
210 bbl covered FG water tank 40' south.
Meter run 75' south. Valves closed & padlocked shut by the pipeline.
No battery in EGM recorder
Well is still inactive. No work has been done to bring well into compliance.

Action/Recommendations:

Follow Up Required ☐ Yes ☐ No ☒

Date: _____

Send to legal

Verification Sources:

Photos Taken: Yes 4

☒ RBDMS

☐ KGS

☒ TA Program

☐ T-I Database

☐ District Files

☐ Courthouse

☐ Other: _____

By: Ken Jehlik

ECRS

Retain 1 Copy District Office
Send 1 Copy to Conservation Division

Form: 02/22/2008

Exhibit B
Page 9 of 91

Proville Gas Cluster 1
Sec 19-17-40W G1L
Facing South

9-1-2015

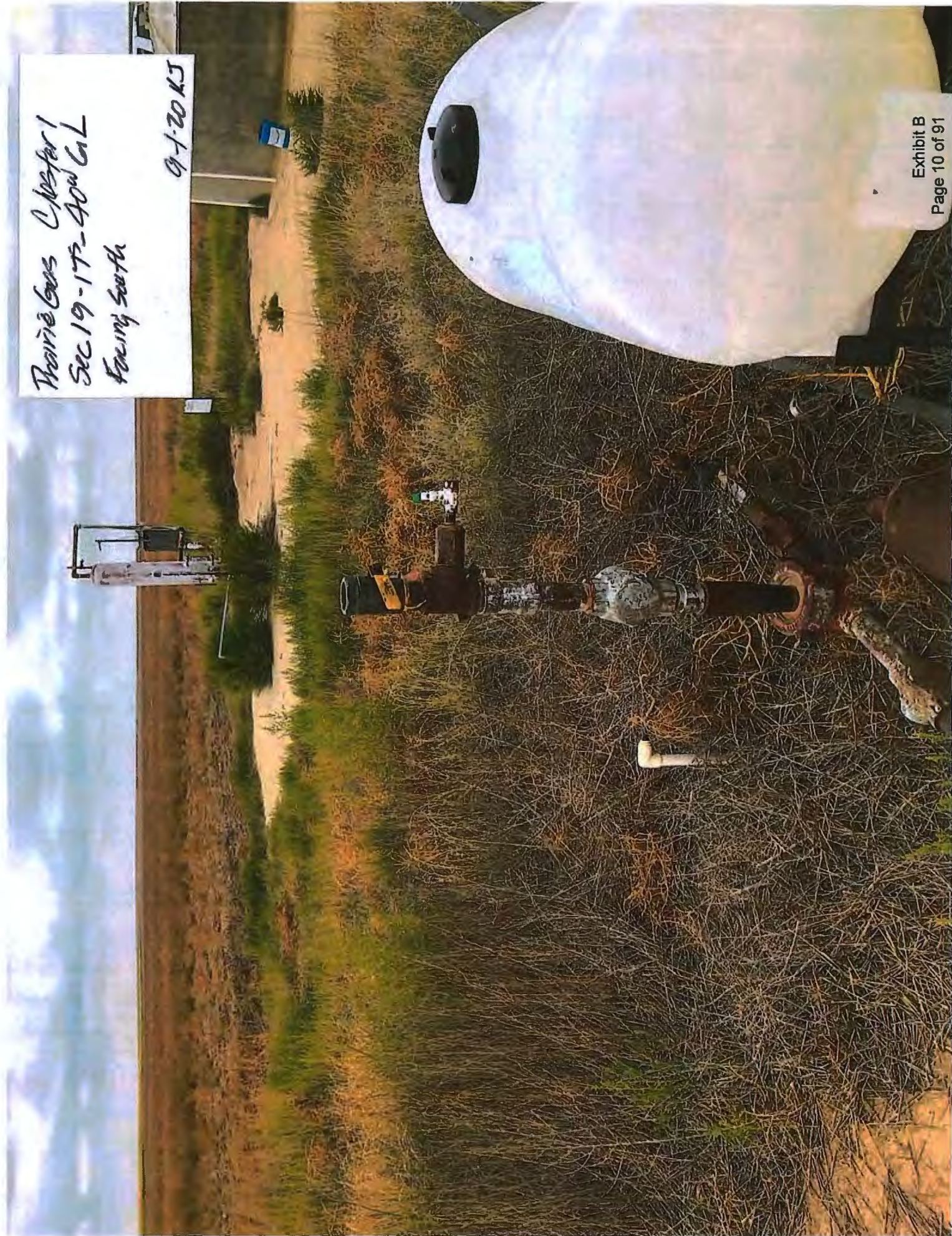

Prairie Gas Chester
Sec 19-17-40 GL
Closest valves line valve

9-1-2015



Prairie Gas Chester 1
Sec 19-17-40 G.L.
Rod locked valves / line valve
9-1-2015





μFLC

Prairie Gas Chester 1
Sec 19-17-40GL
No EGM mod out
No battery

9-1-2015

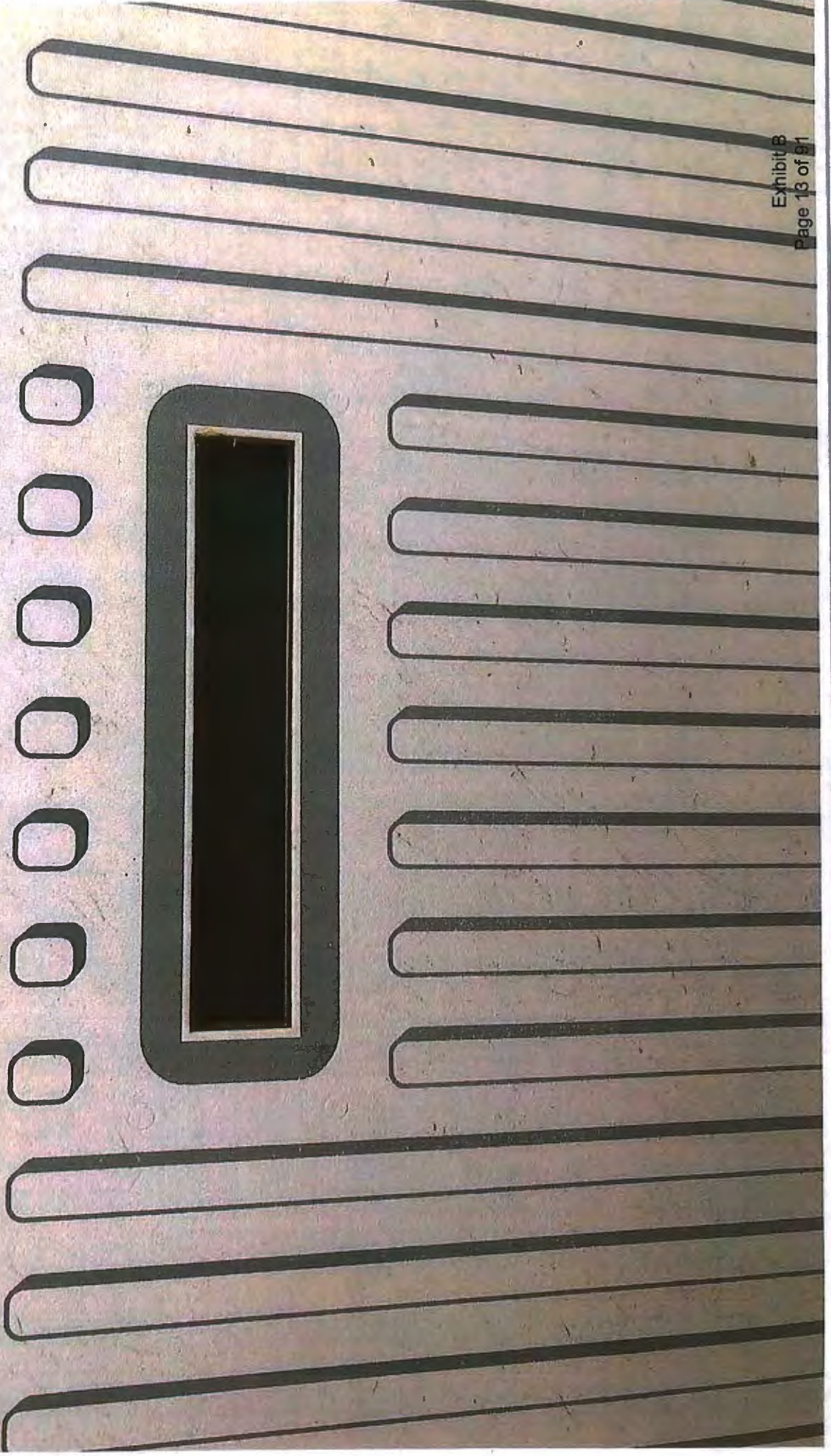

KCC OIL/GAS REGULATORY OFFICES

Date: 03/10/21

District: 01

Case #: _____

- ☒ New Situation
☐ Response to Request
☐ Follow-Up

- ☐ Lease Inspection
☐ Complaint
☒ Field Report

Operator License No: 35442
Op Name: Prairie Gas Operating, LLC
Address 1: 114 E. 5th ST, Ste 100
Address 2: P.O. Box 2170
City: Tulsa
State: Okla Zip Code: 74101 -2170
Operator Phone #: (817) 681-7600

API Well Number: 15-071-20103-00-00
Spot: SE NW NE Sec 9 Twp 19 S Rng 40 ☐ E / ☒ W
4098 Feet from ☐ N / ☒ S Line of Section
1337 Feet from ☒ E / ☐ W Line of Section
GPS: Lat: 38.41892 Long: 101.73846 Date: _____
Lease Name: Clift Well #: 1-9
County: Greeley

Reason for Investigation:

Check status

Problem:

On 1-12-21, a file review indicated a violation of KAR 82-3-111 for failure to re-TA the well.
Deadline for a response was 2-9-21.
3-10-21 No response to the NOV letter.

Persons Contacted:

None

Findings:

Pumping unit w/ electric motor. Power off. Slim hole completion.
Horizontal separator 40' east
Meter run 70' east. 0 mcf flow. Both inlet and outlet valves closed. EGM.

Action/Recommendations:

Follow Up Required ☐ Yes ☐ No ☒ ☐

Date: _____

3-10-21 Send to legal w/ pics

Verification Sources:

Photos Taken: Yes 2

<input type="checkbox"/> RBDMS	<input type="checkbox"/> KGS	<input type="checkbox"/> TA Program
<input type="checkbox"/> T-I Database	<input type="checkbox"/> District Files	<input type="checkbox"/> Courthouse
<input type="checkbox"/> Other: _____		

By: Ken Jehlik
ECRS

Retain 1 Copy District Office
Send 1 Copy to Conservation Division

Form: 02/22/2008

Prairie Gas Operating
Clift #1-9
9-19S-40W NE
Greeley County
Pumping unit
3-10-21



Prairie Gas Operating
Clift #1-9
9-19S-40W NE
Greeley County
Closed meter run valve
3-10-21



KCC OIL/GAS REGULATORY OFFICES

Date: 12/22/20

District: 01

Case #: _____

- ☒ New Situation
☐ Response to Request
☐ Follow-Up

- ☐ Lease Inspection
☐ Complaint
☒ Field Report

Operator License No: 35442
Op Name: Prairie Gas Operating, LLC
Address 1: 114 E. 5th ST, Ste 100
Address 2: P.O. Box 2170
City: Tulsa
State: Okla Zip Code: 74101 -2170
Operator Phone #: (817) 681-7600

API Well Number: 15-071-20822-00-00
Spot: NW SE SE Sec 34 Twp 18 S Rng 40 ☐ E / ☒ W
1289 Feet from ☐ N / ☒ S Line of Section
1298 Feet from ☒ E / ☐ W Line of Section
GPS: Lat: 38.44034 Long: 101.71983 Date: _____
Lease Name: Cliff B Well #: 3-34
County: Greeley

Reason for Investigation:

Check gas well status. The legal dept has requested a current field lease inspection.

Problem:

No response to a NOV letter dated 11-10-20 to file a CP-111
Operator license was suspended 10-9-20 and all wells that were producing were shut in 10-21-20.

Persons Contacted:

Findings:

Pumping unit with no motor. Sales line valve closed.
Meter run 25' west. No current chart. Inlet valve closed.
No water tank. Water goes direct to a disposal.

Last KGS gas production was 10/15
Last fluid level shot was 10-1-19 (2728')
NOV letter to file a TA dated 11-10-20 with a deadline of 12-8-20.

Action/Recommendations:

Follow Up Required ☐ Yes ☐ No ☒ ?

Date: _____

Send to legal

Verification Sources:

Photos Taken: _____

- | | | |
|---------------------------------------|---|-------------------------------------|
| <input type="checkbox"/> RBDMS | <input type="checkbox"/> KGS | <input type="checkbox"/> TA Program |
| <input type="checkbox"/> T-I Database | <input type="checkbox"/> District Files | <input type="checkbox"/> Courthouse |
| <input type="checkbox"/> Other: _____ | | |

By: Ken Jehlik
ECRS

Retain 1 Copy District Office
Send 1 Copy to Conservation Division

Form: 02/22/2008



December 22, 2020

Prairie Gas Operating, L.L.C.

Clift B #3-34

NW-SE-SE 34-18S-40W, Greeley County

Pumping unit with no motor.



December 22, 2020

Prairie Gas Operating, L.L.C.

Clift B #3-34

NW-SE-SE 34-18S-40W, Greeley County

Meter run with closed valve.

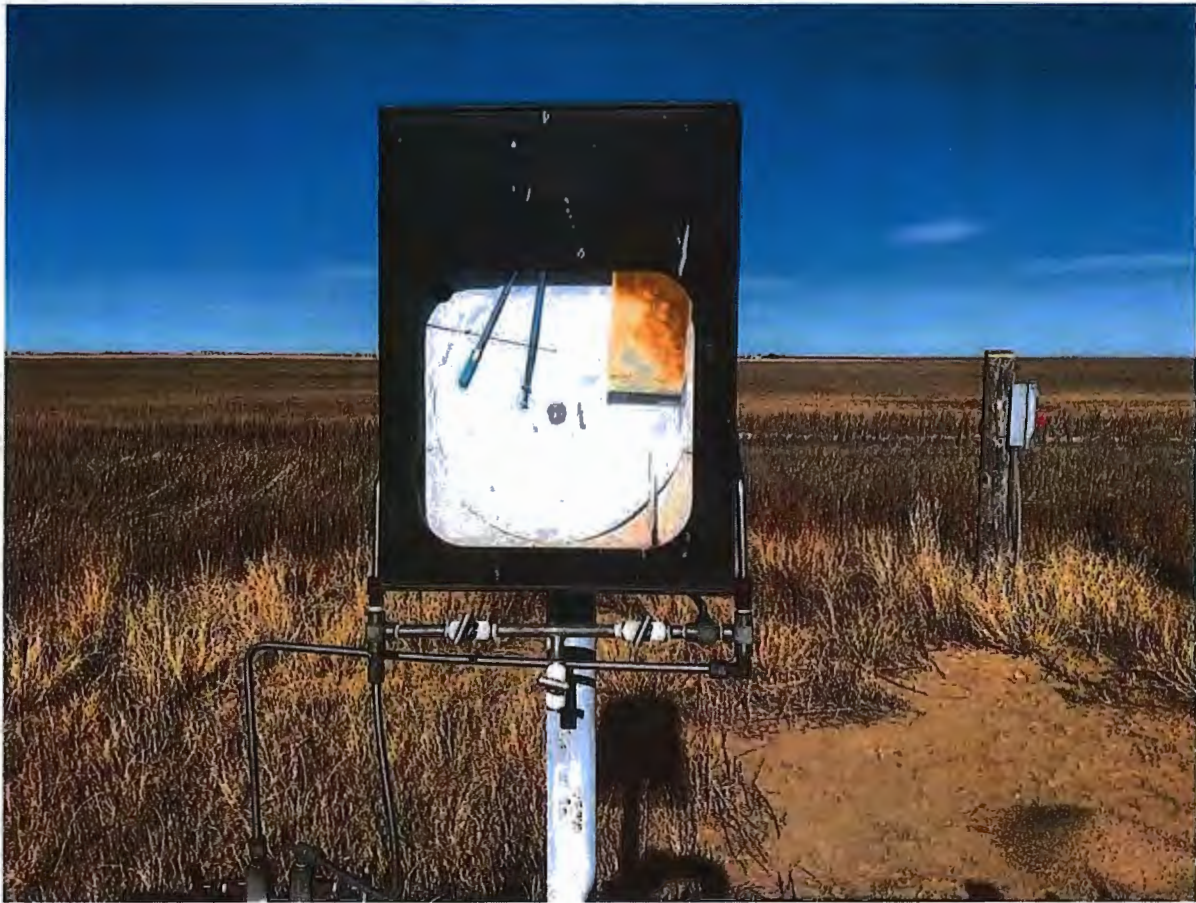

December 22, 2020

Prairie Gas Operating, L.L.C.

Clift B #3-34

NW-SE-SE 34-18S-40W, Greeley County

Gas meter with no current chart.

KCC OIL/GAS REGULATORY OFFICES

Date: 12/22/20

District: 01

Case #: _____

- ☒ New Situation
☒ Response to Request
☐ Follow-Up

- ☒ Lease Inspection
☐ Complaint
☐ Field Report

Operator License No: 35442

Op Name: Prairie Gas Operating, LLC

Address 1: 114 E. 5th ST, Ste 100

Address 2: P.O. Box 2170

City: Tulsa

State: Okla Zip Code: 74101 -2170

Operator Phone #: (817) 681-7600

API Well Number: 15-071-20804-00-00

Spot: NE NW SW Sec 27 Twp 20 S Rng 40 ☐ E / ☒ W

2010 Feet from ☐ N / ☒ S Line of Section

4618 Feet from ☒ E / ☐ W Line of Section

GPS: Lat: 38.28254 Long: 101.73088 Date: _____

Lease Name: Drake Well #: 3-27

County: Greeley

Reason for Investigation:

Check gas well status. The legal dept has requested a current field lease inspection.

Problem:

No response to a NOV letter dated 11-10-20 to file a CP-111
 Operator license was suspended 10-9-20 and all wells that were producing were shut in 10-21-20.

Persons Contacted:

Findings:

Pumping unit with electric motor. Power shut off.
 Meter run 25' NW. Valves closed. No chart on recorder.

Last KGS gas production was 7/17
 Last fluid level shot was 10-1-19 (2511')
 NOV letter to file a TA dated 11-10-20 with a deadline of 12-8-20

Action/Recommendations:

Follow Up Required ☐ Yes ☐ No ☒ ☐

Date: _____

Send to legal

Verification Sources:

Photos Taken: Yes 2

- | | | |
|---------------------------------------|---|-------------------------------------|
| <input type="checkbox"/> RBDMS | <input type="checkbox"/> KGS | <input type="checkbox"/> TA Program |
| <input type="checkbox"/> T-I Database | <input type="checkbox"/> District Files | <input type="checkbox"/> Courthouse |
| <input type="checkbox"/> Other: _____ | | |

By: Ken Jehlik

ECRS

Retain 1 Copy District Office
 Send 1 Copy to Conservation Division

Form: 02/22/2008



December 22, 2020

Prairie Gas Operating, L.L.C.

Drake #3-27

NE-NW-SW 27-20S-40W, Greeley County

Pumping unit with power shut off.



December 22, 2020

Prairie Gas Operating, L.L.C.

Drake #3-27

NE-NW-SW 27-20S-40W, Greeley County

Gas meter with no chart.

KCC OIL/GAS REGULATORY OFFICES

Date: 08/18/20

District: 01

Case #: _____

☒ New Situation
☐ Response to Request
☐ Follow-Up

☐ Lease Inspection
☐ Complaint
☒ Field Report

Operator License No: 35442

API Well Number: 15-071-20047-00-00

Op Name: Prairie Gas Operating, LLC

Spot: SE NW NW Sec 25 Twp 19 S Rng 40 ☐ E / ☒ W

Address 1: 114 E. 5th ST, Ste 100

4103 Feet from ☐ N / ☒ S Line of Section

Address 2: P.O. Box 2170

4012 Feet from ☒ E / ☐ W Line of Section

City: Tulsa

GPS: Lat: 38.37540 Long: 101.69205 Date: _____

State: Okla Zip Code: 74101 -2170

Lease Name: Floyd A Well #: 1

Operator Phone #: (817) 681-7600

County: Greeley

Reason for Investigation:

Check gas well status

Problem:

No response to NOV letter dated June 16, 2020 for denied TA due to a high fluid level. Deadline for action was 7-16-20

Persons Contacted:

None

Findings:

8-18-20 Pumping unit with elec motor. Power off. Belts off motor. All wellhead valves closed. Meter run 50' south. No battery in EGM. Both inlet & outlet valves closed by the pipeline. 0 mcf flow.
 No water tank. Water goes direct to a disposal.
 No action has been taken to bring the well into compliance.

Action/Recommendations:

Follow Up Required ☐ Yes ☐ No ☒

Date: _____

Send to legal

Verification Sources:

Photos Taken: Yes 4

☒ RBDMS ☐ KGS ☒ TA Program
☐ T-I Database ☐ District Files ☐ Courthouse
☐ Other: _____

By: Ken Jehlik
ECRS

Retain 1 Copy District Office
 Send 1 Copy to Conservation Division

JA

Form: 02/22/2008

Driveline Throttle 810206
Sec 25-19-40 GLE
No battery in ECM
No digital reading

μFLO 6213



Prairie Gas Floyd A-1
Sec 25-19-40 G.L.C.
8-18-20 KJ
Scales line valve closed on
well head

1/2" gas
line valve
closed

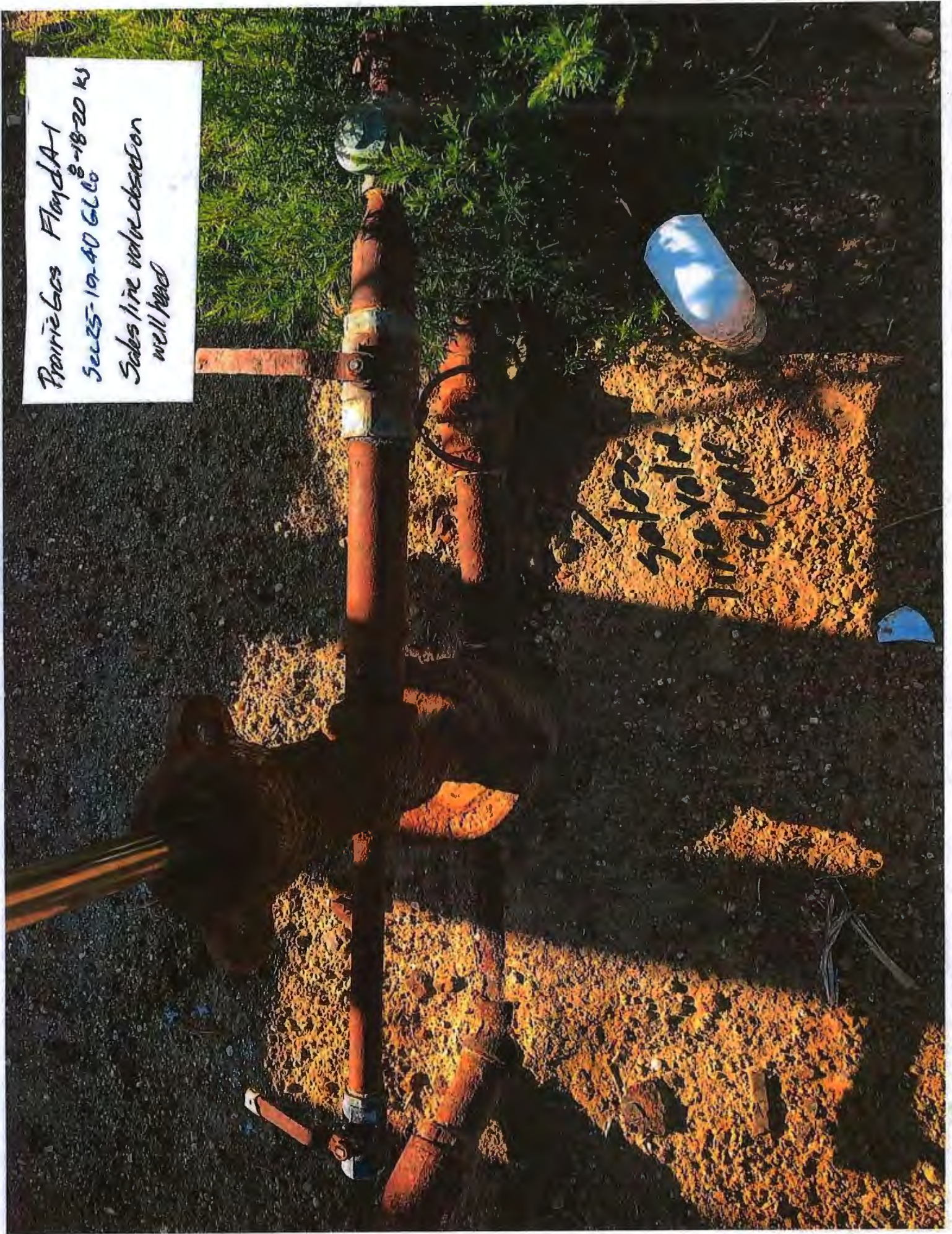

Pratt & Whitney Flyer 8-1820K
Facing North. No bells on
pumping unit
Sec 25-19-40 GL Co

No bells



Parrish Co. April 8-18-2015
5a 2519-40 6L Co

Meter run sales line valve
closed by pipeline



KCC OIL/GAS REGULATORY OFFICES

Date: 12/22/20

District: 01

Case #: _____

- ☒ New Situation
☒ Response to Request
☐ Follow-Up

- ☒ Lease Inspection
☐ Complaint
☐ Field Report

Operator License No: 35442

API Well Number: 15-071-20136-00-00

Op Name: Prairie Gas Operating, LLC

Spot: NE SW NW Sec 7 Typ 20 S Rng 39 ☐ E / ☒ W

Address 1: 114 E. 5th ST, Ste 100

3957 Feet from ☐ N / ☒ S Line of Section

Address 2: P.O. Box 2170

4055 Feet from ☒ E / ☐ W Line of Section

City: Tulsa

GPS: Lat: 38.33162 Long: 101.67344 Date: 12/22/20

State: Okl Zip Code: 74101 -2170

Lease Name: Foster Well #: 1

Operator Phone #: (817) 681-7600

County: Greeley

Reason for Investigation:

Check gas well status. The legal dept has requested a current field lease inspection.

Problem:

No response to a NOV letter dated 10-20-20 denying a TA request due to a high fluid level of 1165' shot on 10-13-20. Deadline for a response was 11-19-20. Operator license was suspended 10-9-20 and all wells that were producing were shut in 10-21-20.

Persons Contacted:

Findings:

Pumping unit with electric motor. Power shut off
 210 bbl open top FG water tank 30' west.
 Meter run 100' west. No recorder. Valves closed and padlocked shut by the pipeline.

Last KGS gas production was 7/17
 Last fluid level shot was 10-13-20 (1165' probable csg leak). Note: Usable water in the area is ~ 1375'.
 Deadline for a response to the 10-20-20 NOV letter was 11-19-20.

Action/Recommendations:

Follow Up Required ☐ Yes ☐ No ☒

Date: _____

Send to legal

Verification Sources:

Photos Taken: Yes 2

<input type="checkbox"/> RBDMS	<input type="checkbox"/> KGS	<input type="checkbox"/> TA Program
<input type="checkbox"/> T-I Database	<input type="checkbox"/> District Files	<input type="checkbox"/> Courthouse
<input type="checkbox"/> Other: _____		

By: Ken Jehlik
ECRS

Retain 1 Copy District Office
 Send 1 Copy to Conservation Division

Form: 02/22/2008



December 22, 2020

Prairie Gas Operating, L.L.C.

Foster #1

NE-SW-NW 7-20S-39W, Greeley County

Pumping unit with power shut off.



December 22, 2020

Prairie Gas Operating, L.L.C.

Foster #1

NE-SW-NW 7-20S-39W, Greeley County

Meter run valve closed and padlocked.

KCC OIL/GAS REGULATORY OFFICES

Date: 03/10/21

District: 01

Case #: _____

☒ New Situation
☐ Response to Request
☐ Follow-Up

☐ Lease Inspection
☐ Complaint
☒ Field Report

Operator License No: 35442

API Well Number: 15-071-20151-00-00

Op Name: Prairie Gas Operating, LLC

Spot: NW NW NW Sec 28 Twp 17 S Rng 40 ☐ E / ☒ W

Address 1: 114 E. 5th ST, Ste 100

4933 Feet from ☐ N / ☒ S Line of Section

Address 2: P.O. Box 2170

4939 Feet from ☒ E / ☐ W Line of Section

City: Tulsa

GPS: Lat: 38.55190 Long: 101.75134 Date: 12/18/18

State: Okla Zip Code: 74101 -2170

Lease Name: Gibb Well #: 1

Operator Phone #: (817) 681-7600

County: Greeley

Reason for Investigation:

3-10-21 Check well status.

Problem:

On 1-12-21 a file review indicated a violation of KAR 82-3-111 for failure to re-TA the well.

Deadline was 2-9-21.

3-10-21 No response to NOV.

Persons Contacted:

None

Findings:

3-10-21 Pumping unit w/ gas engine. Down. Well head valves closed.

Meter run 50' west. Valves closed. EGM battery dead.

210 bbl covered FG water tank 20' SW of well.

Well is not producing nor is well capable of immediate return to production. Well is not TA'd.

Action/Recommendations:

Follow Up Required ☐ Yes ☐ No ☒

Date: _____

3-10-21 Send to legal w/ pics.

Verification Sources:

Photos Taken: Yes 2

☐ RBDMS ☐ KGS ☐ TA Program
☐ T-I Database ☐ District Files ☐ Courthouse
☐ Other: _____

By: Kian Jehlik

ECRS

Retain 1 Copy District Office
 Send 1 Copy to Conservation Division

Form: 02/22/2008

Prairie Gas Operating
Gibb #1
28-17S-40W NWNWNW
Greeley County
Pumping unit
3-10-21



Prairie Gas Operating
Gibb #1
28-17S-40W NWNWNW
Greeley County
Closed meter run valve
3-10-21



KCC OIL/GAS REGULATORY OFFICES

Date: 11/19/20

District: 01

Case #: _____

☒ New Situation
☐ Response to Request
☐ Follow-Up

☐ Lease Inspection
☐ Complaint
☒ Field Report

Operator License No: 35442
 Op Name: Prairie Gas Operating, LLC
 Address 1: 114 E. 5th ST, Ste 100
 Address 2: P.O. Box 2170
 City: Tulsa
 State: Okla Zip Code: 74101 -2170
 Operator Phone #: (817) 681-7600

API Well Number: 15-075-20704-00-00
 Spot: NW SE SE Sec 9 Twp 23 S Rng 40 ☐ E / ☒ W
871 Feet from ☐ N / ☒ S Line of Section
1198 Feet from ☒ E / ☐ W Line of Section
 GPS: Lat: 38.16290 Long: 101.71138 Date: 9/3/20
 Lease Name: Hermann Well #: 1
 County: Hamilton

Reason for Investigation:

Inactive gas well
 11-5-20 Re check well

Problem:

Last KGS gas production 3/19
 No TA or CP-1 as of 9-3-20
 11-5-20 No response to NOV letter dated 9-8-20 to file a TA. Deadline was 10-6-20.

Persons Contacted:

11-5-20 Brett Cook--Prairie Gas

Findings:

9/10/19 Could not get to location. Road grown up in tall weeds & milo.
 11-5-19 Pumping unit w/ elec motor. Power off.
 Meter run 30' SE. 0 mcf flow. EGM
 No water tank. Water goes direct to a swd.
 9-3-20 Re check. No change from 11-15-19 inspection
 Well has been inactive for over 1 year.
 11-5-20 Re check. Well is currently shut-in due to a non-compliance shut-in order. However before their license was suspended 10-9-20 and the wells shut in on 10-21-20 and 10-22-20, the well was not producing gas and a fluid level was not shot to file a TA. Mr Cook plans to shoot a fluid level and advise his Tulsa office to file a CP-111.
 11-19-20 Re-check well to obtain pictures for legal. Well is still inactive. 4 pictures

Action/Recommendations:

Follow Up Required ☐ Yes ☐ No ☒

Date: _____

9-3-20 NOV to TA
 11-5-20 Wait until 11-15-20 to see if a CP-111 is filed
 11-19-20 Send to legal w/ pictures.

Verification Sources:

☒ RBDMS ☒ KGS ☒ TA Program
☐ T-I Database ☐ District Files ☐ Courthouse
☐ Other: _____

Photos Taken: yes 2

By: Ken Jehlik

ECRS

Retain 1 Copy District Office
 Send 1 Copy to Conservation Division

Form: 02/22/2008

Prairie Gas Operating Hermann #1 Hamilton Co. Well 92340

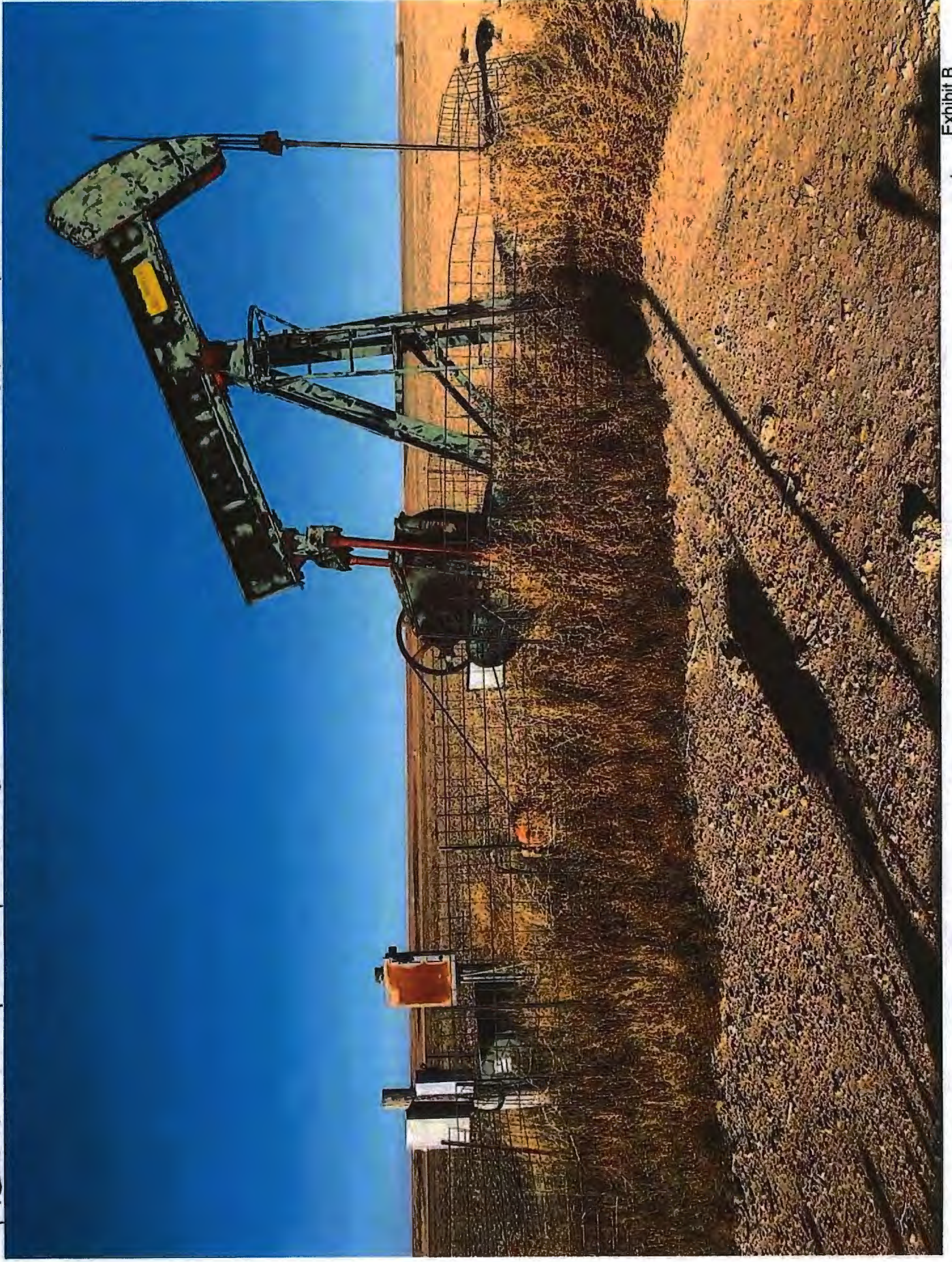

Prairie Gas operating Herman #1 Hamilton Co. 9-2340 Closed Meter & Run Valve



Prairie Gas Operating Hermann#1 9-23-40 Hamilton Co. Meter w/ 0 net flow

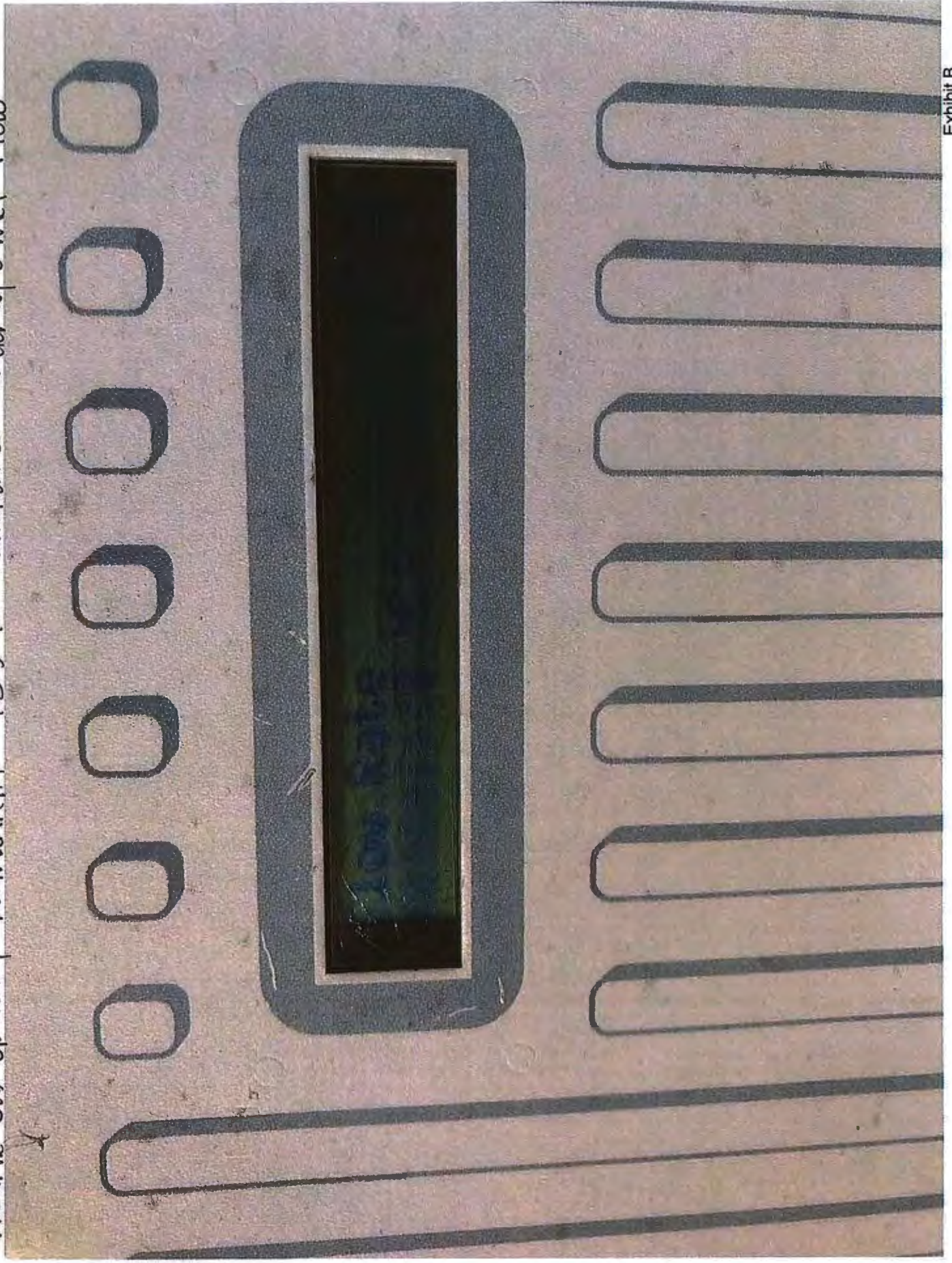

7
Prairie Gas Operating Hermann #1 Hamilton Co. 9-2340 Electric panel box



KCC OIL/GAS REGULATORY OFFICES

Date: 04/05/21

District: 01

Case #: _____

- ☒ New Situation
☒ Response to Request
☐ Follow-Up

- ☐ Lease Inspection
☐ Complaint
☒ Field Report

Operator License No: 35442

API Well Number: 15-071-20357-00-00

Op Name: Prairie Gas Operating, LLC

Spot: SE NE SW Sec 32 Twp 18 S Rng 40 ☐ E ☒ W

Address 1: 427 S. Boston St. Ste 520

1954 Feet from ☐ N ☒ S Line of Section

Address 2: _____

2979 Feet from ☒ E ☐ W Line of Section

City: Tulsa

GPS: Lat: 38.44213 Long: 101.76263 Date: 6/27/17

State: Okl Zip Code: 74103 -

Lease Name: Hoffman G Well #: 32-1

Operator Phone #: (918) 734-7727

County: Greeley

Reason for Investigation:

Check well status.

Problem:

No response to NOV letter dated 1-5-21 for failure to conduct a witnessed fluid level for a TA application.
Deadline for action was 2-4-21.

Persons Contacted:

None

Findings:

4-5-21 Pumping unit w/ elec motor. Power shut off. All well head valves closed.
Meter run 60' east. 0 mcf sales. Chart is inactive.
210 bbl open top FG water tank 30' east.
This is a "slim hole" completed well with 1 1/2" tbg inside of 2 7/8" tbg on a packer isolating a casing leak.

Action/Recommendations:

Follow Up Required ☐ Yes ☐ No ☒

Date: _____

Send to legal

Verification Sources:

Photos Taken: Yes 2

- | | | |
|---|---|--|
| <input checked="" type="checkbox"/> RBDMS | <input checked="" type="checkbox"/> KGS | <input checked="" type="checkbox"/> TA Program |
| <input type="checkbox"/> T-I Database | <input type="checkbox"/> District Files | <input type="checkbox"/> Courthouse |
| <input type="checkbox"/> Other: _____ | | |

By: Ken Jehlik

ECRS

Retain 1 Copy District Office
Send 1 Copy to Conservation Division

Form: 02/22/2008

Prairie Gas Operating
Hoffman G #32-1
SENESEW 32-18-40
Greeley County, Kansas
Well & tank
4/5/21



Prairie Gas Operating
Hoffman G #32-1
SESW 32-18-40
Greeley County, Kansas
Meter run chart out of service
4/5/21



KCC OIL/GAS REGULATORY OFFICES

Date: 09/02/20

District: 01

Case #: _____

- ☒ New Situation
☐ Response to Request
☐ Follow-Up

- ☐ Lease Inspection
☐ Complaint
☒ Field Report

Operator License No: 35442
 Op Name: Prairie Gas Operating, LLC
 Address 1: 114 E 5th ST, Ste 100
 Address 2: P.O. Box 2170
 City: Tulsa
 State: Okla Zip Code: 74101 -2170
 Operator Phone #: (817) 681-7600

API Well Number: 15-071-20299-00-00
 Spot: SE NW NW Sec 4 Twp 20 S Rng 39 ☐ E / ☒ W
3984 Feet from ☐ N / ☒ S Line of Section
4604 Feet from ☒ E / ☐ W Line of Section
 GPS: Lat: 38.34630 Long: 101.63857 Date: 9/2/20
 Lease Name: Kuttler Well #: 1
 County: Greeley

Reason for Investigation:

Check well status

Problem:

The TA application was denied on 7-21-20 due to a high fluid level of 1134'.
 Deadline to bring well into compliance was 8-20-20.

Persons Contacted:

None

Findings:

9-2-20 Pumping unit w/ electric motor. Power off.
 Meter run 50' west. Valves closed & padlocked shut by the pipeline. 0 mcf flow.
 No water tank. Water went directly to a swd.
 No work has been done to the well to bring it into compliance.

Action/Recommendations:

Follow Up Required ☐ Yes ☐ No ☒ N

Date: _____

Send to legal

Verification Sources:

Photos Taken: Yes 4

<input checked="" type="checkbox"/> RBDMS	<input type="checkbox"/> KGS	<input checked="" type="checkbox"/> TA Program
<input type="checkbox"/> T-I Database	<input type="checkbox"/> District Files	<input type="checkbox"/> Courthouse
<input type="checkbox"/> Other: _____		

By: Ken Jehlik
ECRS

Retain 1 Copy District Office
 Send 1 Copy to Conservation Division

Form: 02/22/2008

Proiriz Gas Kutter #1
Red locked down stream meter
run valve
Snd-20-396L

9-2-20 KJS



Dairi2 Gas Kutter #1
Closed upstream meter run
Valve
Sec 4-20-39 GL

9-2-2015



Prarie Gas Kutter #1
Closed sales line valve
Sec A-20-39 CL

9-2-20 KJ



Prairie 603 Kuttler #1
Sec 4-20-39 GL

9-2-2012

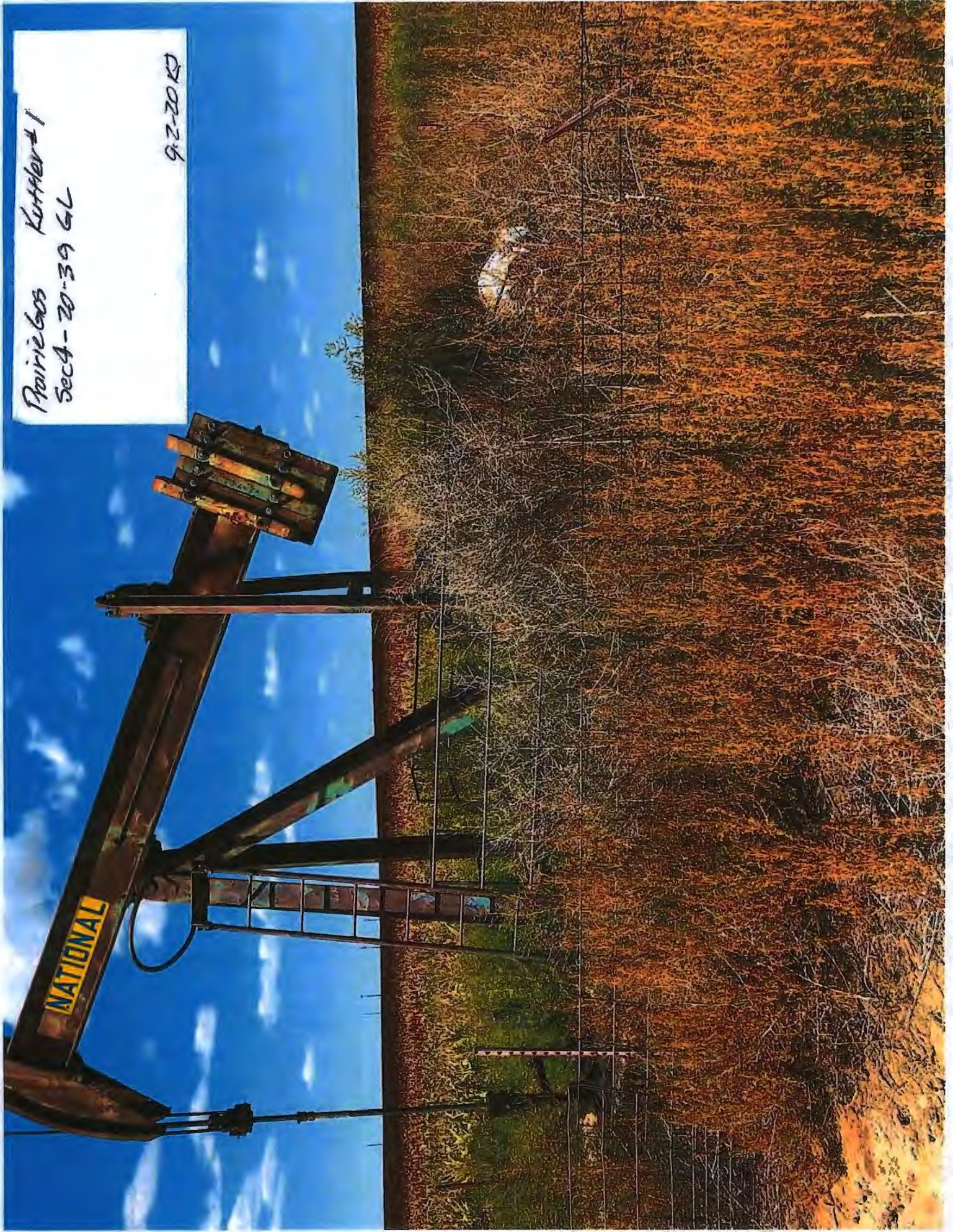

KCC OIL/GAS REGULATORY OFFICES

Date: 03/10/21

District: 01

Case #: _____

- ☒ New Situation
☐ Response to Request
☐ Follow-Up

- ☐ Lease Inspection
☐ Complaint
☒ Field Report

Operator License No: 35442

API Well Number: 15-071-20224-00-00

Op Name: Prairie Gas Operating, LLC

Spot: NW SE SE Sec 29 Twp 19 S Rng 39 ☐ E / ☒ W

Address 1: 114 E. 5th ST, Ste 100

1295 Feet from ☐ N / ☒ S Line of Section

Address 2: P.O. Box 2170

1304 Feet from ☒ E / ☐ W Line of Section

City: Tulsa

GPS: Lat: 38.36796 Long: 101.64548 Date: 4/22/20

State: Okla Zip Code: 74101 -2170

Lease Name: Kuttler A Well #: 1

Operator Phone #: (817) 681-7600

County: Greeley

Reason for Investigation:

1-13-21 Inactive gas well
3-10-21 Re check status

Problem:

1-13-21 Last KGS production 10/19. No TA or CP-1 as of 1-13-21
Operators license was suspended and all wells shut in 10-21-20.
Well had been inactive for over 1 year prior to license suspension.
3-10-21 No response to NOV letter dated 1-22-21. Deadline for a response was 2-19-21.

Persons Contacted:

None

Findings:

4-22-20 Pumping unit w/ electric motor. Power shut off.
No water tank. Water goes direct to a disposal.
Meter run 50' south. Valves open. No current chart.
1-13-21 Re check. No change from last inspection.
3-10-21 Re check. No change from 4-22-20 inspection.

Action/Recommendations:

Follow Up Required ☐ Yes ☐ No ☒

Date: _____

1-13-21 NOV to TA
3-10-21 send to legal dept w/ pics

Verification Sources:

Photos Taken: Yes 3

- | | | |
|---|---|--|
| <input checked="" type="checkbox"/> RBDMS | <input checked="" type="checkbox"/> KGS | <input checked="" type="checkbox"/> TA Program |
| <input type="checkbox"/> T-I Database | <input type="checkbox"/> District Files | <input type="checkbox"/> Courthouse |
| <input type="checkbox"/> Other: _____ | | |

By: Ken Jehlik
ECRS

Retain 1 Copy District Office
Send 1 Copy to Conservation Division

Form: 02/22/2008

Prairie Gas Operating
Kuttler A #1
29-19S-39W SE
Greeley County
Pumping unit
3-10-21



Prairie Gas Operating
Kuttler A #1
29-19S-39W SW
Greeley County
Meter run chart out of service
3-10-21



Prairie Gas Operating
Kuttler A #1
29-19S-39W SE
Greeley County
Closed wellhead valves
3-10-21



KCC OIL/GAS REGULATORY OFFICES

Date: 03/10/21

District: 01

Case #: _____

☒ New Situation

☐ Lease Inspection

☐ Response to Request

☐ Complaint

☐ Follow-Up

☒ Field Report

Operator License No: 35442

API Well Number: 15-071-20231-00-00

Op Name: Prairie Gas Operating, LLC

Spot: NW SE SW Sec 33 Twp 19 S Rng 39 ☐ E / ☒ W

Address 1: 144 E. 5th ST, Ste 100

1288 Feet from ☐ N / ☒ S Line of Section

Address 2: P.O. Box 2170

3950 Feet from ☒ E / ☐ W Line of Section

City: Tulsa

GPS: Lat: 38.35348 Long: 101.63628 Date: 4/22/20

State: Okl Zip Code: 74101 -2170

Lease Name: Kuttler B Well #: 1

Operator Phone #: (817) 681-7600

County: Greeley

Reason for Investigation:

1-13-21 Inactive gas well
3-10-21 Recheck status

Problem:

1-13-21 Last KGS production 10/19. No TA or CP-1 as of 1-13-21.
Operator license was suspended and all wells shut in 10-21-20.
Well had been inactive for over 1 year prior to license suspension.
3-10-21 No response to NOV letter dated 1-22-21. Deadline for a response was 2-19-21.

Persons Contacted:

None

Findings:

4-22-20 Pumping unit with electric motor. Power shut off.
No water tank. Water goes direct to a disposal.
Meter run 90' west. No current chart.
1-13-21 Re check. No change from last inspection. Gas leaking out of packing on stuffing box.
Asked pumper to tighten packing.
3-10-21 No change from 4-22-20 inspection.

Action/Recommendations:

Follow Up Required ☐ Yes ☐ No ☒ 

Date: _____

1-13-21 NOV to TA
3-10-21 Send to legal dept w/ pics.

Verification Sources:

Photos Taken: Yes 2

☒ RBDMS

☒ KGS

☒ TA Program

☐ T-I Database

☐ District Files

☐ Courthouse

☐ Other: _____

By: Ken Jehlik

ECRS

Retain 1 Copy District Office
Send 1 Copy to Conservation Division

Form: 02/22/2008

Prairie Gas Operating
Kuttler B #1
33-19S-39W SW
Greeley County
Pumping unit
3-10-21



Prairie Gas Operating
Kuttler B #1
33-19S-39W SW
Greeley County
Meter run chart out of service
3-10-21



KCC OIL/GAS REGULATORY OFFICES

Date: 01/13/21

District: 01

Case #: _____

- ☒ New Situation
☒ Response to Request
☐ Follow-Up

- ☐ Lease Inspection
☐ Complaint
☒ Field Report

Operator License No: 35442
 Op Name: Prairie Gas Operating, LLC
 Address 1: 114 E. 5th ST, Ste 100
 Address 2: P.O. Box 2170
 City: Tulsa
 State: Okla Zip Code: 74101 -2170
 Operator Phone #: (817) 681-7600

API Well Number: 15-071-20238-00-00
 Spot: SE NW SW Sec 20 Twp 19 S Rng 39 ☐ E / ☒ W
1371 Feet from ☐ N / ☒ S Line of Section
4018 Feet from ☒ E / ☐ W Line of Section
 GPS: Lat: 38.38258 Long: 101.65485 Date: 4/9/19
 Lease Name: Kuttler D Well #: 1
 County: Greeley

Reason for Investigation:

Check current status

Problem:

Last KGS production 12/15. No response to NOV letter dated 12-11-20 for failure to file a current TA application.
 Deadline for action .was 1-08-21.
 All wells were shut-in 10-21-20 due to license suspension.

Persons Contacted:

None

Findings:

1-13-21 Pumping unit w/ elec motor. Power shut off. Meter run 60' east. 0 mcf sales. No current chart.

Action/Recommendations:

Follow Up Required ☐ Yes ☐ No ☒ ☐

Date: _____

Send to legal

Verification Sources:

Photos Taken: Yes 2

- ☒ RBDMS ☒ KGS ☒ TA Program
☐ T-I Database ☐ District Files ☐ Courthouse
☐ Other: _____

By: Ken Jahlk
ECRS

Retain 1 Copy District Office
 Send 1 Copy to Conservation Division

Form: 02/22/2008

Prairie Gas Butler D#1 SW 20-19-39 Gravel on Pumping unit

1/13/21

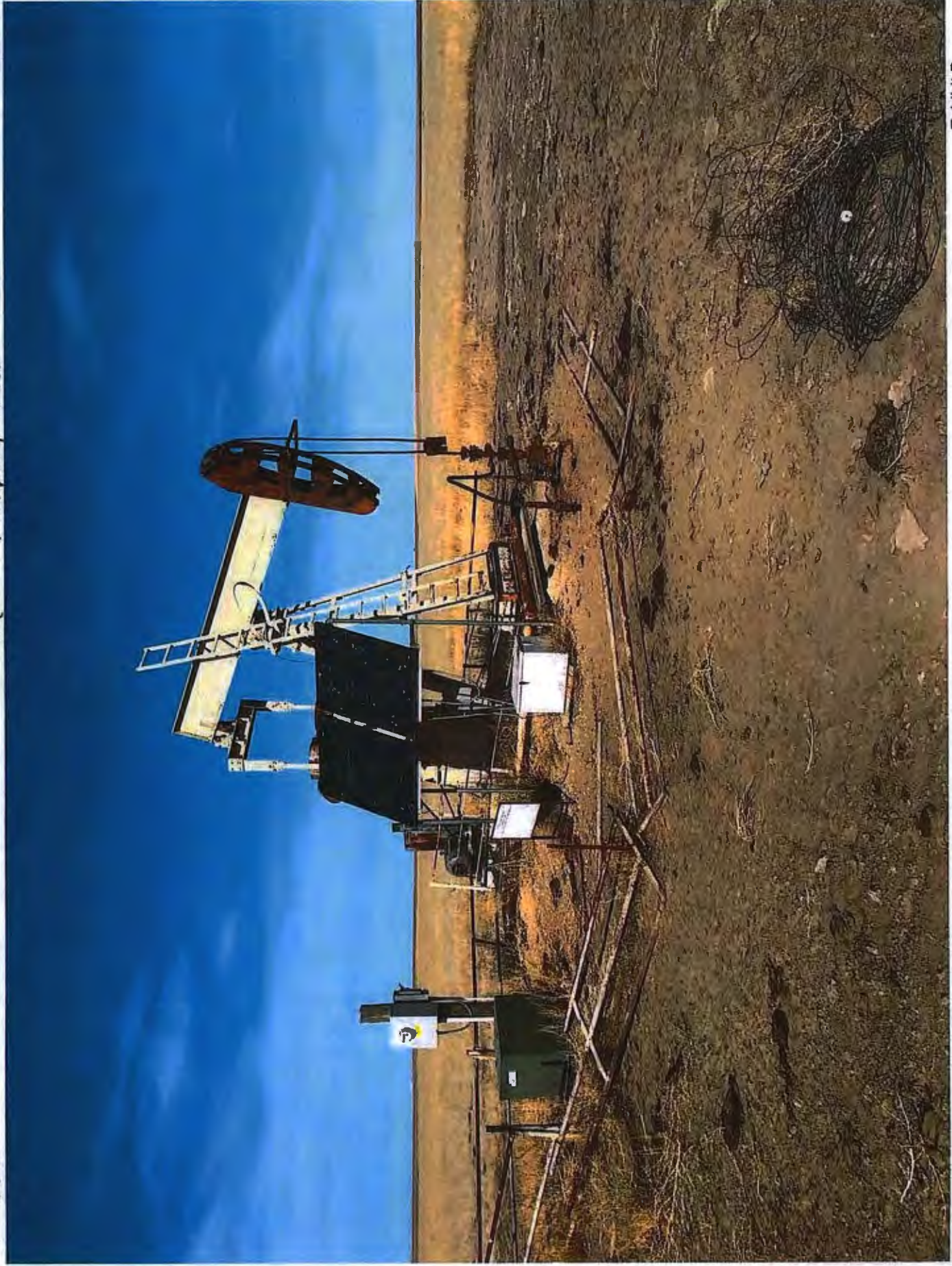

Prairie Gas Kuttler D#1 SW 20-19-79 Greeley Co. No current chart 1/13/27



KCC OIL/GAS REGULATORY OFFICES

Date: 01/13/21

District: 01

Case #: _____

- ☒ New Situation
☐ Response to Request
☐ Follow-Up

- ☐ Lease Inspection
☐ Complaint
☒ Field Report

Operator License No: 35442

API Well Number: 15-071-20240-00-00

Op Name: Prairie Gas Operating, LLC

Spot: SW NE NE Sec 29 Twp 19 S Rng 39 ☐ E / ☒ W

Address 1: 114 E 5th St, Ste 100

4548 Feet from ☐ N / ☒ S Line of Section

Address 2: PO Box 2170

689 Feet from ☒ E / ☐ W Line of Section

City: Tulsa

GPS: Lat: 38.37690 Long: 101.64325 Date: 9/5/19

State: Okla Zip Code: 74101 -2170

Lease Name: Kuttler E Well #: 1

Operator Phone #: (817) 681-7600

County: Greeley

Reason for Investigation:

Check current status.

Problem:

Last KGS production 4/16. No response to NOV letter dated 12-11-20 for failure to file a current TA application. Deadline for action was 1-08-21. All wells were shut-in 10-21-20 due to license suspension.

Persons Contacted:

None

Findings:

1-13-21 Pumping unit w/ elec motor. Power shut off. Wellhead valves closed. Meter run 60' west. No current chart on the recorder in the meter house.
No water tank. water goes direct to a disposal.

Action/Recommendations:

Follow Up Required: ☐ Yes ☐ No ☒ ?

Date: _____

Send to legal

Verification Sources:

Photos Taken: Yes 2

<input checked="" type="checkbox"/> RBDMS	<input checked="" type="checkbox"/> KGS	<input checked="" type="checkbox"/> TA Program
<input type="checkbox"/> T-I Database	<input type="checkbox"/> District Files	<input type="checkbox"/> Courthouse
<input type="checkbox"/> Other: _____		

By: Ken Jehlik

ECRS

Retain 1 Copy District Office
Send 1 Copy to Conservation Division

Form: 02/22/2008

Prairie Gas Well G-#1 NE 24-19-34 Greeley Co. Pumping Unit

1/13/21

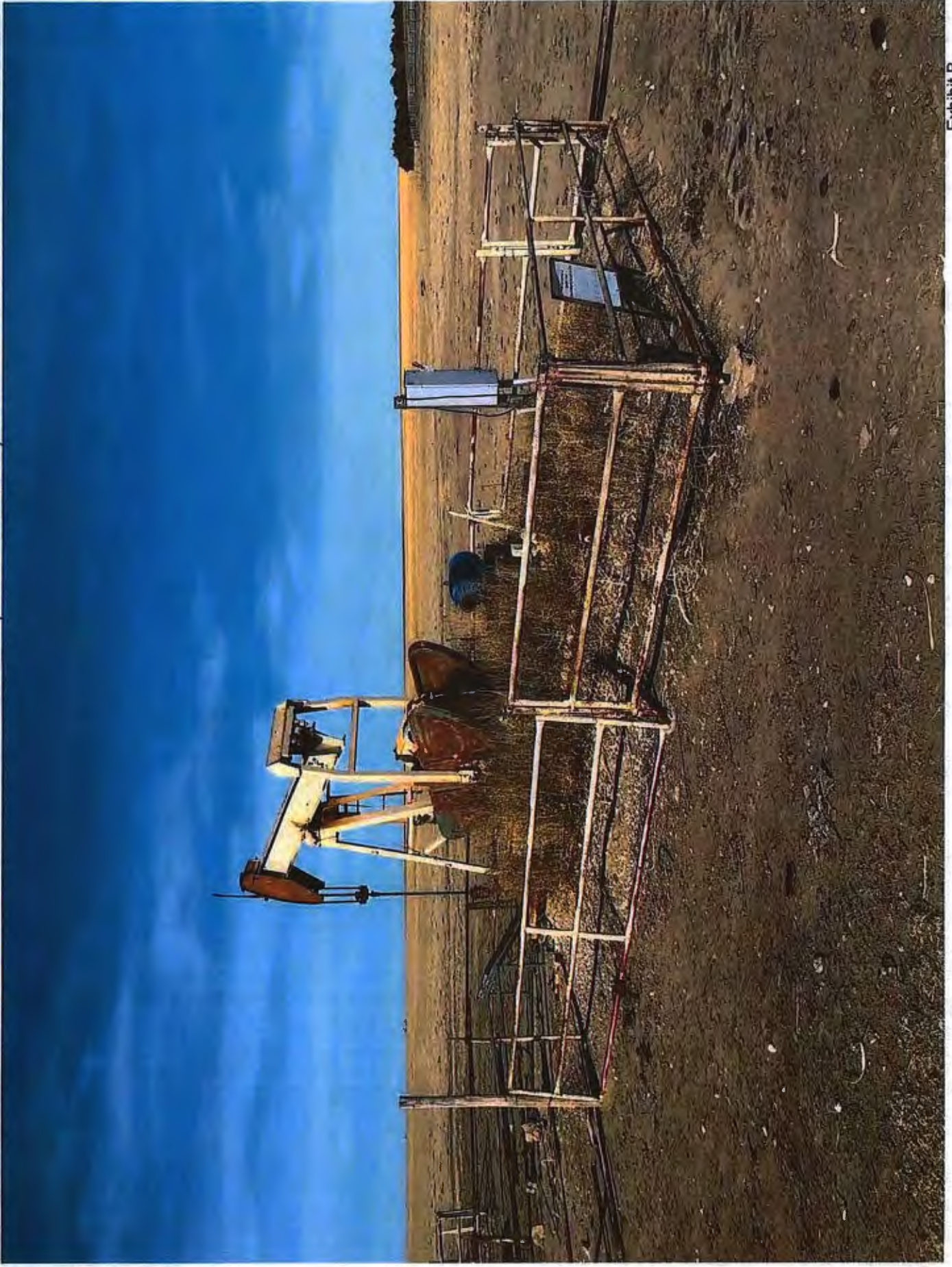

Prairie Gas Kuttler E-1 NE 26-10-39 Greeley Co. No current chart 1/13/21



KCC OIL/GAS REGULATORY OFFICES

Date: 01/13/21

District: 01

Case #: _____

☐ New Situation

☐ Lease Inspection

☒ Response to Request

☐ Complaint

☒ Follow-Up

☒ Field Report

Operator License No: 35442

API Well Number: 15-071-20753-00-00

Op Name: Prairie Gas Operating, LLC

Spot: NW NE SW Sec 29 Twp 19 S Rng 39 ☐ E / ☒ W

Address 1: 114 E 5th ST, Ste 100

2054 Feet from ☐ N / ☒ S Line of Section

Address 2: _____

3796 Feet from ☒ E / ☐ W Line of Section

City: Tulsa

GPS: Lat: 38.37000 Long: 101.65415 Date: 8/30/17

State: Okla Zip Code: 74101 -

Lease Name: Kuttler G Well #: 1

Operator Phone #: (817) 681-7600

County: Groesbeek

Reason for Investigation:

Check status

Problem:

Last KGS production 9-18. No response to NOV letter dated 12-11-20 for failure to file a current TA application. Deadline for action was 1-08-21. All wells were shut in 10-21-20 due to license suspension.

Persons Contacted:

None

Findings:

1-13-21 Pumping unit w/ elec motor. Power off. All wellhead valves closed
Meter run 30' NW. 0 mcf flow. Both downstream valves closed by the pipeline.

Action/Recommendations:

Follow Up Required ☐ Yes ☐ No ☒ ☐

Date: _____

Send to legal

Verification Sources:

Photos Taken: Yes 2

<input checked="" type="checkbox"/> RBDMS	<input checked="" type="checkbox"/> KGS	<input checked="" type="checkbox"/> TA Program
<input type="checkbox"/> T-I Database	<input type="checkbox"/> District Files	<input type="checkbox"/> Courthouse
<input type="checkbox"/> Other: _____		

By: Ken Jahlk

ECRS

Retain 1 Copy District Office
Send 1 Copy to Conservation Division

Form: 02/22/2008

Prairie Gas Well G#1 SW 24-19-39 Greeley Co. Pumping unit 11/3/21



Praine Gas Cutter G#1 SW 29-29 Greeley Co. Outlet valve on motor run closed 11/3/21



KCC OIL/GAS REGULATORY OFFICES

Date: 12/22/20

District: 01

Case #: _____

- ☒ New Situation
☒ Response to Request
☐ Follow-Up

- ☒ Lease Inspection
☐ Complaint
☐ Field Report

Operator License No: 35442
 Op Name: Prairie Gas Operating, LLC
 Address 1: 114 E. 5th ST, Ste 100
 Address 2: P.O. Box 2170
 City: Tulsa
 State: Okla Zip Code: 74101 -2170
 Operator Phone #: (817) 681-7600

API Well Number: 15-071-20755-00-00
 Spot: NE NE NW Sec 29 Twp 19 S Rng 39 ☐ E / ☒ W
4633 Feet from ☐ N / ☒ S Line of Section
3233 Feet from ☒ E / ☐ W Line of Section
 GPS: Lat: 38.37709 Long: 101.65212 Date: 12/22/20
 Lease Name: Kuttler H Well #: 1
 County: Greeley

Reason for Investigation:

Check gas well status. The legal dept has requested a current field lease inspection.

Problem:

No response to a NOV letter dated 11-10-20 to file a CP-111
 Operator license was suspended 10-9-20 and all wells that were producing were shut in 10-21-20.

Persons Contacted:

Findings:

Pumping unit with horsehead off. Swage & valve on well. Disconnected from the pipeline.
 Rods & tbg laid out
 No water tank. Water goes direct to a disposal
 Meter run recorder broke off meter tube by cattle.

Last KGS gas production was 3/17
 Last fluid level shot was 10-1-19 (1643')??. Shot again on 10-15-20 @ 819'. Probable Cedar Hills csg leak. Witnessed by KJ. Usable water @ 1400'. HIGH FLUID LEVEL due to csg leak.

NOV letter to file a TA dated 11-10-20 with a deadline of 12-8-20.

Action/Recommendations:

Follow Up Required ☐ Yes ☐ No ☒

Date: _____

Send to legal

Verification Sources:

Photos Taken: Yes 1

<input type="checkbox"/> RBDMS	<input type="checkbox"/> KGS	<input type="checkbox"/> TA Program
<input type="checkbox"/> T-I Database	<input type="checkbox"/> District Files	<input type="checkbox"/> Courthouse
<input type="checkbox"/> Other: _____		

By: Ken Jehlik
ECRS

Retain 1 Copy District Office
 Send 1 Copy to Conservation Division

Form: 02/22/2008



December 22, 2020

Prairie Gas Operating, L.L.C.

Kuttler H #1

NE-NE-NW 29-19S-39W, Greeley County

Wellhead with swage & valve.

KCC OIL/GAS REGULATORY OFFICES

Date: 12/22/20

District: 01

Case #: _____

- ☒ New Situation
☐ Response to Request
☐ Follow-Up

- ☐ Lease Inspection
☐ Complaint
☒ Field Report

Operator License No: 35442

API Well Number: 15-071-20617-00-01

Op Name: Prairie Gas Operating, LLC

Spot: NE SW NE Sec 4 Twp 20 S Rng 39 ☐ E / ☒ W

Address 1: 114 E. 5th ST, Ste 100

3937 Feet from ☐ N / ☒ S Line of Section

Address 2: P.O. Box 2170

1342 Feet from ☒ E / ☐ W Line of Section

City: Tulsa

GPS: Lat: 38.34618 Long: 101.62720 Date: _____

State: Okla Zip Code: 74101 -2170

Lease Name: Nickelson Well #: 1-4

Operator Phone #: (817) 681-7600

County: Greeley

Reason for Investigation:

Check gas well status. The legal dept has requested a current field lease inspection.

Problem:

No response to a NOV letter dated 11-10-20 to file a CP-111
 Operator license was suspended 10-9-20 and all wells that were producing were shut in 10-21-20.

Persons Contacted:

Findings:

Pumping unit with electric motor. Power shut off
 Meter run 30' NW. Both inlet and outlet valves closed. 0 mcf flow.
 No water tank. Water goes direct to a disposal.

Last KGS gas production was 10/17
 Last fluid level shot was 10-17-19 (2418)
 NOV letter to file a TA dated 11-10-20 with a deadline for response 12-8-20.

Action/Recommendations:

Follow Up Required ☐ Yes ☐ No ☒ ☐

Date: _____

Send to legal

Verification Sources:

Photos Taken: Yes 2

<input type="checkbox"/> RBDMS	<input type="checkbox"/> KGS	<input type="checkbox"/> TA Program
<input type="checkbox"/> T-J Database	<input type="checkbox"/> District Files	<input type="checkbox"/> Courthouse
<input type="checkbox"/> Other: _____		

By: Ken Jahlk
ECRS

Retain 1 Copy District Office
 Send 1 Copy to Conservation Division

Form: 0222/2008



December 22, 2020

Prairie Gas Operating, L.L.C.

Nickelson #1-4

NE-SW-NE 4-20S-39W, Greeley County

Pumping unit with power shut off.

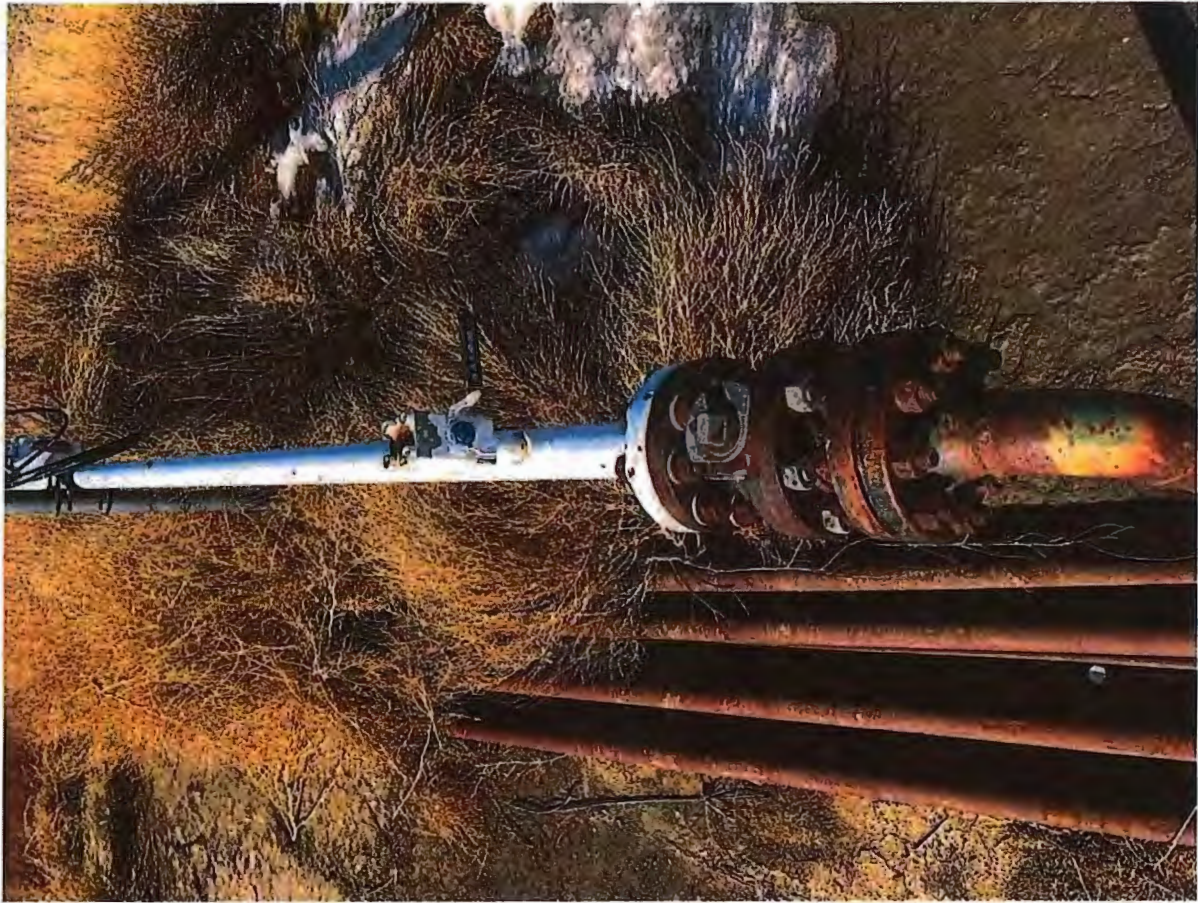

December 22, 2020

Prairie Gas Operating, L.L.C.

Nickelson #1-4

NE-SW-NE 4-20S-39W, Greeley County

Meter run with closed valves.

KCC OIL/GAS REGULATORY OFFICES

Date: 09/01/20

District: 01

Case #: _____

- ☒ New Situation
☐ Response to Request
☐ Follow-Up

- ☐ Lease Inspection
☐ Complaint
☒ Field Report

Operator License No: 35442

API Well Number: 15-071-20172-00-00

Op Name: Prairie Gas Operating, LLC

Spot: SW SW NW Sec 5 Twp 18 S Rng 39 ☐ E / ☒ W

Address 1: 114 E 5th ST, Ste 100

3320 Feet from ☐ N / ☒ S Line of Section

Address 2: P.O. Box 2170

4718 Feet from ☒ E / ☐ W Line of Section

City: Tulsa

GPS: Lat: 38.51833 Long: 101.65748 Date: 9/1/20

State: Okla Zip Code: 74101 -2170

Lease Name: Ross Well #: 2

Operator Phone #: (817) 681-7600

County: Greeley

Reason for Investigation:

Check gas well status

Problem:

No response to a denied TA letter dated 7-21-20 due to a high fluid level as 882'. Fluid level was shot on 7-13-20. Deadline to bring well into compliance was 8-20-20.

Persons Contacted:

None

Findings:

9-1-20 Pumping unit with electric motor. Power off. Wellhead valves closed.
 210 bbl covered fiberglass water tank 10' east.
 Meter run 30' west. No chart on the recorder. Inlet valve closed.
 Well is inactive. No work has been performed to bring well into compliance.

Action/Recommendations:

Follow Up Required ☐ Yes ☐ No ☒

Date: _____

Send to legal

Verification Sources:

Photos Taken: yes 4

<input checked="" type="checkbox"/> RBDMS	<input type="checkbox"/> KGS	<input checked="" type="checkbox"/> TA Program
<input type="checkbox"/> T-I Database	<input type="checkbox"/> District Files	<input type="checkbox"/> Courthouse
<input type="checkbox"/> Other: _____		

By: Ken Jehlik
ECRS

Retain 1 Copy District Office
 Send 1 Copy to Conservation Division

Form: 02/22/2008

Prairie Gas Ross 2
Sec 5-18-39 6L
Closed meter run valve

9-1-20



Prairie Gas Ross 2
See 5-18-39 GL
No chart on gas meter
reorder

9-1-2015

SN: 202E-387778

Prairie Gas Ross 2
505-18-396L

9-1-2015



Prairie Coos Ross 2
Sec 5-18-39 GL
Closed well head subs line
valve.

9-120 K5

KCC OIL/GAS REGULATORY OFFICES

Date: 12/22/20

District: 01

Case #: _____

- ☒ New Situation
☐ Response to Request
☐ Follow-Up

- ☐ Lease Inspection
☐ Complaint
☒ Field Report

Operator License No: 35442

API Well Number: 15-071-20752-00-00

Op Name: Prairie Gas Operating, LLC

Spot: SE SW NE Sec 33 Twp 19 S Rng 39 ☐ E / ☒ W

Address 1: 114 E. 5th ST, Ste 100

2955 Feet from ☐ N / ☒ S Line of Section

Address 2: P.O. Box 2170

1982 Feet from ☒ E / ☐ W Line of Section

City: Tulsa

GPS: Lat: 38.35805 Long: 101.62941 Date: 12/22/20

State: Okla Zip Code: 74101 -2170

Lease Name: Sandifer Well #: 2

Operator Phone #: (817) 681-7600

County: Greeley

Reason for Investigation:

Check gas well status. The legal dept has requested a current field lease inspection.

Problem:

No response to a NOV letter dated 11-10-20 to file a CP-111
Operator license was suspended 10-9-20 and all wells that were producing were shut in 10-21-20.

Persons Contacted:

Findings:

Pumping unit with electric motor. Power shut off. wellhead sales line valve closed.
Meter run 40' west. No current chart on the recorder.
No water tank. Water goes direct to a disposal.

Last KGS gas production was 9/15
Last fluid level shot was 10-28-20 (2520'). Witnessed by KJ
NOV letter to file a TA dated 11-10-20 with a deadline of 12-8-20.

Action/Recommendations:

Follow Up Required ☐ Yes ☐ No ☒

Date: _____

Send to legal

Verification Sources:

Photos Taken: Yes 2

<input type="checkbox"/> RBDMS	<input type="checkbox"/> KGS	<input type="checkbox"/> TA Program
<input type="checkbox"/> T-I Database	<input type="checkbox"/> District Files	<input type="checkbox"/> Courthouse
<input type="checkbox"/> Other: _____		

By: Ken Jehlik

EGRS

Retain 1 Copy District Office
Send 1 Copy to Conservation Division

Form: 02/22/2008



December 22, 2020

Prairie Gas Operating, L.L.C.

Sandifer #2

SE-SW-NE 33-19S-39W, Greeley County

Pumping unit with power shut off.



December 22, 2020

Prairie Gas Operating, L.L.C.

Sandifer #2

SE-SW-NE 33-19S-39W, Greeley County

Gas meter with no current chart.

KCC OIL/GAS REGULATORY OFFICES

Date: 03/10/21

District: 01

Case #: _____

- ☒ New Situation
☐ Response to Request
☐ Follow-Up

- ☐ Lease Inspection
☐ Complaint
☒ Field Report

Operator License No: 35442
 Op Name: Prairie Gas Operating, LLC
 Address 1: 114 E. 5th ST, Ste 100
 Address 2: P.O. Box 2170
 City: Tulsa
 State: Okla Zip Code: 74101 -2170
 Operator Phone #: (817) 681-7600

API Well Number: 15-071-20379-00-00
 Spot: SW NE NW Sec 33 Twp 19 S Rng 39 ☐ E / ☒ W
3965 Feet from ☐ N / ☒ S Line of Section
3951 Feet from ☒ E / ☐ W Line of Section
 GPS: Lat: 38.36083 Long: 101.63627 Date: 4/22/20
 Lease Name: Sandifer A Well #: 1
 County: Greeley

Reason for Investigation:

1-13-21 Inactive gas well
 3-10-21 Check status

Problem:

1-13-21 Last KGS production 10/19.
 No TA or CP-1 as of 1-13-21
 Operator license suspended 10-9-20 and all wells shut in 10-21-20.
 Well had been shut in over 1 year prior to license suspension.
 3-10-21 No response to NOV letter dated 1-22-21. Deadline for a response was 2-19-21.

Persons Contacted:

None

Findings:

4-22-20 Pumping unit w/ electric motor. Power shut off.
 No water tank. Water goes direct to a disposal.
 Meter run 15' NE. Valves open. No current chart.
 1-13-21 No change from last inspection.

Well has been inactive for over 1 year.
 3-10-21 Re check. No change from 4-22-20 inspection.

Action/Recommendations:

Follow Up Required ☐ Yes ☐ No ☒ ☐

Date: _____

1-13-20 NOV to TA
 3-10-21 Send to legal dept with pics

Verification Sources:

Photos Taken: Yes 2

☒ RBDMS ☒ KGS ☒ TA Program
☐ T-I Database ☐ District Files ☐ Courthouse
☐ Other: _____

By: Ken Jehlik
ECRS

Retain 1 Copy District Office
 Send 1 Copy to Conservation Division

Form: 02/22/2008

Prairie Gas Operating
Sandifer A #1
33-19S-39W NW
Greeley County
Pumping unit
3-10-21



Prairie Gas Operating
Sandifer A #1
33-19S-39W NW
Greeley County
Meter run chart out of service
3-10-21



KCC OIL/GAS REGULATORY OFFICES

Date: 03/10/21

District: 01

Case #: _____

- ☒ New Situation
☐ Response to Request
☐ Follow-Up

- ☐ Lease Inspection
☐ Complaint
☒ Field Report

Operator License No: 35442
Op Name: Prairie Gas Operating, LLC
Address 1: 114 E. 5th ST, Ste 100
Address 2: P.O. Box 2170
City: Tulsa
State: Okla Zip Code: 74101 -2170
Operator Phone #: (817) 681-7600

API Well Number: 15-071-20821-00-00
Spot: NE SW SW Sec 3 Twp 19 S Rng 40 ☐ E / ☒ W
1310 Feet from ☐ N / ☒ S Line of Section
4020 Feet from ☒ E / ☐ W Line of Section
GPS: Lat: 38.42590 Long: 101.72923 Date: 9/5/19
Lease Name: Sell A Well #: 2-3
County: Graeley

Reason for Investigation:

1-13-21 Inactive gas well
3-10-21 Check well status

Problem:

1-13-21 Last KGS gas sales 5/19. No TA or CP-1 as of 1-13-21.
Operators license was suspended and all wells shut in 10-21-20.
This well was inactive for over 1 year prior to shut in.
3-10-21 No response to NOV letter dated 1-11-21. Deadline for a response was 2-19-21.

Persons Contacted:

None

Findings:

9-15-19 Pumping unit w/ electric motor. Power shut off on pole. Control panel broke off on the ground.
No belts on the pumping unit.
Meter run ~1400' west. 0 mcf flow. Valves open.
1-13-21 Re check. No change from last inspection. Inlet meter run valve closed by the pipeline.
Well has been inactive for over 1 year.
3-10-21 Re check. No change from 9-15-19 inspection.

Action/Recommendations:

Follow Up Required ☐ Yes ☐ No ☒ 7

Date: _____

1-13-21 NOV to TA
3-10-21 Send to legal dept w/ pics

Verification Sources:

Photos Taken: Yes 2

- | | | |
|---|---|--|
| <input checked="" type="checkbox"/> RBDMS | <input checked="" type="checkbox"/> KGS | <input checked="" type="checkbox"/> TA Program |
| <input type="checkbox"/> T-I Database | <input type="checkbox"/> District Files | <input type="checkbox"/> Courthouse |
| <input type="checkbox"/> Other: _____ | | |

By: Ken Jehlik
ECRS

Retain 1 Copy District Office
Send 1 Copy to Conservation Division

Form: 02/22/2008

Prairie Gas Operating
Sell A #2-3
3-19-40W SW
Greeley County
Pumping unit
3-10-21



Prairie Gas Operating
Sell A 2-3
3-19S-40W SW
Greeley County
Closed meter run valve
3-10-21



KCC OIL/GAS REGULATORY OFFICES

Date: 12/22/20

District: 01

Case #: _____

- ☒ New Situation
☒ Response to Request
☐ Follow-Up

- ☒ Lease Inspection
☐ Complaint
☐ Field Report

Operator License No: 35442

API Well Number: 15-071-20246-00-00

Op Name: Prairie Gas Operating, LLC

Spot: SE SW NE Sec 5 Twp 20 S Rng 40 ☐ E / ☒ W

Address 1: 114 E. 5th ST, Ste 100

3280 Feet from ☐ N / ☒ S Line of Section

Address 2: P.O. Box 2170

1939 Feet from ☒ E / ☐ W Line of Section

City: Tulsa

GPS: Lat: 38.34414 Long: 101.75844 Date: 12/22/20

State: Okla Zip Code: 74101 -2170

Lease Name: Spears Well #: 2

Operator Phone #: (817) 681-7600

County: Greeley

Reason for Investigation:

Check gas well status. The legal dept has requested a current field lease inspection.

Problem:

No response to a NOV letter dated 11-10-20 to file a CP-111
Operator license was suspended 10-9-20 and all wells that were producing were shut in 10-21-20.

Persons Contacted:

Findings:

Pumping unit with gas engine. Down. Wellhead valves closed.
Meter run 35' SE. Valves closed and padlocked shut by the pipeline.
No water tank. Water goes direct to a disposal.

Last KGS gas production was 5/17
Last fluid level shot was 10-28-20 (1606'). Witnessed by KJ
NOV letter to file a TA dated 11-10-20 with a deadline of 12-8-20.

Action/Recommendations:

Follow Up Required ☐ Yes ☐ No ☒

Date: _____

Send to legal

Verification Sources:

Photos Taken: _____

<input type="checkbox"/> RBDMS	<input type="checkbox"/> KGS	<input type="checkbox"/> TA Program
<input type="checkbox"/> T-I Database	<input type="checkbox"/> District Files	<input type="checkbox"/> Courthouse
<input type="checkbox"/> Other: _____		

By: Ken Jehlik

ECRS

Retain 1 Copy District Office
Send 1 Copy to Conservation Division

Form: 02/22/2008



December 22, 2020

Prairie Gas Operating, L.L.C.

Spears #2

SE-SW-NE 5-20S-40W, Greeley County

Pumping unit with engine shut down.



December 22, 2020

Prairie Gas Operating, L.L.C.

Spears #2

SE-SW-NE 5-20S-40W, Greeley County

Meter run with valves closed and padlocked.

KCC OIL/GAS REGULATORY OFFICES

Date: 01/13/21

District: 01

Case #: _____

- ☒ New Situation
☐ Response to Request
☐ Follow-Up

- ☐ Lease Inspection
☐ Complaint
☒ Field Report

Operator License No: 35442
 Op Name: Prairie Gas Operating, LLC
 Address 1: 114 E. 5th ST, Ste 100
 Address 2: P.O. Box 2170
 City: Tulsa
 State: Okla Zip Code: 74101 -2170
 Operator Phone #: (817) 681-7600

API Well Number: 15-075-20793-00-00
 Spot: NE NE NW Sec 24 Twp 23 S Rng 40 ☐ E / ☒ W
4661 Feet from ☐ N / ☒ S Line of Section
3263 Feet from ☒ E / ☐ W Line of Section
 GPS: Lat: 38.04325 Long: 101.66265 Date: 9/10/19
 Lease Name: Sugar Well #: 1
 County: Hamilton

Reason for Investigation:

Check status

Problem:

Last KGS production 6/18. No response to NOV letter dated 12-11-20 for failure to file a current TA application. Deadline for action was 1-08-21. License was suspended and all wells shut in 10-21-20.

Persons Contacted:

None

Findings:

1-13-21 Pumping unit w/ elec motor. Power shut off. Wellhead valves closed.
 300 bbl open top FG water tank 20' north.
 Meter run 30' south. No chart on the recorder. Inlet valve closed.
 No lease sign at the water tank.

Action/Recommendations:

Follow Up Required ☐ Yes ☐ No ☒ ☐

Date: _____

Send to legal.

Verification Sources:

Photos Taken: Yes 2

- | | | |
|---|---|--|
| <input checked="" type="checkbox"/> RBDMS | <input checked="" type="checkbox"/> KGS | <input checked="" type="checkbox"/> TA Program |
| <input type="checkbox"/> T-I Database | <input type="checkbox"/> District Files | <input type="checkbox"/> Courthouse |
| <input type="checkbox"/> Other: _____ | | |

By: Ken Jehlik
ECRS

Retain 1 Copy District Office
 Send 1 Copy to Conservation Division

Form: 02/22/2008

Patri Gas Sugar #1 NW 24-23-40 Hamilton Co. Pumping unit 1/13/21

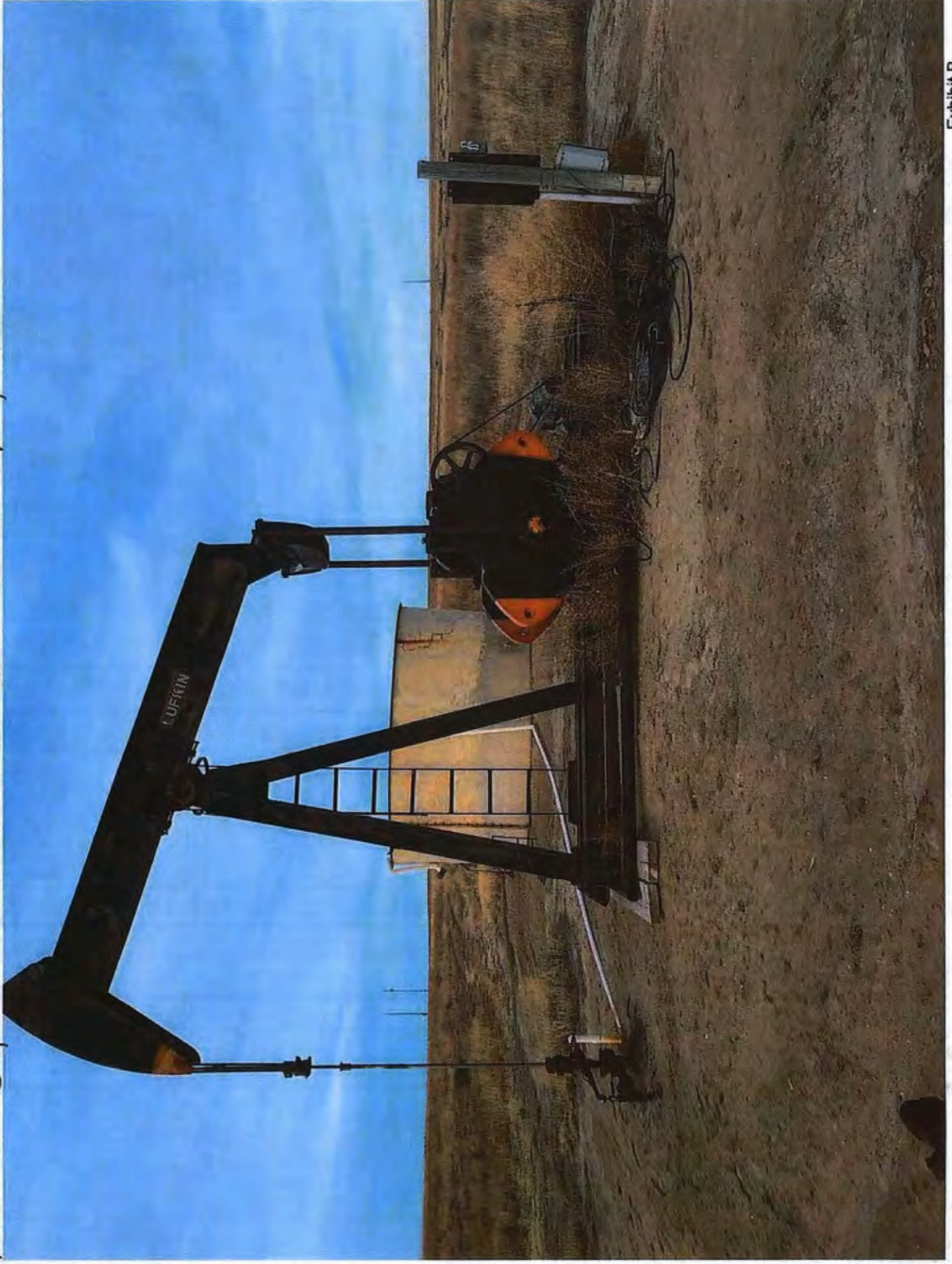

Plastic Gas Sugar #1 NW 24-23-40 Hamlet Co. No crest closed inlet valve 11/31/21



KCC OIL/GAS REGULATORY OFFICES

Date: 12/22/20

District: 01

Case #: _____

☒ New Situation
☐ Response to Request
☐ Follow-Up

☐ Lease Inspection
☐ Complaint
☒ Field Report

Operator License No: 35442

API Well Number: 15-071-20180-00-00

Op Name: Prairie Gas Operating, LLC

Spot: NW SE NW Sec 28 Twp 19 S Rng 40 ☐ E / ☒ W

Address 1: 114 E. 5th ST, Ste 100

3944 Feet from ☐ N / ☒ S Line of Section

Address 2: P.O. Box 2170

3873 Feet from ☒ E / ☐ W Line of Section

City: Tulsa

GPS: Lat: 38.37494 Long: 101.74702 Date: _____

State: Okla Zip Code: 74101 -2170

Lease Name: West Well #: 1

Operator Phone #: (817) 681-7600

County: Greeley

Reason for Investigation:

Check gas well status. The legal dept has requested a current field lease inspection.

Problem:

No response to a NOV letter dated 11-10-20 to file a CP-111
 Operator license was suspended 10-9-20 and all wells that were producing were shut in 10-21-20.

Persons Contacted:

Findings:

Pumping unit with electric motor. Power shut off.
 Meter run 70' west. Inlet valve padlocked shut by the pipeline. 0 mcf gas flow.
 No water tank. Water goes direct to a disposal.

Last KGS gas production was 3/17
 Last fluid level shot was 10-28-20 (1638'). Witnessed by KJ
 NOV letter to file a TA dated 11-10-20 with a deadline of 12-8-20.

Action/Recommendations:

Follow Up Required ☐ Yes ☐ No ☒ N/A

Date: _____

Send to legal

Verification Sources:

Photos Taken: Yes 2

☐ RBDMS ☐ KGS ☐ TA Program
☐ T-I Database ☐ District Files ☐ Courthouse
☐ Other: _____

By: Ken Jehlik
ECRS

Retain 1 Copy District Office
 Send 1 Copy to Conservation Division

Form: 02/22/2008



December 22, 2020

Prairie Gas Operating, L.L.C.

West #1

NW-SE-NW 28-19S-40W, Greeley County

Pumping unit with power shut off.



December 22, 2020

Prairie Gas Operating, L.L.C.

West #1

NW-SE-NW 28-19S-40W, Greeley County

Closed and padlocked meter run valve.

CERTIFICATE OF SERVICE

21-CONS-3199-CPEN

I, the undersigned, certify that a true copy of the attached Order has been served to the following by means of first class mail and electronic service on 04/13/2021.

FRED MACLAREN
KANSAS CORPORATION COMMISSION
DISTRICT OFFICE NO. 1
210 E. FRONTVIEW SUITE A
DODGE CITY, KS 67801
Fax: 785-271-3354
e.maclaren@kcc.ks.gov

MICHELE PENNINGTON
KANSAS CORPORATION COMMISSION
DISTRICT OFFICE NO. 1
210 E. FRONTVIEW SUITE A
DODGE CITY, KS 67801
Fax: 785-271-3354
m.pennington@kcc.ks.gov

KELCEY MARSH, LITIGATION COUNSEL
KANSAS CORPORATION COMMISSION
CENTRAL OFFICE
266 N. MAIN ST, STE 220
WICHITA, KS 67202-1513
Fax: 785-271-3354
k.marsh@kcc.ks.gov

IAN B. ACREY
Prairie Gas Operating, LLC
PO BOX 2170
TULSA, OK 74101
iacrey@pge-llc.com

/S/ DeeAnn Shupe

DeeAnn Shupe