

**THE STATE CORPORATION COMMISSION
OF THE STATE OF KANSAS**

2016.05.24 13:47:57
Kansas Corporation Commission
/S/ Amy L. Green

Before Commissioners: Shari Feist Albrecht, Chair
 Jay Scott Emler
 Pat Apple

16-CONS-4048-CEXC

In the matter of the Application of Pintail Petroleum Ltd for an exception to the 10-year time limitation of K.A.R. 82-3-111 for its Kleeman 2A well located in the C S2 SW/4 of Section 36, Township 22 South, Range 36 West, Kearny County, Kansas.)

Docket No. 15-CONS- -CEXC CONSERVATION DIVISION

License No.: 5086

KCC WICHITA
MAY 24 2016
RECEIVED

APPLICATION

COMES NOW Pintail Petroleum, Ltd ("Applicant") in support of its Application in the captioned matter and states as follows:

1. Applicant is a Pintail Petroleum, Ltd authorized to do business in the State of Kansas. Applicant's address is 225 N. Market, Ste. 300, Wichita, KS 67202.

2. Applicant has been issued by the Kansas Corporation Commission Operator's License 5086, which expires on 06/30/2016.

3. Applicant is the owner and operator of the Kleeman 2A well, API#15-093-21744 Kleeman 2A, which is located in the C S2 SW Section 36, Township 22 South, Range 36 West, Kearny County, Kansas. The subject well is located on an active oil and gas lease or unit comprising the following lands:

All of Section 36, Township 22 South, Range 36 West, Kearny County, Kansas,
containing 640 acres, more or less.

4. Pursuant to K.A.R. 82-3-111, the well was shut in, or Applicant obtained temporary abandonment status, for the subject well on March 11, 2004. The subject well has maintained such status from March 11, 2004, to the present date.

5. On or about March 1, 2016, the Kansas Corporation Commission notified Applicant temporary abandonment status for the subject well would be denied from and after May 15, 2016, because subject well had been temporarily abandoned for more than ten (10) years.

6. K.A.R. 82-3-111 imposes a 10-year limitation on the amount of time during which wells may be temporarily abandoned, but an exception to the 10-year limitation may be obtained pursuant to said regulation through an Application filed with the Commission pursuant to K.A.R. 82-3-100. Applicant seeks such an exception.

7. On January 12, 2014, the subject well passed a Commission Staff-witnessed mechanical integrity test of the casing between the surface and a point within fifty (50) feet above the uppermost perforation or open hole in the well. The Kleeman lease sold approximately 12,000 mcf for the year 2015 and continues to produce.

8. Applicant wishes to continue TA status for the subject well, because Applicant intends to use the well for the following purpose: Pintail plans to use this well as a future salt water disposal well.

9. Applicant submits the following information regarding the well in support of the Application. We reworked this well January 12, 2014 and we are planning on acidizing the disposal zone.

10. Applicant has included a plat map showing the locations of all producing, injection, temporarily abandoned, abandoned, and plugged wells located on the same leased premises as the subject well.

11. Based on the foregoing, Applicant requests the Commission grant an exception to the 10-year limitation, specifically to allow the subject well to remain eligible for temporary abandonment status for three (3) years following the expiration of the 10-year limitation.

KCC WICHITA

MAY 24 2016

RECEIVED

Applicant understands that the exception would be valid for three (3) years, but Applicant would still need to apply annually to the Conservation Division District Office for approval of an application for temporary abandonment status.

12. Listed in the attached Exhibit "A" are the names and addresses of the following:

- A. Each operator of each oil and gas lease covering lands within one-half (1/2) mile radius of the subject well; and
- B. Each person who owns any mineral interest of record in and under any lands located within one-half (1/2) mile radius of subject well (provided that such mineral interest is not covered by any oil and gas lease).

13. Notice of this Application will be published pursuant to K.A.R. 82-3-135a.

14. Notice was proper in every respect and was published at least fifteen days prior in the Wichita Eagle newspaper and the Lakin Independent newspaper. In addition, notice of the hearing to be held in this matter will be provided as prescribed by K.A.R. 82-3-135.

KCC WICHITA
MAY 24 2015
RECEIVED

WHEREFORE, Applicant prays that this matter be granted administratively without a hearing, or in the alternative be set for hearing, and upon hearing that the Commission grant Applicant's request, for an exception to the K.A.R. 82-3-111 ten (10) year limitation, to allow the subject well to remain temporarily abandoned for three (3) years, subject to annual approval by the Conservation Division District Office of an application for temporary abandonment status.

Respectfully Submitted,

Pintail Petroleum, Ltd
225 N. Market, Ste. 300
Wichita KS 67202
316-263-2243
316-263-6479

By Innes Phillips



KCC WICHITA
MAY 24 2015
RECEIVED

CERTIFICATE OF SERVICE

I hereby certify on this 28 day of April, 2016, true and correct copies of the above and foregoing Application and the Notice of Application were served by depositing copies of the same in the United States Mail, postage prepaid, and properly addressed to the landowner/s set forth in paragraph 14 of said Application and each party set forth in Exhibit "A" attached to said Application filed by Applicant, and the original was delivered to the Kansas Corporation Commission.



Karen Houseberg

KCC WICHITA
MAY 24 2016
RECEIVED

Exhibit A – Kleeman 2 A – Pintail Petroleum

Oil & Gas Operators within ½ mile of Kleeman 2A:

Section 36-T22S-R36W: All of Section 36-Leased and Operated by Applicant:
Pintail Petroleum, Ltd

Section 1-T23S-R36W: NE/4 of Section 1- Leased and Operated by:
Linn Operating Inc.
660 Travis, Ste 5100
Houston, TX 77002

Section 2-T23S-R36W: NE/4 of Section 2 – Leased and Operated by:
Linn Operating Inc.

Mineral Owners within in ½ mile of Kleeman 2A:

Section 1-T23S-R36W: NE/4 & NW/4 of Section 1-T23S-R36W:

W.T. III & Anne Rooney &
William IV & Janet Rooney
PO Box 732
Lakin KS 67860

Section 35-T22S-R36W: SE/4 of Section 35

Betty Rice
PO Box 781249
Wichita KS 67278

KCC WICHITA

MAY 24 2016

RECEIVED

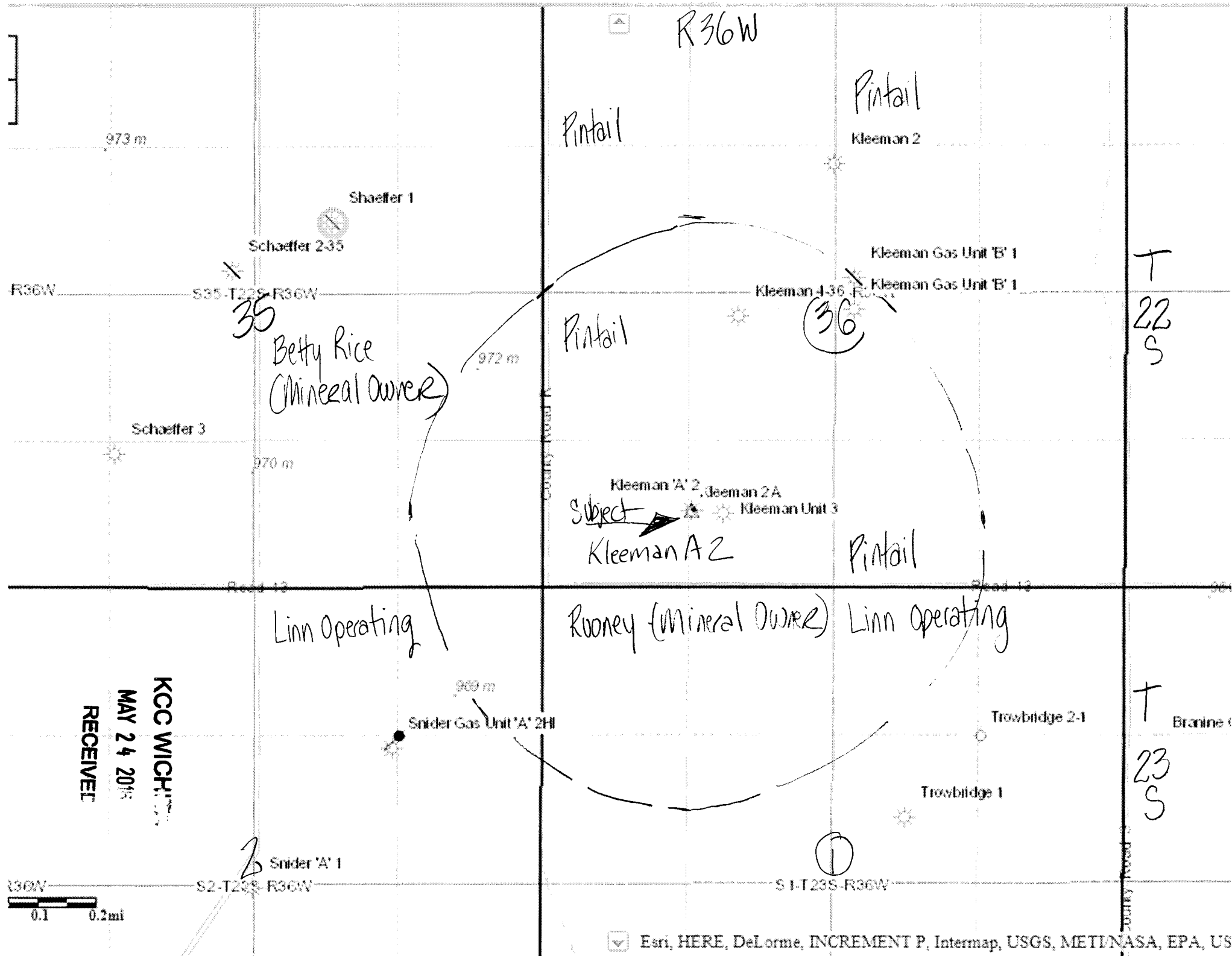

KANSAS CORPORATION COMMISSION
OIL & GAS CONSERVATION DIVISION



1294991

Form CP-111

June 2011

Form must be Typed

Form must be signed

All blanks must be complete

TEMPORARY ABANDONMENT WELL APPLICATION

OPERATOR: License# 5086
Name: Pintail Petroleum, Ltd.
Address 1: 225 N MARKET STE 300
Address 2: _____
City: WICHITA State: KS Zip: 67202 + 2024
Contact Person: WALTER INNES PHILLIPS
Phone: (316) 263-2243
Contact Person Email: _____
Field Contact Person: WAYNE COMBS
Field Contact Person Phone: (620) 271-4744

API No. 15- 15-093-21744-00-00
Spot Description: _____
_____ S2 SW Sec. 36 Twp. 22 S. R. 36 ☐ E ☒ W
660 feet from ☐ N / ☒ S Line of Section
3960 feet from ☒ E / ☐ W Line of Section
GPS Location: Lat: _____, Long: _____
(e.g. xxx.xxxxx) (e.g. -xxx.xxxxx)
Datum: ☐ NAD27 ☐ NAD83 ☐ WGS84
County: Kearny Elevation: 3182 ☒ GL ☐ KB
Lease Name: KLEEMAN Well #: 2 A
Well Type: (check one) ☐ Oil ☐ Gas ☐ OG ☐ WSW ☒ Other: HI
☐ SWD Permit #: _____ ☐ ENHR Permit #: _____
☐ Gas Storage Permit #: _____
Spud Date: 11/24/2003 Date Shut-In: 3/11/2004

	Conductor	Surface	Production	Intermediate	Liner	Tubing
Size	N/A	8.624	5.5	N/A	N/A	N/A
Setting Depth		327	2700			
Amount of Cement		150	520			
Top of Cement		0	0			
Bottom of Cement		327	2700			

Casing Fluid Level from Surface: 0 How Determined? MIT Date: 01/12/2014
Casing Squeeze(s): _____ to _____ w / _____ sacks of cement, _____ to _____ w / _____ sacks of cement. Date: _____
(top) (bottom) (top) (bottom)

Do you have a valid Oil & Gas Lease? ☒ Yes ☐ No

Depth and Type: ☐ Junk in Hole at _____ ☐ Tools in Hole at _____ Casing Leaks: ☐ Yes ☐ No Depth of casing leak(s): _____
(depth) (depth)

Type Completion: ☒ ALT. I ☐ ALT. II Depth of: ☐ DV Tool: _____ w / _____ sacks of cement ☐ Port Collar: _____ w / _____ sack of cement
(depth) (depth)

Packer Type: _____ Size: _____ Inch Set at: _____ Feet

Total Depth: 2720 Plug Back Depth: 1850 Plug Back Method: CIBP

KCC WICHITA

MAY 24 2016

RECEIVED

Geological Data:

Formation Name CEAR HILLS Formation Top _____ Formation Base _____ Completion Information
1. _____ At: _____ to _____ Feet Perforation Interval 1671 to 1760 Feet or Open Hole Interval _____ to _____ Feet
2. _____ At: _____ to _____ Feet Perforation Interval _____ to _____ Feet or Open Hole Interval _____ to _____ Feet

UNDER PENALTY OF PERJURY I HEREBY ATTEST THAT THE INFORMATION CONTAINED HEREIN IS TRUE AND CORRECT TO THE BEST OF MY KNOWLEDGE

Submitted Electronically

Do NOT Write in This Space - KCC USE ONLY	Date Tested: _____	Results: _____	Date Plugged: _____	Date Repaired: _____	Date Put Back in Service: _____
	Review Completed by: <u>Michael Maier</u> Comments: _____				
TA Approved: <input type="checkbox"/> Yes <input checked="" type="checkbox"/> Denied Date: <u>03/16/2016</u>					

Mail to the Appropriate KCC Conservation Office:

	KCC District Office #1 - 210 E. Frontview, Suite A, Dodge City, KS 67801	Phone 620.225.8888
	KCC District Office #2 / UPGS - 3450 N. Rock Road, Building 600, Suite 601, Wichita, KS 67226	Phone 316.630.4000
	KCC District Office #3 - 1500 SW Seventh Steet, Chanute, KS 66720	Phone 620.432.2300
	KCC District Office #4 - 2301 E. 13th Street, Hays, KS 67601-2651	Phone 785.625.0550

CASING MECHANICAL INTEGRITY TEST

DOCKET # D 33012Disposal ☒ Enhanced Recovery:Repressuring ☐Flood ☐Tertiary ☐

Date injection started _____

API #15 -093-21744-0000NW 1/4 SE SW 1/4, Sec 36, T 22 S, R 36 E(689) Feet from South Section Line(3970) Feet from East Section LineLease KleemonWell # 2-ACounty KearnyOperator: Pinkel Petroleum LTDOperator License # 5086

Name &

Address 275 N. Market St. Ste 300 Contact Person Walter PhillipsWichita, KS 67202Phone 316 263-2243

Max. Auth. Injection Press. _____ psi; Max. Inj. Rate _____ bbl/d;

If Dual Completion - Injection above production _____ Injection below production _____

	Conductor	Surface	Production	Liner	Size	Tubing
Size		<u>8 7/8</u>	<u>5 1/2</u>		<u>2 3/8</u>	
Set at		<u>327</u>	<u>2700</u>		<u>1621</u>	
Cement Top		<u>0</u>	<u>0</u>		<u>Bare Steel</u>	
" Bottom		<u>377</u>	<u>2700</u>			
DV/Perf.					<u>2770 (CIBP 4183)</u>	ft. depth
Packer type	<u>Howe tension</u>		Size <u>2 3/4 x 5 1/2</u>		Set at <u>1621</u>	
Zone of injection	<u>Corrietta</u>	ft. to ft. <u>1621-1760</u>			Perf. or open hole <u>perf</u>	

Type Mit: Pressure ☒ Radioactive Tracer Survey ☐ Temperature Survey ☐F Time: Start 0 Min. 15 Min. 30 Min.I Pressures: 300 300 300 Set up 1 System Pres. during test 0L 120 hrs - 300 Set up 2 Annular Pres. during test 300D Set up 3 Fluid loss during test 0 bbls.D Tested: Casing ☐ or Casing - Tubing Annulus ☒A The bottom of the tested zone is shut in with a packerTest Date 1-12-14 Using Brady Fluid Svc Company's EquipmentThe operator hereby certifies that the zone between 0 feet and 1621 feetwas the zone tested X Ken Seplik Signature Ken Seplik TitleThe results were Satisfactory ☒, Marginal ☐, Not Satisfactory ☐State Agent Ken Seplik Title PIRT II Witness: Yes ☒ No ☐REMARKS: Initial MIT. Operator plans to file an application to convert this TAIL well to a SWD☐ Origin. Conservation Div.; ☐ KDHE/T; ☐ Dist. Office;☐ Computer Update

KCC WICHITA

KCC Form U-7 6/84

MAY 24 2016

RECEIVED

NAD 83 GPS 38.09201° N
101.22598° W