

**BEFORE THE STATE CORPORATION COMMISSION
OF THE STATE OF KANSAS**

In the matter of the Application of Jones Oil,
LLC, for an exception to the Pit Closure time
Limitation of K.A.R. 82-3-602 at its Dunn #1
located in the NE/4 of Section 24, Township 23,
Range 14 West, Stafford County, Kansas

Docket No. 20-CONS-3077-CEXC

CONSERVATION DIVISION

License No. 30116

APPLICATION

COMES NOW Jones Oil, LLC (Applicant) and in support of its Application in the above captioned matter, states as follows:

1. Applicant is a Kansas Corporation doing business in the State of Kansas. Applicant's address is 112 N. Gray, St. John, Kansas 67576.
2. The Kansas Corporation Commission has issued Applicant an Operator's License Number 30116, which expires on May 30th 2020.
3. Applicant is the owner and operator of the Dunn #1 (D&A) well, API #15-185 24007-00-00 (the subject well), which is located 969 feet from the North line and 330 feet from the East line of NE/4 of Section 24, Township 23 South, Range 14 West, Stafford County Kansas. The subject pit is located 969 feet from the North line and 330 feet from the East line on an Applicant's Dunn Oil and Gas lease covering the NE/4 of Section 24, Township 23 South, Range 14 West, Stafford County, Kansas.
4. K.A.R. 82-3-100 (b) States that the Commission may grant an exception to the requirement of any of its regulations.
5. Applicant respectfully requests an exception to the deadline for closing drilling pit as provided in K.A.R. 82-3-602. Applicant has received a 6-month extension but, due to certain circumstances beyond Applicant's control, has been unable to complete closure of the drilling pit.
6. An exception and corresponding extension of time to close the pit will cause no environmental harm. The subject pit has been emptied several times and Applicant has closed up those portions of the pit deemed dry enough to close. Any fluid which may remain in the pit is fresh water.
7. The Applicant has been unable to completely close the pit within the time prescribed by regulation due to intermittent but persistent rainfall at the location. Readings from a weather station

located 0.5 Miles ESE of St. John, indicate that during the period between February 02, 2018 and ending August 26, 2019, rainfall totaling 52.79 inches has been received.

8. The name and address of the landowner on whose land the well and pit are located is the Brian L. Dunn Revocable Trust Dated October 22, 2008, 774 NW 10th Avenue, St. John Kansas 67576. The names and addresses of the mineral owners of record and operators of leases of record within one-half (1/2) mile of the subject well and entitled to receive notice of this Application are shown on the attached Exhibit "A."

9. Attached as Exhibit "B" is a plat map showing the Location of the Dunn #1 well.

10. Attached as Exhibit "C" is the report of the Community Collaborative Rain, Hail, and Snow Network showing rainfall in the vicinity of the Dunn #1 location for the period beginning February 02, 2018, and ending August 26, 2019.

Jones Oil, LLC asks that if no written protest is received within thirty (30) days after Notice of the Application has been published and duly provided to all interested parties, the Commission issue an order administratively granting Jones Oil, LLC an exception to the time limitation set forth in K.A.R. 82-3-602 and allow an additional extension of six (6) months. In the event a timely and proper protest is filed with the Commission, Jones Oil, LLC requests that the Commission set this Application for hearing and, upon such hearing, grant the request for exception and afford such other and further relief as Commission deems necessary and proper.

Respectfully submitted

Jones Oil, LLC
112 N Gray St.
St. John KS 67576

By:

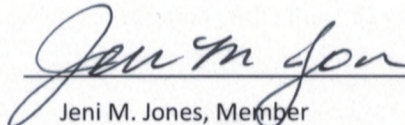
Jeni M. Jones, Member

CERTIFICATE OF SERVICE

I hereby certify that on this 26th day of August, 2019, true and correct copies of the above and foregoing Application and the Notice of Application were served by depositing copies of the same in the United States mail, postage prepaid, and properly addressed to the landowners set forth in Exhibit "A" attached to said Application, and the original Application and all necessary support documentation was mailed to the Kansas Corporation Commission.

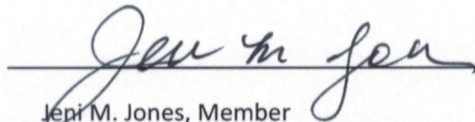
Jeni M. Jones, Member

SCHEDULE "A"

OFFSET OPERATORS/UNLEASED MINERAL OWNERS (within ½ miles radius)

To Jones Oil, LLC

Dunn #1

969' FNL & 330' FEL

Sec. 24-23s-14W

Stafford County, Kansas

Sec. 24-T23S-R14W

NW ¼

Chad & Misty Fisher

PO Box 455

309 W. 6th Ave

St. John, Ks 67576

(Unleased Minerals)

SE ¼

Prater Oil & Gas Operations, Inc.

10356 Bluestem Blvd.

Pratt, Ks 67124

(Offset Operator)

NW ¼

Brian L Dunn Revocable Trust Dated October 22, 2008.

774 NW 10th St

St. John KS 67576

(Mineral Owner)

NW ¼

Rockhound Petroleum, LLC

PO Box 43

St. John, Ks 67576

(Operator)

Sec. 19-T23S-R13W

NW ¼

Richard Smith

16171 W. US Hwy 54

Lot 17

Goddard, Ks 67052

(Unleased Minerals)

SE ¼

Mike Kelso Oil & Gas, Inc.

PO Box 467

Chase, Ks 67524-0467

(Operator)

Sec. 13-T23S-14W

SE ¼
Malin Farms
112 N. Gray St.
St. John, Ks 67576
(Unleased Minerals)

Sec. 18-T23S-13W

SW ¼
Malin Farms
112 N. Gray St.
St. John, Ks 67576
(Unleased Minerals)

Kansas Oil and Gas

Kansas Geological Survey

Statewide View | Zoom to Location | Filter Wells | Label Wells | Download Wells | Print to PDF | Clear Highlight | Help

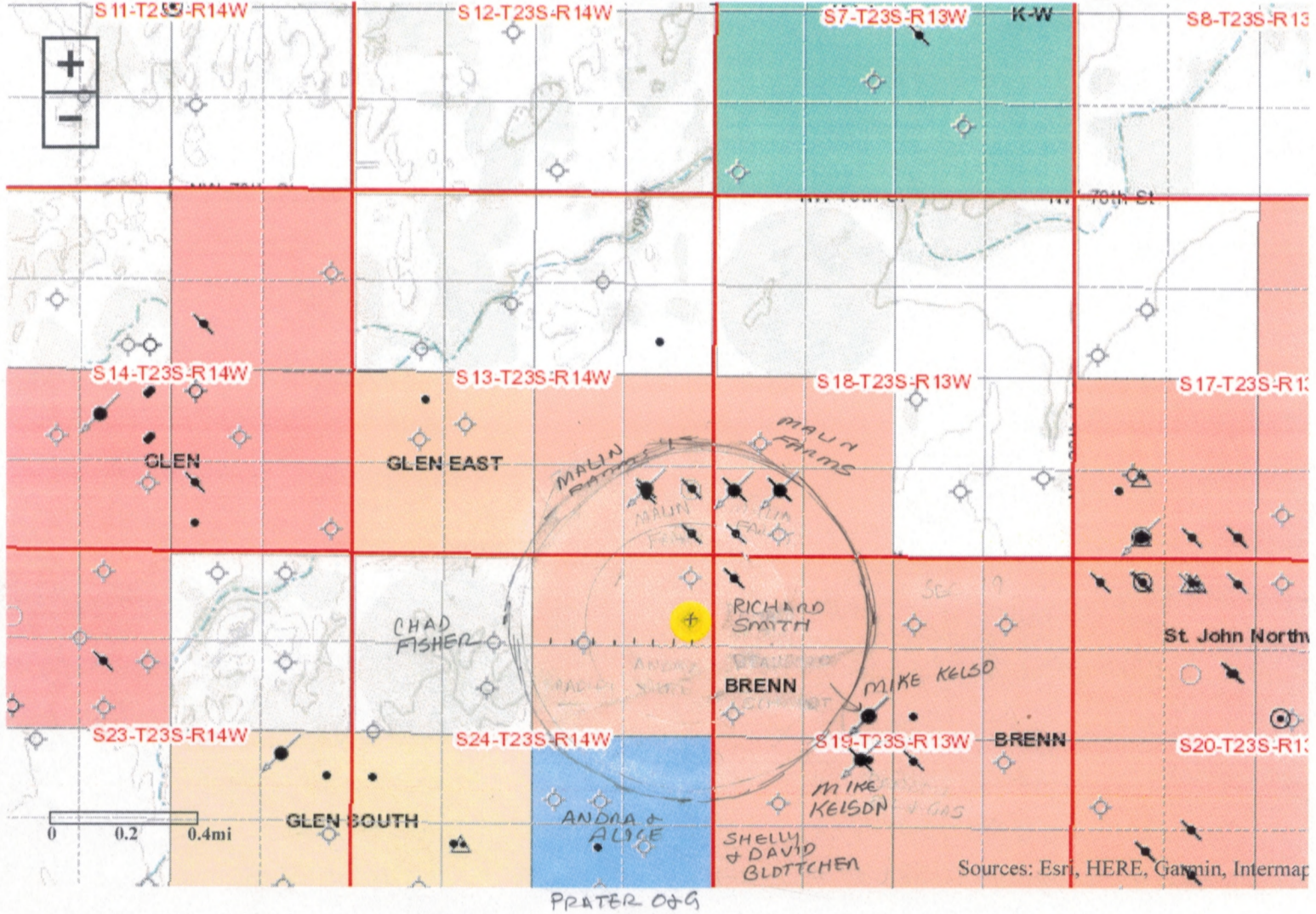

NAME SCHEDULE B

OPERATION

RANDON

View Data : Station Report Summary US Units ▼

View Data

- [Daily Precip Reports](#)
- [Daily Comments Reports](#)
- [Significant Weather Reports](#)
- [Multiple Day Reports](#)
- [Condition Monitoring Reports](#)
- [Condition Monitoring Charts](#)
- [Soil Moisture](#)
- [ET Reports](#)

- [Days with Hail](#)
- [Search Hail Reports](#)
- [Station Hail Reports](#)
- [Station Precip Summary](#)

- [Water Year Summary](#)
- [Station Precip Summary](#)
- [Station Snow Summary](#)
- [Station Water Balance](#)
- [Rainy Days Report](#)
- [Total Precip Summary](#)
- [Water Balance Summary](#)
- [Water Balance Charts](#)
- [List Stations](#)

FROST Data

- [Frost](#)
- [Optics](#)
- [Snowflake](#)
- [Thunder](#)

Main Menu

- [Home](#)
- [About Us](#)
- [Join CoCoRaHS](#)
- [Contact Us](#)
- [Donate](#)

Resources

- [FAQ / Help](#)
- [Education](#)
- [Training Slide-Shows](#)
- [Videos](#)
- [Condition Monitoring](#)
- [Evapotranspiration](#)
- [Soil Moisture](#)

- [Volunteer Coordinators](#)
- [Hail Pad](#)
- [Distribution/Drop-off](#)
- [Help Needed](#)
- [Printable Forms](#)

- [The Catch](#)
- [Message of the Day](#)
- [Publications](#)
- [CoCoRaHS Blog](#)
- [Web Groups](#)
- [State Newsletters](#)
- [Master Gardener Guide](#)

Station Report Summary

Station 1 : Example: CO-LR-273
Station 2 :
Station 3 :
Start Date: **End Date:**

SCHEDULE C

Stations:

KS-SF-6
 St. John 0.5 ESE
 Lat: 37.999443
 Lon: -98.751854

* indicates Multi-Day Accumulation Report

Station
KS-SF-6

Date	Precip in.
02/02/2018	0.00
02/03/2018	0.00
02/04/2018	0.00
02/05/2018	0.00
02/06/2018	0.00
02/07/2018	0.00
02/08/2018	0.00
02/09/2018	0.00
02/10/2018	0.00
02/11/2018	0.00
02/12/2018	0.00
02/13/2018	0.00
02/14/2018	0.00
02/15/2018	0.00
02/16/2018	0.00
02/17/2018	0.00
02/18/2018	0.00
02/19/2018	0.00
02/20/2018	0.00
02/21/2018	0.00
02/22/2018	0.13
02/23/2018	0.00
02/24/2018	0.00
02/25/2018	0.00
02/26/2018	0.00
02/27/2018	0.00
02/28/2018	0.00
03/01/2018	0.00
03/02/2018	0.00
03/03/2018	0.00
03/04/2018	0.00
03/05/2018	0.00
03/06/2018	0.00

- [State Climate Series](#)
- [March Madness](#)
- [WxTalk Webinars](#)

- [Sponsors](#)
- [Links](#)
- [CoCoRaHS Store](#)



SCHEDULE C

03/07/2018	0.00
03/08/2018	0.00
03/09/2018	0.00
03/10/2018	0.00
03/11/2018	0.00
03/12/2018	0.00
03/13/2018	0.00
03/14/2018	0.00
03/15/2018	0.00
03/16/2018	0.00
03/17/2018	0.00
03/18/2018	0.00
03/19/2018	0.00
03/20/2018	NA
03/21/2018	0.00
03/22/2018	0.00
03/23/2018	0.00
03/24/2018	0.00
03/25/2018	**
03/26/2018	0.20 *
03/27/2018	0.00
03/28/2018	0.00
03/29/2018	0.04
03/30/2018	0.00
03/31/2018	0.00
04/01/2018	0.00
04/02/2018	0.00
04/03/2018	0.00
04/04/2018	0.00
04/05/2018	0.00
04/06/2018	0.00
04/07/2018	**
04/08/2018	**
04/09/2018	0.18 *
04/10/2018	0.00
04/11/2018	0.00
04/12/2018	0.00
04/13/2018	0.00
04/14/2018	0.00
04/15/2018	0.00
04/16/2018	0.00
04/17/2018	0.00
04/18/2018	0.00
04/19/2018	0.00
04/20/2018	**
04/21/2018	**
04/22/2018	0.86 *
04/23/2018	0.00
04/24/2018	0.00
04/25/2018	0.42
04/26/2018	0.00
04/27/2018	0.00
04/28/2018	0.00
04/29/2018	0.00
04/30/2018	0.00
05/01/2018	0.00
05/02/2018	0.23
05/03/2018	0.96

05/04/2018	0.00
05/05/2018	0.00
05/06/2018	0.00
05/07/2018	0.00
05/08/2018	0.00
05/09/2018	0.00
05/10/2018	0.72
05/11/2018	0.00
05/12/2018	0.00
05/13/2018	0.00
05/14/2018	0.00
05/15/2018	0.01
05/16/2018	0.00
05/17/2018	0.00
05/18/2018	0.00
05/19/2018	0.89
05/20/2018	0.00
05/21/2018	0.00
05/22/2018	0.00
05/23/2018	0.00
05/24/2018	0.69
05/25/2018	0.00
05/26/2018	0.00
05/27/2018	0.00
05/28/2018	0.00
05/29/2018	0.36
05/30/2018	0.85
05/31/2018	0.00
06/01/2018	0.00
06/02/2018	0.00
06/03/2018	0.00
06/04/2018	0.00
06/05/2018	0.00
06/06/2018	0.00
06/07/2018	0.33
06/08/2018	0.00
06/09/2018	0.00
06/10/2018	0.00
06/11/2018	0.00
06/12/2018	0.00
06/13/2018	0.00
06/14/2018	0.00
06/15/2018	0.00
06/16/2018	0.00
06/17/2018	0.00
06/18/2018	0.00
06/19/2018	0.00
06/20/2018	0.69
06/21/2018	0.00
06/22/2018	0.00
06/23/2018	0.45
06/24/2018	0.00
06/25/2018	1.30
06/26/2018	0.00
06/27/2018	0.27
06/28/2018	0.00
06/29/2018	0.00
06/30/2018	0.00

07/01/2018	0.07
07/02/2018	0.00
07/03/2018	0.00
07/04/2018	0.00
07/05/2018	0.00
07/06/2018	0.92
07/07/2018	0.00
07/08/2018	0.00
07/09/2018	0.00
07/10/2018	0.00
07/11/2018	0.00
07/12/2018	0.00
07/13/2018	0.00
07/14/2018	2.19
07/15/2018	0.00
07/16/2018	0.00
07/17/2018	0.35
07/18/2018	0.00
07/19/2018	0.00
07/20/2018	0.00
07/21/2018	0.05
07/22/2018	0.00
07/23/2018	0.00
07/24/2018	0.00
07/25/2018	0.00
07/26/2018	0.22
07/27/2018	0.00
07/28/2018	0.09
07/29/2018	**
07/30/2018	1.09 *
07/31/2018	0.26
08/01/2018	0.00
08/02/2018	0.00
08/03/2018	0.00
08/04/2018	0.00
08/05/2018	0.00
08/06/2018	0.00
08/07/2018	0.00
08/08/2018	0.00
08/09/2018	0.00
08/10/2018	0.00
08/11/2018	0.00
08/12/2018	0.00
08/13/2018	0.02
08/14/2018	0.40
08/15/2018	0.00
08/16/2018	0.00
08/17/2018	0.43
08/18/2018	0.00
08/19/2018	**
08/20/2018	NA
08/21/2018	0.00
08/22/2018	0.00
08/23/2018	0.17
08/24/2018	0.01
08/25/2018	0.00
08/26/2018	0.00
08/27/2018	0.00

08/28/2018	0.00
08/29/2018	0.00
08/30/2018	0.00
08/31/2018	0.01
09/01/2018	0.00
09/02/2018	**
09/03/2018	**
09/04/2018	2.26 *
09/05/2018	0.14
09/06/2018	0.06
09/07/2018	0.00
09/08/2018	0.05
09/09/2018	0.00
09/10/2018	0.00
09/11/2018	0.00
09/12/2018	0.00
09/13/2018	0.00
09/14/2018	0.00
09/15/2018	0.00
09/16/2018	0.00
09/17/2018	0.00
09/18/2018	0.00
09/19/2018	0.00
09/20/2018	0.00
09/21/2018	0.11
09/22/2018	0.00
09/23/2018	0.00
09/24/2018	0.00
09/25/2018	0.00
09/26/2018	0.00
09/27/2018	0.00
09/28/2018	0.00
09/29/2018	0.03
09/30/2018	0.00
10/01/2018	0.00
10/02/2018	0.00
10/03/2018	0.00
10/04/2018	2.32
10/05/2018	0.00
10/06/2018	**
10/07/2018	**
10/08/2018	**
10/09/2018	5.16 *
10/10/2018	NA
10/11/2018	0.00
10/12/2018	0.05
10/13/2018	0.00
10/14/2018	0.00
10/15/2018	0.46
10/16/2018	0.00
10/17/2018	0.00
10/18/2018	0.00
10/19/2018	0.00
10/20/2018	0.00
10/21/2018	0.00
10/22/2018	0.00
10/23/2018	0.00
10/24/2018	0.00

10/25/2018	0.00
10/26/2018	NA
10/27/2018	0.00
10/28/2018	0.00
10/29/2018	0.00
10/30/2018	0.00
10/31/2018	0.00
11/01/2018	0.00
11/02/2018	0.00
11/03/2018	0.00
11/04/2018	0.00
11/05/2018	0.21
11/06/2018	0.00
11/07/2018	0.01
11/08/2018	0.00
11/09/2018	0.33
11/10/2018	0.00
11/11/2018	0.00
11/12/2018	0.00
11/13/2018	0.00
11/14/2018	0.00
11/15/2018	0.07
11/16/2018	0.00
11/17/2018	0.00
11/18/2018	0.00
11/19/2018	0.00
11/20/2018	0.00
11/21/2018	0.00
11/22/2018	0.00
11/23/2018	0.00
11/24/2018	0.00
11/25/2018	0.00
11/26/2018	0.00
11/27/2018	0.00
11/28/2018	0.00
11/29/2018	0.00
11/30/2018	0.00
12/01/2018	0.00
12/02/2018	0.00
12/03/2018	0.00
12/04/2018	0.00
12/05/2018	0.00
12/06/2018	0.00
12/07/2018	0.00
12/08/2018	0.00
12/09/2018	0.00
12/10/2018	0.00
12/11/2018	0.00
12/12/2018	0.00
12/13/2018	0.00
12/14/2018	0.00
12/15/2018	0.00
12/16/2018	0.00
12/17/2018	0.00
12/18/2018	0.00
12/19/2018	0.00
12/20/2018	0.00
12/21/2018	0.00

12/22/2018	0.00
12/23/2018	0.00
12/24/2018	0.00
12/25/2018	0.00
12/26/2018	0.30
12/27/2018	0.00
12/28/2018	1.07
12/29/2018	0.00
12/30/2018	0.00
12/31/2018	0.00
01/01/2019	0.00
01/02/2019	0.00
01/03/2019	0.00
01/04/2019	0.00
01/05/2019	0.00
01/06/2019	0.00
01/07/2019	0.00
01/08/2019	0.00
01/09/2019	0.00
01/10/2019	0.00
01/11/2019	0.00
01/12/2019	0.00
01/13/2019	0.91
01/14/2019	0.00
01/15/2019	0.00
01/16/2019	0.00
01/17/2019	0.00
01/18/2019	0.00
01/19/2019	0.00
01/20/2019	0.00
01/21/2019	0.00
01/22/2019	0.00
01/23/2019	0.00
01/24/2019	0.00
01/25/2019	0.00
01/26/2019	0.00
01/27/2019	0.00
01/28/2019	0.00
01/29/2019	0.00
01/30/2019	0.00
01/31/2019	0.00
02/01/2019	0.00
02/02/2019	0.00
02/03/2019	0.00
02/04/2019	0.00
02/05/2019	0.00
02/06/2019	0.00
02/07/2019	0.00
02/08/2019	0.00
02/09/2019	0.00
02/10/2019	0.00
02/11/2019	0.00
02/12/2019	0.00
02/13/2019	0.00
02/14/2019	0.00
02/15/2019	0.00
02/16/2019	0.00
02/17/2019	0.00

02/18/2019	0.00
02/19/2019	0.00
02/20/2019	0.14
02/21/2019	0.00
02/22/2019	0.00
02/23/2019	0.00
02/24/2019	0.00
02/25/2019	NA
02/26/2019	0.00
02/27/2019	0.00
02/28/2019	0.00
03/01/2019	0.00
03/02/2019	0.00
03/03/2019	0.00
03/04/2019	0.00
03/05/2019	0.12
03/06/2019	0.00
03/07/2019	0.00
03/08/2019	0.00
03/09/2019	0.00
03/10/2019	0.00
03/11/2019	0.00
03/12/2019	0.00
03/13/2019	0.00
03/14/2019	1.04
03/15/2019	0.00
03/16/2019	0.00
03/17/2019	0.00
03/18/2019	0.00
03/19/2019	0.00
03/20/2019	0.02
03/21/2019	0.00
03/22/2019	0.00
03/23/2019	0.00
03/24/2019	0.00
03/25/2019	0.21
03/26/2019	0.00
03/27/2019	0.00
03/28/2019	0.00
03/29/2019	0.00
03/30/2019	0.00
03/31/2019	0.00
04/01/2019	0.10
04/02/2019	0.00
04/03/2019	0.00
04/04/2019	0.00
04/05/2019	0.00
04/06/2019	0.00
04/07/2019	0.01
04/08/2019	0.00
04/09/2019	0.00
04/10/2019	0.00
04/11/2019	0.00
04/12/2019	0.00
04/13/2019	0.00
04/14/2019	0.00
04/15/2019	0.00
04/16/2019	0.00

04/17/2019	0.00
04/18/2019	0.00
04/19/2019	0.00
04/20/2019	0.00
04/21/2019	0.00
04/22/2019	0.00
04/23/2019	0.00
04/24/2019	0.03
04/25/2019	0.00
04/26/2019	0.00
04/27/2019	0.00
04/28/2019	0.00
04/29/2019	0.03
04/30/2019	0.00
05/01/2019	0.70
05/02/2019	0.00
05/03/2019	0.04
05/04/2019	0.00
05/05/2019	0.00
05/06/2019	0.00
05/07/2019	0.44
05/08/2019	2.36
05/09/2019	0.55
05/10/2019	0.08
05/11/2019	0.03
05/12/2019	0.00
05/13/2019	0.00
05/14/2019	0.00
05/15/2019	0.00
05/16/2019	0.00
05/17/2019	0.00
05/18/2019	0.07
05/19/2019	0.00
05/20/2019	0.00
05/21/2019	2.37
05/22/2019	0.33
05/23/2019	0.00
05/24/2019	0.52
05/25/2019	**
05/26/2019	**
05/27/2019	**
05/28/2019	2.14 *
05/29/2019	0.00
05/30/2019	0.00
05/31/2019	0.00
06/01/2019	0.00
06/02/2019	0.00
06/03/2019	0.00
06/04/2019	0.00
06/05/2019	0.00
06/06/2019	0.00
06/07/2019	0.93
06/08/2019	0.00
06/09/2019	0.00
06/10/2019	0.61
06/11/2019	0.00
06/12/2019	0.00
06/13/2019	0.00

06/14/2019	0.00
06/15/2019	0.40
06/16/2019	0.00
06/17/2019	0.00
06/18/2019	0.00
06/19/2019	0.08
06/20/2019	0.09
06/21/2019	0.00
06/22/2019	1.13
06/23/2019	1.52
06/24/2019	0.00
06/25/2019	0.00
06/26/2019	0.00
06/27/2019	0.00
06/28/2019	0.00
06/29/2019	0.00
06/30/2019	0.00
07/01/2019	0.00
07/02/2019	0.00
07/03/2019	0.07
07/04/2019	0.00
07/05/2019	0.00
07/06/2019	0.95
07/07/2019	0.00
07/08/2019	0.00
07/09/2019	0.04
07/10/2019	0.00
07/11/2019	0.00
07/12/2019	0.00
07/13/2019	0.00
07/14/2019	0.00
07/15/2019	0.00
07/16/2019	0.00
07/17/2019	0.00
07/18/2019	0.00
07/19/2019	--
07/20/2019	--
07/21/2019	--
07/22/2019	--
07/23/2019	--
07/24/2019	--
07/25/2019	--
07/26/2019	--
07/27/2019	--
07/28/2019	--
07/29/2019	0.04
07/30/2019	--
07/31/2019	--
08/01/2019	--
08/02/2019	--
08/03/2019	--
08/04/2019	--
08/05/2019	--
08/06/2019	--
08/07/2019	--
08/08/2019	--
08/09/2019	0.30
08/10/2019	0.34

08/11/2019	--
08/12/2019	--
08/13/2019	--
08/14/2019	0.31
08/15/2019	--
08/16/2019	--
08/17/2019	0.21
08/18/2019	--
08/19/2019	--
08/20/2019	--
08/21/2019	--
08/22/2019	0.68
08/23/2019	--
08/24/2019	--
08/25/2019	2.68
08/26/2019	--
Totals :	52.79 in.

For questions or comments concerning this web page please contact info@cocorahs.org.
Unless otherwise noted, all content on the CoCoRaHS website is released under a [Creative Commons Attribution 3.0 License](#).
[Privacy Policy](#) [Data Usage Policy](#) Copyright © 1998-2019, Colorado Climate Center, All rights reserved.

**BEFORE ME
STATE CORPORATION COMMISSION
OF THE STATE OF KANSAS**

RE: APPLICATION OF JONES OIL, LLC
FOR AN EXCEPTION TO THE PIT
CLOSURE TIME LIMITATION OF K.A.R.
82-3-602 FOR THE DUNN #1,
LOCATED IN STAFFORD COUNTY,
KANSAS

TO: ALL LANDOWNERS, OIL AND GAS
OFFSETTING OPERATORS, LEASE
HOLDERS, UNLEASED MINERAL
OWNERS AND ALL PERSONS
CONCERNED:

You, and each of you, are hereby
notified that Jones Oil, LLC has filed
an Application for an exception to the
Pit Closure time limitation of K.A.R.
82-3 602 at its Dunn #1 well in
Section 24, Township 23S South,
Range 13 West, Stafford County,
Kansas.

Any Person who object to or protest
this Application shall be required to
file their objections or protests in
writing with the State Corporation
Commission of the State of Kansas
within thirty (30) days from the date of
this publication. All objections and
protest must be filed pursuant
Commission regulations and must
state specific reasons why granting
the Application may cause waste,
violate correlative rights or pollute the
natural resources of the State of
Kansas.

All persons interested or concerned
shall take notice of the foregoing and
shall govern themselves accordingly.

**Jones Oil, LLC
112 N Gray St
St. John, Kansas 67576**