

KANSAS CORPORATION COMMISSION
OIL & GAS CONSERVATION DIVISION

APPLICATION TO AMEND INJECTION PERMIT

2019-01-31 14:24:52
Kansas Corporation Commission
/s/ Lynn M. Retz

Form U-8
July 2014
Form must be Typed
Form must be Signed
All blanks must be Filled

- ☐ Salt Water Disposal
☒ Repressuring
☐ Other Enhanced Recovery

Permit Number: E-17,207NW 1/4 Sec. 18 Twp. 32 S. R. 6 ☒ East ☐ West2970 Feet from ☐ North / ☒ South Section Line2970 Feet from ☒ East / ☐ West Section LineLease: HammerWell #: 5 15-035-19,501-00-01Cowley County, KansasOriginally granted to: H & M Drilling Co.

(All information above this line taken from the original permit)

Current Operator: License # 6017 Exp. 06/30/19 Contact Person: Donna HopperCompany Name: Hopper Oil Company, Inc

(As listed on operator license)

Received
KANSAS CORPORATION COMMISSIONAddress: 1011 Mound Winfield KS 67156Phone: 620 221-7171

JAN 30 2019

CONSERVATION DIVISION
WICHITA, KS

It is requested that the (caption) (paragraph # _____) of the original permit be amended as follows:

- ☐ A. Change the authorized injection pressure to: _____ psi maximum from the current permitted pressure of _____ psi.
- ☐ B. Change the authorized injection rate to: _____ bbl/day maximum from the current rate of _____ bbl/day.
- ☐ C. Add (_____) or delete (_____) the following leases/facilities supplying produced saltwater or other fluids approved by the Conservation Division.

Company Name	Lease Name	Lease Description
1. _____	_____	_____
2. _____	_____	_____
3. _____	_____	_____
4. _____	_____	_____
5. _____	_____	_____
6. _____	_____	_____
7. _____	_____	_____
8. _____	_____	_____

(Attach additional sheets if necessary)

- ☒ D. Change the permit by: (X) add the following repressuring wells: #10 ;
(_____) change the injection formation; or (_____) change well construction; or (_____) other:

Mail to: KCC - Conservation Division, 266 N Main St, Ste 220, Wichita, Kansas 67202-1513

Paid \$100.00
CK 7306
1/30/19

Offset Operators, Unleased Mineral Owners and Landowners

Form U-8

(Attach additional sheets if necessary)

Name <u>Hammer</u>	Legal Description of Leasehold <u>18-32-6E</u>	
<u>Josephine Hammer E/2 NW/4 18-32S-6E</u>	<u>Dianna Weigand SE SE/4 12-32S-5E</u>	
<u>Stanley Hammer E/2 NW/4 18-32S-6E</u>	<u>Brothers Dairy S/2 SW/4 7-32S-6E</u>	
<u>Ronald Poltera W/2 NE/4 18-32S-6E</u>	<u>Larry Stevens S/2 SE/4 7-32S-6E</u>	
<u>Chris Rogers E/2 NE/4 18-32S-6E</u>		
<u>Marvin Bailey N/2 SW/4 18/32S/6E</u>		
<u>Robert Hill E/2 NE/4 13-32S-5E</u>		Received KANSAS CORPORATION COMMISSION
<u>Jimmie Neal NE SE/4 18-32S-5E</u>		JAN 30 2019
<u>Arlene Miller E/2 NE/4 13-32S-5E</u>		CONSERVATION DIVISION WICHITA, KS

I hereby certify that the statements made herein are true and correct to the best of my knowledge and belief.

Applicant or Duly Authorized Agent

Subscribed and sworn to before me this 18 day of January, 2019.

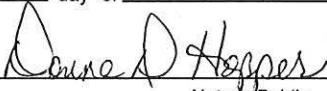
Notary Public

My Commission Expires: September 1, 2021

Instructions for Form U-8*Application to Amend Injection Permit*

1. All requested changes in injection authority must be submitted with this form.
2. Complete the top portion, (side 1) of the form with the information requested for the pilot well, as shown on the original order or permit.
3. Complete the current operator information, listing the license number, current name and address, contact person and phone number.
4. Fill in the type of change or amendment desired. Leave blank any sections not applicable.
5. For amendments adding additional input wells to enhanced recovery permits, the following information must be submitted in addition to pages 1 and 2 of form U-8:
 - a) pages 1 and 2 of form U-1
 - b) an updated map, showing the new well(s) and all existing wells; page 4 of the form U-1.
 - c) a complete log of the well(s) to be added;
 - d) verification of cement (cement tickets, bond log, etc.) *Do not have. Well drilled in 1977, before we owned it.*
6. Attach Affidavit of Notice Served, page 5 of form U-1.
7. Attach Affidavit of Publication from the official county newspaper.
8. This form must be signed by the applicant or an authorized agent. A notarization of the signature is required.
9. All applicable fees must accompany this application.

KANSAS CORPORATION COMMISSION
OIL & GAS CONSERVATION DIVISION
APPLICATION FOR INJECTION WELL

Form U-1
July 2014
Form must be Typed
Form must be Signed
All blanks must be Filled

Disposal ☐

Enhanced Recovery: ☒ Repressuring

☐ Waterflood

☐ Tertiary

Date: January 18, 2019

Operator License Number: 6017

Operator: HOPPER OIL CO., INC.

Address: 1011 Mound
Winfield, KS 67156

Contact Person: Donna Hopper

Phone: 620 221-7171

Email: _____

Permit Number: E 17,207

API Number: 15-035-21252-00-01

Well Location

- NW SE - NW Sec. 18 Twp. 32 S. R. 6 ☒ E ☐ W

3630 feet from ☐ N / ☒ S Line of Section

3630 feet from ☒ E / ☐ W Line of Section

GPS Location: Lat: _____, Long: _____
(e.g. xx.xxxxx) (e.g. -xxx.xxxxx)

Datum: ☐ NAD27 ☐ NAD83 ☐ WGS84

Lease Description: E/2 NW/4

Lease Name: Hammer Well Number: 10

Field Name: Turner North

County: Cowley

Deepest Usable Water

Formation: _____

Depth to Bottom of Formation: 200

Received
KANSAS CORPORATION COMMISSION

JAN 30 2019

CONSERVATION DIVISION
WICHITA, KS

Check One: ☒ Old Well Being Converted ☐ Newly Drilled Well ☐ Well to be Drilled

Surface Elevation: 1341 feet Well Total Depth: 3024 feet Plug Back Depth: _____ feet

Datum of top of injection formation: _____ feet (reference mean sea level)

Injection Formation Description:

Name	top / bottom	perf / open hole	depth
Bartlesville	2986 /	open hole	at 3015 to 3024 feet
	/		at to feet

List of Wells/Facilities Supplying Produced Saltwater or Other Fluids Approved by the Conservation Division:

(attach additional sheets if necessary)

Lease Operator	Lease/Facility Name	Lease/Facility Description	Well ID & Spot Location
1. Hopper Oil Co., Inc	Hammer		1-2-4-7-8
2.			
3.			

Producing Formation	Strata Depth	Total Dissolved Solids (if available)
1. Bartlesville	3020 to 3024 feet	mg/l
2.	to feet	mg/l
3.	to feet	mg/l

Maximum Requested Liquid Injection Rate: 150 bbls / day; or

Maximum Requested Gas Injection Rate: _____ scf / day. Type of Gas: _____

Maximum Requested Injection Pressure: 250 psig

Well CompletionType: ☐ Tubing & Packer ☐ Packerless ☐ Tubingless

	Conductor	Surface	Intermediate	Production	Tubing
Size		8.625		5.5	
Setting Depth		200		3015	
Amount of Cement		140		100	
Top of Cement		surface		2500	
Bottom of Cement		200		3015	

If Alternate II cementing, complete the following:

Perforations / D.V. Tool at _____ feet, cemented to _____ feet with _____ sx.

Tubing: Type _____ Grade _____

Packer: Type _____ Depth _____

Annulus Corrosion Inhibitor: Type _____ Concentration _____

List Logs Enclosed: _____

Received
KANSAS CORPORATION COMMISSION

JAN 30 2019

CONSERVATION DIVISION
WICHITA, KS**Well Sketch**

(To sketch installation, darken the appropriate lines, indicate cement, and show depths.)

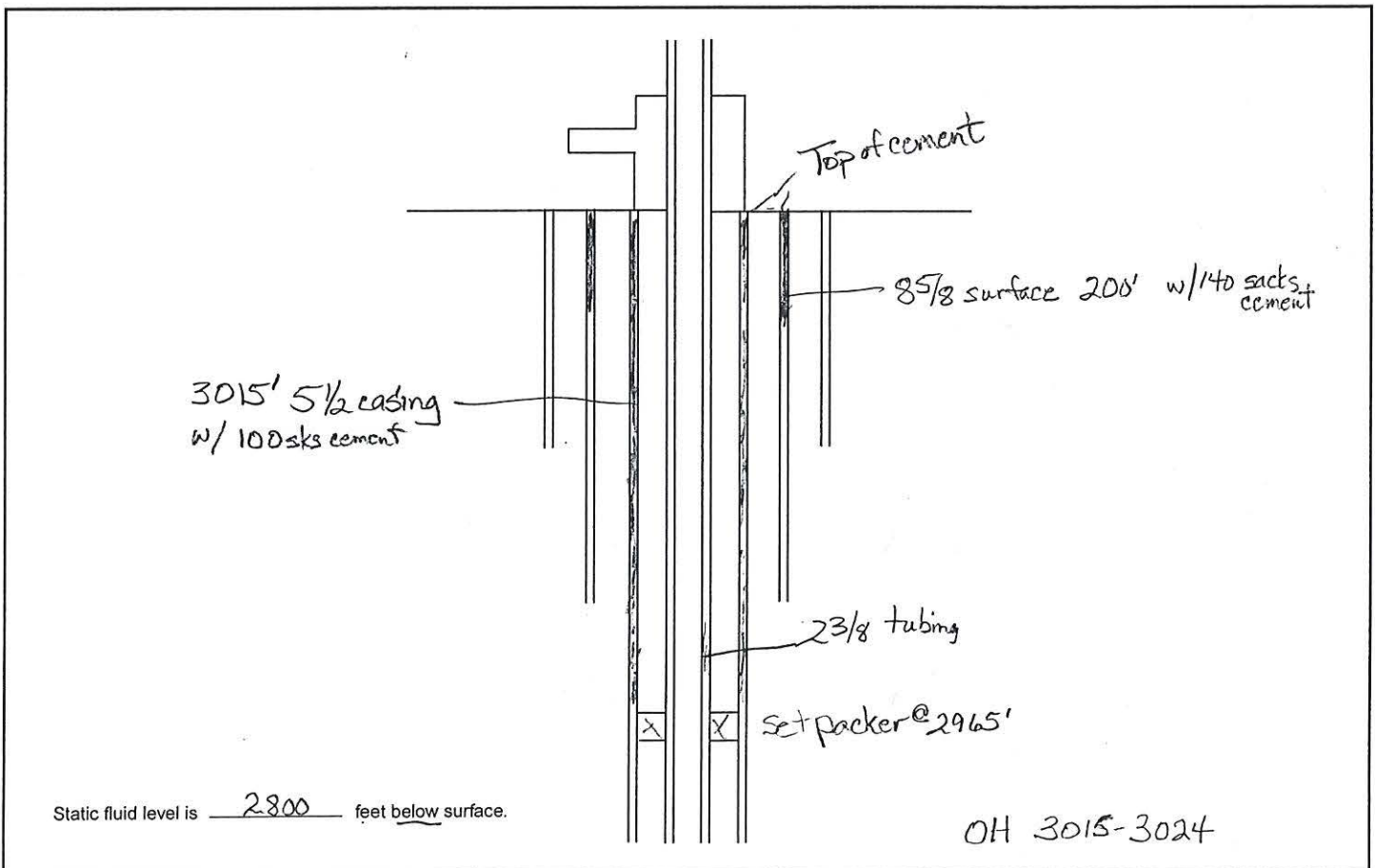

Plat and Certificate of Injection Well Location and Surrounding Acreages

Operator: Hopper Oil Company Inc Location of Well: NW-SE-NW
 Lease: Hammer 3630 feet from ☐ N / ☒ S Line of Section
 Well Number: 3630 feet from ☒ E / ☐ W Line of Section
 County: Cowley Sec. 18 Twp. 32S S. R. 6 ☒ East ☐ West

Plat

Show the following information: applicant injection well, all producing wells, inactive wells, plugged wells, and other wells within a one-half mile radius, all lease boundaries, lease operators, unleased mineral rights owners, well numbers, and producing wells producing formation tops.

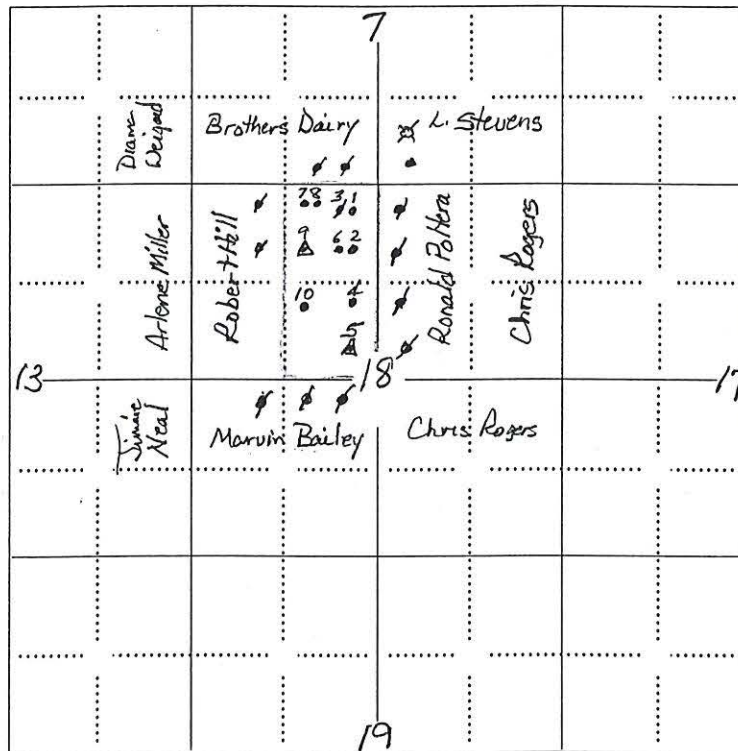

Received
KANSAS CORPORATION COMMISSION

JAN 30 2019

CONSERVATION DIVISION
WICHITA, KS

applicant well producing well plugged injection well
 D & A well other injection well temporary abandoned well
 plugged producer water supply well

The undersigned hereby certifies that he / she is a duly authorized agent for Hopper Oil Co., Inc., and that all of the information shown herein is true, complete and correct to the best of his / her knowledge.

Applicant or Duly Authorized Agent

Subscribed and sworn before me this 18 day of January, 2019

Notary Public

My Commission Expires: September 1, 2019

Affidavit of Notice ServedRe: Application for: Injection PermitWell Name: Hammer #10Legal Location: E/2 NW/4 18-32S-6E

The undersigned hereby certifies that he / she is a duly authorized agent for the applicant, and that on the day 18 of January, 2019, a true and correct copy of the application referenced above was delivered or mailed to the following parties:

Note: A copy of this affidavit must be served as a part of the application.

Name	Address (Attach additional sheets if necessary)
Josephine Hammer	55 E Pearson St Unit 3506 Chicago IL 60611
Stanley Hammer	23473 202nd Road Dexter KS 67038
Ronald Poltera	17486 185th Dr Winfield KS 67156
Chris Rogers	117 College Winfield KS 67156
Marvin Bailey	15592 181st Rd Winfield KS 67156
Robert Hill	11819 S Partridge Partridge KS 67566
Jimmie Neal	18656 152nd Rd Winfield KS 67156
Arlene Miller	1804 Weile Winfield KS 67156
Dianna Weigand	18774 142nd Rd Winfield KS 67156
Brothers Dairy	12255 171st Rd Winfield KS 67156
Larry Stevens	2915 Amos Becker Rd Winfield KS 67156

I further attest that notice of the filing of this application was published in the 17th January 2019, the official county publication of Cowley Courier Traveler county. A copy of the affidavit of this publication is attached.

Signed this 18 day of January, 2019

Received
KANSAS CORPORATION COMMISSION

JAN 30 2019

CONSERVATION DIVISION
WICHITA, KS

Applicant or Duly Authorized Agent

Subscribed and sworn to before me this 18 day of January, 2019

Notary Public

My Commission Expires: September 1, 2021

Protests may be filed by any party having a valid interest in the application. Petitions for protests shall be in writing and shall clearly identify the name and address of the protestant and the title of the application. The petition shall include a clear and concise statement of the direct and substantial interest of the protestant in the proceedings, including the manner in which the protestant may be affected, and the nature, extent, character and grounds of the protest. Protestants shall serve the protest upon the applicant by mail or personal service at the same time or before the protestant files the protest with the Conservation Division. Protests must be filed within 30 days of the publication notice of the application.