

FEB 07 2018

CONSERVATION DIVISION  
WICHITA, KS

THE STATE CORPORATION COMMISSION  
OF THE STATE OF KANSAS

Before Commissioners: Jay Scott Emler, Chairman  
Shari Feist Albrecht  
Pat Apple

In the matter of the Application of SEK Energy, LLC ("Operator") for an exception to the 10-year time limitation of K.A.R. 82-3-111 for its Bradford, Richard #1-5 well located in the NW/4 of Section 05, Township 30 South, Range 16 East, Wilson County, Kansas.

Docket No. ~~16-CONS-~~ 18-CONS-3313-CEXC ~~CEXC~~

CONSERVATION DIVISION

License No.: 33739

APPLICATION

COMES NOW SEK Energy, LLC ("Applicant") in support of its Application in the captioned matter and states as follows:

1. Applicant is a LLC authorized to do business in the State of Kansas. Applicant's address is 149 Benedict Road, Benedict, KS 66714.

2. Applicant has been issued by the Kansas Corporation Commission Operator's License #33739, which expires on 02/28/2018.

3. Applicant is the owner and operator of the Bradford, Richard #1-5 well, API No. 15-205-26979-0000 ("the subject well"), which is located in the Northwest Quarter of the Southwest Quarter of the Northwest Quarter of Section 5, Township 30 South, Range 16 East, Wilson County, Kansas. The subject well is located on an active oil and gas lease or unit comprising the following lands:

Lots Three (3) and Four (4) and all that part of the Southwest Quarter (SW4) lying North of the Verdigris River in Section Five (5), Township Thirty South (T30S), Range Sixteen East (R16E), in Wilson County, Kansas.

4. Pursuant to K.A.R. 82-3-111, the well was shut in, or Applicant obtained temporary

abandonment status, for the subject well on 12/28/2006. The subject well has maintained such status from 12/28/2006, to the present date.

5. On or about 05/15/17, the Kansas Corporation Commission notified Applicant temporary abandonment status for the subject well would be denied from and after 12/28/16, because subject well had been temporarily abandoned for more than ten (10) years.

6. K.A.R. 82-3-111 imposes a 10-year limitation on the amount of time during which wells may be temporarily abandoned, but an exception to the 10-year limitation may be obtained pursuant to said regulation through an Application filed with the Commission pursuant to K.A.R. 82-3-100. Applicant seeks such an exception.

7. The subject well is capable of passing a Commission Staff-witnessed mechanical integrity test of the casing between the surface and a point within fifty (50) feet above the uppermost perforation or open hole in the well.

8. Applicant wishes to continue TA status for the subject well, because Applicant intends to use the well for the following purpose: To be completed as oil/gas well

9. Applicant submits the following information regarding the well in support of the Application. See attached Exhibit "A"

10. Applicant has included a plat map showing the locations of all producing, injection, temporarily abandoned, abandoned, and plugged wells located on the same leased premises as the subject well.

11. Based on the foregoing, Applicant requests the Commission grant an exception to the 10-year limitation, specifically to allow the subject well to remain eligible for temporary abandonment status for three (3) years following the expiration of the 10-year limitation.

Applicant understands that the exception would be valid for three (3) years, but Applicant would still need to apply annually to the Conservation Division District Office for approval of an application for temporary abandonment status.

12. Listed in the attached Exhibit "B" are the names and addresses of the following persons:

- A. Each operator of each oil and gas lease covering lands within one-half (1/2) mile radius of the subject well; and
- B. Each person who owns any mineral interest of record in and under any lands located within one-half (1/2) mile radius of subject well (provided that such mineral interest is not covered by any oil and gas lease).

13. Notice of this Application will be published pursuant to K.A.R. 82-3-135a. In addition, notice of the hearing to be held in this matter will be provided as prescribed by K.A.R. 82-3-135.

WHEREFORE, Applicant prays that this matter be granted administratively without a hearing, or in the alternative be set for hearing, and upon hearing that the Commission grant Applicant's request, for an exception to the K.A.R. 82-3-111 ten (10) year limitation, to allow the subject well to remain temporarily abandoned for three (3) years, subject to annual approval by the Conservation Division District Office of an application for temporary abandonment status.

Respectfully Submitted,

SEK Energy, LLC  
P.O.Box55  
620-698-2150  
620-698-2180

By

Douglas Lamb

## **CERTIFICATE OF SERVICE**

I hereby certify on this 15<sup>th</sup> day of January, 2018, true and correct copies of the above and foregoing Application and the Notice of Application were served by depositing copies of the same in the United States Mail, postage prepaid, and properly addressed to the landowner/s set forth in paragraph 12 of said Application and each party set forth in Exhibit "C" attached to said Application filed by Applicant, and the original and seven (7) copies were hand delivered to the Kansas Corporation Commission.

Douglas Lamb

## Exhibit "A"

### Information in Support of the Application to Extend TA status

- a. There is a total of 2 wells on the lease. One producing CBM gas well and this T/A CBM gas well.
- b. SEK estimates that it would cost approximately \$5,000 to plug this well and \$5,000 for additional wells.
- c. The Bradford, Richard lease makes approximately 10 Mcf/day.
- d. We estimate the remaining gas reserves to be 150k+ Mcf. The 150k+ Mcf gas reserves is a conservative estimate based on 100k+ MCF cumulative average for potential gas wells to be completed on the lease in the future. Other nearby gas wells have cumulative production of this amount over 10 year period.
- e. This well has been drilled, cased and cemented to surface. To place the well into service will require perforating, fracking, downhole equipment, wellsite equipment, installing electric, and mainly installing water/gas flowlines.
- f. SEK has invested over \$61,000 thus far and estimates that it will cost between \$60,000-\$75,000 to finish putting the well into service.

## Kansas Oil and Gas

Statewide View | [Zoom to Location](#) | [Filter Wells](#) | [Label Wells](#) | [Download Wells](#) | [Print to PDF](#) | [Clear Highlight](#) | [Help](#)

Exhibit "B"

SEK Energy, LLC  
P.O. Box 55  
Benedict, KS 66714

A. Operators

1. **River Rock Operating, LLC**, 211 N. Robinson Suite 200, Oklahoma City, OK 73102
2. **LR Energy, Inc.**, 8150 N. Central Expy. Ste. 1605, Dallas, TX 75206

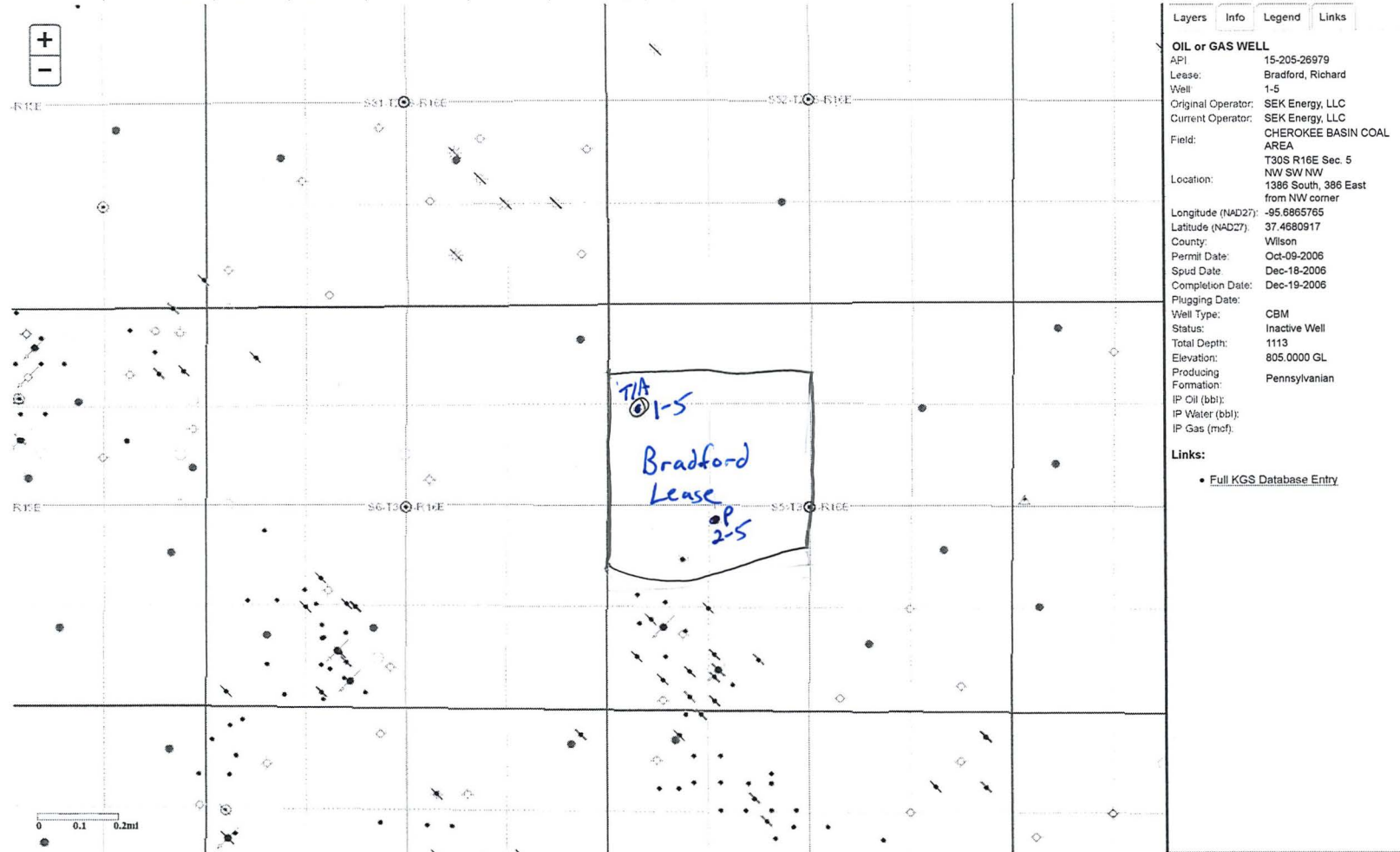
B. Landowners

1. **Richard & Debra Bradford**, 14373 Viola Rd., Chanute, KS 66720
2. **Jim & Gyda Bauman**, 4672 Nevada Road, Neodesha, KS 66757
3. **Gary D. & Debra A. Willhite Trust**, 1708 North Main, Eldorado, KS 67042
4. **John Porter**, 11742 Scott Road, Altoona, KS 66710
5. **Lee R. Porter**, 605 N. Louise St., Unit #102, Glendale, CA 91206
6. **Jonas Hoesli**, 5976 Pratt Road, Neodesha, KS 66757