

**BEFORE THE STATE CORPORATION COMMISSION
OF THE STATE OF KANSAS**

IN THE MATTER OF THE APPLICATION OF)
WESTAR ENERGY, INC. FOR CERTIFICATE)
PUBLIC CONVENIENCE AND AUTHORITY)
TO TRANSACT THE BUSINESS OF AN)
ELECTRIC PUBLIC UTILITY SPECIFICALLY) Docket No. _____
IN A PORTION OF SECTION 13, TOWNSHIP 15)
SOUTH, RANGE 23 EAST, IN JOHNSON)
COUNTY KANSAS)

**APPLICATION FOR A CERTIFICATE OF PUBLIC CONVENIENCE AND
AUTHORITY TO TRANSACT THE BUSINESS OF AN ELECTRIC PUBLIC UTILITY**

COMES NOW Westar Energy, Inc. (Westar Energy), and in support of its Application
for a Certificate of Public Convenience and Authority, states:

Westar Energy is a Kansas corporation authorized by the Commission pursuant to K.S.A.
66-104 to conduct the business of a public utility, and as such holds a Certificate of Convenience
and Authority from this Commission to engage in the business of an electric public utility in the
State of Kansas, thereby promoting the public convenience.

1. Westar Energy seeks to serve, subject to the Commission's approval, in Kansas
City Power & Light Company (KCP&L) certified territory described below:

JOHNSON COUNTY, KANSAS

A tract of land described as Lots 229-236, 263, 264, 376-383, 415 and 416 in
Woodland Ridge Subdivision of Spring Hill located in the Northwest ¼ of
Section 13, Township 15 South, Range 23 East in Johnson County, Kansas, as
detailed on the map marked Exhibit A and attached hereto.

2. Westar Energy and KCP&L are working together to correct territory issues.

3. KCP&L has agreed to cease serving the tract of land described in Paragraph 1,
subject to the Commission's approval, to correct the existing territory discrepancies.

4. Westar Energy understands that KCP&L has filed, or will soon file, an application with the Commission to cease serving its electric service in the territory described in paragraph 1.

5. A copy of this application is being served on KCP&L by delivery of United States Mail, postage prepaid, addressed as follows:

Roger Steiner, Corporate Counsel
Kansas City Power & Light Company
One Kansas City Place
1200 Main Street – 16th Floor
Kansas City, Missouri 64105

There is no other person or entity, corporate, municipal or otherwise that requires notice of this Application.

THEREFORE, Westar Energy requests that an Order be issued, granting Westar Energy the authority to serve as an electric public utility in the territory described in paragraph 1 above.

WESTAR ENERGY, INC.

BY: Cathryn Dinges
Cathryn J. Dinges, S.Ct. #20848
818 S. Kansas Avenue
P. O. Box 889
Topeka, Kansas 66601-0889
Phone: (785) 575-8344
Fax: (785) 575-8136

ITS ATTORNEY

STATE OF KANSAS)
)
COUNTY OF SHAWNEE) ss

Cathryn J. Dinges, of lawful age, being first duly sworn upon oath, deposes and states:

That she is the attorney for the within named applicant, that she has read the above and foregoing application and that the statements therein contained are true according to her knowledge and belief.

Cathryn Dinges
Cathryn J. Dinges

Subscribed and sworn to before me this 19th day of January, 2015.

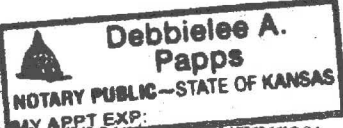
NOTARY PUBLIC—STATE OF KANSAS
MY APPT EXP:
My Appointment Expires:
June 26, 2017

Debbielee Papps
Notary Public

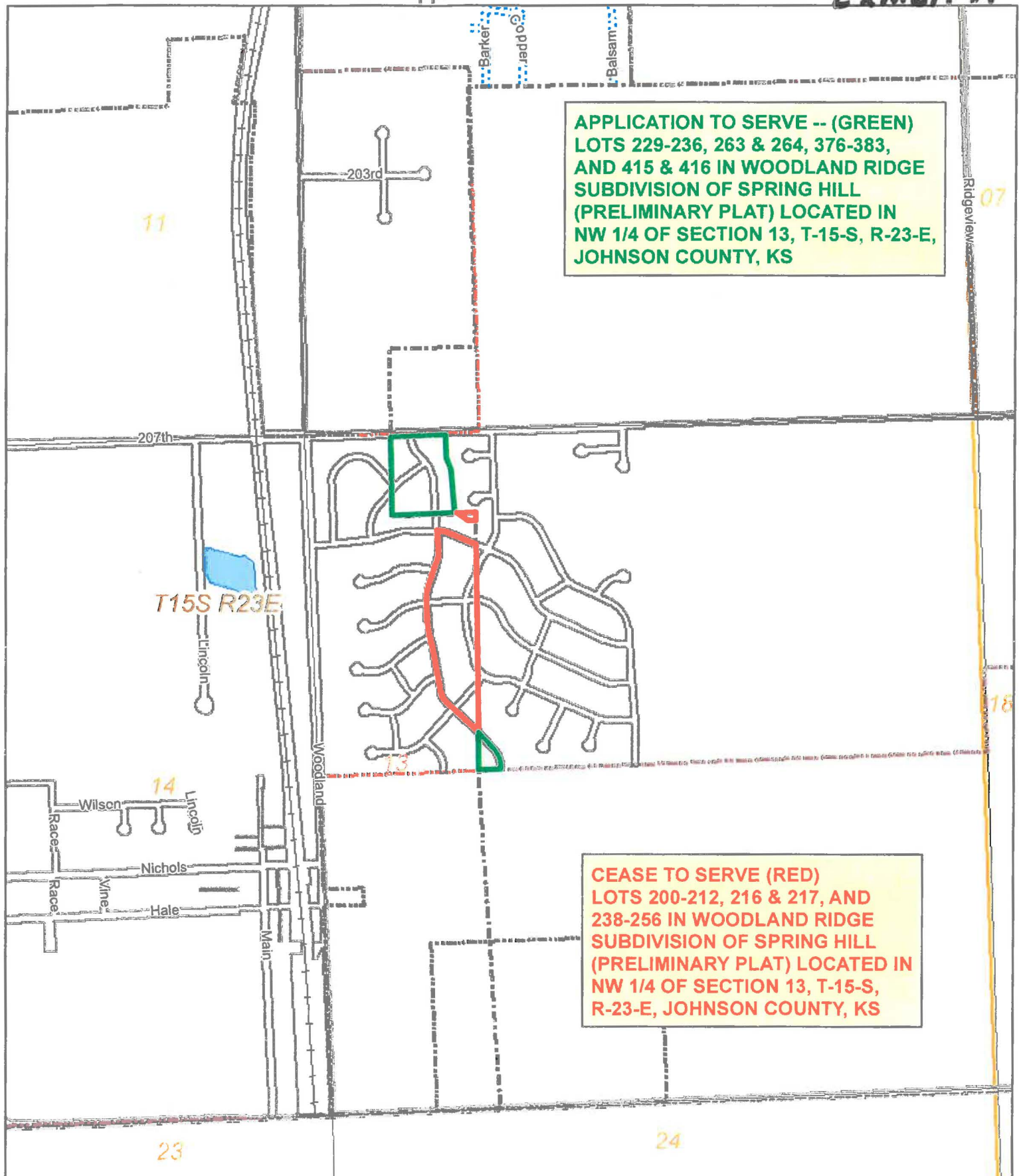

Title: Westar Energy -- Application to Serve & Cease to Serve

Name: Todd N.

WR # N/A

Crew HQ: Shawnee

Date 10/6/2014

Scale: 1" = 1000

Page 1

Proposed

Application Number Title