

LAW OFFICES
JAMES M. CAPLINGER, CHARTERED
823 W. 10th
TOPEKA, KANSAS 66612-1618

06-RRLT-1094-CCS
06-GRHT-1095-COC
(785) 232-0495
Fax (785) 232-0724

JAMES M. CAPLINGER
JAMES M. CAPLINGER, JR.
MARK E. CAPLINGER

June 30, 2006

Jerry Lammers
Kansas Corporation Commission
1500 SW Arrowhead Road
Topeka, Kansas 66604

Re: Luray & Paradise Exchanges

Dear Jerry:

Sorry we showed Schedule 2.1.(b) as "Proprietary and Confidential".

Enclosed is the Schedule of the Exchange descriptions and maps without the stamp.

The Luray map is hard to read but in the middle of the center dark area you will see the name. We have added the name at the top.

Sincerely,

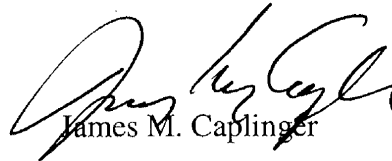

James M. Caplinger

JMC/dh

enclosures

cc: Thomas Gleason

RECEIVED

JUL 05 2006

OFFICE OF THE CLERK

Schedule 2.1.(b)

Exchanges

Luray

Beginning at a point 1/2 mile east of the southwest corner of Section 24, T9S, R12W, Osborne County, Kansas; thence south 5 1/2 miles; thence east 1 1/4 miles; thence south 1 1/4 miles; thence west 1 1/4 miles; thence south 3/4 mile; thence west 1/4 mile; thence south 1/2 mile to a point 1/4 mile east of the southwest corner of Section 36, T10S, R12W; thence west along Osborne-Russell County Line to a point 1/4 mile west of the northeast corner of Section 2, T11S, R12W, Russell County, Kansas; thence south 3 1/2 miles; thence west 1 1/4 miles; thence south 2 3/4 miles; thence west 2 1/4 miles; thence south 1 mile; thence west 3/4 mile; thence south 1 mile; thence west 1 3/4 miles to a point 1/4 mile south and 1/4 mile west of the northeast corner of Section 14, T12S, R13W, thence north 3 1/2 miles; thence west 3/4 mile; thence north 1/4 mile; thence west 1 mile; thence north 4 1/2 miles to the northwest corner of Section 3, T11S, R13W, Russell County, Kansas; thence east along Osborne-Russell County Line to a point 1/4 mile west of the southeast corner of Section 34, T10S, R13W, Osborne County, Kansas; thence north 2 miles; thence east 3/4 mile; thence north 3 3/4 miles; thence east 1 mile; thence north 3/4 mile; thence east 1 mile; thence north 1 mile; thence east 2 miles; thence north 1/2 mile; thence east 3 miles to the point of beginning.

Paradise

Beginning at a point 1/4 mile south and 1/4 mile east of the northwest corner of Section 11, T10S, R14W, Osborne County, Kansas; thence south 4 3/4 miles to a point 1/4 mile east of the southwest corner of Section 35, T10S, R14W; thence to a point 1/4 mile west of the northeast corner of Section 3, T11S, R14W, Russell County, Kansas; thence south 7 1/2 miles to a point 1/2 mile south and 1/4 mile west of the northeast corner of Section 10, T12S, R14W, Russell County, Kansas; thence west 5 3/4 miles; thence north 3/4 mile; thence west 3 1/2 miles; thence south 2 3/4 miles; thence west 4 1/4 miles to a point 1/4 mile east and 1/2 mile south of the northwest corner of Section 21, T12S, R16W, Ellis County, Kansas; thence north 2 1/4 miles; thence east 3 5/8 miles; thence north 3 1/4 miles; thence east 5/8 mile to a point 1/2 mile west of the southeast corner of Section 19, T11S, R15W, Russell County, Kansas; thence north 3 1/2 miles; thence east 2 miles; thence north 1/2 mile to a point 1/2 mile east of the northwest corner of Section 4, T11S, R15W, Russell County, Kansas; thence east along Russell-Osborne County Line to a point 1/8 mile east of the southwest corner of Section 34, T10S, R15W, Osborne County, Kansas; thence north 2 1/8 miles to a point 1/8 mile north and 1/8 mile east of the southwest corner of Section 22, T10S, R15W; thence east 2 5/8 miles; thence north 2 5/8 miles; thence east 4 1/2 miles to the point of beginning.

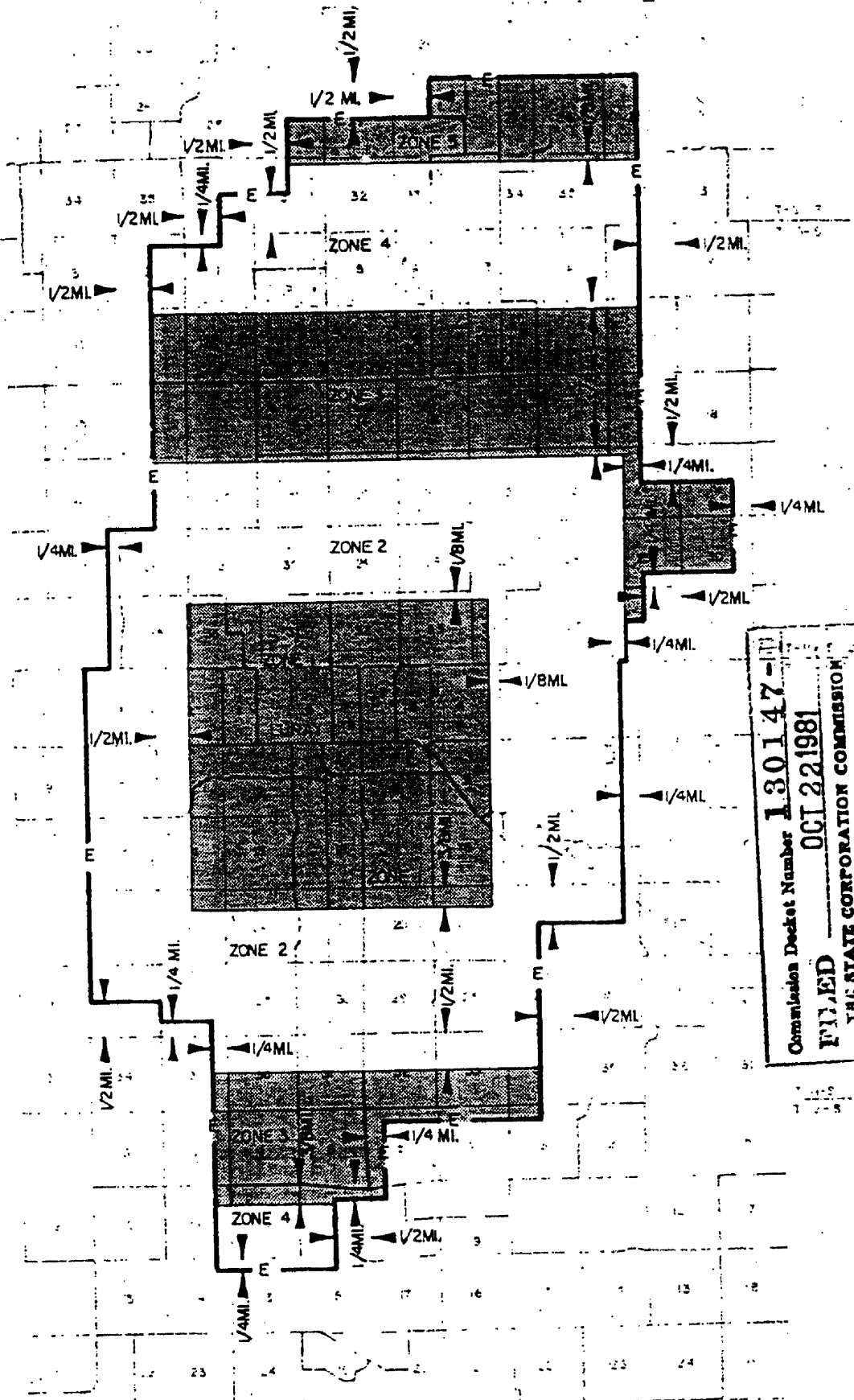

Commission Decket Number **130147-111**
FILED OCT 22 1981
 KANSAS STATE CORPORATION COMMISSION
 OF KANSAS
Carol J. Waters Secretary

DATE: Sept. 21, 1981
 DRAWN BY: *AMW*

DATE EFFECTIVE: **OCT 22 1981**
 CERTIFICATE NO:

SCHEDULE 1st Revised Paradise, Kansas
 Replacing Schedule Exchange Sheet Area Map
 which was filed July 31, 1962

EXCHANGE ZONE MAP

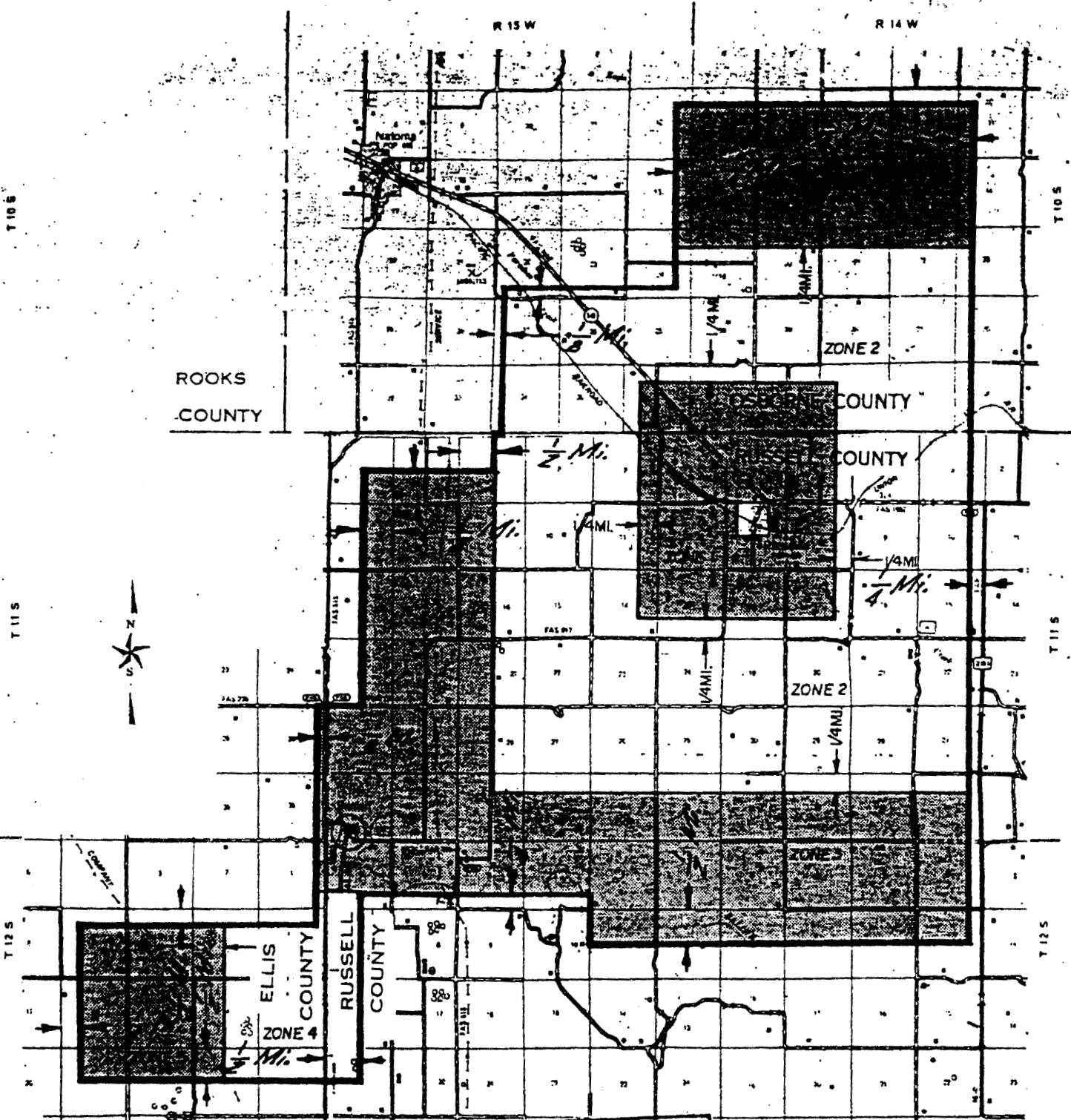

Commission File Number **811105**
APR 16 1981
 THE STATE CORPORATION COMMISSION
 OF KANSAS
 By *Carol J. Hanson* Secretary

Date of Issue April 16, 1981 & FILED
 Issued By *nmbrans*
 Date Effective
 Docket No.