

BEFORE THE STATE CORPORATION COMMISSION OF THE STATE OF KANSAS

IN THE MATTER OF THE APPLICATION OF

4 Rivers Electric Cooperative, Inc.

for a CERTIFICATE of CONVENIENCE and AUTHORITY to transact the

business of a(n) Electric

(Tel., Gas, Elec, etc.)

Public Utility

(Common carrier or public utility)

in the State of Kansas.

parcel# 087-36-0-00-00-014.000, City of Garnett

Docket No.

26-4REE-123-COC

APPLICATION FOR CERTIFICATE

Comes on 4 Rivers Electric Cooperative, Inc.

of 2731 Milo Terrace, Lebo, _____, Kansas, and presents and shows to the Commission:

That Applicant is a(n) Corporation

(Corporation, Partnership or Individual)

and as such intends to engage in the business of a(n) Electric

(Tel., Gas, Elec., etc.)

Corporation

(Corporation, Partnership or Individual)

in the State of Kansas, thereby promoting the public convenience in the following described territory in said state, to wit:
(describe by metes and bounds and attach map as part of this application).

4 Rivers Electric Cooperative, Inc. requests permission to serve the landowner of the above mentioned parcel from an existing utility line adjacent to the property. We have been asked by the City of Garnett and the land owner, to serve electric power to the following described area.

The area measures 250 Feet in width, being 125 Feet on each side of the following described line. Commencing at S41°31'58.227"W a distance of 170 Feet, more or less, to the POINT OF BEGINNING from EXISTING ELECTRIC POLE at approximately 38°16'11.980"N, 95°15'12.322"W, thence N88°43'6.314"E a distance of 1205 Feet, more or less, thus to the end point.

The above described is for Certificate of Convenience and Authority extending over an area approximately 250ft x 1205ft, more or less.

That other utilities of the same classification as this Applicant now operating in or adjoining the above-described territory are:

NAME _____

ADDRESS

City of Garnett 131 West 5th Ave. Garnett, KS 66032

That the above-described territory is now being served by City Of Garnett
which said utility has filed its application requesting permission from the Commission to cease operating in said territory.

That Applicant further states:

WHEREFORE; Applicant requests that a Certificate of Convenience and Authority be issued granting the right to
transact the business of a (n) Electric Public Utility
(Tel., Gas, Elec., etc.) (Common carrier or public utility)
in the above-described territory.



Applicant

By Dennis Sranos, General Manager/CEO

STATE OF KANSAS

Coffey)
COUNTY,) ss.

Dennis Sranos, of lawful age, being duly sworn deposes and
says that he is the General Manager/CEO of the above-named, that he has read the above and
foregoing application and knows the contents thereof, and that the matters and information therein stated are true.

SUBSCRIBED AND SWORN TO before me this 11 day of September 2025

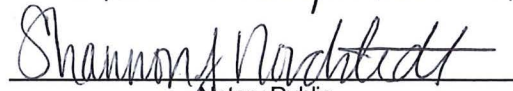
Notary Public

My commission expires: 12.13.2028

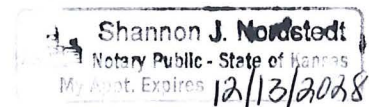

TROYER TERRITORY EXCHANGE

WO#:
TROYER
TERRITORY

CITY OF GARNETT

T20S, R19E, Anderson County, Section 36:

Bearing and distances are approximated based
on GPS data gathered and projected into
NAD_1983_StatePlane_Kansas_South_FIPS_1502_Feet

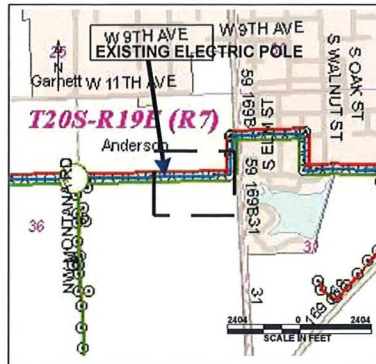

An area 250 Feet in width,
being 125 Feet on each side of the
following described line. Commencing
at S41°31'58.227"W a distance of
170 Feet, more or less, to the POINT
OF BEGINNING from EXISTING
ELECTRIC POLE at approximately
38°16'11.980"N, 95°15'12.322"W, thence
N88°43'6.314"E a distance of 1205 Feet,
more or less, thus to the end point.

The above described is for
Certificate of Convenience and Authority
extending over an area approximately
250ft x 1205ft, more or less.

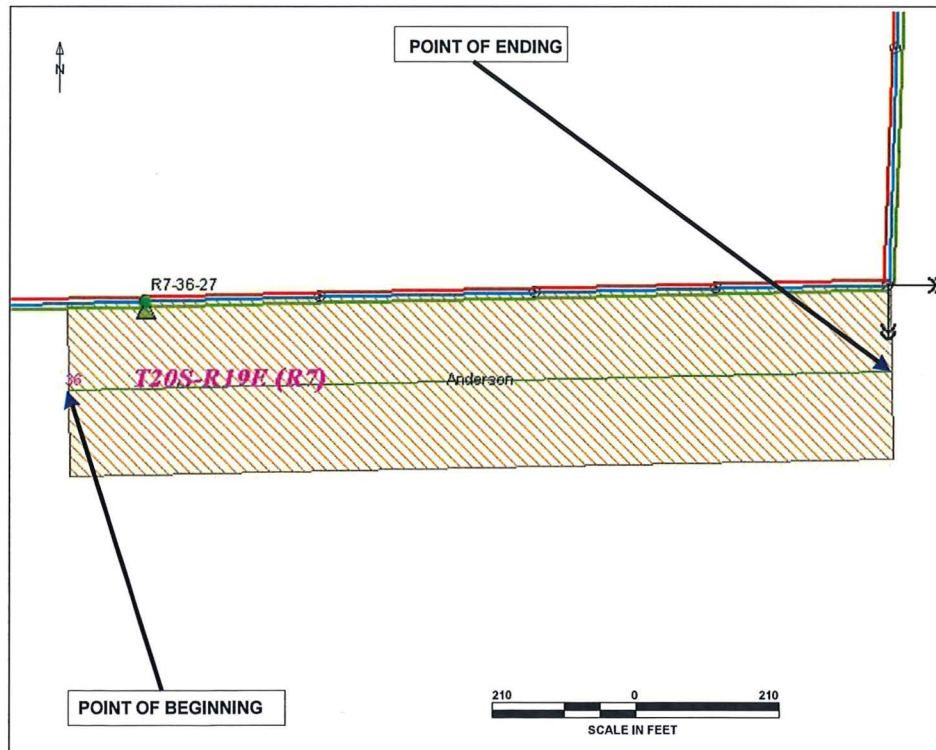

TROYER TERRITORY EXCHANGE

WO#:
TROYER
TERRITORY

CITY OF GARNETT

T20S, R19E, Anderson County, Section 36:

Bearing and distances are approximated based
on GPS data gathered and projected into
NAD_1983_StatePlane_Kansas_South_FIPS_1502_Feet



An area 250 Feet in width,
being 125 Feet on each side of the
following described line. Commencing
at S41°31'58.227"W a distance of
170 Feet, more or less, to the POINT
OF BEGINNING from EXISTING
ELECTRIC POLE at approximately
38°16'11.980"N, 95°15'12.322"W, thence
N88°43'6.314"E a distance of 1205 Feet,
more or less, thus to the end point.

The above described is for
Certificate of Convenience and Authority
extending over an area approximately
250ft x 1205ft, more or less.

