

FORM CC

[illegible]

County of Pottawatomie

APPLICATION FOR CERTIFICATE

1000 South Wind Dr., Wamego, KS 66547

That the above-described territory is now being served by Bluestem Electric Cooperative, Inc.
which said utility has filed its application requesting permission from the Commission to cease operating in said territory.

That Applicant further states:

WHEREFORE; Applicant requests that a Certificate of Convenience and Authority be issued granting the right to
transact the business of a (n) Electric public utility
(Tel., Gas, Elec., etc.) (Common carrier or public utility)
in the above-described territory.

[Signature] Applicant City of Wamego

By Stacie Eichen
City Manager
City of Wamego

STATE OF KANSAS)
Pottawatomie COUNTY,) ss.

Stacie Eichen, of lawful age, being duly sworn deposes and
^{she} says that ~~he~~ is the City Manager ^{she} of the above-named, that ~~he~~ has read the above and
foregoing application and knows the contents thereof, and that the matters and information therein stated are true.

SUBSCRIBED AND SWORN TO before me this 22nd day of April, 2020

[Signature]
Notary Public

My commission expires: 6/11/2023

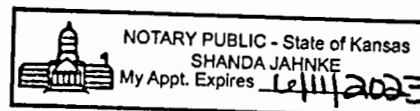

Pottawatomie Co KS

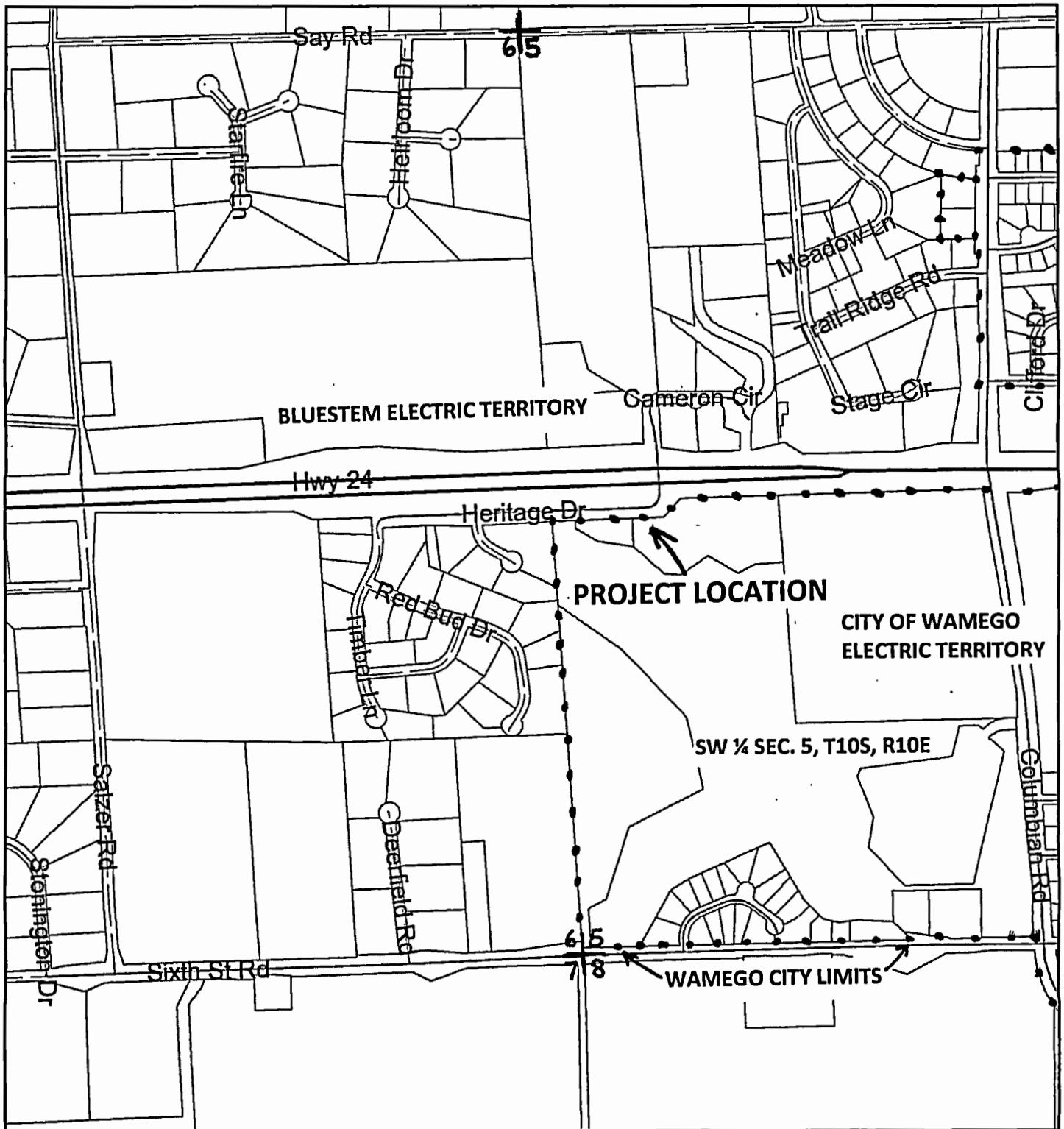

April 20, 2020

1:9,551

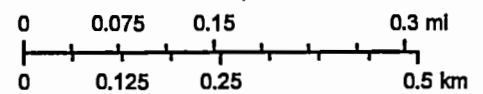

- | | |
|-----------------|------------------------------|
| — Road Closures | — Dirt Rd |
| — Divided Hwy | — Private Dr |
| — State Hwy | — Lake Rd |
| — Paved Rd | — Future Rd |
| — Gravel Rd | · · · Parcel Detail Boundary |

**BLUESTEM ELECTRIC
SERVICE TERRITORY**

**TO CONNECT WITH
EXIST.CITY SYSTEM**

PROPERTY LINE = CITY LIMITS LINE =
SERVICE TERRITORY BOUNDARY
N 42°10'04" E 143.44'

UCT. BOX

JCT. BOX

**PROPOSED 3-PHASE
UNDERGROUND ELECT.**

110-
LOT 1
0.892 acres

CITY OF WAMEGO
SERVICE TERRITORY

**DRAINAGE
EASEMENT**

UTILITY EASEMENT

NORTH
SCALE: 1" = 60'

**NW ¼ OF SW ¼ OF SECTION 5, TOWNSHIP 10 SOUTH,
RANGE 10 EAST OF THE 6TH P.M.**

April 23, 2020

Jeff McClanahan
Director- Utilities Division
Kansas Corporation Commission
1500 SW Arrowhead Rd.
Topeka, KS 66604-4027

Dear Jeff:

Attached is our application to extend a City of Wamego underground three phase distribution line into the electric service territory of Bluestem Electric Cooperative, Inc. We are serving a new veterinary clinic under construction on Lot 1 (see enclosed map), which is within the City and our service territory, however due to some difficult terrain and the need to remove trees which our customer would like to retain, it will be much less involved to locate our lines in the right-of-way of Heritage Drive, rather than utilizing an easement on the private side of the right-of-way line. This line is the Wamego city limits line, to the north of which lies the Bluestem territory.

It should be noted that the extension to a junction box at the west edge of Lot 1 is not to serve this customer, but rather to accommodate any future service requirements on land to the west, should it be annexed into the City and added to our service territory.

The City has already contacted Bluestem and they have given their approval to this proposal, which is for transmission rights only, and does not include service to any current Bluestem territory. Consequently, it is our understanding that Bluestem will not need to file a cease operation application. Please contact me at the above number if you have any questions or concerns.

Thank you for your consideration of this application.

Sincerely,



Ken Stein
Wamego Admin./Planning Assistant

Enclosure