

KANSAS CORPORATION COMMISSION
OIL & GAS CONSERVATION DIVISION
APPLICATION FOR INJECTION WELL

20220404152822
Filed Date: 4/04/2022
State Corporation Commission
of Kansas
August 2020
Form must be Typed
Form must be Signed
All blanks must be Filled

Disposal ☒

Enhanced Recovery: ☐ Repressuring

☐ Waterflood

☐ Tertiary

Date: 02/12/2022

Operator License Number: 30169 Exp 07/30/22

Operator: Double "D" Oil Company, Inc.

Address: 2009 Jean Ct

Winfield KS 67156

Contact Person: Donald L. Butler

Phone: 620-221-3570

Email: abutler12@cox.net

Permit Number: D-34,189
API Number: 15-035-24718-00-00

Well Location

SE - SW - NE - NW Sec. 21 Twp. 32 S. R. 5 ☒ E ☐ W

4272 feet from ☒ S / ☐ N Line of Section

3489 feet from ☒ E / ☐ W Line of Section

GPS Location: Lat: (e.g. XX.XXXXX), Long: (e.g. -XXX.XXXXX)

Datum: ☐ NAD27 ☐ NAD83 ☐ WGS84

Lease Description: E/2 NW/4

Lease Name: Byers Well Number: SWD #1

Field Name: Frog Hollow

County: Cowley

Deepest Usable Water

Formation:

Depth to Bottom of Formation: 100

Check One: ☐ Old Well Being Converted ☒ Newly Drilled Well ☐ Well to be Drilled

Surface Elevation: 1334 feet Well Total Depth: 2115 feet Plug Back Depth: feet

Datum of top of injection formation: -636 feet (reference mean sea level)

Injection Formation Description:

Name	top / bottom	perf / open hole	depth
Stalnaker	1970 / 2115	Open hole	at 1963 to 2115 feet

List of Wells/Facilities Supplying Produced Saltwater or Other Fluids Approved by the Conservation Division:
(attach additional sheets if necessary)

Lease Operator	Lease/Facility Name	Lease/Facility Description	Well ID & Spot Location
1. Double "D" Oil Co	Byers #2		Byers 2 NE SE NW
2. Double "D" Oil Co	Moon B #3		Moon B #3 SE NW NW
3.			

Producing Formation	Strata Depth	Total Dissolved Solids (if available)
1. Bartlesville	3044 to 3062 feet	mg/l
2. Bartlesville	3054 to 3133 feet	mg/l
3.	to feet	mg/l

Maximum Requested Liquid Injection Rate: 700 bbls / day; or

Maximum Requested Gas Injection Rate: scf / day. Type of Gas:

Maximum Requested Injection Pressure: 0 psig

Paid \$200.00
CK 42338
2/21/22

2/21/22 Revd-UK, PM/BL/em
Mail to: KCC - Conservation Division, 266 N Main St, Ste 220, Wichita, Kansas 67202-1513

Well CompletionType: ☒ Tubing & Packer ☐ Packerless ☐ Tubingless

	Conductor	Surface	Intermediate	Production	Tubing
Size	0	7.0	0	4.5	2.375
Setting Depth	0	360	0	1963	1942
Amount of Cement	0	90	0	305	
Top of Cement	0	0	0	0	
Bottom of Cement	0	360	0	1970	

If Alternate II cementing, complete the following:

Perforations / D.V. Tool at _____ feet, cemented to _____ feet with _____ sx.

Tubing: Type _____ Grade _____

Packer: Type _____ Depth _____

Annulus Corrosion Inhibitor: Type _____ Concentration _____

List Logs Enclosed: _____

Well Sketch

(To sketch installation, darken the appropriate lines, indicate cement, and show depths.)

Received
KANSAS CORPORATION COMMISSION

FEB 18 2022

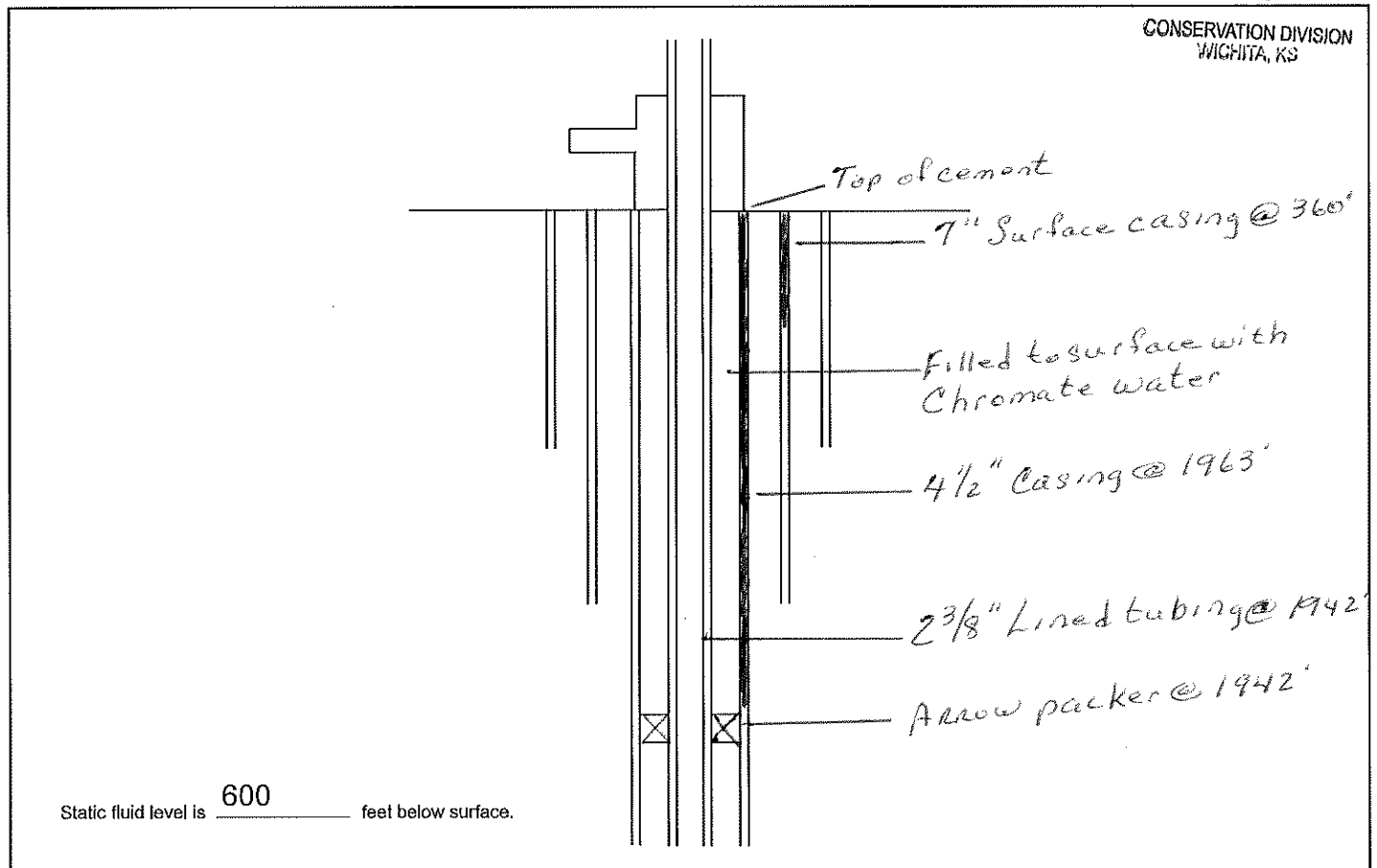
CONSERVATION DIVISION
WICHITA, KS

Offset Operators, Unleased Mineral Owners and Landowners acreage

(Attach additional sheets if necessary)

Name:

Legal Description of Leasehold:

Schedule attached

Received
KANSAS CORPORATION COMMISSION
FEB 18 2022
CONSERVATION DIVISION
WICHITA, KS

Instructions:

1. Fully complete application, including page 4 (plat map) showing subject well and all known oil, gas and input wells, including wells being drilled, inactive wells, or dry holes, within one-half mile. Show lease names and operators or unleased mineral rights owners of all lands within one-half mile. Show well numbers and elevations of producing formation tops.
2. Attach some type of log (*drillers log, electric log, etc.*).
3. Attach some type of verification of cementing for surface casing, longstring, D.V. tool, perforations, etc. (*Cement ticket and job log, bond log, etc.*).
4. Fill in schematic drawing of subsurface facilities including: size, setting depth, amount of cement, measured or calculated tops of cement for each of surface, intermediate (*if any*) and production casing; size and setting depth of tubing and packer; geological zone of injection showing top and bottom of injection interval.
5. The original and one copy of the application and all attachments shall be mailed to the Conservation Division.
6. Deliver or mail one (*1*) copy of the application to the landowner on whose land the injection well is located and to each operator or lessee of record and each unleased mineral rights owner within one-half mile of the applicant well before or when you file this application.
7. Approval of this application, if granted, is valid only as long as there are no substantial changes in operation set forth in the application. A substantial change requires the approval of a new application. **No injection well may be used without prior written authorization.**
8. All application fees must accompany the application.
9. After confirming the Conservation Division's receipt of this application, publish notice of the application in the official county newspaper of record where the well(s) is located. Mail a copy of the affidavit to the Conservation Division upon receipt from the newspaper.

DOUBLE "D" OIL COMPANY
BYERS #1 SWD DISPOSAL APPLICATION
SCHEDULE OF ADJOINING LANDOWNERS/OPERATORS

<u>PARCEL #</u>	<u>LANDOWNER</u>	<u>ADDRESS</u>
1	Jerald D Cales and Jimalene K Cales	15438 152 nd Rd Winfield KS 67156
2 & 7	James M Cales	15816 152 nd Rd Winfield KS 67156
3 & 4	Jeremy Todd Andes, Vegas Roulette Andes and Reno Remington Andes	17603 131st Rd Winfield KS 67156
3	Val Energy Inc – Operator	125 N Market Ste #1110 Wichita KS 67202
5	Rick L Eastman	15229 151 st Rd Winfield KS 67156
6	Hilma I Weber Trust	14044 141 st Rd Winfield KS 67156
8	Kevin L & Carol D Coon	P O Box 24 Winfield KS 67156
9 & 11	James W Scott	14769 152 nd Rd Winfield KS 67156
10	Holdorf Family Trust	1100 Huntington Dr Fayetteville AR 72701
10	Steven R Scott – 1/3 Int	2575 Gault Rd Malaga WA 98828
10	Susan J Scott – 1/3 Int	P O Box 305 Exeter NH 03833
12	Roger Moon and Allyson Moon	1606 Fowler Winfield KS 67156
13	Garth Moon and Amy Moon	16512 141 st Rd Winfield KS 67156
14	Marilyn J Buffum	8 Fleetwood Dr Winfield KS 67156
15	Daryl B & Marcia A Thiel	12591 131 st Rd Winfield KS 67156
16	Donnie Andes and Janice Andes	17878 192 nd Rd Winfield KS 67156
17	Jack and Elissa Additon	15417 152 nd Rd Winfield KS 67156
18	George H Moon	218 W Excelsior St Excelsior Springs MO 64024
19	Donald L and Laura A Butler	2112 Simpson Winfield KS 67156

Received
KANSAS CORPORATION COMMISSION

FEB 18 2022

CONSERVATION DIVISION
WICHITA, KS

GIS Web Map

Map produced via
Cowley County GIS Web App Builder

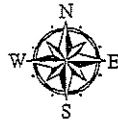

Cowley County GIS
311 E 9TH AVE
Winfield, KS 67156
620-221-5405
www.cowleycounty.org



COWLEY COUNTY
misgis

Map Produced on: 2/14/2022

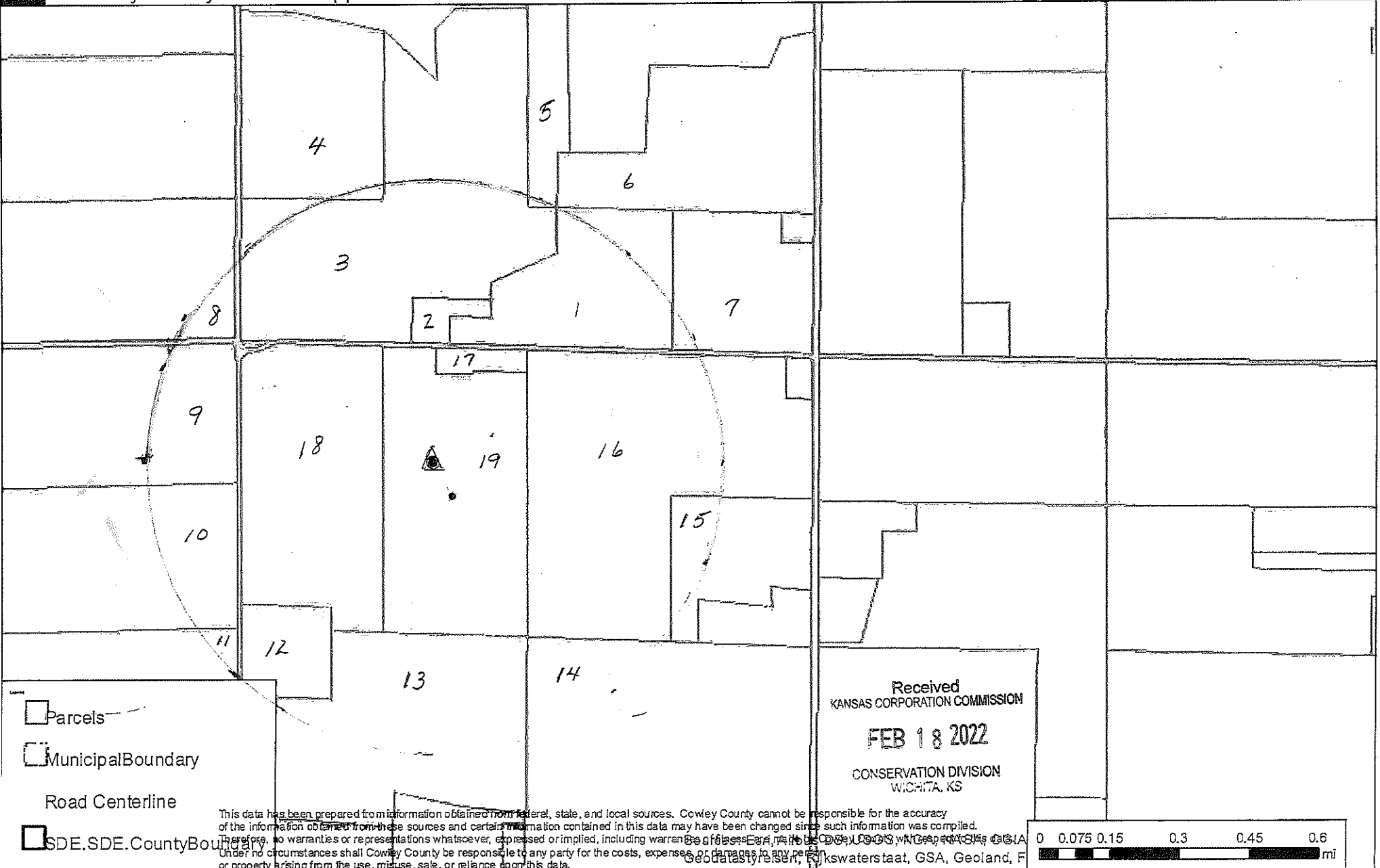

Plat and Certificate of Injection Well Location and Surrounding Acreages

Operator: Double "D" Oil Co., Inc. Location of Well: SE SW NE NW
 Lease: Byers 4272 feet from ☒ S / ☐ N Line of Section
 Well Number: 1 SWD 3489 feet from ☒ E / ☐ W Line of Section
 County: Cowley Sec. 21 Twp. 32 S. R. 5 ☒ East ☐ West

Plat

Show the following information: applicant injection well, all producing wells, inactive wells, plugged wells, and other wells within a one-half mile radius, all lease boundaries, lease operators, unleased mineral rights owners, well numbers, and producing wells producing formation tops.

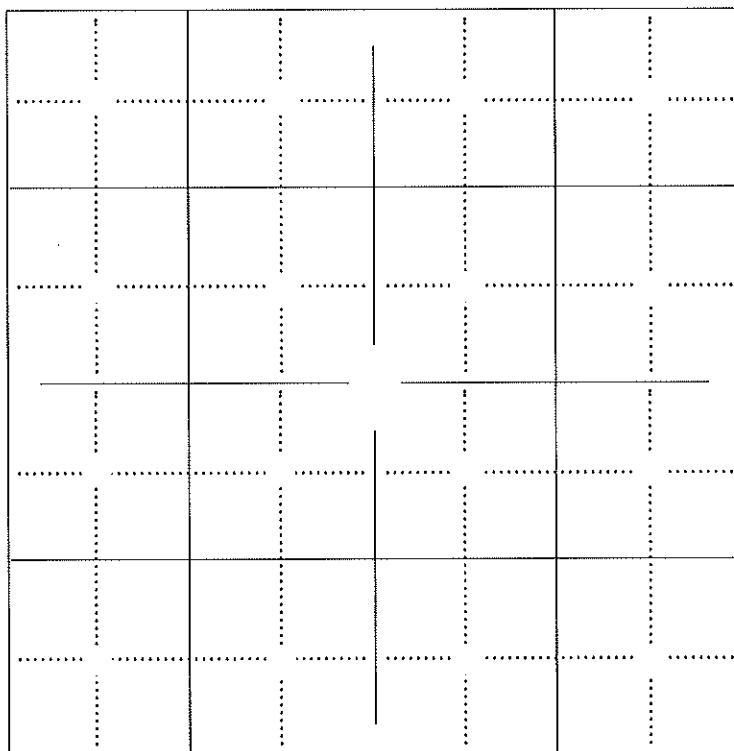

applicant well

producing well

plugged injection well

D & A well

other injection well

temporary abandoned well

plugged producer

water supply well

Received
KANSAS CORPORATION COMMISSION

FEB 18 2022

CONSERVATION DIVISION
WICHITA, KS

Byers SWD

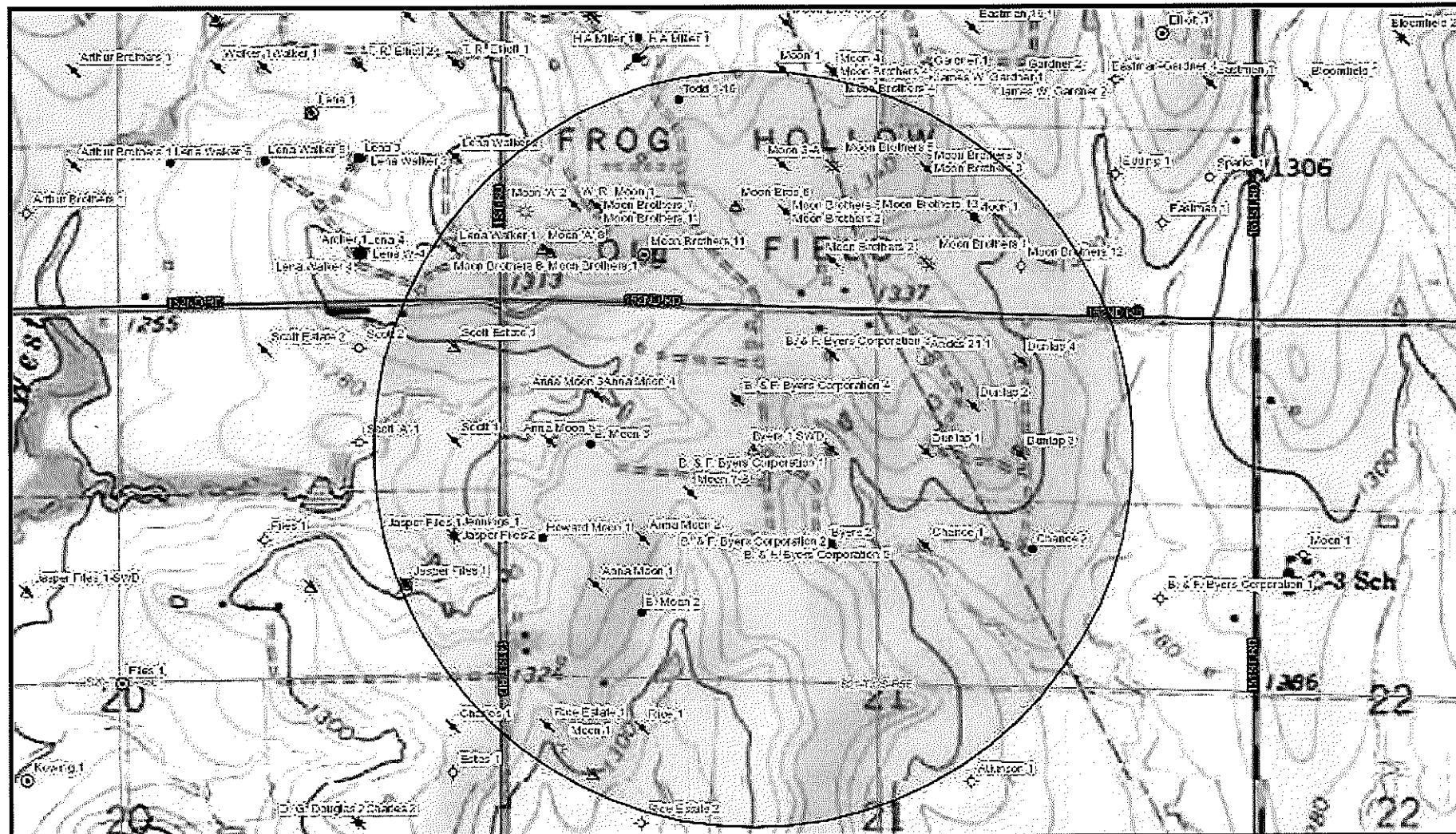

Oil and Gas Wells

- | | | | | |
|---------------------------------------|--|--------------------------------|----------------------------------|--|
| ● Coal Bed Methane | ✕ Enhanced Oil Recovery, Plugged-Abandoned | ✕ Injection, Plugged-Abandoned | ✕ Oil and Gas, Plugged-Abandoned | ✕ Other, Plugged-Abandoned |
| ● Coal Bed Methane, Plugged-Abandoned | ✕ Gas | ○ Intent | ● Oil | ▲ Salt Water Disposal |
| ✕ Dry and Abandoned | ✕ Gas, Plugged-Abandoned | ○ Location | ✕ Oil, Plugged-Abandoned | ▲ Salt Water Disposal, Plugged-Abandoned |
| ✕ Enhanced Oil Recovery | ✕ Injection | ✕ Oil and Gas | ○ Other | |

2/14/2022

Received
KANSAS CORPORATION COMMISSION

<https://maps.kgs.ku.edu/oilgas>

FEB 18 2022

CONSERVATION DIVISION
WICHITA, KS

Affidavit of Notice Served

Re: Application for: Double "D" Oil Co., Inc.
 Well Name: Byers #1 SWD Legal Location: SE SW NE NW of Sec 21-32S-5E

Note: A copy of this affidavit must be served as a part of the application.

Name:

Address: (Attach additional sheets if necessary)

Schedule attached

Received
KANSAS CORPORATION COMMISSION

FEB 18 2022

CONSERVATION DIVISION
WICHITA, KS

I certify that the statements and information contained in this application are true and correct to the best of my knowledge, and that a true and correct copy of this application was delivered or mailed to all required persons, and that such persons are identified on Page 5 of this application.

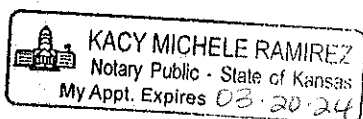

[Signature]
Applicant or Duly Authorized Agent

Subscribed and sworn before me on: 2/17/22

Kacy Ramirez
Notary Public

My Commission Expires: 03/20/24

Protests may be filed by any party having a valid interest in the application. Petitions for protests shall be in writing and shall clearly identify the name and address of the protester and the title of the application. The petition shall include a clear and concise statement of the direct and substantial interest of the protester in the proceeding, including specific allegations as to the manner in which the grant of the application will cause waste, violate correlative rights, or pollute the water resources of the state of Kansas. Protesters shall serve the protest upon the applicant by mail or personal service at the same time or before the protester files the protest with the Conservation Division. Protests must be filed within 30 days of the publication notice of the application.

Mail to: KCC - Conservation Division, 266 N Main St, Ste 220, Wichita, Kansas 67202-1513

NOTICE OF FILING APPLICATION

RE: Double "D" Oil Company, Inc. – Application for a permit to authorize the disposal of salt water in the Byers #1 SWD located in Cowley County, Kansas.

TO: All Oil and Gas Producers, Unleased Mineral Interest Owners, Landowners and all persons whomever concerned.

You, and each of you, are hereby notified that Double "D" Oil Company, Inc. has filed an application to commence the disposal of saltwater into the Stalnaker formation at the Byers #1 SWD well located in the E/2 NW of Section 21-32S-5E, Cowley County, Kansas, with a maximum operating pressure of 0 psi and a maximum injection rate of 700 bbls per day.

Any persons who object to or protest this application shall be required to file their objections of protest with the Conservation Division of the State Corporation Commission of the State of Kansas within 30 days from the date of this publication. These protests shall be filed pursuant to Commission regulations and must state specific reasons why granting the application may cause waste, violate correlative rights or pollute the natural resources of the State of Kansas.

All persons interested or concerned shall take notice of the foregoing and shall govern themselves accordingly.

Double "D" Oil Company, Inc.
2009 Jean Ct
Winfield KS 67156
620-221-3570

Received
KANSAS CORPORATION COMMISSION

FEB 18 2022

CONSERVATION DIVISION
WICHITA, KS

2/21/22 Rcvd - UIC, PM/AL/CM