

Received
KANSAS CORPORATION COMMISSION

MAR 25 2024
CONSERVATION DIVISION

**BEFORE THE STATE CORPORATION COMMISSION
OF THE STATE OF KANSAS**

In the matter of the Application of Edison Operating Company, LLC for an exception to the 10-year time limitation of K.A.R. 82-3-111 for its Glasscock LKC Unit #2-1 well located in the Northeast Quarter of the Northeast Quarter of the Southwest Quarter of Section 32, Township 24 South, Range 13 West Stafford County, Kansas.)	Docket No. 24-CONS-3263-CEXC
)	
)	Conservation Division
)	
)	License No.: 34434

APPLICATION

COMES NOW Edison Operating Company, LLC (“Applicant”) in support of its Application in the captioned matter and states as follows:

1. Applicant is a Limited Liability Company authorized to do business in the State of Kansas. Applicant’s address is 8100 E. 22nd N. Building 1900, Wichita, Kansas 67226.

2. Applicant has been issued by the Kansas Corporation Commission Operator’s License number 34434, which expires on August 3rd, 2024.

3. Applicant is the owner and operator of the Glasscock #2-1 well (originally known as the Belote #1), API # 15-185-00298-0001 (“the subject well”), which is located in the Northeast Quarter of the Northeast Quarter of the Southwest Quarter of Section 32, Township 24 South, Range 13 West, Stafford County, Kansas. The subject well is located on an active oil lease comprising the following lands:

- South Half of the Northwest Quarter (S/2 NW/4) in Section 32, Township 24 South, Range 13 West
- Northwest Quarter of the Southwest Quarter (NW/4 SW/4) in Section 32, Township 24 South, Range 13 West
- South Half of the Southwest Quarter (S/2 SW/4) in Section 32, Township 24 South, Range 13 West
- Northeast Quarter of the Southwest Quarter (NE/4 SW/4) in Section 32, Township 24 South, Range 13 West
- Southeast Quarter (SE/4) in Section 32, Township 24 South, Range 13 West
- Northeast Quarter (NE/4) in Section 05, Township 25 South, Range 13 West
- East Half of the Northwest Quarter (E/2 NW/4) in Section 05, Township 25 South, Range 13 West

4. Pursuant to K.A.R. 82-3-111, the well was shut in, or Applicant obtained temporary abandonment status, for the subject well on June 1, 2007. The subject well has maintained such status from June 1, 2007 to the present date.

5. On or about March 1, 2018, the Kansas Corporation Commission notified Applicant that temporary abandonment status for the subject well would be denied because the subject well had been temporarily abandoned for more than ten (10) years. Applicant filed for and received approval for an exception to K.A.R. 82-2-111 on April 4, 2018.

6. On or about March 1, 2024, the Kansas Corporation Commission notified Applicant that the 3-year exception to K.A.R. 82-3-111 was expiring. K.A.R. 82-3-111 provides for an additional exception to be obtained through an application filed with the Commission. Applicant seeks such an exception.

7. On February 27, 2024, the subject well passed a mechanical integrity test of the casing between the surface and a point within 14 feet above the uppermost perforation in the well. Said test was witnessed by Ken Scofield with the Kansas Corporation Commission, District #1.

8. Applicant wishes to continue temporary abandonment status for the subject well because Edison Operating Company, LLC intends to re-establish production from the existing perforation in the Lansing-Kansas City. Applicant has recently improved disposal capacity for this lease, and believes the Glasscock #2-1 can return to commercial production.

9. Applicant submits the following information regarding the well in support of the Application.

See Exhibit A

10. Applicant has included a plat map showing the locations of all producing, injection, temporarily abandoned, abandoned, and plugged wells located on the same leased premises as the subject well. See enclosed.

11. Based on the foregoing, Applicant requests the Commission grant an additional exception to the 10-year limitation, specifically to allow the subject well to remain eligible for temporary abandonment status for three (3) years following the expiration of the 10-year limitation.

Applicant understands that the exception would be valid for three (3) years, but Applicant would still need to apply annually to the Conservation Division District Office for approval of an application for temporary abandonment status.

12. Listed in the attached Exhibit "B" are the names and addresses of the following persons:

A. Each operator of each oil and gas lease covering lands within one-half (1/2) mile radius of the subject well; and

B. Each person who owns any mineral interest of record in and under any lands located within one-half (1/2) mile radius of subject well (provided that such mineral interest is not covered by any oil and gas lease).

13. Notice of this Application will be published pursuant to K.A.R. 82-3-135a. In addition, notice of the hearing to be held in this matter will be provided as prescribed by K.A.R. 82-3-135.

WHEREFORE, Applicant prays that this matter be granted administratively without a hearing, or in the alternative be set for hearing, and upon hearing that the Commission grant Applicant's request, for an exception to the K.A.R. 82-3-111 ten (10) year limitation, to allow the subject well to remain temporarily abandoned for three (3) years, subject to annual approval by the Conservation Division District Office of an application for temporary abandonment status.

Respectfully Submitted,

Edison Operating Company, LLC
8100 E. 22nd N. Bldg 1900
316.201.1744 (phone)
316.201.1687 (fax)

By 
Brian J. McCoy

CERTIFICATE OF SERVICE

I hereby certify on this 25 day of MARCH, 2024, true and correct copies of the above and foregoing Application and the Notice of Application were served by depositing copies of the same in the United States Mail, postage prepaid, and properly addressed to the landowner/s set forth in paragraph 12 of said Application and each party set forth in Exhibit "B" attached to said Application filed by Applicant, and the original and seven (7) copies were hand delivered to the Kansas Corporation Commission.

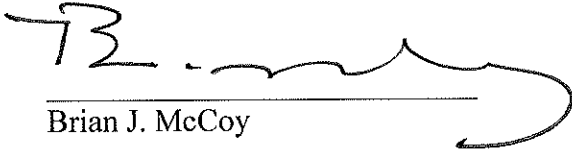

Brian J. McCoy

KANSAS CORPORATION COMMISSION
OIL & GAS CONSERVATION DIVISION
CASING MECHANICAL INTEGRITY TEST

Disposal: Enhanced Recovery: KCC District No.: 1
Operator License No.: 34434 Name: Edison Operating Company LLC
Address 1: 8100 E. 22ND ST. N., BLDG 1900
Address 2: _____
City: WICHITA State: KS Zip: 67226 + 2319
Contact Person: David Withrow Phone: (316) 201-1744

API No.: 15-185-00298-00-01 Permit No.: E14551.2
NE NE SW Sec. 32 Twp. 24 S. R. 13 East West
2311 Feet from North / South Line of Section
3054 Feet from East / West Line of Section
Lease: GLASSCOCK Well No.: 2-1
County: Stafford

Well Construction Details: New well Existing well with changes to construction Existing well with no changes to construction
Maximum Authorized Injection Pressure: 1000 psi Maximum Injection Rate: 1000 bbl/d
Size:

Conductor	Surface	Intermediate	Production	Liner	Tubing
NA	8.625	NA	4.5	NA	2.375
Set at:	<u>253</u>		<u>3942</u>		<u>3828</u>
Sacks of Cement:	<u>250</u>		<u>175</u>		<u>DUOLINE</u>
Cement Top:	<u>0</u>		<u>3315</u>		
Cement Bottom:	<u>253</u>		<u>3942</u>		

Packer Type: AD-1 Set at: 3828
 DV Tool Port Collar Depth of: _____ feet with _____ sacks of cement TD (and plug back): 4285 (3910) feet depth
Zone of Injection Formation: LANSING-KANSAS CITY Top Feet: 3842 Bottom Feet: 3885 Perf. or Open Hole: Perf
Is there a Chemical Sealant or a Mechanical Casing patch in the annular space? Yes No
If Dual Completion - Injection is: Above Production Below Production

FIELD DATA

GPS Location: Datum: NAD27 NAD83 WGS84 Lat: 37.91885 Long: -98.77621 Date Acquired: 02/24/2021
MIT Type: Tubing and Packer (or Initial Pressure) Test MIT Reason: 3-YEAR TEST
Time in Minute(s):

	0	15	30
Pressures: Set up 1	<u>350</u>	<u>350</u>	<u>350</u>
Set up 2			
Set up 3			

Tested: Casing or Casing - Tubing Annulus System Pressure during test: 0 Bbls. to load annulus: 0
Test Date: 02/27/2024 Using: DAMM PIPE TESTING Company's Equipment
The zone tested for this well is between 0 feet and 3828 feet.
The test results were verified by operator's representative:
Name: BRIAN J MCCOY Title: MANAGER Phone: (316) 214-3658

KCC Office Use Only

The results were:

- Satisfactory
 Not Satisfactory

Next MIT: 02/26/2027

State Agent: Ken Scofield Title: E.C.R.S. Witness: Yes No

Remarks: _____

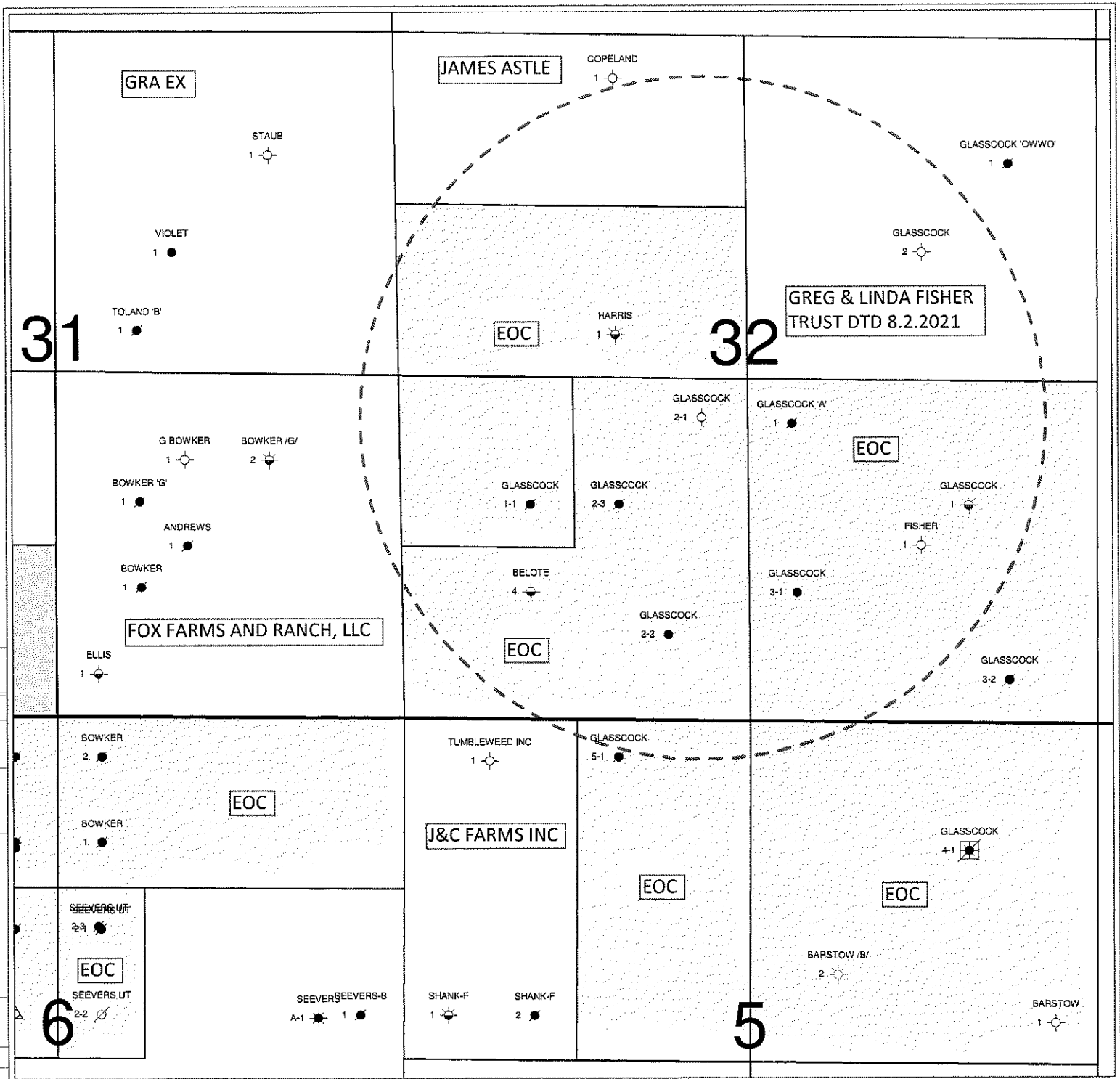

GLASSCOCK UNIT LEASE	
245-13W STAFFORD COUNTY, KS	
POSTED WELL DATA	
Well Name	
Well Number	●
WELL SYMBOLS	
●	Oil Well
●	Plugged & Abandoned Oil Well
★	Oil & Gas Well
○	Dry Hole
○	Injection Well
⊠	Oil Conv to EOR P&A
⊠	Service Well
○	Temporarily Abandoned
○	Dry Hole, With Show of Oil
○	Dry Hole, With Show of Oil & Gas
○	Dry Hole, With Show of Gas
REMARKS	
UNIT MAP	
By: EOC	
March 22, 2024	

EXHIBIT A

A.

Lease	O/G	PROD WELLS	WELL COUNT	API #	Year Drilled	Yr. Assumed Responsibility	Depth	County	S	T	R
Glasscock LKC Unit #2-1	TA	0	1	15-185-00298-0001	1959	2016	4285	Stafford	32	24S	13W
Glasscock LKC Unit #2-2	O	1	1	15-185-01112-0000	1959	2016	4256	Stafford	32	24S	13W
Glasscock LKC Unit #3-1	O	1	1	15-185-19036-0000	1960	2016	4273	Stafford	32	24S	13W

B. BREAKDOWN OF PLUGGING EXPENSES TO PLUG GLASSCOCK #2-1

WORKOVER RIG	\$ 7,500.00
WIRELINE	\$ 2,500.00
TBG RENTAL	\$ 1,500.00
PUMP TRUCK & CEMENT	\$ 8,500.00
DIG PIT & WATER TO PLUG	\$ 2,000.00
MISC.	\$ 1,500.00
TOTAL	\$ 23,500.00

C. 2023 OIL PRODUCTION

MONTH	BO
JANUARY	197
FEBRUARY	178
MARCH	195
APRIL	157
MAY	175
JUNE	0
JULY	144
AUGUST	108
SEPTEMBER	170
OCTOBER	168
NOVEMBER	191
DECEMBER	204
2020 TOTALS	1887

D. SEE ITEM 1.

REMAINING RESERVES 20,000-25,000 BOE

E. The subject well, in order to produce or inject at a future time will need the following:

1. RIH AND CEMENT/SQUEEZE INJECTION ZONE.
2. SCENARIO FOR PRODUCER - PERFORATE NEW ZONE, ACIDIZE, SWAB TEST, RUN PRODUCTION TBG, RIH W/ BHP AND ROD STRING, PUT WELL INTO PRODUCTION.
3. SCENARIO FOR INJECTOR - RIH WITH PACKER AND COATED TBG, MIT WELL, PUT INTO SERVICE.

F. THE SUBJECT WELL HAS PASSED MIT AS OF FEBRUARY 27, 2024. NO FURTHER ACTION IS NEEDED. PLUGGING COSTS ABOVE ARE CURRENT PRICE.

EXHIBIT B

A. GRA EX LLC P.O. BOX 32 KINGMAN, KS 67068-0032	NE/4	SECTION 31-24S-13W	STAFFORD COUNTY, KS
EDISON OPERATING COMPANY, LLC 8100 E. 22ND ST. NORTH BUILDING 1900 WICHITA, KS 67226	S/2 NW/4 & NW/4 SW/4	SECTION 32-24S-13W	STAFFORD COUNTY, KS
	NE/4 SW4 & S/2 SW/4	SECTION 32-24S-13W	STAFFORD COUNTY, KS
	SE/4	SECTION 32-24S-13W	STAFFORD COUNTY, KS
	E/2 NW/4	SECTION 5-25S-13W	STAFFORD COUNTY, KS
	NE/4	SECTION 5-25S-13W	STAFFORD COUNTY, KS
B. FOX FARM AND RANCH LLC 3814 E. 11TH ST. TULSA, OK 74137	SE/4	SECTION 31-24S-13W	STAFFORD COUNTY, KS
JAMES ASTLE 320 SW 20TH ST. ST. JOHN, KS 67576	N/2 NW/4	SECTION 32-24S-13W	STAFFORD COUNTY, KS
GREG AND LINDA FISHER TRUST DTD 8-2-2021 410 N. NUTTING ST. JOHN, KS 67576	NE/4	SECTION 32-24S-13W	STAFFORD COUNTY, KS
J&C FARMS INC 122 S. MAIN ST. ST. JOHN, KS 67576	W/2 NW/4	SECTION 5-25S-13W	STAFFORD COUNTY, KS