

Wamego Office:

1000 South Wind Dr.
P.O. Box 5
Wamego, KS 66547-0005
(785) 456-2212



Clay Center Office:

524 Dexter
P.O. Box 513
Clay Center, KS 67432-0513
(785) 632-3111

July 29, 2019

Mr. Jason Kerr, Utilities Engineer
Kansas Corporation Commission
1500 SW Arrowhead Road
Topeka, Kansas 66604

Re: In the Matter of the Application of Bluestem Electric Cooperative, Inc.,
For A Certificate of Public Convenience and Authority to Transact the
Business of an Electric Public Utility, Specifically in a Portion of Section
33, Township 09 South, Range 09 East, and portion of Section 4,
Township 10 South, Range 9 East, located in Pottawatomie County,
Kansas

Dear Mr. Kerr,

Please find enclosed five (5) copies each of the Bluestem Electric Cooperative, Inc., Application for Certificate of Public Convenience and Authority to Transact Business as an Electric Public Utility, in Pottawatomie County. This application is being filed with the Kansas Corporation Commission for their approval.

If you have any questions, please contact me at 785-456-2212.

Sincerely,

A handwritten signature in blue ink that reads "Michael M. Morton".

Michael M. Morton
General Manager

Enclosures

BEFORE THE STATE CORPORATION COMMISSION OF THE STATE OF KANSAS

IN THE MATTER OF THE APPLICATION OF)

Bluestem Electric Cooperative, Inc.)

for a CERTIFICATE of CONVENIENCE and AUTHORITY to)

transact the business of a Public Utility)

(Common carrier or public utility))

in the State of Kansas.)

A Portion of Section 33, Township 09 South, Range 09 East, and a portion of Section 4, Township 10 South, Range 9 East, in Pottawatomie County, Kansas)

(Here describe the territory very briefly, as county, city, section, etc.))

DOCKET NO.

20-BECE-043-COC

APPLICATION FOR CERTIFICATE

Comes on Bluestem Electric Cooperative, Inc., Michael M. Morton, General Manager

of Wamego, Kansas, and represents and shows to the commission:

That applicant is a cooperative corporation

(Corporation, Partnership or Individual)

and as such intends to engage in the business of an electric utility in the State of Kansas, thereby promoting the public convenience in the following described territory in said state, to wit: (describe by metes and bounds and attach map as part of this application).

A tract of land described as a portion of Section 33, Southeast ¼ of the Southwest ¼, T-09-S, R-09-E, and a portion of Section 4, the Northeast ¼ of the Northwest ¼, T-10-S, R-09-E. Pottawatomie County, Kansas, as detailed on the map marked Exhibit "A" and attached hereto.

That other utilities of the same classification as this applicant now operating in or adjoining the above-described territory are:

NAME

ADDRESS

WESTAR Energy, Inc.

818 S. Kansas Avenue, Topeka, Kansas 66601

That the above-described territory is now being served by WESTAR Energy, Inc. which said utility has filed its application requesting permission from the Commission to cease operating in said territory.

That applicant further states: Westar Energy desires and seeks the approval of the Commission to cease operating as an electric utility in the territory described above and that Bluestem Electric Cooperative, Inc., has agreed to

provide electric utility service to the customer. WHEREFORE, Applicant requests that a Certificate of Convenience and Authority be issued granting the right to transact the business of a Electric Public Utility to Bluestem Electric Cooperative, Inc.

in the above-described territory.

Michael M. Morton

Applicant

By Michael M. Morton, General Manager

STATE OF KANSAS, POTTAWATOMIE COUNTY, SS.:

Michael M. Morton, of lawful age, being first duly sworn deposes and says that he is of General Manager of the within named applicant, that he has read the above and foregoing application and the statements therein contained are true.

SUBSCRIBED AND SWORN TO before me this 29th day of July 2019

Thad Donnelly

Notary Public.

My commission Expires: Nov 6 2022



WESTAR ENERGY -- PROPOSED CEASE TO SERVE

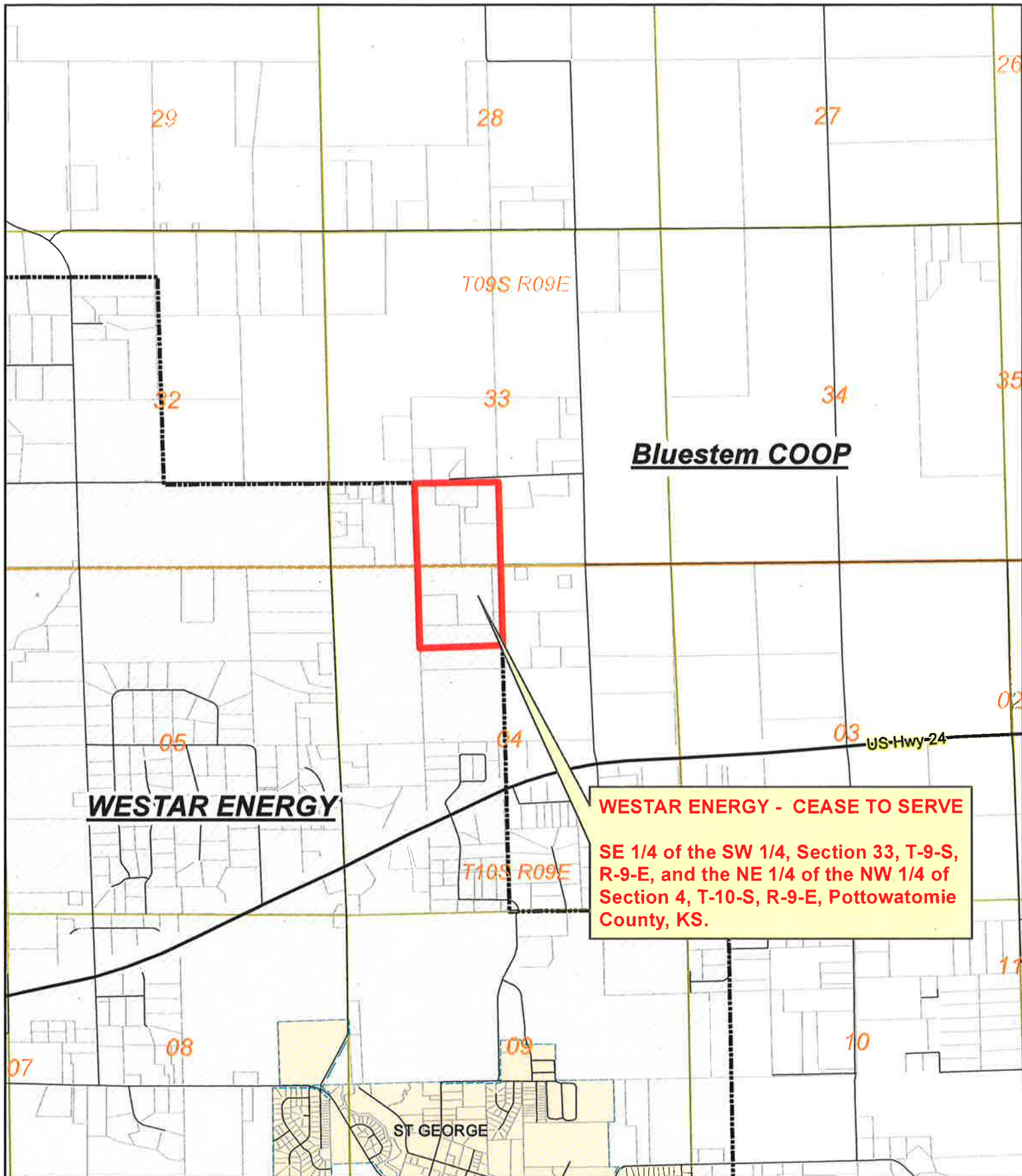

WESTAR ENERGY - CEASE TO SERVE
 SE 1/4 of the SW 1/4, Section 33, T-9-S, R-9-E, and the NE 1/4 of the NW 1/4 of Section 4, T-10-S, R-9-E, Pottowatomie County, KS.



Think Safety



Westar Energy - Proposed Cease to Serve--(to Bluestem COOP)

BY Todd N.	WR # n/a	Crew HQ	Manhattan
Date 7/26/2019	Scale 1" = 2,000'	Page 1	
Proposed	Application Number		

Exhibit "A"