



That the above-described territory is now being served by Evergy Kansas Central, Inc.  
which said utility has filed its application requesting permission from the Commission to cease operating in said territory.

That Applicant further states:

**WHEREFORE;** Applicant requests that a Certificate of Convenience and Authority be issued granting the right to  
transact the business of a (n) Electric public utility  
(Tel., Gas, Elec., etc.) (Common carrier or public utility)  
in the above-described territory.

**Sedgwick County Electric Coop Assoc.**  
Applicant

By Scott Ayres

STATE OF KANSAS )  
 ) ss.  
SEDGWICK COUNTY, )

Scott Ayres, of lawful age, being duly sworn deposes and  
says that he is the CEO of the above-named, that he has read the above and  
foregoing application and knows the contents thereof, and that the matters and information therein stated are true.

Tim Rosenhagen

SUBSCRIBED AND SWORN TO before me this 30 day of May, 2023

Tim Rosenhagen  
Notary Public

My commission expires: 4-08-2025



NOTARY PUBLIC - State of Kansas  
TIM ROSENHAGEN  
My Appt. Expires 4-08-2025



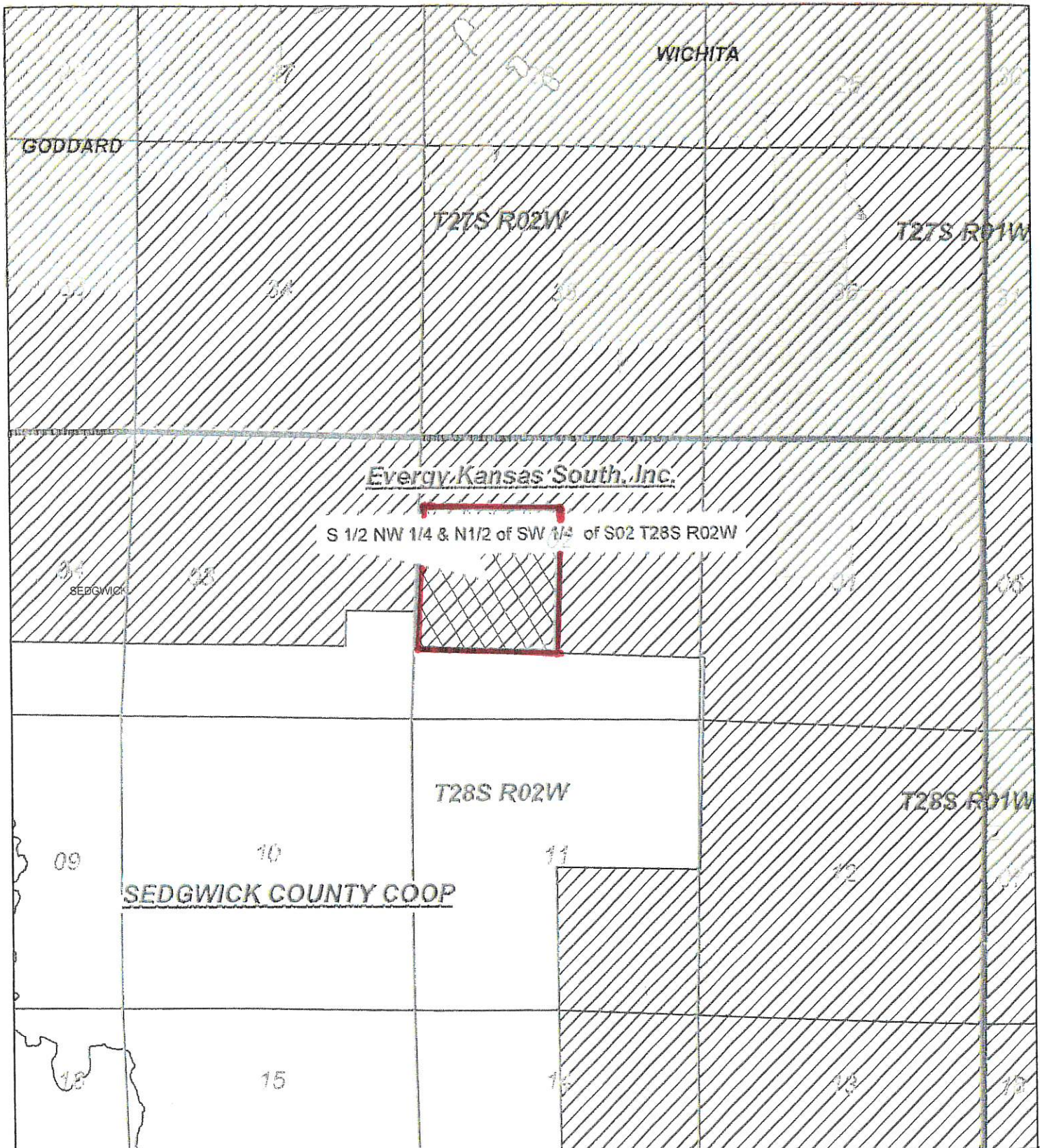

## DISCLAIMER AND COPYRIGHT NOTICE

The information contained on this drawing/map is used to locate, identify and/or inventory Everygy Inc. electrical facilities located on parcels of land in the Everygy Inc. service area. It is intended for reference purposes only and is NOT to be construed or used as a "legal description." Map information is believed to be accurate but accuracy is not guaranteed. This information should not be relied upon as a substitute for an actual field survey. This drawing/map is not to be used as a substitute for using the ONE-CALL system for purposes of digging and excavation. You must call ONE-CALL (811) to notify operators of underground facilities of proposed excavation or digging to request that member companies mark their underground facilities before they dig. In no event will Everygy Inc. be liable for any damages, including loss of data, lost profits, business interruption, loss of business information or other pecuniary loss that might arise from the inaccuracy, use or misuse of this map or the information it contains. You are prohibited from reproducing or distributing this drawing/map or any portion of it without written permission of Everygy Inc. © Everygy Inc. All rights reserved.



**TITLE: PROPOSED TRANSFER EVERYGY TO SCEC**  
**BY: TIM ROSENHAGEN (316) 542-3131**  
**DATED: 5/10/2023**

WR # xxxx		Crew HQ xxxx	
Scale 1 inch = 2359 feet		Sheet Page 1	