

25-CONS-3323-CUIC

KANSAS CORPORATION COMMISSION
OIL & GAS CONSERVATION DIVISION
APPLICATION FOR INJECTION WELL

2025-03-21 16:38:47
Filed Date: 03/21/2025
State Corporation Commission
Form U-1
of Kansas
Must be Typed
Form must be Signed
All blanks must be Filled

Disposal
Enhanced Recovery: Repressuring
 Waterflood
 Tertiary
Date: 2/14/2025
Operator License Number: 32701 Exp. 09/30/25
Operator: C&G Drilling Inc
Address: 701 E River Eureka, KS 67045
Tim Gulick
Contact Person: Bryan Smith (cc)
Phone: 6205833242 620-583-4306
Email: cgdrilling@yahoo.com

Permit Number: E-34,576 2-ED
API Number: 15-015-75902
Well Location
Sec. 16 Twp. 26 S. R. 8 E W
1960 feet from S / N Line of Section
2025 feet from E / W Line of Section
GPS Location: Lat: 37.7900505, Long: 96.5325424
(e.g. xx.xxxxx) (e.g. -xxx.xxxxx)
Datum: NAD27 NAD83 WGS84
Lease Description: S/2 Sec 16 & NE/4 Sec 16-TWP26S-R8E
Lease Name: Larcom Well Number: B7
Field Name: Blankinship
County: Butler
Deepest Usable Water
Formation:
Depth to Bottom of Formation: Received by Kansas Corporation Commission

Check One: Old Well Being Converted Newly Drilled Well Well to be Drilled
Surface Elevation: 1372 feet Well Total Depth: 2495 feet Plug Back Depth: feet
Datum of top of injection formation: 2406 feet (reference mean sea level)

Injection Formation Description:

Name	top / bottom	perf / open hole	depth
Bartlesville	2406 / 2509	Perf	at 2430 to 2452 feet

List of Wells/Facilities Supplying Produced Saltwater or Other Fluids Approved by the Conservation Division:
(attach additional sheets if necessary)

Lease Operator	Lease/Facility Name	Lease/Facility Description	Well ID & Spot Location
1. C&G Drilling Inc	Larcom	S16-T26S-R8E	#1NW SE S16-T26S-R8E
2. C&G Drilling Inc	Larcom	S16-T26S-R8E	#2 NW SE S16-T26S-R8E
3. C&G Drilling Inc	Larcom	S16-T26S-R8E	#4 NW SE S16-T26S-R8E

Producing Formation	Strata Depth	Total Dissolved Solids (if available)
1. _____	_____ to _____ feet	(Applicant Paid \$200.00 CK 7473 2/21/25) mg/l
2. _____	_____ to _____ feet	mg/l
3. _____	_____ to _____ feet	mg/l

Maximum Requested Liquid Injection Rate: 2000 bbls / day; or
Maximum Requested Gas Injection Rate: _____ scf / day. Type of Gas: _____
Maximum Requested Injection Pressure: 750 psig

Mail to: KCC - Conservation Division, 266 N Main St, Ste 220, Wichita, Kansas 67202-1513

2/25/25 Recd in UIC Dept.

Well Completion

Type: Tubing & Packer Packerless Tubingless

	Conductor	Surface	Intermediate	Production	Tubing
Size	0	8.625	5.50	4.50	2.375
Setting Depth			2495	2460	2425
Amount of Cement				50sks	
Top of Cement			2388	938	
Bottom of Cement			2495	2460	

If Alternate II cementing, complete the following:

Perforations / D.V. Tool at _____ feet, cemented to _____ feet with _____ sx.

Tubing: Type _____ Grade _____

Packer: Type _____ Depth _____

Annulus Corrosion Inhibitor: Type _____ Concentration _____

List Logs Enclosed: _____

Received by
Kansas Corporation Commission

Well Sketch

(To sketch installation, darken the appropriate lines, indicate cement, and show depths.)

FEB 21 2025

Conservation Division, Wichita, KS

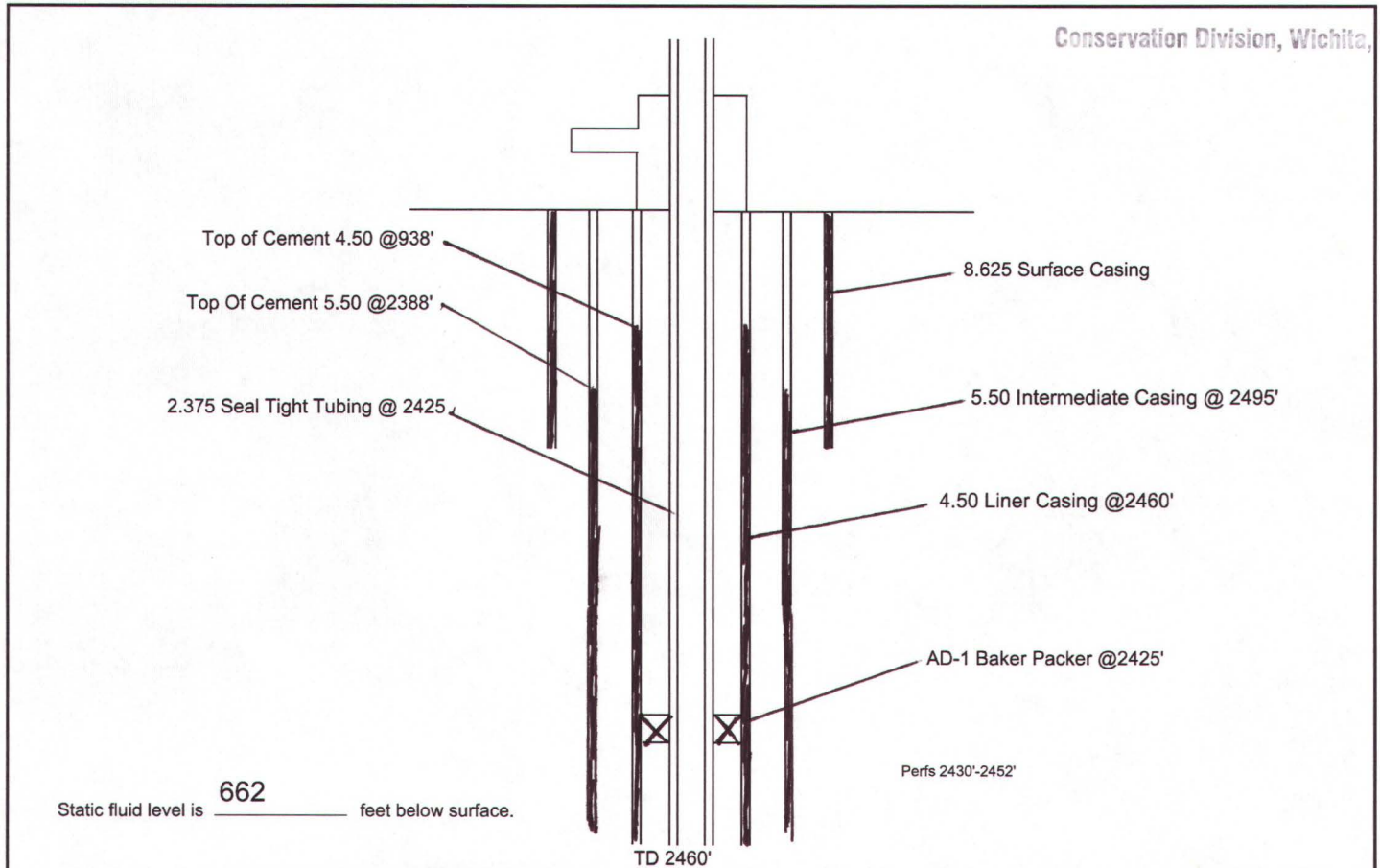

M. Dickinson B"7" Proposed Injection Well

In the matter of the well B"7" proposed injection well not having any records we have discussed a couple ways to make this well meet approval with Jeff Clock and Neal Rupe. This well had a 4.50 liner ran to depth of 2465' in 2013 and a bond log was ran and cement was at 938' so we came up with a plan to weld a ring in between 4.50 and 5.50 then weld nipple on 5.50 circulate fluid down the outside of 4.50 then out the hole at the 938' and back to surface. Once flow is established circulate die to make sure we are at the 938'. Once we have determined that we are at the correct depth circulate cement to surface. If fluid cannot be established we could run 1 inch pipe down between the 5.50 and the 8.625 to a depth of 250' and circulate cement it to surface.

Received by
Kansas Corporation Commission

FEB 21 2025

Conservation Division, Wichita, KS

Plat and Certificate of Injection Well Location and Surrounding Acreages

Operator: C&G Drilling Inc Location of Well: NE/4 S16-T26S-R8E
 Lease: Larcom 1960 feet from S / N Line of Section
 Well Number: B7 2025 feet from E / W Line of Section
 County: Butler Sec. 16 Twp. 26 S. R. 8 East West

Plat

Show the following information: applicant injection well, all producing wells, inactive wells, plugged wells, and other wells within a one-half mile radius, all lease boundaries, lease operators, unleased mineral rights owners, well numbers, and producing wells producing formation tops.

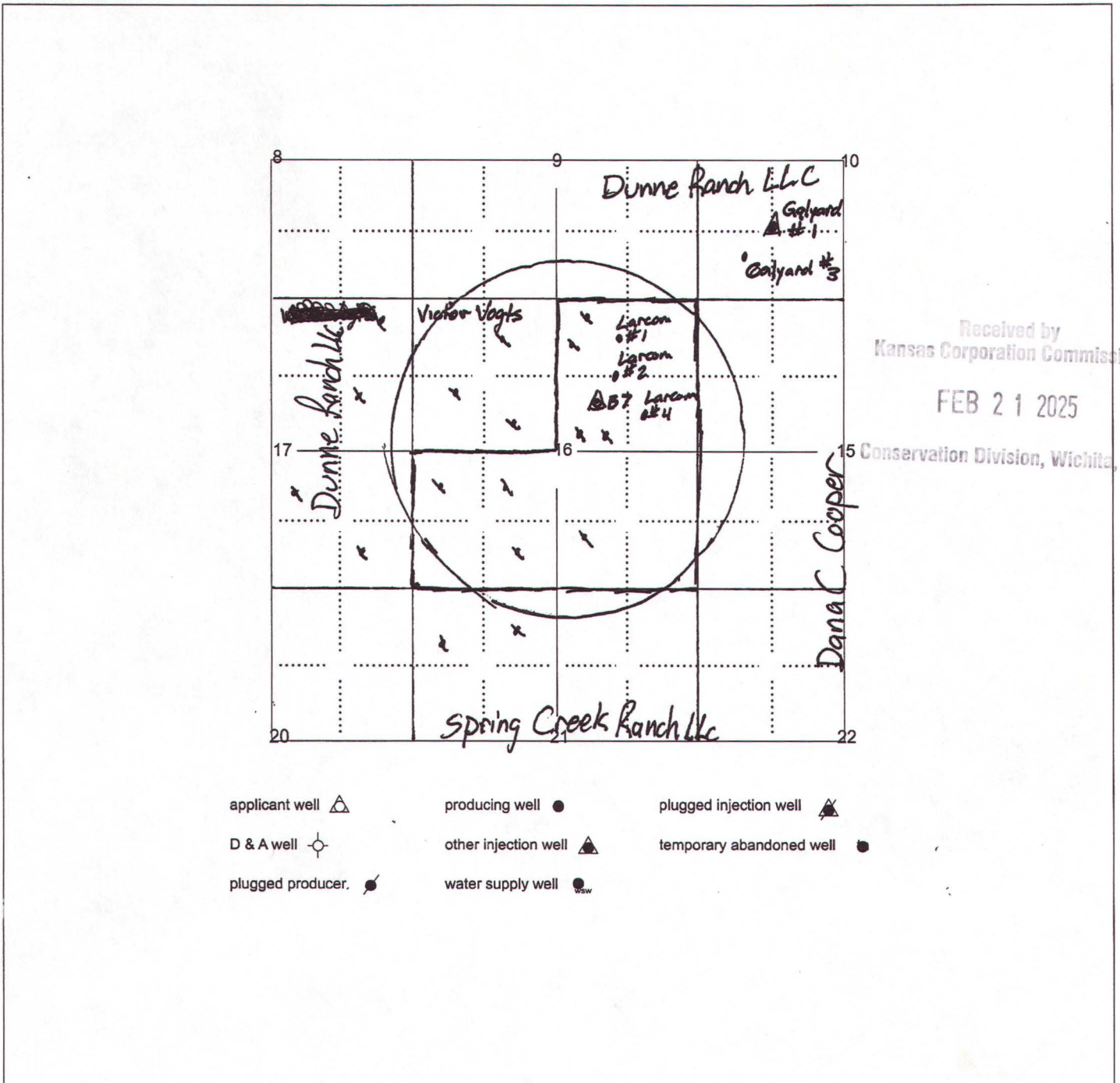

Affidavit of Notice Served

Re: Application for: C&G Drilling Inc
Well Name: M Dickinson B"7" Legal Location: NE/4 S16-T26S-R8E

Note: A copy of this affidavit must be served as a part of the application.

Name:
Dana C Cooper
Dunne Ranch LLC
Victor Vogts
Micheal Larcom {landowner}

Address: (Attach additional sheets if necessary)
18054 S Hastings St Olathe, KS 66061
2424 Ridge RD Rockwell, TX 75087
P.O. Box 124 Rosalia, KS 67132
436 131ST Eureka, KS 67045

Received by
Kansas Corporation Commission
FEB 21 2025
Conservation Division, Wichita, KS

I certify that the statements and information contained in this application are true and correct to the best of my knowledge, and that a true and correct copy of this application was delivered or mailed to all required persons, and that such persons are identified on Page 5 of this application.

[Signature]
Applicant or Duly Authorized Agent

Subscribed and sworn before me on: February 20, 2025



Janice Van Hoozer
Notary Public

My Commission Expires: 6-9-2026

Protests may be filed by any party having a valid interest in the application. Petitions for protests shall be in writing and shall clearly identify the name and address of the protester and the title of the application. The petition shall include a clear and concise statement of the direct and substantial interest of the protester in the proceeding, including specific allegations as to the manner in which the grant of the application will cause waste, violate correlative rights, or pollute the water resources of the state of Kansas. Protesters shall serve the protest upon the applicant by mail or personal service at the same time or before the protester files the protest with the Conservation Division. Protests must be filed within 30 days of the publication notice of the application.