

**BEFORE THE STATE CORPORATION COMMISSION  
OF THE STATE OF KANSAS**

IN THE MATTER OF THE APPLICATION OF )  
WESTAR ENERGY, INC. TO CEASE )  
TRANSACTIONING THE BUSINESS OF AN )  
ELECTRIC PUBLIC UTILITY, IN PORTIONS OF )  
SECTION 25, TOWNSHIP 8 SOUTH, RANGE 21 )  
EAST, IN LEAVENWORTH COUNTY, KANSAS )

Docket No 18-WSEE-463-CCS

**APPLICATION TO CEASE**

COMES NOW Westar Energy, Inc. (Westar Energy), and in support of its Application  
To Cease states:

1. Westar Energy is a Kansas corporation authorized by the Commission to conduct the business of a public utility under the provisions of K.S.A. 66-104, and as such holds a Certificate of Convenience and Authority from this Commission to engage in the business of an electric public utility in the State of Kansas, thereby promoting the public convenience in the following described territory:

**LEAVENWORTH COUNTY, KANSAS**

A tract of land described as the West 300 feet of the East ½ of the Southwest ¼, and the West 300 feet of the Southeast ¼ of the Northwest ¼ of Section 25, Township 8 South, Range 21 East in Leavenworth County, Kansas, as detailed on the map marked Exhibit A and attached hereto.

2. FreeState Electric Cooperative, Inc. (FreeState) certified territory is adjacent to the territory described in paragraph 1.

3. Westar Energy and FreeState have mutually agreed, subject to the Commission's approval, that as a matter of public convenience and to better serve a new customer, FreeState should serve as an electric public utility in the territory described in paragraph 1.

4. Westar Energy understands that FreeState has filed an application with the Commission to expand its electric service territory to include the territory described in paragraph 1.

5. A copy of this application is being served on Heartland REC by delivery of United States Mail, postage prepaid, addressed as follows:

Matthew Magill  
FreeState Electric Cooperative, Inc.  
1100 SW Auburn Road  
Topeka, Kansas 66615

There is no other person or entity, corporate, municipal or otherwise that requires notice of this Application.

THEREFORE, Westar Energy requests that an Order be issued, granting Westar Energy the authority to cease operating as an electric public utility in the territory described in paragraph I above.

WESTAR ENERGY, INC.

BY: Cathryn J. Dinges  
Cathryn J. Dinges, S.Ct. #20848  
818 S. Kansas Avenue  
P. O. Box 889  
Topeka, Kansas 66601-0889  
Phone: (785) 575-8344  
Fax: (785) 575-8136

ITS ATTORNEY

STATE OF KANSAS            )  
  )  
COUNTY OF SHAWNEE    )       ss

Cathryn J. Dinges, of lawful age, being first duly sworn upon oath, deposes and states:

That she is the attorney for the within named applicant, that she has read the above and foregoing application and that the statements therein contained are true according to her knowledge and belief.

Cathryn J. Dinges  
Cathryn J. Dinges

Subscribed and sworn to before me this 24<sup>th</sup> day of April 2018.

Donna G. Quinn  
Notary Public

My Appointment Expires:

4/28/2020

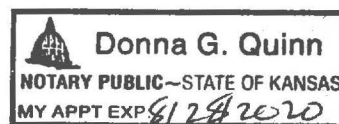

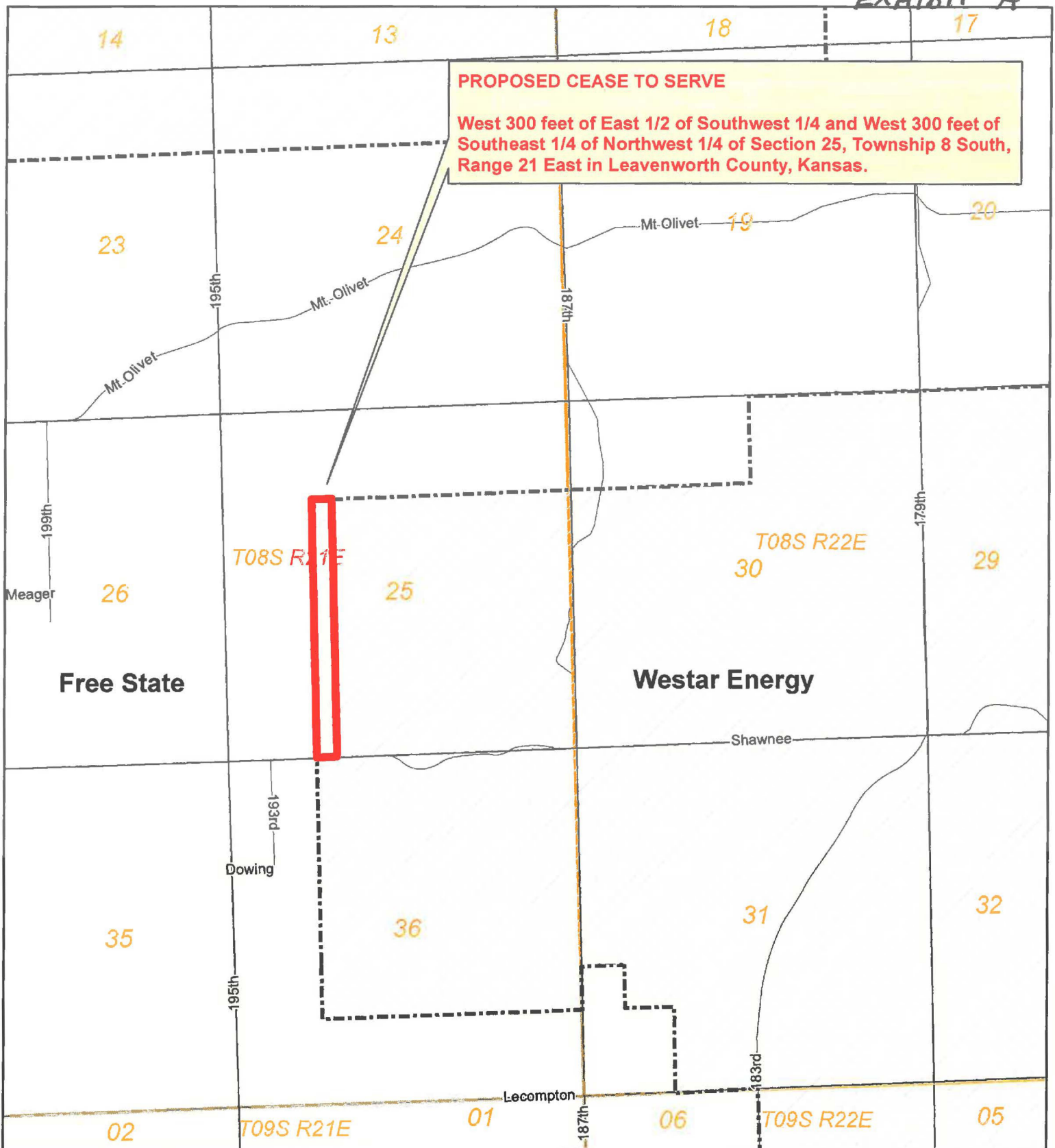

DISCLAIMER AND COPYRIGHT NOTICE

The information contained on this drawing/map is used to locate, identify and/or inventory Westar Energy, Inc. electrical facilities located on parcels of land in the Westar Energy, Inc. service area. It is intended for reference purposes only and is NOT to be construed or used as a "legal description." Map information is believed to be accurate but accuracy is not guaranteed. This information should not be relied upon as a substitute for an actual field survey. This drawing/map is not to be used as a substitute for using the Kansas ONE-CALL system for purposes of digging and excavation. You must call Kansas ONE-CALL (1-800-DIG-SAFE) to notify operators of underground facilities of proposed excavation or digging to request that member companies mark their underground facilities before they dig! In no event will Westar Energy, Inc. be liable for any damages, including loss of data, lost profits, business interruption, loss of business information or other pecuniary loss that might arise from the inaccuracy, use or misuse of this map or the information it contains. You are prohibited from reproducing or distributing this drawing/map or any portion of it without written permission of Westar Energy, Inc. © Westar Energy, Inc. All rights reserved.

Exist	New				Title <b>Westar Energy - Proposed Cease to Serve</b>		
Line Direction					By <b>Todd N.</b>	WR # <b>000000</b>	Crew HQ <b>0000</b>
		Date <b>4/20/2018</b>	Scale <b>1 inch = 2000 feet</b>		Sheet <b>Page 1</b>		
		Sub/Ckt <b>n/a</b>	Upstream Device <b>n/a</b>				