

BEFORE THE STATE CORPORATION COMMISSION OF THE STATE OF KANSAS

18-CONS-3142-CHOR

IN THE MATTER OF THE APPLICATION	}	DOCKET NO. 17-CONS- ----- -CHOR
OF H2OIL OPCO, LLC. TO DRILL THE	}	
WAGNER UNIT #1 IN RUSH COUNTY,	}	CONSERVATION DIVISION
KANSAS AS A HORIZONTALLY DRILLED	}	
WELL PURSUANT TO K.A.R.82-103A	}	LICENSE NO. 35474

APPLICATION

COMES NOW, Applicant H2Oil OPCO, LLC, 1400 Post Oak Blvd., Ste. 400, Houston, TX 77056.
Applicant herein and respectfully states as follows:

1. The Applicant is the owner of oil and gas leasehold interest in the subject acreage in Rush County, Kansas.
2. The Applicant seeks to complete the Wagner Unit #1 as a horizontally drilled well. The surface location is 410 feet from the North line and 1246 feet from the East line of Section 29-18S-16W, in Rush County, Kansas. The Wagner Unit #1 is planned to be an Injection well completed in the Reagan formation.
3. Attached and made a part hereof is Exhibit No. 1, plats showing the location for the Wagner Unit #1 in side and aerial view.
4. Attached and made a part hereof is Exhibit No. 2, a list of each operator or lessee of record (other than the Applicant) and each owner of record of the minerals in any unleased acreage within one-half mile radius of the planned well to be drilled.
5. That notice of the Application and opportunity for hearing thereon is being provided pursuant to K.A.R. 82-3-135a by mailing notice to those listed on Exhibit No. 2 and by causing the Notice of Pending Application to be published as required by the Commission in the Wichita Eagle and the Rush County News newspapers. Said notice provides that unless written protest is received by the commission within fifteen (15) days after the date of publication of said notice, the Applicant in this matter will be granted administrative approval after said 15 day period.

WHEREFORE, Applicant prays that this cause be docketed and in the event no protest is made to the Commission within the time period provided, an Order be entered permitting the drilling and completion of the Wagner Unit #1.

H2Oil Opco, LLC

By Thomas Holland
Thomas Holland
Sr. Vice President, Bus. Dev. & Land

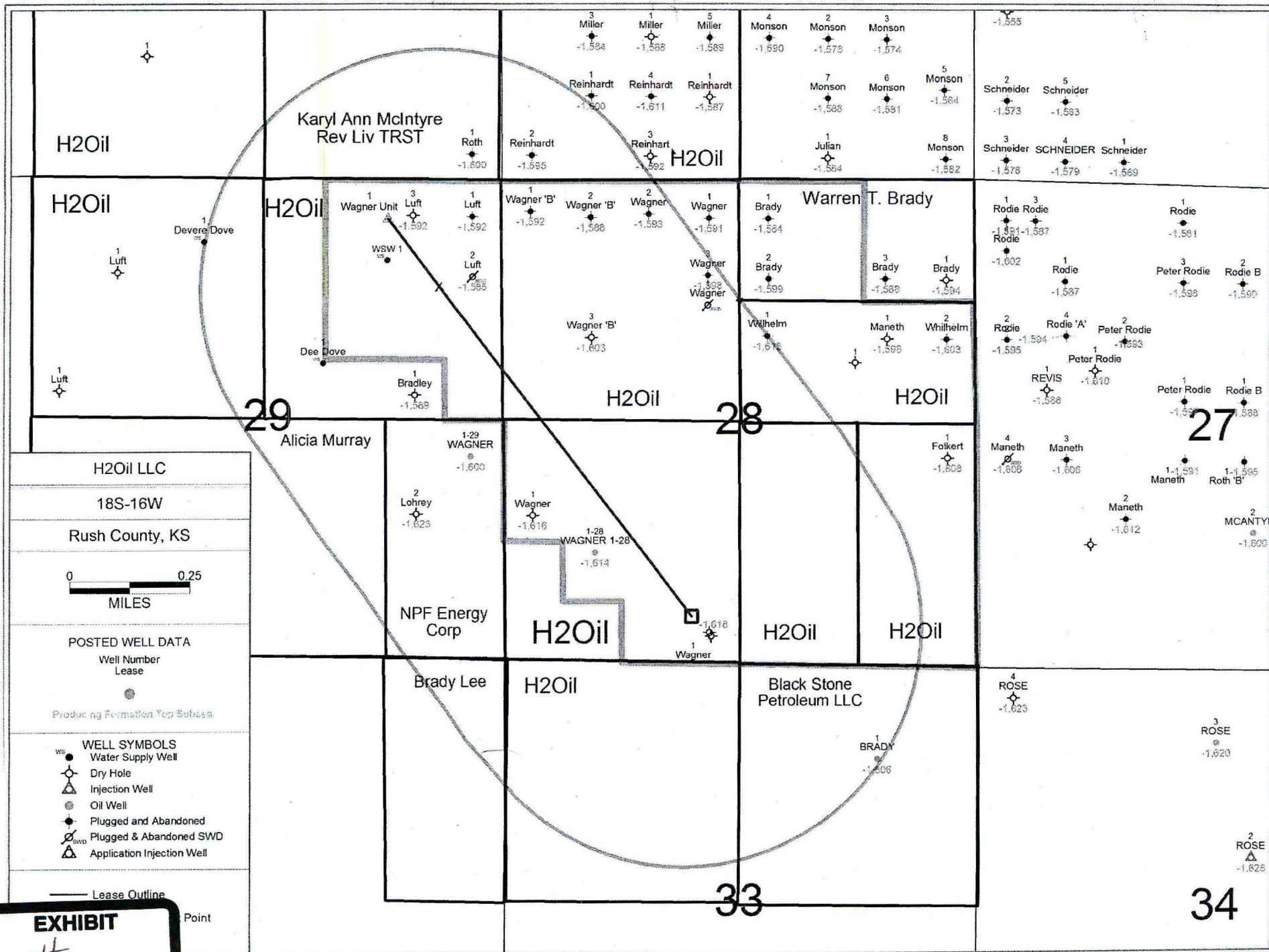

Wagner Unit # 1

10 3/4" Csg @
Approx 1100'
Cmt w/ 500
Sxs, Cmt to Surf

4 1/2" Injection Tubing

Packer at Approx. 4000' MD

Csg Penetration @ Top of Reagan Sandstone, Est 3640' TVD, 4100' MD

Liner Packer/Hanger at Approx. 4300'

7 5/8" Csg @ Approx. 4300' Cmt w/ 350 Sxs, TOC Est @ 3014'

5" Slotted Liner to TMD @ 8870'

6 3/4" OD to TMD @ 8870'

Granite Est 3750' TVD

EXHIBIT

1

tabbles

Landowner	Address	City	State	Zip Code	Legal Description	Acres	Sec	Tsp/Range
James Kaiser	601 W. Jennifer Drive	Lincoln	NE	68521	SW/4	160.00	20	18S-16W
Karyl Karyl Ann McIntyre Revocable Living Trust	1857 CR 360	Otis	KS	67565	E/2 less a 0.28 ac tract in SE/4 NE/4	307.10	20	18S-16W
Doris L. Reile Revocable Inter Vivos Trust	3631 Hwy 96	Albert	KS	67511	SW/4 less 3 ac tract at SE/cor SW/4	153.80	21	18S-16W
Gladys K. Wagner	3639 Avenue R	Albert	KS	67511	W/2	320.00	28	18S-16W
Warren T. Brady	3007 Worden	Albert	KS	67511	N/2 NE/4	80.00	28	18S-16W
Marla Ann Hungerford & Charles L Hungerford	6125 146th St.,	Omaha	NE	68116	S/2 NE/4	80.00	28	18S-16W
John M Maneth & Traci A. Maneth	2111 Foxglove Circle	Great Bend	KS	67530	S/2 NE/4	80.00	28	18S-16W
James M. Maneth & Carla J Maneth	3731 Robin Rd.	Great Bend	KS	67530	S/2 NE/4	80.00	28	18S-16W
Jeffery C. Maneth	227 Bellevue Way NE #494	Bellevue	WA	98004	S/2 NE/4	80.00	28	18S-16W
JAB Farms, LLC, a Kansas Limited Liability Company	3630 Avenue O	Bison	KS	67520	W/2 SE/4	80.00	28	18S-16W
Lenard D. Wagner	2420 W. College Lane	Hobbs	NM	88242	E/2 SE/4	80.00	28	18S-16W
Cheyenne Enterprises, LLC	1032 NE 50th Road	Ellinwood	KS	67526	N/2	320.00	29	18S-16W
Alicia Murray	30682 Country Road	Redlands	CA	92374	SW/4 & W/2 SE/4	240.00	29	18S-16W
Gladys K. Wagner	3639 Avenue R	Albert	KS	67511	E/2 SE/4	80.00	29	18S-16W
Lenard D. Wagner	2420 W. College Lane	Hobbs	NM	88242	E/2 NE/4	80.00	32	18S-16W
Marilyn Rae Roth	973 T Road	Larned	KS	67550	NW/4	160.00	33	18S-16W
Lee Brady	1607 CR 370	Otis	KS	67565	NE/4	160.00	33	18S-16W
Offset Operators								
NPF Energy Corp	PO Box 3827	Tustin	CA	92781-3827	E/2 SE/4	80.00	29	18S-16W
Mike Kelso Oil Inc.	PO Box 467	Chase	KS	67524	S/2 NE/4	80.00	28	18S-16W
Black Stone Petroleum, LLC	1041 N. White Tail Ct	Wichita	KS	67206	NE/4	160.00	33	18S-16W

EXHIBIT

#2

tabbies