

BEFORE THE STATE CORPORATION COMMISSION
OF THE STATE OF KANSAS

IN THE MATTER OF THE APPLICATION)	DOCKET NO. 18-CONS-3292-CEXC
OF MERIT ENERGY COMPANY FOR AN)	
EXCEPTION TO THE 10-YEAR TIME)	
LIMITATION OF K.A.R. 82-3-111 FOR ITS)	CONSERVATION DIVISION
WANDER 2-2 WELL IN THE)	
NORTHWEST QUARTER OF THE)	
NORTHEAST QUARTER OF SECTION 2,)	LICENSE NO. 32446
TOWNSHIP 30 SOUTH, RANGE 35)	
WEST, GRANT COUNTY, KANSAS.)	
_____)	

SUPPLEMENT TO APPLICATION

COMES NOW, Merit Energy Company, LLC, 13727 Noel Road, Suite 1200, Dallas, Texas 75240, Applicant herein and respectfully states to the Commission as follows:

1. Applicant hereby supplements its Application by submitting the following attached document:

a. Corrected plat.

WHEREFORE, Applicant prays that an Order be entered granting an exception to the K.A.R. 82-3-111 10-year limitation for the Wander 2-2 well.

MERIT ENERGY COMPANY, LLC

By 
Stanford J. Smith, Jr.
MARTIN, PRINGLE, OLIVER, WALLACE
& BAUER, L.L.P.
100 North Broadway, Suite 500
Wichita, KS 67202
Telephone: (316) 265-9311
Attorneys for the Applicant

VERIFICATION

STATE OF KANSAS)
) ss:
COUNTY OF SEDGWICK)

COMES NOW, Stanford J. Smith, Jr., of lawful age, being first duly sworn on his oath states:

That he is employed by Merit Energy Company, LLC, as its attorney and is authorized to make this verification; that he has read the above and foregoing Supplement to Application and is familiar with the contents thereof and that the statements made therein are true and correct to the best of his knowledge and belief.

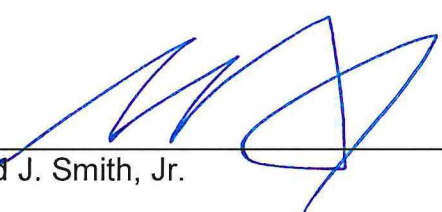

Stanford J. Smith, Jr.

SUBSCRIBED AND SWORN to before me this 1st day of February, 2018.

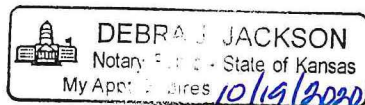



Notary Public

My Appointment Expires:
10/19/2020

CERTIFICATE OF SERVICE

I hereby certify that a true and correct copy of the foregoing document was e-mailed on this 1st day of February, 2018, to:

Jonathan R. Myers, Esq.
Litigation Counsel
Kansas Corporation Commission
266 North Main, Suite 220
Wichita, KS 67202



Stanford J. Smith, Jr.

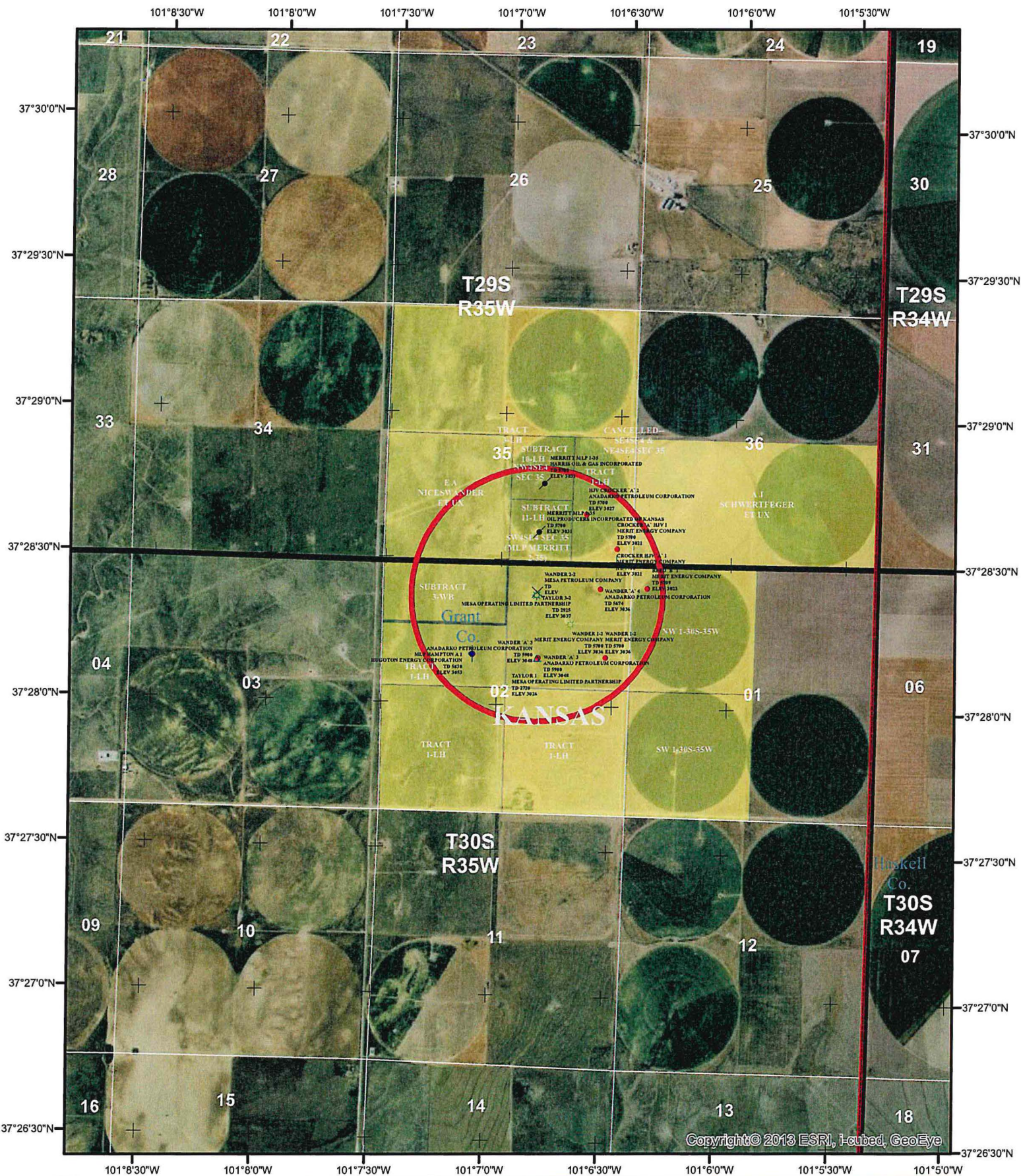

- ✱ GAS
- OIL PRODUCER
- ✱ GAS PRODUCER
- ✕ ABANDON LOCATION
- ✂ ABD-OW
- ▲ SWDOP
- TA-O
- WELL PERMIT

HALF MILE BUFFER
MERIT LEASEHOLD

0 0.5 1 Miles

Scale: 1:31,680



EXHIBIT 1

MERIT ENERGY COMPANY

WANDER 2-2 W/
1/2 MILE BUFFER

GRANT CO., KANSAS

Map by: Richard Norzagaray

Date: Tuesday, January 30, 2018

Coordinate System:

NAD 1983 StatePlane Kansas State FIPS 4604