

**BEFORE THE STATE CORPORATION COMMISSION  
OF THE STATE OF KANSAS**

IN THE MATTER OF THE APPLICATION OF )  
WESTAR ENERGY, INC. FOR CERTIFICATE )  
PUBLIC CONVENIENCE AND AUTHORITY )  
TO TRANSACT THE BUSINESS OF AN )  
ELECTRIC PUBLIC UTILITY SPECIFICALLY ) Docket No. 15-WSEE-238-COC  
IN A PORTION OF SECTION 25, TOWNSHIP 2 )  
SOUTH, RANGE 7 EAST, IN LEAVENWORTH )  
COUNTY KANSAS )

**APPLICATION FOR A CERTIFICATE OF PUBLIC CONVENIENCE AND  
AUTHORITY TO TRANSACT THE BUSINESS OF AN ELECTRIC PUBLIC UTILITY**

COMES NOW Westar Energy, Inc. (Westar Energy), and in support of its Application  
for a Certificate of Public Convenience and Authority, states:

Westar Energy is a Kansas corporation authorized by the Commission pursuant to K.S.A.  
66-104 to conduct the business of a public utility, and as such holds a Certificate of Convenience  
and Authority from this Commission to engage in the business of an electric public utility in the  
State of Kansas, thereby promoting the public convenience.

1. Westar Energy seeks to serve, subject to the Commission's approval, in  
Leavenworth Jefferson Electric Cooperative (Leavenworth Jefferson EC) certified territory  
described below:

**LEAVENWORTH COUNTY, KANSAS**

A tract of land described as the Northeast  $\frac{1}{4}$  of the Northeast  $\frac{1}{4}$  of the Southwest  
 $\frac{1}{4}$  of Section 16, Township 9 South, Range 22 East, in Leavenworth County,  
Kansas, as detailed on the map marked Exhibit A and attached hereto.

2. Westar Energy and Leavenworth Jefferson EC are working together to correct  
territory issues. Westar Energy is currently serving the tract of land described in Paragraph 1  
although it is in Leavenworth Jefferson EC's certified territory.

3. Leavenworth Jefferson EC has agreed to cease serving the tract of land described in Paragraph 1, subject to the Commission's approval, to correct the existing territory discrepancies.

4. Westar Energy understands that Leavenworth Jefferson EC has filed, or will soon file, an application with the Commission to cease serving its electric service in the territory described in paragraph 1.

5. A copy of this application is being served on Leavenworth Jefferson EC by delivery of United States Mail, postage prepaid, addressed as follows:

Eric Wylie  
Engineer and Operations Manager  
Leavenworth Jefferson Electric Cooperative  
507 N. Union Street  
McLouth, KS 66054

There is no other person or entity, corporate, municipal or otherwise that requires notice of this Application.

THEREFORE, Westar Energy requests that an Order be issued, granting Westar Energy the authority to serve as an electric public utility in the territory described in paragraph 1 above.

WESTAR ENERGY, INC.

BY: Cathryn Dinges  
Cathryn J. Dinges, S.Ct. #20848  
818 S. Kansas Avenue  
P. O. Box 889  
Topeka, Kansas 66601-0889  
Phone: (785) 575-8344  
Fax: (785) 575-8136

ITS ATTORNEY

STATE OF KANSAS            )  
  )  
COUNTY OF SHAWNEE    )       ss

Cathryn J. Dinges, of lawful age, being first duly sworn upon oath, deposes and states:

That she is the attorney for the within named applicant, that she has read the above and foregoing application and that the statements therein contained are true according to her knowledge and belief.

Cathryn Dinges  
Cathryn J. Dinges

Subscribed and sworn to before me this 5<sup>th</sup> day of December, 2014

  
My Appointment Expires:  
June 26, 2017

Debbielee A. Papps  
Notary Public

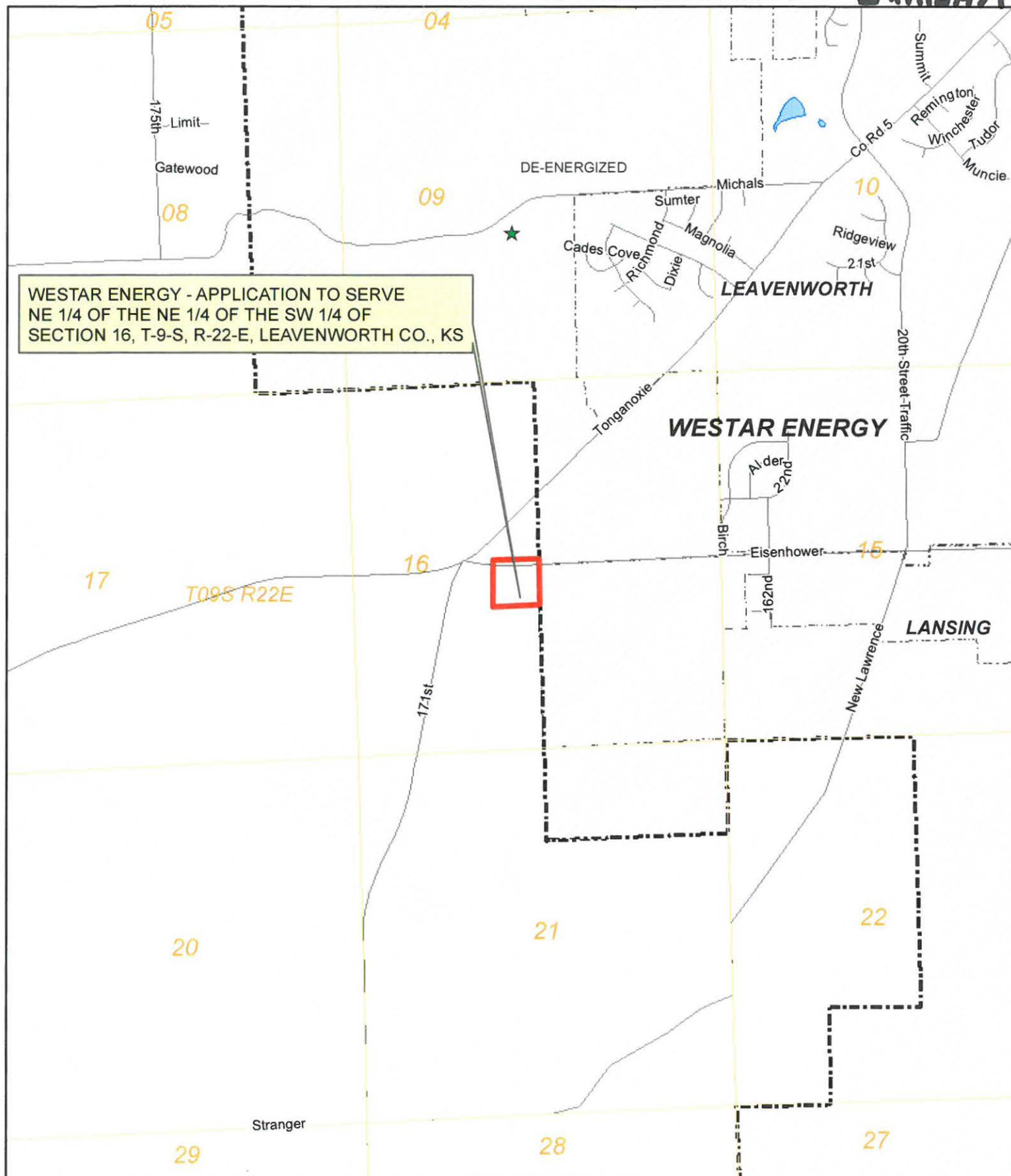

Title: Westar/LJEC clean up project

Name: Todd N.

WR #

n/a

Crew HQ: Leavenworth

Date 8/15/2014

Scale: 1" = 2000

Page 1

Proposed

Application Number Title