

MAR 23 2015

CONSERVATION DIVISION  
WICHITA, KS

BEFORE THE STATE CORPORATION COMMISSION  
OF THE STATE OF KANSAS

IN THE MATTER OF THE APPLICATION	)	
OF LINN OPERATING, INC. FOR AN	)	DOCKET NO. 15-CONS- <u>774</u> -CUNI
ORDER PROVIDING FOR THE	)	
UNITIZATION AND UNIT OPERATION OF	)	
A PART OF THE HUGOTON AND	)	
PANOMA COUNCIL GROVE GAS FIELDS	)	
IN THE ALTERNATE TRACT UNIT	)	
DESCRIBED AS SECTION 36-26S-38W	)	OPERATOR NO. 33999
(SE/4), SECTION 31-26S-37W (SW/4), IN	)	CONSERVATION DIVISION
KEARNY COUNTY, KANSAS, SECTION	)	
06-27S-37W (NW/4), SECTION 01-27S-	)	
38W (NE/4) IN GRANT COUNTY, KANSAS	)	
(ATU 127X)	)	

**APPLICATION**

COMES NOW, LINN OPERATING, Inc., 600 Travis, Suite 5100, Houston, TX 77002, Applicant herein and respectfully states to the Commission as follows:

1. The Applicant is the owner of oil and gas leasehold interests in Kearny and Grant Counties, Kansas, and operates several wells producing in the subject area from the Chase and Council Grove Formations, which respectively comprise the Hugoton and Panoma Council Grove Gas Fields.

2. The Applicant proposes to unitize gas leasehold interests and operations in the area pursuant to K.S.A. 55-1304(a)(2) for the purpose of the unitized management, operation and further development of a part of the Hugoton and Panoma Council Grove Gas Fields, which is economically feasible and reasonably necessary to prevent waste within these gas pools and thereby increase substantially the ultimate recovery of gas therefrom.

3. The unit area of the proposed gas unit, which is termed an "Alternate Tract Unit" ("ATU") under the Basic Integrated Proration Order for the Hugoton Gas Field and the Panoma Council Grove Gas Field when formed thereunder as an approximate 640 acre square, is shown on the attached unit plat and is as follows:

Section 36-26S-38W: SE/4  
Section 31-26S-37W: SW/4  
In Kearny County, Kansas

Section 06-27S-37W: NW/4  
Section 01-27S-38W: NE/4  
In Grant County, Kansas.

4. The Applicant will be the unit operator.

5. The unitized formations to be unitized within the unit area are the subsurface portions of the Unit Area described as a part of the common sources of supply of gas underlying the Unit Area known as an Alternate Tract Unit, and more specifically defined as the Chase and Council Grove Formations found in said Unit Area which are encountered in the subsurface between the approximate depths of 2,700 and 3,000 feet. Said Unit Area is comprised of parts of these pools in the area producing from the Chase and Council Grove Formations.

6. The additional drilling of an alternate tract unit well on the unit area as described above is needed for the effective management, development and production in a part of the Hugoton and Panoma Council Grove Gas Fields to substantially increase and maximize the ultimate gas recovery from the unit area.

7. That the value of the estimated additional recovery of the hydrocarbons from these formations substantially exceeds the estimated additional cost incident to the conducting of such operations. The proposed operations as outlined in the unit agreement and the unit operating agreement are fair and equitable to all interest owners.

8. That attached hereto and incorporated herein by reference are the following exhibits comprising Applicant's Plan for Unit Operations:

A. Unit Agreement

B. Unit Operating Agreement (Excerpted A.A.P.L. Form 610-1982 Model Form Operating Agreement, entirety incorporated by reference.)

9. That said Plan, as required by statute, has been approved in writing by at least 63% of the persons required to pay the costs of the unit operation, whereas Applicant owns 100% working interest in the unit area tracts described above and the governmental sections contributing said unit area tracts, and by the owners of at least 75% of the production or proceeds that will be credited to royalties, excluding overriding royalties or other like interests which are carved out of the leasehold estate.

10. That attached hereto and made a part of this Application, marked as Exhibit C, is a tabular listing of the names and addresses of all oil and gas lessees and other oil and gas interest owners owning interest in the unit area and affected sections whose names and addresses Applicant has been able to determine after diligent search and inquiry, which includes lessors, mineral owners and mortgagees of oil and gas

interests of record. Pursuant to existing conventional unitization agreements, the working interests and royalty interests in the entirety of the four governmental sections listed above are entitled to share in the production and proceeds from the subject alternate tract unit, thus are included on said tabular listing as parties in interest in this matter.

11. That Applicant has sent by regular mail a copy of this Application and Notice to all persons listed on the attached Exhibit C.

12. That Applicant is causing the Notice of Pending Application to be published as required by the Commission, in *The Wichita Eagle*, *The Lakin Independent* and *The Ulysses News* newspapers.

13. Therefore, Applicant requests that after due notice the Commission issue its Order providing for the unitization and unit operation of the subject alternate tract unit pursuant to K.S.A. 55-1301, et seq.

WHEREFORE, Applicant prays that the Commission consider this matter pursuant to K.S.A. 77-537 and if no protest or request for hearing is received within fifteen (15) days of notice, the Commission issue its Order providing for the Unitization and the Unit Operation of the subject Alternate Tract Unit comprised of the above described lands, and providing for such other and further provisions and relief as may be deemed appropriate.

By

  
Stanford J. Smith Jr.  
MARTIN, PRINGLE, OLIVER, WALLACE,  
& BAUER, L.L.P.  
100 North Broadway, Suite 500  
Wichita, KS 67202  
*Attorney for Applicant*

VERIFICATION

STATE OF KANSAS )  
 ) ss:  
COUNTY OF SEDGWICK )

Stanford J. Smith, Jr., being of lawful age and being first duly sworn upon his oath, deposes and says:

That he is the attorney for LINN OPERATING, Inc.; he has read the above and foregoing Application and is familiar with the contents and that the statements made therein are true and correct to the best of this knowledge and belief.

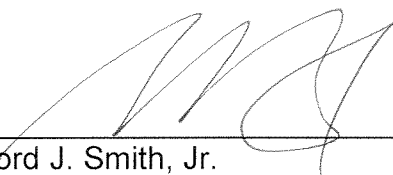
  
\_\_\_\_\_  
Stanford J. Smith, Jr.

SUBSCRIBED AND SWORN to before me this 19th day of March, 2015.

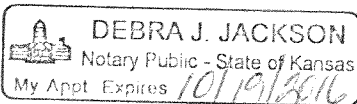

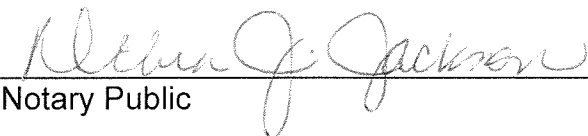
  
\_\_\_\_\_  
Notary Public

My Appointment Expires:  
10/19/2016

**EXHIBIT A**

**UNIT AGREEMENT**

**ALTERNATE TRACT UNIT DESCRIBED AS:**

**SECTION 36-26S-38W (SE/4), SECTION 31-26S-37W (SW/4)**

**KEARNY COUNTY, KANSAS**

**SECTION 06-27S-37W (NW/4), SECTION 01-27S-38W (NE/4)**

**GRANT COUNTY, KANSAS**

**UNIT AGREEMENT**

**ALTERNATE TRACT UNIT DESCRIBED AS:  
SECTION 36-26S-38W (SE/4), SECTION 31-26S-37W (SW/4)  
KEARNY COUNTY, KANSAS  
SECTION 06-27S-37W (NW/4), SECTION 01-27S-38W (NE/4)  
GRANT COUNTY, KANSAS  
TABLE OF CONTENTS  
SECTION PAGE**

Preliminary Recitals 1

**ARTICLE 1  
DEFINITIONS**

1.1	Effective Date
1.2	Oil and Gas Rights
1.3	Outside Substances
1.4	Party
1.5	Royalty Interest
1.6	Royalty Owner
1.7	Tract
1.8	Tract Participation
1.9	Unit Area
1.10	Unit Equipment
1.11	Unit Expense
1.12	Unit Operations
1.13	Unit Operating Agreement
1.14	Unit Operator
1.15	Unit Participation
1.16	Unitized Formation
1.17	Unitized Substances
1.18	Working Interest
1.19	Working Interest Owner

**ARTICLE 2  
EXHIBITS**

2.1	Exhibits
2.1.1	Exhibit A
2.1.2	Exhibits B & B-1
2.2	Reference to Exhibits
2.3	Exhibits Considered Correct
2.4	Correcting Errors
2.5	Filing Revised Exhibits

**ARTICLE 3  
CREATION AND EFFECT OF UNIT**

- 3.1 Oil and Gas Rights Unitized
- 3.2 Personal Property Excepted
- 3.3 Amendment of Leases and Other Agreements
- 3.4 Continuation of Leases and Term Interests
- 3.5 Titles Unaffected by Unitization
- 3.6 Unitized Operation Rights
- 3.7 Development Obligation
- 3.8 Cooperative Agreements

**ARTICLE 4  
PLAN OF OPERATIONS**

- 4.1 Unit Operator
- 4.2 Method of Operation
- 4.3 Change of Method of Operation

**ARTICLE 5  
TRACT PARTICIPATIONS**

- 5.1 Tract Participations
- 5.2 Relative Tract Participations

**ARTICLE 6  
ALLOCATION OF UNITIZED SUBSTANCES**

- 6.1 Allocation to Tracts
- 6.2 Distribution Within Tracts
- 6.3 Taking Unitized Substances in Kind
- 6.4 Failure to Take in Kind
- 6.5 Responsibility for Royalty Settlements
- 6.6 Royalty on Outside Substances

**ARTICLE 7  
PRODUCTION AS OF THE EFFECTIVE DATE**

- 7.1 Unitized Substances
- 7.2 Overproduction

**ARTICLE 8  
USE OR LOSS OF UNITIZED SUBSTANCES**

- 8.1 Use of Unitized Substances
- 8.2 Royalty Payments

**ARTICLE 9  
TITLES**

- 9.1 Warranty and Indemnity

- 9.2 Production Where Title is in Dispute
- 9.3 Payment of Taxes to Protect Title
- 9.4 Transfer of Title

**ARTICLE 10  
EASEMENTS OR USE OF SURFACE**

- 10.1 Grant of Easements
- 10.2 Use of Water
- 10.3 Surface Damages

**ARTICLE 11  
CHANGES AND AMENDMENTS**

- 11.1 Changes and Amendments

**ARTICLE 12  
RELATIONSHIP OF PARTIES**

- 12.1 No Partnership
- 12.2 No Joint Refining or Marketing
- 12.3 Royalty Owners Free of Unit Expense

**ARTICLE 13  
LAWS AND REGULATIONS**

- 13.1 Laws and Regulations
- 13.2 Governing Law

**ARTICLE 14  
FORCE MAJEURE**

- 14.1 Force Majeure

**ARTICLE 15  
EFFECTIVE DATE**

- 15.1 Effective Date
- 15.2 Ipso Facto Termination
- 15.3 Certificate of Effectiveness

**ARTICLE 16  
TERM**

- 16.1 Term
- 16.2 Termination by Unit Operator
- 16.3 Effect of Termination
- 16.4 Salvaging Equipment Upon Termination
- 16.5 Certificate of Termination



**ARTICLE 17  
EXECUTION**

- 17.1 Original, Counterpart, or Other Instrument
- 17.2 Joinder in Dual Capacity

**ARTICLE 18  
DETERMINATIONS BY WORKING INTEREST OWNERS**

- 18.1 Determinations by Unit Operator

**ARTICLE 19  
GENERAL**

- 19.1 Amendments Affecting Unit Operator
- 19.2 Action by Royalty Owners
- 19.3 Lien and Security Interest of Unit Operator
- 19.4 Heading for Convenience
- 19.5 Severability of Provisions

**ARTICLE 20  
SUCCESSORS AND ASSIGNS**

- 20.1 Successors and Assigns

**UNIT AGREEMENT**

**ALTERNATE TRACT UNIT DESCRIBED AS**

**SECTION 36-26S-38W (SE/4), SECTION 31-26S-37W (SW/4)**

**KEARNY COUNTY, KANSAS**

**SECTION 06-27S-37W (NW/4), SECTION 01-27S-38W (NE/4)**

**GRANT COUNTY, KANSAS**

THIS AGREEMENT, entered into as of the \_\_\_\_\_ day of \_\_\_\_\_, 20\_\_\_\_, by the Parties who have consented in writing to be bound hereunder for the conduct of Unit Operations, or so bound by the Order of the Kansas Corporation Commission issued pursuant to the Kansas Statutes Annotated, Section 55-1301, et seq.,

WITNESSETH:

WHEREAS, in the interest of the public welfare and to promote conservation and increase the ultimate recovery of Unitized Substances from the Hugoton Field and Panoma Council Grove Field, in part in Kearny and Grant Counties, Kansas, and to protect the rights of the owners of interests therein, it is deemed necessary and desirable to enter into this Agreement to unitize the Oil and Gas Rights in and to the Unitized Formations in order to conduct Unit Operations as herein provided, pursuant to Kansas Statutes Annotated, Section 55-1301, et seq., or by unanimous approval of all Royalty Owners provided to the Unit Operator as sole Working Interest Owner.

NOW, THEREFORE, in consideration of the premises and of the mutual agreements herein contained, it is agreed as follows:

**ARTICLE 1 DEFINITIONS** as used in this Agreement:

- 1.1 **Effective Date** is the time and date this Agreement becomes effective, as provided in Article 15.1.
- 1.2 **Oil and Gas Rights** are the rights to explore, develop, and operate lands within the Unit Area for the production of Unitized Substances, or to share in the production so obtained or the proceeds thereof.
- 1.3 **Outside Substances** are all substances purchased or otherwise obtained for a consideration by Unit Operator and introduced into the Unitized Formation.
- 1.4 **Party** is any individual, corporation, partnership, association, receiver, trustee, curator, executor, administrator, guardian, tutor, fiduciary, or other representative of any kind, any department, agency, or instrumentality of the state, or any governmental subdivision thereof, or any other entity capable of holding an interest in the Unitized Formation.
- 1.5 **Royalty Interest** is a right to or interest in any portion of the Unitized Substances or proceeds thereof other than a Working Interest.

- 1.6 **Royalty Owner** is a Party hereto who owns a Royalty Interest.
- 1.7 **Tract** is the land described as such and given a tract number in "Exhibit B".
- 1.8 **Tract Participation** is the percentage shown on "Exhibit B" and "Exhibit B-1" for allocating Unitized Substances to a Tract.
- 1.9 **Unit Area** is the land described by Tracts in "Exhibit B" and "Exhibit B-1" and shown on "Exhibit A" as to which this Agreement becomes effective or to which it may be extended as herein provided.
- 1.10 **Unit Equipment** is all personal property, lease and well equipment, plants, and other facilities and equipment taken over or otherwise acquired for the joint account for use in Unit Operations.
- 1.11 **Unit Expense** is all cost, expense, or indebtedness incurred by the Unit Operator as sole Working Interest Owner pursuant to this Agreement and the Unit Operating Agreement for or on account of Unit Operations.
- 1.12 **Unit Operations** are all operations conducted pursuant to this Agreement and the Unit Operating Agreement.
- 1.13 **Unit Operating Agreement** is the agreement entered into by the Working Interest Owner, having the same Effective Date as this Agreement, and entitled "Unit Operating Agreement for Alternate Tract Unit described as Section 36-26S-38W (SE/4), Section 31-26S-37W (SW/4), in Kearny County, Kansas, Section 06-27S-37W (NW/4), Section 01-27S-38W (NE/4), Grant County, Kansas", and with this Agreement constitutes the Plan for Unit Operations.
- 1.14 **Unit Operator** is the sole Working Interest Owner under the Unit Operating Agreement to conduct Unit Operations, but acting as operator and not as Working Interest Owner.
- 1.15 **Unit Participation** of the Unit Operator as the Working Interest Owner is the entirety of the Working Interest singularly held in the Unit Area for Tract Participation of such Tract.
- 1.16 **Unitized Formations** is the subsurface portion of the Unit Area described as the common sources of supply of oil and gas underlying the Unit Area known as the Alternate Tract Unit described as:
- Section 36-26S-38W (SE/4), Section 31-26S-37W (SW/4), Kearny County, Kansas  
Section 06-27S-37W (NW/4), Section 01-27S-38W (NE/4), Grant County, Kansas
- and more specifically identified as the Chase and Council Grove Formations.
- 1.17 **Unitized Substances** are all natural gas, gaseous substances, sulfur and helium contained in gas, and all associated and constituent gaseous hydrocarbons other than Outside Substances within or produced from the Unitized Formation.
- 1.18 **Working Interest** is an interest in Unitized Substances by virtue of a lease, operating agreement, fee title, or otherwise, the owner of which interest is obligated to pay, either in cash or out of production or otherwise, the Unit Expense; however, Oil and Gas Rights that are free of lease or other instrument creating a Working Interest shall be regarded as Working Interest to the extent of seven-eighths (7/8) thereof and a Royalty Interest to the extent of the remaining one-eighth

(1/8) thereof. A Royalty Interest created out of a Working Interest subsequent to the execution of this Agreement by the owner of such Working Interest shall continue to be subject to such Working Interest burdens and obligations that are stated in this Agreement and the Unit Operating Agreement.

1.19 **Working Interest Owner** is the Party hereto who owns the Working Interest.

## **ARTICLE 2 EXHIBITS**

2.1 **Exhibits.** The following exhibits, which are attached hereto, are incorporated herein by reference:

2.1.1 **“Exhibit A”** is a map that shows the boundary lines of the Alternate Tract Unit Area and the Tracts therein.

2.1.2 **“Exhibits B and B-1”** are schedules that describe each Tract in the Alternate Tract Unit Area and shows its Tract Participation by Working Interest and Royalty Interest.

2.2 **Reference to Exhibits.** When reference is made to an exhibit, it is to the exhibit as originally attached or, if revised, to the last revision.

2.3 **Exhibits Considered Correct.** “Exhibit A”, “Exhibit B” and “Exhibit B-1” shall be considered to be correct until revised as herein provided.

2.4 **Correcting Errors.** The shapes and descriptions of the respective Tracts have been established by using the best information available. If it subsequently appears that any Tract, because of diverse Royalty Interest ownership on the Effective Date, should have been divided into more than one Tract, or that any mechanical miscalculation or clerical error has been made, Unit Operator shall correct the mistake by revising the exhibits to conform to the facts. The revision shall not include any re-evaluation of engineering or geological interpretations used in determining Tract Participation. Each such revision of an exhibit made prior to thirty (30) days after the Effective Date shall be effective as of the Effective Date. Each such revision thereafter made shall be effective at 7:00 a.m. on the first day of the calendar month next following the filing for record of the revised exhibit or on such other date as may be determined by Unit Operator and set forth in the revised exhibit.

2.5 **Filing Revised Exhibits.** If an exhibit is revised, Unit Operator shall execute an appropriate instrument stating the effective date for the revised exhibit with the revised exhibit attached stating the effective date for the revised exhibit and file the same with the Kansas Corporation Commission.

## **ARTICLE 3 CREATION AND EFFECT OF UNIT**

3.1 **Oil and Gas Rights Unitized.** All Oil and Gas Rights of Royalty Owners in and to the lands described in “Exhibit B-1”, and all Oil and Gas Rights of the Working Interest Owner in and to said lands, are hereby unitized insofar as the respective Oil and Gas Rights pertain to the Unitized Formations, so that Unit Operations may be conducted with respect to the Unitized Formations as if the Unit Area had been included in a single lease executed by all Royalty Owners, as lessors, in favor of the Working Interest Owner, as lessee, and as if the lease contained all of the provisions of this Agreement.

- 3.2 **Personal Property Excepted.** All lease and well equipment, materials, and other facilities heretofore or hereafter placed by the Working Interest Owner on the lands covered hereby shall be deemed to be and shall remain personal property belonging to and may be removed by the Working Interest Owner.
- 3.3 **Amendment of Leases and Other Agreements.** The provisions of the various leases, agreements, division and transfer orders, or other instruments pertaining to the respective Tracts or the production therefrom are amended to the extent necessary to make them conform to the provisions of this Agreement, but otherwise shall remain in full force and effect. Royalty Owners agree that any default, forfeiture, or penalty provision in any such oil and gas lease or other contract shall be suspended and of no force or effect during the term of this Agreement.
- 3.4 **Continuation of Leases and Term Interests.** Production from any part of the Unitized Formations, except for the purpose of determining payments to Royalty Owners, or other Unit Operations shall be considered as production from or operations upon each Tract, and such production or operations shall continue in effect each lease or term mineral or royalty interest as to all lands and formations covered thereby just as if such operations were conducted on and as if a well were producing from each Tract.
- 3.5 **Titles Unaffected by Unitization.** Nothing herein shall be construed to result in the transfer of title to Oil and Gas Rights by any Party to any other Party or to Unit Operator.
- 3.6 **Unitized Operation Rights.** Royalty Owners hereby grant the Working Interest Owner the right to conduct unitized management, operation and further development of the Unitized Formations as economically feasible and reasonably necessary to prevent the waste of Unitized Substances in the Unitized Formations and thereby substantially increase the ultimate recovery of Unitized Substances therefrom, together with the right to drill, use, and maintain injection wells on the Unit Area, and to use for injection purposes any nonproducing or abandoned wells or dry holes, and any producing wells completed in the Unitized Formation.
- 3.7 **Development Obligation.** Nothing herein shall relieve the Working Interest Owner from any obligation to reasonably develop the lands and leases committed hereto, except as the same may conflict with the provisions hereof and Unit Operations which may be conducted hereunder.
- 3.8 **Cooperative Agreements.** Unit Operator may enter into cooperative agreements with respect to lands adjacent to the Unit Area for the purpose of coordinating operations.

#### **ARTICLE 4 PLAN OF OPERATIONS**

- 4.1 **Unit Operator.** LINN OPERATING, Inc. is hereby designated as the Unit Operator. Unit Operator shall have the exclusive right to conduct Unit Operations, which shall conform to the provisions of this Agreement and the Unit Operating Agreement. If there is any conflict between such Agreements, this Agreement shall govern.
- 4.2 **Method of Operation.** To the end that the quantity of Unitized Substances ultimately recoverable may be increased and waste prevented, the Working Interest Owner shall, with diligence and in accordance with good engineering and production practices, engage in unitized management, operation and further development of the Unitized Formations to efficiently and economically increase the ultimate recovery of Unitized Substances.

- 4.3 **Change of Method of Operation.** Nothing herein shall prevent the Working Interest Owner from discontinuing or changing in whole or in part any method of operation which, in their opinion, is no longer appropriate or in accord with good engineering or production practices. Other methods of operation may be conducted or changes may be made by the Working Interest Owner from time to time if determined by them to be feasible, necessary, or desirable to increase the ultimate recovery of Unitized Substances, consistent with Kansas Statutes Annotated, Section 55-1304(a)(2).

## ARTICLE 5 TRACT PARTICIPATIONS

- 5.1 **Tract Participations.** The Tract Participations of each Tract are shown on “Exhibit B” and “Exhibit B-1”. The Tract Participations as shown in said Exhibits are accepted and approved by the approving Parties hereto as being fair and equitable. The Unitized Substances produced from the Alternate Tract Unit Well drilled hereunder shall be allocated among the Parties according to the respective Tract Participations.
- 5.2 **Relative Tract Participations.** If the Unit Area is enlarged or reduced, the revised Tract Participations of the Tracts remaining in the Unit Area and which were within the Unit Area prior to the enlargement or reduction shall remain in the same ratio one to another.

## ARTICLE 6 ALLOCATION OF UNITIZED SUBSTANCES

- 6.1 **Allocation to Tracts.** All Unitized Substances produced and saved shall be allocated to the several Tracts in accordance with the respective Tract Participations effective during the period that the Unitized Substances were produced. The amount of Unitized Substances allocated to each Tract, regardless of whether the amount is more or less than the actual production of Unitized Substances from the Alternate Tract Unit Well shall be deemed for all purposes to have been produced from such Tract.
- 6.2 **Distribution Within Tracts.** The Unitized Substances allocated to each Tract shall be distributed among, or accounted for to, the Parties entitled to share in the production from such Tract in the same manner, in the same proportions, and upon the same conditions as they would have participated and shared in the production from such Tract, or in the proceeds thereof, had this Agreement not been entered into, and with the same legal effect. If any Oil and Gas Rights in a Tract hereafter become divided and owned in severalty as to different parts of the Tract, the owners of the divided interests, in the absence of an agreement providing for a different division, shall share in the Unitized Substances allocated to the Tract, or in the proceeds thereof, in proportion to the surface acreage of their respective parts of the Tract.
- 6.3 **Taking Unitized Substances in Kind.** The Unitized Substances allocated to each Tract shall be delivered in kind to the respective Parties entitled thereto by virtue of the ownership of Oil and Gas Rights therein or by purchase from such owners. Such Parties shall have the right to construct, maintain, and operate within the Unit Area all necessary facilities for that purpose, provided they are so constructed, maintained, and operated as not to interfere with Unit Operations. Any extra expenditures incurred by Unit Operator by reason of the delivery in kind of any portion of Unitized Substances shall be borne by the owner of such portion of Unitized Substances.

- 6.4 **Failure to Take in Kind.** If any Party fails to take in kind or separately dispose of such Party's share of Unitized Substances, Unit Operator shall have the right, but not the obligation, for the time being and subject to revocation at will by the Party owning the share, to purchase or sell to others such share; however, all contracts of sale by Unit Operator of any other Party's share of Unitized Substances shall be only for such reasonable periods of time as are consistent with the minimum needs of the industry under the circumstances, but in no event shall any such contract be for a period in excess of one (1) year. The proceeds of the Unitized Substances so disposed of by Unit Operator shall be paid to the Parties entitled thereto.
- 6.5 **Responsibility for Royalty Settlements.** Unit Operator shall be responsible for the payment of all royalties, overriding royalties, production payments and all other payments chargeable against or payable out of the proceeds from the sale of Unitized Substances, and shall indemnify all Parties hereto against any liability for such payment.
- 6.6 **Royalty on Outside Substances.** Unit Operator does not anticipate the injection of Outside Substance, consisting of natural gases or otherwise, into the Unitized Formation. In any event, no payment shall be due or payable to Royalty Owners on substances produced from the Unitized Formation that are deemed to be Outside Substances.

#### **ARTICLE 7 PRODUCTION AS OF THE EFFECTIVE DATE**

- 7.1 **Unitized Substances.** Unit Operator shall pay royalty due hereunder on produced Unitized Substances after the Effective Date according to Tract Participation.
- 7.2 **Overproduction.** If, as of the Effective Date, any Tract is subject to a regulatory constraint on its gas allowable and is overproduced with respect to said allowable of the wells on that Tract, and if the amount of overproduction has been sold or otherwise disposed of, such overproduction shall be regarded as a part of the Unitized Substances produced after the Effective Date and shall be charged to such Tract as having been delivered to the Parties entitled to Unitized Substances allocated to such Tract.

#### **ARTICLE 8 USE OR LOSS OF UNITIZED SUBSTANCES**

- 8.1 **Use of Unitized Substances.** Unit Operator may use or consume Unitized Substances for Unit Operations, including but not limited to the injection thereof into the Unitized Formation.
- 8.2 **Royalty Payments.** No royalty, overriding royalty, production, or other payments shall be payable on account of Unitized Substances used, lost, or consumed in Unit Operations.

#### **ARTICLE 9 TITLES**

- 9.1 **Warranty and Indemnity.** Each Person who, by acceptance of produced Unitized Substances or the proceeds thereof, may claim to own a Working Interest or Royalty Interest in and to any Tract or in the Unitized Substances allocated thereto, shall be deemed to have warranted its title to such interest, and, upon receipt of the Unitized Substances or the proceeds thereof to the credit of such interest, shall indemnify and hold harmless all other Persons in interest from any loss due to failure, in whole or in part, of its title to any such interest.

9.2 **Production Where Title is in Dispute.** If the title or right of any Party claiming the right to receive in kind all or any portion of the Unitized Substances allocated to a Tract is in dispute, Unit Operator shall either:

- (a) require that the Party to whom such Unitized Substances are delivered or to whom the proceeds thereof are paid furnish security for the proper accounting therefor to the rightful owner if the title or right of such Party fails in whole or in part, or
- (b) withhold and market the portion of Unitized Substances with respect to which title or right is in dispute, and impound the proceeds thereof until such time as the title or right thereto is established by a final judgment of a court of competent jurisdiction or otherwise, whereupon the proceeds so impounded shall be paid to the Party rightfully entitled thereto.

9.3 **Payment of Taxes to Protect Title.** The owner of surface rights to lands within the Unit Area, or severed mineral interests or Royalty Interests in such lands, or lands outside the Unit Area on which Unit Equipment is located, is responsible for the payment of any ad valorem taxes on all such rights, interests, or property, unless such owner and Working Interest Owners otherwise agree. If any ad valorem taxes are not paid by or for such owner when due, Unit Operator may, at any time prior to tax sale or expiration of period of redemption after tax sale, pay the tax, redeem such rights, interests, or property, and discharge the tax lien.

Any such payment shall be an item of Unit Expense. Unit Operator shall, if possible, withhold from any proceeds derived from the sale of Unitized Substances otherwise due any delinquent taxpayer an amount sufficient to defray the cost of such payment or redemption, such withholding to be credited to the Unit Operator as the Working Interest Owner. Such withholding shall be without prejudice to any other remedy available to Unit Operator as the Working Interest Owner.

9.4 **Transfer of Title.** Any conveyance of all or any part of any interest owned by any Party hereto with respect to any Tract shall be made expressly subject to this Agreement. No change of title shall be binding upon Unit Operator, or upon any Party hereto other than the Party so transferring, until 7:00 a.m. on the first day of the calendar month next succeeding the date of receipt by Unit Operator of a certified copy of the recorded instrument evidencing such change in ownership.

## ARTICLE 10 EASEMENTS OR USE OF SURFACE

10.1 **Grant of Easements.** Unit Operator shall have the right to use as much of the surface of the land within the Unit Area as may be reasonably necessary for Unit Operations and the removal of Unitized Substances from the Unit Area; however, nothing herein shall be construed as leasing or otherwise conveying to Unit Operator a campsite or a plant site for water injection, gas injection, or gas processing.

10.2 **Use of Water.** Unit Operator shall have and is hereby granted free use of non-potable water from the Unit Area for Unit Operations, except water from any well, lake, pond, or irrigation ditch of a Royalty Owner. Unit Operator may convert dry or abandoned wells in the Unit Area for use as water supply or disposal wells.

10.3 **Surface Damages.** Unit Operator shall pay the surface owner for damages to growing crops, timber, fences, improvements, and structures on the Unit Area that result from Unit Operations.



**ARTICLE 11  
CHANGES AND AMENDMENTS**

- 11.1 **Changes and Amendments.** Any change of the Unit Area or any amendment to this Agreement or the Unit Operating Agreement shall be in accordance with Kansas Statutes Annotated, Section 55-1301, et seq., unless such change or amendment is approved in writing by all Royalty Owners.

**ARTICLE 12  
RELATIONSHIP OF PARTIES**

- 12.1 **No Partnership.** The duties, obligations, and liabilities of the Parties hereto are intended to be several and not joint or collective. This Agreement is not intended to create, and shall not be construed to create, an association or trust, or to impose a partnership duty, obligation, or liability with regard to anyone or more of the Parties hereto. Each Party hereto shall be individually responsible for its own obligations as herein provided.
- 12.2 **No Joint Refining or Marketing.** This Agreement is not intended to provide, and shall not be construed to provide, directly or indirectly, for any joint refining or marketing of Unitized Substances.
- 12.3 **Royalty Owners Free of Unit Expense.** This Agreement shall not be construed to impose upon any Royalty Owner any obligation to pay Unit Expense unless such Royalty Owner is otherwise so obligated.

**ARTICLE 13  
LAWS AND REGULATIONS**

- 13.1 **Laws and Regulations.** This Agreement shall be subject to all applicable federal, state, and municipal laws, rules, regulations, and orders.
- 13.2 **Governing Law.** This Agreement and all matters pertaining hereto, including but not limited to matters of performance, non-performance, breach, remedies, procedures, rights, duties, and interpretation or construction, shall be governed and determined by the laws of the state in which the Unit Area is located.

**ARTICLE 14  
FORCE MAJEURE**

- 14.1 **Force Majeure.** If any Party is rendered unable, wholly or in part, by reason of force majeure to carry out its obligations under this Agreement, other than the obligation to make money payments that Party shall give to all other Parties prompt written notice of the force majeure with reasonably full particulars concerning the force majeure. Thereupon, the obligations of the Party giving the notice, so far as they are affected by the force majeure, shall be suspended during, but no longer than, the continuance of the force majeure. The affected Party shall use all reasonable diligence to remove the force majeure situation as quickly as practicable, but neither this Agreement nor any lease or other instrument subject hereto shall be terminated by reason of the suspension of Unit Operations due to the occurrence of any event(s) of force majeure. The requirement that any force majeure shall be remedied with all reasonable dispatch shall not require the settlement of strikes, lockouts, or other labor difficulty by the Party contrary to its wishes, and the manner in which all such difficulties shall be handled shall be entirely within the discretion of the Party concerned. The term "force majeure," as here employed, shall mean any

act of God, strike, lockout, or other industrial disturbance, act of the public enemy, war, blockage, public riot, lightning, fire, storm, flood, explosion, governmental laws, rules, regulations, orders, action, delay, restraint or inaction, unavailability of equipment, or inability to secure materials, or any other cause, whether of the kind specifically enumerated above or otherwise, which is not reasonably within the control of the Party claiming suspension.

## **ARTICLE 15 EFFECTIVE DATE**

- 15.1 **Effective Date.** This Agreement shall become effective as of the date the Kansas Corporation Commission issues its Order approving this Unit Agreement for the subject Alternate Tract Unit; provided, however, in the event that this Agreement has been approved in writing by all Royalty Owners, all provisions of this Agreement pertaining to Regulatory approval shall be considered deleted.
- 15.2 **Ipso Facto Termination.** If this Alternate Tract Unit is not made effective within six (6) months after the date of issuance of the Order of the Kansas Corporation Commission approving same, because prior thereto Working Interest Owners owning a combined Unit Participation of at least seventy-five percent (75%) have not become Parties to this Agreement, this Agreement shall ipso facto terminate on that date (hereinafter called "termination date") and thereafter be of no further effect. If the Unit Operator seeks from the Commission for good cause an extension of the termination date for a period not to exceed two (2) months, and the termination date is so extended, but this unit is not made effective on or before the extended termination date, this Agreement shall ipso facto terminate on the extended termination date and thereafter be of no further effect. For the purpose of this Section, Unit Participation shall be as calculated on the basis of Tract Participations shown on the original "Exhibit B" and "Exhibit B-1."
- 15.3 **Certificate of Effectiveness.** Upon this unit going into effect, the Unit Operator shall promptly file with the Kansas Corporation Commission a certificate stating the Effective Date.

## **ARTICLE 16 TERM**

- 16.1 **Term.** The term of this Agreement, unless sooner terminated in the manner hereinafter provided, shall be for and during the time that Unitized Substances are produced in paying quantities without a cessation of more than ninety (90) consecutive days, or so long as other Unit Operations are conducted without a cessation of more than ninety (90) consecutive days.
- 16.2 **Termination by Unit Operator.** This Agreement may be terminated by the Unit Operator as the Working Interest Owner with Unit Participation of one hundred percent (100%) whenever the Unit Operator determines that Unit Operations are no longer profitable or feasible.
- 16.3 **Effect of Termination.** Upon termination of this Agreement, the further development and operation of the Unitized Formation as a unit shall be abandoned, and Unit Operations shall cease. Each oil and gas lease and other agreement covering lands within the Unit Area shall remain in force for sixty (60) days after the date on which this Agreement terminates, and for such further period as is provided by the lease or other agreement.
- 16.4 **Salvaging Equipment Upon Termination.** If not otherwise granted by the leases or other instruments affecting the separate Tracts, Unit Operator shall have a period of six (6) months after the date of termination of this Agreement within which to salvage and remove Unit Equipment.

- 16.5 **Certificate of Termination.** Upon termination of this Agreement, Unit Operator shall submit to the Kansas Corporation Commission a certificate stating that this Agreement has terminated, stating its termination date.

#### **ARTICLE 17 EXECUTION**

- 17.1 **Original, Counterpart, or Other Instrument.** An owner of Oil and Gas Rights may approve this Agreement by signing the original, a counterpart thereof, or other instrument approving this Agreement. The signing of any such instrument shall have the same effect as if all Persons had signed the same instrument and shall constitute approval of the entire Plan composed of this Agreement and the Unit Operating Agreement.
- 17.2 **Joinder in Dual Capacity.** Execution as herein provided by any Party as either the Working Interest Owner or a Royalty Owner shall commit all interests owned or controlled by such Party.

#### **ARTICLE 18 DETERMINATIONS BY WORKING INTEREST OWNERS**

- 18.1 **Determinations by Unit Operator.** All decisions, determinations, or approvals by Unit Operator shall be made pursuant to this Agreement and consistent with the Unit Operating Agreement, as may be applicable, unless otherwise provided herein.

#### **ARTICLE 19 GENERAL**

- 19.1 **Amendments Affecting Unit Operator.** Amendments hereto relating wholly to Unit Operator may be made at Unit Operator's sole discretion with a vote of Royalty Owners unless otherwise provided herein.
- 19.2 **Action by Royalty Owners.** Except as otherwise provided in this Agreement, any action or approval required by Royalty Owners hereunder shall be in accordance with the provisions of this Agreement and the Unit Operating Agreement, as may be applicable.
- 19.3 **Lien and Security Interest of Unit Operator.** Whereas Unit Operator is the sole Working Interest Owner, Unit Operator shall have a lien upon and a security interest in the interests of the Royalty Owners in the Unit Area only to any extent provided by law.
- 19.4 **Headings for Convenience.** Except for the headings contained in Article 1, the headings and table of contents used in this Agreement are inserted for convenience only and shall be disregarded in construing this Agreement.
- 19.5 **Severability of Provisions.** The provisions of this Agreement are severable and if any section, sentence, clause or part thereof is held to be invalid for any reason, such invalidity shall not be construed to affect the validity of the remaining provisions of this Agreement.

**ARTICLE 20**  
**SUCCESSORS AND ASSIGNS**

- 20.1 **Successors and Assigns.** This Agreement shall extend to, be binding upon, and inure to the benefit of the Parties hereto and their respective heirs, devisees, legal representatives, successors, and assigns, and shall constitute a covenant running with the lands, leases, and interests covered hereby.

“EXHIBIT A”  
TO  
UNIT AGREEMENT  
ALTERNATE TRACT UNIT DESCRIBED AS:  
SECTION 36-26S-38W (SE/4), SECTION 31-26S-37W (SW/4)  
KEARNY COUNTY, KANSAS  
SECTION 06-27S-37W (NW/4), SECTION 01-27S-38W (NE/4)  
GRANT COUNTY, KANSAS

MAP OR PLAT OF UNIT AREA

Showing:

1. Outline of Alternate Tract Unit Area delineated by heavy or hatched line.
2. Tract boundary lines as defined by section boundary lines and Outline of Unit Area.
3. Sections, townships ranges, surveys blocks, lots, etc. as applicable, with applicable legend.
4. Wells completed in the Unitized Formations and general location of proposed Alternate Tract Unit Well.

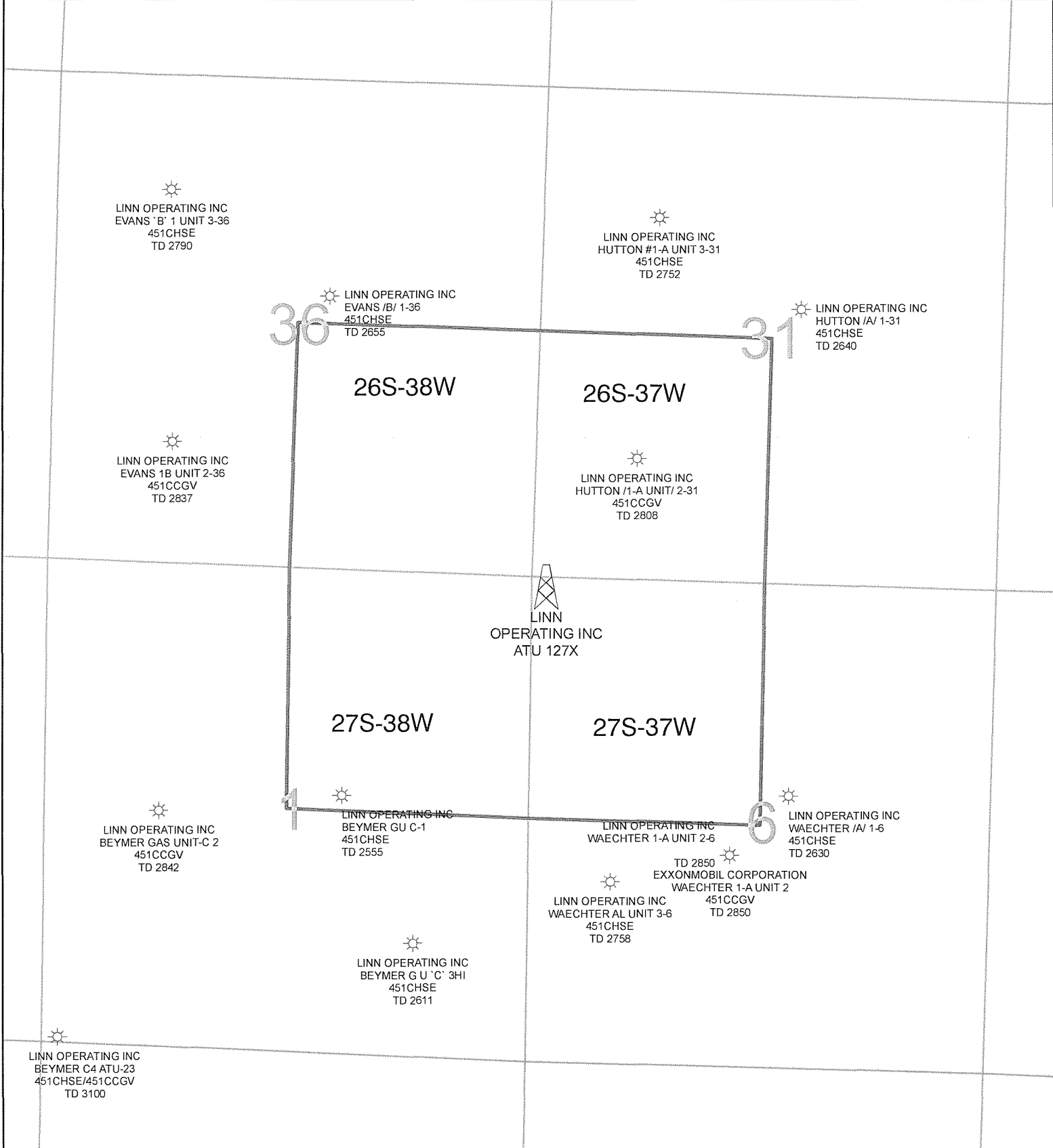

☀  
 LINN OPERATING INC  
 EVANS 'B' 1 UNIT 3-36  
 451CHSE  
 TD 2790

☀  
 LINN OPERATING INC  
 HUTTON #1-A UNIT 3-31  
 451CHSE  
 TD 2752

☀  
 LINN OPERATING INC  
 EVANS /B/ 1-36  
 451CHSE  
 TD 2655

☀  
 LINN OPERATING INC  
 HUTTON /A/ 1-31  
 451CHSE  
 TD 2640

☀  
 LINN OPERATING INC  
 EVANS 1B UNIT 2-36  
 451CCGV  
 TD 2837

☀  
 LINN OPERATING INC  
 HUTTON /1-A UNIT/ 2-31  
 451CCGV  
 TD 2808

⚙  
 LINN  
 OPERATING INC  
 ATU 127X

27S-38W

27S-37W

☀  
 LINN OPERATING INC  
 BEYMER GAS UNIT-C 2  
 451CCGV  
 TD 2842

☀  
 LINN OPERATING INC  
 BEYMER GU C-1  
 451CHSE  
 TD 2555

☀  
 LINN OPERATING INC  
 WAECHTER 1-A UNIT 2-6  
 TD 2850

☀  
 LINN OPERATING INC  
 WAECHTER /A/ 1-6  
 451CHSE  
 TD 2630

☀  
 EXXONMOBIL CORPORATION  
 WAECHTER 1-A UNIT 2  
 451CCGV  
 TD 2850

☀  
 LINN OPERATING INC  
 WAECHTER AL UNIT 3-6  
 451CHSE  
 TD 2758

☀  
 LINN OPERATING INC  
 BEYMER G U 'C' 3H1  
 451CHSE  
 TD 2611

☀  
 LINN OPERATING INC  
 BEYMER C4 ATU-23  
 451CHSE/451CCGV  
 TD 3100

- ⚙ DERRICKS
- ☀ GAS
- ☀ GAS-WO

**LINN OPERATING INC**  
**HUGOTON KANSAS**

ATU 127X

Kearny / Grant Counties

26S-38/37W / 27S-38/37W

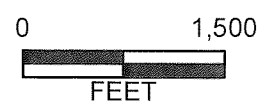

"EXHIBIT B"  
 TO  
 UNIT AGREEMENT  
 ALTERNATE TRACT UNIT DESCRIBED AS:  
 SECTION 36-26S-38W (SE/4), SECTION 31-26S-37W (SW/4)  
 KEARNY COUNTY, KANSAS  
 SECTION 06-27S-37W (NW/4), SECTION 01-27S-38W (NE/4)  
 GRANT COUNTY, KANSAS

TRACTS AND TRACT PARTICIPATION

WORKING INTEREST:

Tract No.	Tract Operator	Description	Acres	Tract Participation Percentages
1	LINN OPERATING, Inc.	SECTION 36-26S-38W (SE/4)	160	25.00%
2	LINN OPERATING, Inc.	SECTION 31-26S-37W (SW/4)	160	25.00%
3	LINN OPERATING, Inc.	SECTION 06-27S-37W (NW/4)	160	25.00%
4	LINN OPERATING, Inc.	SECTION 01-27S-38W (NE/4)	160	25.00%
		<b>Total</b>	<b>640</b>	<b>100.00%</b>

ROYALTY INTEREST:

SEE ATTACHED "EXHIBIT B-1": ALTERNATE TRACT UNIT DESCRIBED AS:  
 SECTION 36-26S-38W (SE/4), SECTION 31-26S-37W (SW/4)  
 IN KEARNY COUNTY, KANSAS  
 SECTION 06-27S-37W (NW/4), SECTION 01-27S-38W (NE/4)  
 IN GRANT COUNTY, KANSAS  
 ROYALTY INTEREST PARTICIPATION

NOTE: The royalty interests listed on Exhibit B-1 include all royalty interests in the four sections contributing acreage to the ATU, since existing communitization agreements require royalties to be paid by proportionate allocation to all royalty interests in said sections according to respective royalty interest in the ATU and thus said interests have been given the right to consent to the formation of the ATU, and further, have been given notice of filing and hearing on this Application to form said ATU pursuant to K.S.A. 55-1301, et seq.

"Exhibit B-1"  
Proposed Alternate Tract Unit  
Section 36-26S-38W (SE/4), Section 31-26S-37W (SW/4)  
Kearny County, Kansas  
Section 06-27S-37W (NW/4), Section 01-27S-38W (NE/4)  
Grant County, Kansas

Owner Name	Address	City	State	Zip Code	Interest Type	Section 36	Section 31	Section 06	Section 01	Total	Allocation	Date ATU Signed	% ATU Signed	STR
J B STODDARD ESTATE	4145 TRAVIS ST SUITE 101	DALLAS	TX	75204-1840	R	0.000938				0.00093800	0.187600%	12/31/2014	0.187600%	Sec 36-26S-38W
JAMES J HEUTEL	PO BOX 12254	DALLAS	TX	75225-0000	R	0.000282				0.00028200	0.056400%	12/31/2014	0.056400%	Sec 36-26S-38W
SALZAU 1	6125 WESTWICK	DALLAS	TX	75205-0000	R	0.000938				0.00093800	0.187600%			Sec 36-26S-38W
CHARLES R GRUYE &	9886 STERLING RIDGE RD	SCOTTSDALE	AZ	85262-0000	R	0.00075				0.00075000	0.150000%			Sec 36-26S-38W
JAMES L WELCH	12225 GREENVILLE AVE STE #950	DALLAS	TX	75243-9362	R	0.000378				0.00037600	0.075200%			Sec 36-26S-38W
HARRY B HEUTEL TRUST	JAMES HEUTEL TTEE 3621 TURTLE CREEK BLVD #9A	DALLAS	TX	75219-0000	R	0.000282				0.00028200	0.056400%	12/30/2014	0.056400%	Sec 36-26S-38W
MAP MRP	PO BOX 269031	OKLAHOMA CITY	OK	73126-9031	R	0.00835283				0.00835283	1.670566%	1/5/2014	1.670566%	Sec 36-26S-38W
MAP HOLDINGS	101 N ROBINSON STE. 1000	OKLAHOMA CITY	OK	73102-5514	R	0.00014062				0.00014062	0.028124%	1/5/2014	0.028124%	Sec 36-26S-38W
KANSAS ROYALTY HOLDINGS	705 SUNSET HILL DRIVE	ROCKWALL	TX	75087-0000	R	0.00027				0.00027000	0.054000%			Sec 36-26S-38W
MAP2004-OK	PO BOX 269031	OKLAHOMA CITY	OK	73126-9031	R	0.00305126				0.00305126	0.610252%			Sec 36-26S-38W
SHADED LAZY H LLC	7603 S RD E	ULYSSES	KS	67880-0000	R	0.031248				0.03124800	6.249600%	1/2/2015	6.249600%	Sec 36-26S-38W
CHARLES GRAHAM LOWE MRTL T	120 E CONSTITUTION ST	VICTORIA	TX	77901-8137	R	0.00251729				0.00251729	0.503458%			Sec 36-26S-38W
REBECCA L SCIBA	23421 S GATEWAY LN	CHENEY	WA	99004-0000	R	0.0041665				0.00416650	0.833300%	1/7/2015	0.833300%	Sec 36-26S-38W
CROWE REV LIV TR	4033 SWEETBERRY DR	NASHVILLE	TN	37211-4599	R	0.0041665				0.00416650	0.833300%			Sec 36-26S-38W
SCOTT ALLEN CROWE IRREV TR	4033 SWEETBERRY DR	NASHVILLE	TN	37211-4599	R	0.002083				0.00208300	0.416600%			Sec 36-26S-38W
CLARKSONS GROUP	12225 GREENVILLE AVE 950	DALLAS	TX	75243-9362	R	0.001126				0.00112600	0.225200%			Sec 36-26S-38W
ARKOMA BASIN MINERALS INC	203 EAST INTERSTATE 30	ROCKWALL	TX	75087-0000	R	0.000875				0.00087500	0.175000%	12/29/2014	0.175000%	Sec 36-26S-38W
EXXONMOBIL OIL CORP-XTO	810 HOUSTON ST	FORT WORTH	TX	76102-0000	R	0.062499				0.06249900	12.499800%	8/7/2014	12.499800%	Sec 36-26S-38W
CHESAPEAKE EXPLORATION LLC	PO BOX 960161	OKLAHOMA CITY	OK	73196-0161	R	0.000938				0.00093800	0.187600%			Sec 36-26S-38W
GARY C BEYMER	BOX 817	LAKIN	KS	67860-0000	R		0.001715			0.00171500	0.343000%	7/7/2014 12/30/2014	0.343000%	Sec 31-26S-37W
CEB INC	ROBERT BEYMER - PRESIDENT PO BOX 363	LAKIN	KS	67860-0000	R		0.003431			0.00343100	0.686200%	12/29/2014	0.686200%	Sec 31-26S-37W
FLYING T CATTLE COMPANY INC	PO BOX 69	LAKIN	KS	67860-0000	R		0.005831			0.00583100	1.166200%	1/2/2015	1.166200%	Sec 31-26S-37W
STEPHEN MCCORMICK FAM TRUS	PO BOX 406	SOUTHFORK	CO	81154-0000	R		0.003221			0.00322100	0.644200%			Sec 31-26S-37W
TATE FAMILY TR	PO BOX 69	LAKIN	KS	67860-0000	R		0.0036595			0.00365950	0.731900%	1/2/2015	0.731900%	Sec 31-26S-37W



"Exhibit B-1"  
Proposed Alternate Tract Unit  
Section 36-26S-38W (SE/4), Section 31-26S-37W (SW/4)  
Kearny County, Kansas  
Section 06-27S-37W (NW/4), Section 01-27S-38W (NE/4)  
Grant County, Kansas

TATE FAMILY TR	PO BOX 69	LAKIN	KS	67860-0000	R	0.003697	0.00369700	0.739400%	1/2/2015	0.739400%	Sec 31-26S-37W
BAT MINERALS LLC	PO BOX 69	LAKIN	KS	67860-0000	R	0.004136	0.00413600	0.827200%	1/2/2015	0.827200%	Sec 31-26S-37W
GHT MINERALS LLC	PO BOX 69	LAKIN	KS	67860-0000	R	0.0036595	0.00365950	0.731900%	1/2/2015	0.731900%	Sec 31-26S-37W
GHT MINERALS LLC	PO BOX 69	LAKIN	KS	67860-0000	R	0.003697	0.00369700	0.739400%	1/2/2015	0.739400%	Sec 31-26S-37W
FRANKLIN LELAND BAKER	9831 LAUREL HOLLOW CIR	GERMANTOWN	TN	38139-0000	R	0.001372	0.00137200	0.274400%			Sec 31-26S-37W
JULIE BAKER COLETTA	10253 PEYTON PATH CV	COLLIERVILLE	TN	38017-0000	R	0.001372	0.00137200	0.274400%			Sec 31-26S-37W
EMERALD LODGE AF & AM #289	PO BOX 864	LAKIN	KS	67860-0000	R	0.014781	0.01478100	2.956200%			Sec 31-26S-37W
LV FARMS A PRTNSH	PO BOX C	LAKIN	KS	67860-0450	R	0.003698	0.00369800	0.739600%			Sec 31-26S-37W
E NORBERT GARRETT	10 KINGWOOD RD	WEST ORANGE	NJ	70523-1110	R	0.00823	0.00823000	1.646000%	12/30/2014	1.646000%	Sec 31-26S-37W
EXXONMOBIL OIL CORP-XTO	810 HOUSTON ST	FORT WORTH	TX	76102-0000	R	0.0625	0.06250000	12.500000%	8/7/2014	12.500000%	Sec 31-26S-37W
MERLE K HEEKE EXPTION	3250 TORO CR	COLORADO SPRINGS	CO	80918-2244	R	0.00279532	0.00279532	0.559064%	12/30/2014	0.559064%	Sec 6-27S-37W
MERLE K HEEKE EXPTION	3250 TORO CR	COLORADO SPRINGS	CO	80918-2244	R	0.00007181	0.00007181	0.014362%	12/30/2014	0.014362%	Sec 6-27S-37W
PADDACK HILL FARM LLC	PO BOX 274	LAKIN	KS	67860-0274	R	0.005877	0.00587700	1.175400%	7/8/2014 1/7/2015	1.175400%	Sec 6-27S-37W
DONALD NEFF	RR 1 BOX 4	LAKIN	KS	67860-9800	R	0.011753	0.01175300	2.350600%	8/8/2014	2.350600%	Sec 6-27S-37W
VERNON M NEFF	BOX 426	LAKIN	KS	67860-0426	R	0.005877	0.00587700	1.175400%			Sec 6-27S-37W
LAURA M HEEKE LIV TR	2112 N TEJON ST	COLORADO SPRINGS	CO	80907-6938	R	0.00558187	0.00558187	1.116374%	7/9/2014 1/8/2015	1.116374%	Sec 6-27S-37W
FREDA M MCVEY	1650 N 1ST	SEWARD	NE	68434-6007	R	0.005582	0.00558200	1.116400%	7/25/2014 1/6/2015	1.116400%	Sec 6-27S-37W
LETCHER R WAECHTER	805 N JOYCE ST	ULYSSES	KS	67880-8408	R	0.02038	0.02038000	4.076000%	7/23/2014 12/22/2014	4.076000%	Sec 6-27S-37W
HAROLD K AND RITA F WAECHTER	JOINT TENANTS WROS PMB 232 4713 OREGON TRAIL	AMARILLO	TX	79109-5919	R	0.007016	0.00701600	1.403200%	7/10/2014 12/19/2014	1.403200%	Sec 6-27S-37W
ELSIE I NEFF TR DTD 3/25/77	PO BOX 1024	DURANGO	CO	81302-1024	R	0.011753	0.01175300	2.350600%	7/9/2014 12/13/2014	2.350600%	Sec 6-27S-37W
WALTER E WAECHTER	252 ROAD H	ULYSSES	KS	67880-5313	R	0.005582	0.00558200	1.116400%			Sec 6-27S-37W
JANE COLE MASSEY TRUST	C/O TOM NEFF 100 INDEPENDENCE PL STE 307	TYLER	TX	75703-0000	R	0.011753	0.01175300	2.350600%	7/3/2014 12/23/2014	2.350600%	Sec 6-27S-37W
RUBART INVESTMENTS LP	921 N SULLIVAN ST	ULYSSES	KS	67880-1619	R	0.015489	0.01548900	3.097800%	12/30/2014	3.097800%	Sec 6-27S-37W
EXXONMOBIL OIL CORP-XTO	810 HOUSTON ST	FORT WORTH	TX	76102-0000	R	0.015489	0.01548900	3.097800%	8/7/2014	3.097800%	Sec 6-27S-37W
C EASTON BEYMER	898 FIRE AGATE DR	BOULDER CITY	NV	89005-1219	R		0.00130310	0.260620%	7/7/2014	0.260620%	Sec 1-27S-38W

"Exhibit B-1"  
Proposed Alternate Tract Unit  
Section 36-26S-38W (SE/4), Section 31-26S-37W (SW/4)  
Kearny County, Kansas  
Section 06-27S-37W (NW/4), Section 01-27S-38W (NE/4)  
Grant County, Kansas

DEANNE LEE HUSTED	2360 MEDALLIAN WAY	LODI	CA	95242	R				0.00195460	0.00195460	0.390920%			Sec 1-27S-38W	
DONALD NEFF	ROUTE 1 BOX 4	LAKIN	KS	67860	R				0.01073850	0.01073850	2.147700%	8/8/2014	2.147700%	Sec 1-27S-38W	
ELSIE I NEFF, TRUST	ELSIE I NEFF TISA SHARI NEFF AND BYRON JAY NEFF TRUSTEES PO BOX 1024	DURANGO	CO	81302	R				0.01073860	0.01073860	2.147720%	7/9/2014 12/13/2014	2.147720%	Sec 1-27S-38W	
EXXONMOBIL OIL CORPORATION	C/O XTO ENERGY INC PO BOX 731917	DALLAS	TX	75373	R				0.01939930	0.01939930	3.879860%	8/7/2014	3.879860%	Sec 1-27S-38W	
FREDA MCVEY	1650 N 1ST	SEWARD	NE	68434	R				0.00934250	0.00934250	1.868500%	7/25/2014 1/6/2015	1.868500%	Sec 1-27S-38W	
GARY C BEYMER	PO BOX 817	LAKIN	KS	67860	R				0.00130310	0.00130310	0.260620%	7/7/2014 12/30/2014	0.260620%	Sec 1-27S-38W	
HAROLD K AND RITA F WAECHTER	JOINT TENANTS WROS PMB 232 4713 OREGON TRAIL	AMARILLO	TX	79109-5919	R				0.01009420	0.01009420	2.018840%	7/10/2014 12/19/2014	2.018840%	Sec 1-27S-38W	
JERE MAX BEYMER	P O BOX 123	LAKIN	KS	67860	R				0.00195460	0.00195460	0.390920%	7/8/2014 12/15/2014	0.390920%	Sec 1-27S-38W	
JUDITH L ROHLF BYPASS TRUST	RICHARD J ROHLF TRUSTEE 14680 ROYAL WAY	TRUCKEE	CA	96161	R				0.00195460	0.00195460	0.390920%	7/7/2014	0.390920%	Sec 1-27S-38W	
LAURA MARIE HEEKE TRUST	U T A DATED JULY 6 2001 LAURA MARIE HEEKE TRUSTEE 2112 N TEJON	COLORADO SPRINGS	CO	80907	R				0.00515450	0.00515450	1.030900%	7/9/2014 1/8/2015	1.030900%	Sec 1-27S-38W	
LETCHER R WAECHTER	805 N JOYCE ST	ULYSSES	KS	67880	R				0.00977210	0.00977210	1.954420%	7/23/2014 12/22/2014	1.954420%	Sec 1-27S-38W	
LINDA L HUMPHREYS	4039 W RD 1	ULYSSES	KS	67880	R				0.00405580	0.00405580	0.811160%			Sec 1-27S-38W	
LINDA MCKAY	2231 DERBY WAY	ST LOUIS	MO	63131	R				0.00195460	0.00195460	0.390920%	7/21/2014	0.390920%	Sec 1-27S-38W	
MARTHA J CUSICK	C/O KEARNEY COUNTY BANK ACCT# 1753760906 PO BOX 67	LAKIN	KS	67860	R				0.00195450	0.00195450	0.390900%	7/24/2014 1/6/2015	0.390900%	Sec 1-27S-38W	
JANE COLE MASSEY TRUST	C/O TOM NEFF 100 INDEPENDENCE PL STE 307	TYLER	TX	75703-0000	R				0.01073850	0.01073850	2.147700%	7/3/2014 12/23/2014	2.147700%	Sec 1-27S-38W	
PADDACK HILL FARM LLC	PO Box 274	LAKIN	KS	67860	R				0.00536920	0.00536920	1.073840%	7/8/2014 1/7/2015	1.073840%	Sec 1-27S-38W	
RKB LLC	PO BOX 3	LAKIN	KS	67860	R				0.00130300	0.00130300	0.260600%	7/3/2014 12/15/2014	0.260600%	Sec 1-27S-38W	
STEVE BEYMER	PO BOX 1152	HUTCHINSON	KS	67504	R				0.00195460	0.00195460	0.390920%	7/3/2014 12/15/2014	0.390920%	Sec 1-27S-38W	
VERNON M NEFF TRUST	GRANT COUNTY BANK TRUSTEE PO BOX 389	ULYSSES	KS	67880	R				0.00536930	0.00536930	1.073860%	12/15/2014	1.073860%	Sec 1-27S-38W	
WALTER E WAECHTER	252 ROAD H	ULYSSES	KS	67880-5313	R				0.00859080	0.00859080	1.718160%			Sec 1-27S-38W	
									0.12500000	0.12500000	0.12500000	0.12500000	0.50000000	100.000000%	86.655950%

**EXHIBIT B**

A.A.P.L. FORM 616-1982

**MODEL FORM OPERATING AGREEMENT**

[EXCERPTED]

**OPERATING AGREEMENT  
DATED**

January 14, 2013

OPERATOR LINN OPERATING, INC.

UNIT AREA ALTERNATE TRACT UNIT DESCRIBED AS:  
SECTION 36-26S-38W (SE/4), SECTION 31-26S-37W (SW/4)  
KEARNY COUNTY KANSAS  
SECTION 06-27S-37W (NW/4), SECTION 01-27S-38W (NE/4)  
GRANT COUNTY, KANSAS

Limited to the Chase and Council Grove Formations in the ATU well described above to be drilled in approximate center of an Alternate Tract Unit consisting of:

Section 36-26S-38W (SE/4), Section 31-26S-37W (SW/4), Kearny County, Kansas  
Section 06-27S-37W (NW/4), Section 01-27S-38W (NE/4), Grant County, Kansas

NOTE: WHEREAS UNIT OPERATOR LINN OPERATING, INC. IS THE SOLE WORKING INTEREST OWNER IN SAID UNIT, THIS FORM OPERATING AGREEMENT IS INCORPORATED BY REFERENCE AND MADE A PART OF THE PLAN OF UNIT OPERATIONS TO THE EXTENT IT DEMONSTRATES PRUDENT METHODS OF OPERATING AND AFFECTS THE INTERESTS OF ROYALTY OWNERS IN THE UNIT AREA.

COUNTIES OF KEARNY AND GRANT, STATE OF KANSAS

COPYRIGHT 1982 - ALL RIGHTS RESERVED  
AMERICAN ASSOCIATION OF PETROLEUM  
LANDMEN. 4100 FOSSIL CREEK BLVD., FORT  
WORTH, TEXAS, 76137-2791, APPROVED FORM.  
A.A.P.L. NO. 610 -1982 REVISED

COPY OF ENTIRE AGREEMENT  
AVAILABLE ON REQUEST

EXHIBIT C

J B STODDARD ESTATE  
4145 TRAVIS ST SUITE 101  
DALLAS, TX 75204-1840

JAMES J HEUTEL  
PO BOX 12254  
DALLAS, TX 75225-0000

SALZAU 1  
6125 WESTWICK  
DALLAS, TX 75205-0000

CHARLES R GRUYE &  
9886 STERLING RIDGE RD  
SCOTTSDALE, AZ 85262-0000

JAMES L WELCH  
12225 GREENVILLE AVE STE #950  
DALLAS, TX 75243-9362

HARRY B HEUTEL TRUST  
JAMES HEUTEL TTEE  
3621 TURTLE CREEK BLVD #9A  
DALLAS, TX 75219-0000

MAP MRP  
PO BOX 269031  
OKLAHOMA CITY, OK 73126-9031

MAP HOLDINGS  
101 N ROBINSON STE 1000  
OKLAHOMA CITY, OK 73102-5514

KANSAS ROYALTY HOLDINGS  
705 SUNSET HILL DRIVE  
ROCKWALL, TX 75087-0000

MAP2004-OK  
PO BOX 269031  
OKLAHOMA CITY, OK 73126-9031

SHADED LAZY H LLC  
7603 S RD E  
ULYSSES, KS 67880-0000

CHARLES GRAHAM LOWE MRTL TR  
120 E CONSTITUTION ST  
VICTORIA, TX 77901-8137

REBECCA L SCIBA  
23421 S GATEWAY LN  
CHENEY, WA 99004-0000

CROWE REV LIV TR  
4033 SWEETBERRY DR  
NASHVILLE, TN 37211-4599

SCOTT ALLEN CROWE IRREV TR  
4033 SWEETBERRY DR  
NASHVILLE, TN 37211-4599

CLARKSONS GROUP  
12225 GREENVILLE AVE 950  
DALLAS, TX 75243-9362

ARKOMA BASIN MINERALS INC  
203 EAST INTERSTATE 30  
ROCKWALL, TX 75087-0000

EXXONMOBIL OIL CORP-XTO  
810 HOUSTON ST  
FORT WORTH, TX 76102-0000

CHESAPEAKE EXPLORATION LLC  
PO BOX 18496  
OKLAHOMA CITY, OK 73154-0496

GARY C BEYMER  
BOX 817  
LAKIN, KS 67860-0000

CEB INC  
ROBERT BEYMER - PRESIDENT  
PO BOX 363  
LAKIN, KS 67860-0000

FLYING T CATTLE COMPANY INC  
PO BOX 69  
LAKIN, KS 67860-0000

STEPHEN MCCORMICK FAM TRUST  
PO BOX 406  
SOUTHFORK, CO 81154-0000

TATE FAMILY TR  
PO BOX 69  
LAKIN, KS 67860-0000

BAT MINERALS LLC  
PO BOX 69  
LAKIN, KS 67860-0000

GHT MINERALS LLC  
PO BOX 69  
LAKIN, KS 67860-0000

FRANKLIN LELAND BAKER  
9831 LAUREL HOLLOW CIR  
GERMANTOWN, TN 38139-0000

JULIE BAKER COLETTA  
10253 PEYTON PATH CV  
COLLIERVILLE, TN 38017-0000

EMERALD LODGE AF & AM #289  
PO BOX 864  
LAKIN, KS 67860-0000

LV FARMS A PRTNSHP  
PO BOX C  
LAKIN, KS 67860-0450

E NORBERT GARRETT  
10 KINGWOOD RD  
WEST ORANGE, NJ 70523-1110

MERLE K HEEKE EXPTION  
3250 TORO CR  
COLORADO SPRINGS, CO 80918-2244

PADDACK HILL FARM LLC  
PO BOX 274  
LAKIN, KS 67860-0274

DONALD NEFF  
RR I BOX 4  
LAKIN, KS 67860-9800

VERNON M NEFF  
BOX 426  
LAKIN, KS 67860-0426

LAURA M HEEKE LIV TR  
2112 N TEJON ST  
COLORADO SPRINGS, CO 80907-6938

FREDA M MCVEY  
1650 N 1<sup>ST</sup>  
SEWARD, NE 68434-6007

LETCHER R WAECHTER  
805 N JOYCE ST  
ULYSSES, KS 67880-8408

HAROLD K AND RITA F WAECHTER  
JOINT TENANTS WROS  
PMB 232  
4713 OREGON TRAIL  
AMARILLO, TX 79109-5919

ELSIE I NEFF TR  
DTD 3/25/77  
PO BOX 1024  
DURANGO, CO 81302-1024

WALTER E WAECHTER  
252 ROAD H  
ULYSSES, KS 67880-5313

JANE COLE MASSEY TRUST  
C/O TOM NEFF  
100 INDEPENDENCE PL STE 307  
TYLER, TX 75703-0000

RUBART INVESTMENTS LP  
921 N SULLIVAN ST  
ULYSSES, KS 67880-1619

C EASTON BEYMER  
898 FIRE AGATE DR  
BOULDER CITY, NV 89005-1219

DEANNE LEE HUSTED  
2360 MEDALLIAN WAY  
LODI, CA 95242

ELSIE I NEFF TRUST  
ELSIE I NEFF TISA SHARI NEFF  
AND BYRON JAY NEFF TRUSTEES  
PO BOX 1024  
DURANGO, CO 81302

EXXONMOBIL OIL CORPORATION  
C/O XTO ENERGY INC  
PO BOX 731917  
DALLAS, TX 75373

JERE MAX BEYMER  
P O BOX 123  
LAKIN, KS 67860

JUDITH L ROHLF BYPASS TRUST  
RICHARD J ROHLF TRUSTEE  
14680 ROYAL WAY  
TRUCKEE, CA 96161

LAURA MARIE HEEKE TRUST  
U T A DATED JULY 6 2001  
LAURA MARIE HEEKE TRUSTEE  
2112 N TEJON  
COLORADO SPRINGS, CO 80907

LINDA L HUMPHREYS  
4039 W RD 1  
ULYSSES, KS 67880

LINDA MCKAY  
2231 DERBY WAY  
ST LOUIS, MO 63131



MARTHA J CUSICK  
C/O KEARNEY COUNTY BANK  
ACCT# 1753760906  
PO BOX 67  
LAKIN, KS 67860

RKB LLC  
PO BOX 3  
LAKIN, KS 67860

STEVE BEYMER  
PO BOX 1152  
HUTCHINSON, KS 67504

VERNON M NEFF TRUST  
GRANT COUNTY BANK TRUSTEE  
PO BOX 389  
ULYSSES, KS 67880

BEFORE THE STATE CORPORATION COMMISSION  
OF THE STATE OF KANSAS

IN THE MATTER OF THE APPLICATION )  
OF LINN OPERATING, INC. FOR AN ) DOCKET NO. 15-CONS-\_\_\_\_\_-CUNI  
ORDER PROVIDING FOR THE )  
UNITIZATION AND UNIT OPERATION OF )  
A PART OF THE HUGOTON AND )  
PANOMA COUNCIL GROVE GAS FIELDS )  
IN THE ALTERNATE TRACT UNIT )  
DESCRIBED AS SECTION 36-26S-38W ) OPERATOR NO. 33999  
(SE/4), SECTION 31-26S-37W (SW/4), IN ) CONSERVATION DIVISION  
KEARNY COUNTY, KANSAS, SECTION )  
06-27S-37W (NW/4), SECTION 01-27S- )  
38W (NE/4) IN GRANT COUNTY, KANSAS )  
(ATU 127X)

NOTICE OF PENDING APPLICATION

THE STATE CORPORATION COMMISSION  
OF THE STATE OF KANSAS TO:

ALL OIL AND GAS PRODUCERS AND OIL AND GAS PURCHASERS, ROYALTY  
OWNERS, LAND OWNERS, AND ALL PERSONS WHOMSOEVER CONCERNED:

YOU, and each of you, are hereby notified that LINN OPERATING, Inc., has filed an Application with the State Corporation Commission of the State of Kansas requesting an Order providing for the Unitization and Unit Operation of an Alternate Tract Unit pursuant to K.S.A. 55-1301, *et seq.*, and the Basic Integrated Proration Order for the Hugoton Gas Field and Panoma Council Grove Gas Field. The unit area subject to the requested Order is as follows:

Section 36-26S-38W (SE/4)  
Section 31-26S-37W (SW/4)  
In Kearny County, Kansas  
Section 06-27S-37W (NW/4)  
Section 01-27S-38W (NE/4)  
In Grant County, Kansas.

YOU are further notified that unless written protest or request for hearing is received by the State Corporation Commission within 15 days after publication of this Notice, the Application in this matter will be granted pursuant to K.S.A. 77-537 after said 15 day period. Any such protest or request for hearing should be mailed to the State Corporation Commission of the State of Kansas, Conservation Division, 130 S. Market, Room 2078, Wichita, Kansas 67202 and to the Applicant at the address below.

All parties in anywise interested or concerned shall take notice of the foregoing and govern themselves accordingly.

LINN OPERATING, Inc.  
BY: Lawson Mertz  
Landman  
Kansas Hugoton Assets  
600 Travis, Suite 5100  
Houston, TX 77002  
(281) 840-4002  
lmertz@linnenergy.com