

MAR 25 2024  
CONSERVATION DIVISION  
APPROVAL

**BEFORE THE STATE CORPORATION COMMISSION  
OF THE STATE OF KANSAS**

In the matter of the Application of Edison Operating Company, LLC for an exception to the 10-year time limitation of K.A.R. 82-3-111 for its Seevers LKC Unit #8-3 well located in the Center of the Southwest Quarter of the Southeast Quarter of Section 1, Township 25 South, Range 14 West Stafford County, Kansas.	)	Docket No. 24-CONS-3269-CEXC
	)	
	)	Conservation Division
	)	
	)	License No.: 34434

**APPLICATION**

COMES NOW Edison Operating Company, LLC (“Applicant”) in support of its Application in the captioned matter and states as follows:

1. Applicant is a Limited Liability Company authorized to do business in the State of Kansas. Applicant’s address is 8100 E. 22<sup>nd</sup> N. Building 1900, Wichita, Kansas 67226.

2. Applicant has been issued by the Kansas Corporation Commission Operator’s License number 34434, which expires on August 3rd, 2024.

3. Applicant is the owner and operator of the Seevers LKC Unit #8-3 well (originally known as the Goodman #3), API # 15-185-33915-0001 (“the subject well”), which is located in the Center of the Southwest Quarter of the Southeast Quarter of Section 1, Township 25 South, Range 14 West, Stafford County, Kansas. The subject well is located on an active oil lease comprising the following lands:

- North Half of the Northeast Quarter (N/2 NE/4) in Section 6, Township 25 South, Range 13 West
- West Half of the Southwest Quarter of the Northeast Quarter (W/2 SW/4 NE/4) in Section 6, Township 25 South, Range 13 West
- North Half of the Northwest Quarter (N/2 NW/4) in Section 6, Township 25 South, Range 13 West
- South Half of the Northwest Quarter (S/2 NW/4) in Section 6, Township 25 South, Range 13 West
- Northwest Quarter of the Southwest Quarter (NW/4 SW/4) in Section 6, Township 25 South, Range 13 West
- South Half of the Northeast Quarter (S/2 NE/4) in Section 1, Township 25 South, Range 14 West
- Northeast Quarter of the Northeast Quarter (NE/4 NE/4) in Section 1, Township 25 South, Range 14 West
- North Half of the Southeast Quarter (N/2 SE/4) in Section 1, Township 25 South, Range 14 West
- South Half of the Southeast Quarter (S/2 SE/4) in Section 1, Township 25 South, Range 14 West
- Southeast Quarter of the Southwest Quarter (SE/4 SW/4) in Section 1, Township 25 South, Range 14 West
- North Half of the Northeast Quarter (N/2 NE/4) in Section 12, Township 25 South, Range 14 West
- Northwest Quarter (NW/4) in Section 12, Township 25 South, Range 14 West

4. Pursuant to K.A.R. 82-3-111, the well was shut in, or Applicant obtained temporary abandonment status, for the subject well on June 1, 2007. The subject well has maintained such status from June 1, 2007 to the present date.

5. On or about March 1, 2018, the Kansas Corporation Commission notified Applicant that temporary abandonment status for the subject well would be denied because the subject well had been temporarily abandoned for more than ten (10) years. Applicant filed for and received approval for an exception to K.A.R. 82-2-111 on April 4, 2018.

6. On or about March 1, 2024, the Kansas Corporation Commission notified Applicant that the 3-year exception to K.A.R. 82-3-111 was expiring. K.A.R. 82-3-111 provides for an additional exception to be obtained through an application filed with the Commission. Applicant seeks such an exception.

7. On February 27, 2024, the subject well passed a mechanical integrity test of the casing between the surface and a point within 108 feet above the uppermost perforation in the well. Said test was witnessed by Ken Scofield with the Kansas Corporation Commission, District #1.

8. Applicant wishes to continue temporary abandonment status for the subject well because Edison Operating Company, LLC intends to re-complete the wellbore in the Viola formation. The Seevers LKC Unit #8-3 is currently open in the Lansing-Kansas City. A DST was run across the Viola and recovered commercial quantities of oil and gas, but was never completed. The Viola formation is productive in this area of Stafford County, and we estimate recoverable reserves of 40,000 BOE.

9. Applicant submits the following information regarding the well in support of the Application.

See Exhibit A

10. Applicant has included a plat map showing the locations of all producing, injection, temporarily abandoned, abandoned, and plugged wells located on the same leased premises as the subject well. See enclosed.

11. Based on the foregoing, Applicant requests the Commission grant an additional exception to the 10-year limitation, specifically to allow the subject well to remain eligible for temporary abandonment status for three (3) years following the expiration of the 10-year limitation.

Applicant understands that the exception would be valid for three (3) years, but Applicant would still need to apply annually to the Conservation Division District Office for approval of an application for temporary abandonment status.

12. Listed in the attached Exhibit "B" are the names and addresses of the following persons:

A. Each operator of each oil and gas lease covering lands within one-half (1/2) mile radius of the subject well; and

B. Each person who owns any mineral interest of record in and under any lands located within one-half (1/2) mile radius of subject well (provided that such mineral interest is not covered by any oil and gas lease).

13. Notice of this Application will be published pursuant to K.A.R. 82-3-135a. In addition, notice of the hearing to be held in this matter will be provided as prescribed by K.A.R. 82-3-135.

WHEREFORE, Applicant prays that this matter be granted administratively without a hearing, or in the alternative be set for hearing, and upon hearing that the Commission grant Applicant's request, for an exception to the K.A.R. 82-3-111 ten (10) year limitation, to allow the subject well to remain temporarily abandoned for three (3) years, subject to annual approval by the Conservation Division District Office of an application for temporary abandonment status.

Respectfully Submitted,

Edison Operating Company, LLC  
8100 E. 22<sup>nd</sup> N. Bldg 1900  
316.201.1744 (phone)  
316.201.1687 (fax)

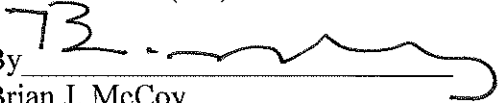
By   
Brian J. McCoy

**CERTIFICATE OF SERVICE**

I hereby certify on this 25 day of MARCH, 2024, true and correct copies of the above and foregoing Application and the Notice of Application were served by depositing copies of the same in the United States Mail, postage prepaid, and properly addressed to the landowner/s set forth in paragraph 12 of said Application and each party set forth in Exhibit "B" attached to said Application filed by Applicant, and the original and seven (7) copies were hand delivered to the Kansas Corporation Commission.

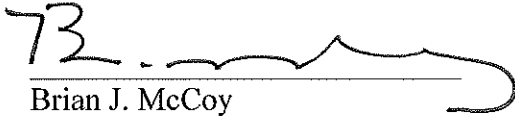
  
Brian J. McCoy

KANSAS CORPORATION COMMISSION  
OIL & GAS CONSERVATION DIVISION  
**CASING MECHANICAL INTEGRITY TEST**

Form U-7  
August 2019

Disposal:  Enhanced Recovery:  KCC District No.: 1  
Operator License No.: 34434 Name: Edison Operating Company LLC  
Address 1: 8100 E. 22ND ST. N., BLDG 1900  
Address 2: \_\_\_\_\_  
City: WICHITA State: KS Zip: 67226 + 2319  
Contact Person: David Withrow Phone: (316) 201-1744

API No.: 15-185-33915-00-01 Permit No.: E14994.4  
E2 SW SE Sec. 1 Twp. 25 S. R. 14  East  West  
663 Feet from  North /  South Line of Section  
1966 Feet from  East /  West Line of Section  
Lease: SEEVERS Well No.: 8-3  
County: Stafford

Well Construction Details:  New well  Existing well with changes to construction  Existing well with no changes to construction

Maximum Authorized Injection Pressure: 1500 psi Maximum Injection Rate: 1500 bbl/d

	Conductor	Surface	Intermediate	Production	Liner	Tubing
Size:	NA	8.625	NA	5.5	NA	NA
Set at:		257		4225		
Sacks of Cement:		225		300		
Cement Top:		0		2810		
Cement Bottom:		257		4225		
Packer Type:	NA					

DV Tool  Port Collar Depth of: \_\_\_\_\_ feet with \_\_\_\_\_ sacks of cement TD (and plug back): 4310 (3650) feet depth  
Zone of Injection Formation: LANSING-KANSAS CITY Top Feet: 3758 Bottom Feet: 3947 Perf. or Open Hole: Perf

Is there a Chemical Sealant or a Mechanical Casing patch in the annular space?  Yes  No

If Dual Completion - Injection is:  Above Production  Below Production

**FIELD DATA**

GPS Location: Datum:  NAD27  NAD83  WGS84 Lat: 37.89986 Long: -98.8094 Date Acquired: 02/24/2021  
MIT Type: Monitoring Test MIT Reason: 3-YEAR TEST

Time in Minute(s):	0	15	30
Pressures: Set up 1	<u>350</u>	<u>350</u>	<u>350</u>
Set up 2			
Set up 3			

Tested:  Casing  or Casing - Tubing Annulus System Pressure during test: 0 Bbls. to load annulus: 0  
Test Date: 02/27/2024 Using: DAMM PIPE TESTING Company's Equipment \_\_\_\_\_

The zone tested for this well is between 0 feet and 3650 feet.

The test results were verified by operator's representative:

Name: BRIAN J MCCOY Title: MANAGER Phone: (316) 214-3658

<p><b>KCC Office Use Only</b></p> <p>The results were:</p> <p><input checked="" type="checkbox"/> Satisfactory</p> <p><input type="checkbox"/> Not Satisfactory</p> <p>Next MIT: <u>02/26/2027</u></p>	<p>State Agent: <u>Ken Scofield</u> Title: <u>E.C.R.S.</u> Witness: <input checked="" type="checkbox"/> Yes <input type="checkbox"/> No</p> <p>Remarks: _____</p> <p>[Set up 1 Pressures represent "Out of Use" pressure readings. Set up 2 Pressures represent "In Use" pressure readings.] [Set up 1 Pressures represent "Out of Use" pressure readings. Set up 2 Pressures represent "In Use" pressure readings.]</p>
--	--

 <b>EDISON OPERATING COMPANY</b> <sub>LLC</sub>
SEEVERS LKC UNIT LEASE
25S-14W
STAFFORD COUNTY, KS
POSTED WELL DATA Well Name
Well Number ●
<b>WELL SYMBOLS</b> ● Oil Well ● Plugged & Abandoned Oil Well ● Plugged And Abandoned Oil and Gas Well ○ Dry Hole ○ Injection Well ○ Oil Conv to EOR ○ Oil Conv to EOR P&A ○ Abandoned Location - Permit ○ Service Well ○ Service Well P&A ○ Temporarily Abandoned ○ Dry Hole, With Show of Oil ○ Dry Hole, With Show of Oil & Gas ○ Dry Hole, With Show of Gas
REMARKS
UNIT MAP
By: EOC
March 22, 2024

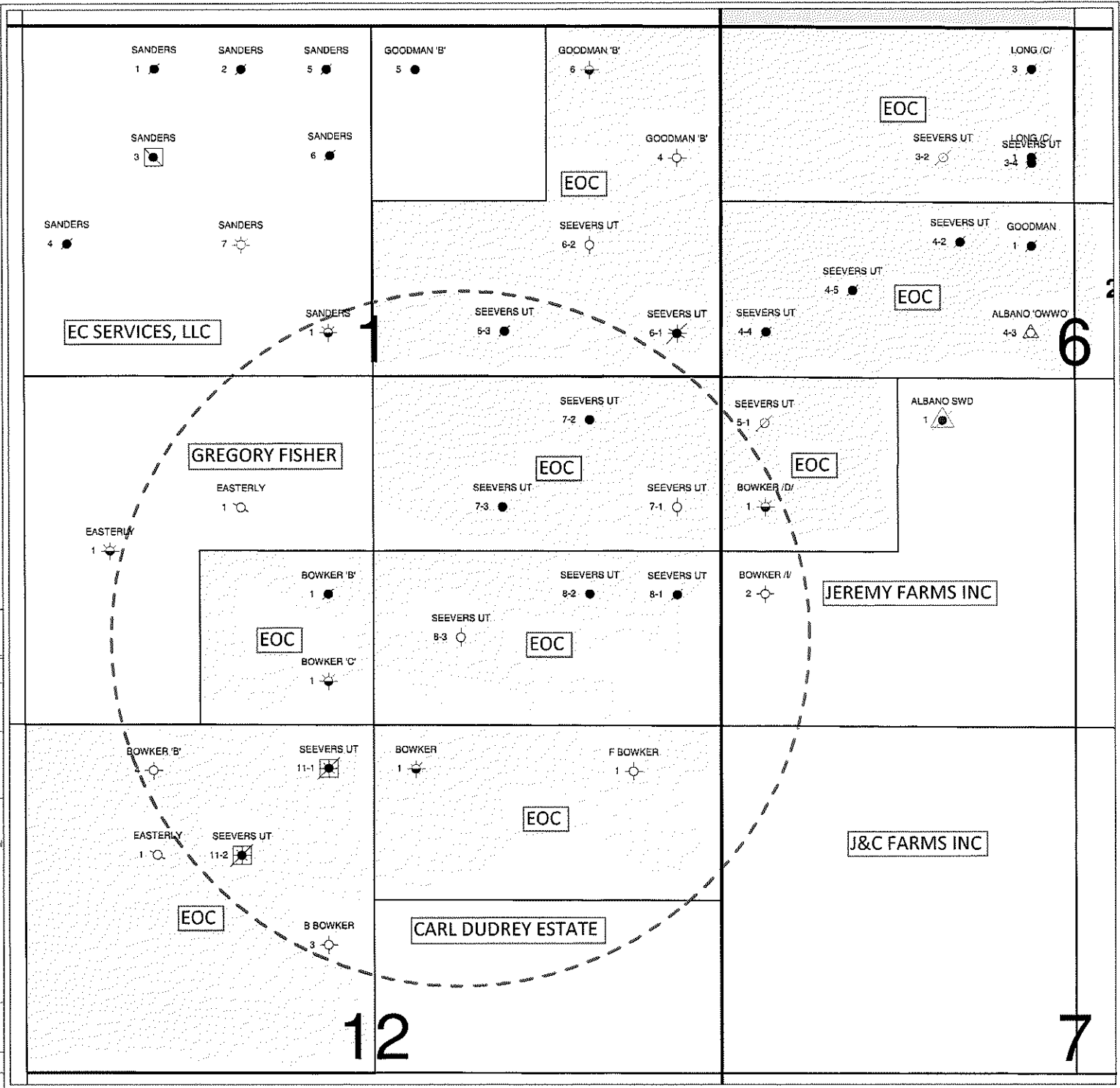

**EXHIBIT A**

**A.**

Lease	O/G	PROD WELLS	WELL COUNT	API #	Year Drilled	Yr. Assumed Responsibility	Depth	County	S	T	R
Seevers LKC Unit #6-2	TA	0	1	15-185-11923-0001	1959	2016	4292	Stafford	1	25S	14W
Seevers LKC Unit #7-1	TA	0	1	15-185-13139-0001	1958	2016	4291	Stafford	1	25S	14W
Seevers LKC Unit #7-2	TA	1	1	15-185-13234-0000	1958	2016	4307	Stafford	1	25S	14W
Seevers LKC Unit #7-3	O	1	1	15-185-13233-0000	1959	2016	4297	Stafford	1	25S	14W
Seevers LKC Unit #8-2	O	1	1	15-185-13138-0000	1958	2016	4317	Stafford	1	25S	14W
Seevers LKC Unit #8-3	TA	0	1	15-185-33915-0001	1959	2016	4310	Stafford	1	25S	14W

**B. BREAKDOWN OF PLUGGING EXPENSES TO PLUG SEEVERS LKC UNIT #8-3**

WORKOVER RIG	\$ 7,500.00
WIRELINE	\$ 2,500.00
TBG RENTAL	\$ 1,500.00
PUMP TRUCK & CEMENT	\$ 8,500.00
DIG PIT & WATER TO PLUG	\$ 2,000.00
MISC.	\$ 1,500.00
<b>TOTAL</b>	<b>\$ 23,500.00</b>

**C. 2023 OIL PRODUCTION**

MONTH	#7-3 (BO)	#8-2 (BO)	LEASE TOTALS (BO)
JANUARY	382	294	676
FEBRUARY	348	292	640
MARCH	385	334	719
APRIL	266	309	575
MAY	2	298	300
JUNE	0	245	245
JULY	0	207	207
AUGUST	0	72	72
SEPTEMBER	0	129	129
OCTOBER	0	115	115
NOVEMBER	0	43	43
DECEMBER	164	156	320
2020 TOTALS	1547	2494	4041

**D. SEE ITEM 1.**

REMAINING RESERVES 40,000 BOE

**E. The subject well, in order to produce or inject at a future time will need the following:**

1. RIH AND CEMENT/SQUEEZE INJECTION ZONE.
2. SCENARIO FOR PRODUCER - PERFORATE NEW ZONE, ACIDIZE, SWAB TEST, RUN PRODUCTION TBG, RIH W/ BHP AND ROD STRING, PUT WELL INTO PRODUCTION.
3. SCENARIO FOR INJECTOR - RIH WITH PACKER AND COATED TBG, MIT WELL, PUT INTO SERVICE.

**F. THE SUBJECT WELL HAS PASSED MIT AS OF FEBRUARY 27, 2024. NO FURTHER ACTION IS NEEDED. PLUGGING COSTS ABOVE ARE CURRENT PRICE.**



EXHIBIT B

<p>A. EC SERVICES, LLC P.O. BOX 142 WHITEWATER, KS 67154</p>	<p>NW/4</p>	<p>SECTION 1-25S-14W</p>	<p>STAFFORD COUNTY, KS</p>
<p>HERMAN L. LOEB P.O. BOX 524 LAWRENCEVILLE, IL 62439-0524</p>	<p>NW/4 NE/4</p>	<p>SECTION 1-25S-14W</p>	<p>STAFFORD COUNTY, KS</p>
<p>EDISON OPERATING COMPANY, LLC 8100 E. 22ND ST. NORTH BUILDING 1900 WICHITA, KS 67226</p>	<p>NE/4 NE/4 &amp; S/2 NE/4</p>	<p>SECTION 1-25S-14W</p>	<p>STAFFORD COUNTY, KS</p>
	<p>N/2 SE/4</p>	<p>SECTION 1-25S-14W</p>	<p>STAFFORD COUNTY, KS</p>
	<p>S/2 SE/4</p>	<p>SECTION 1-25S-14W</p>	<p>STAFFORD COUNTY, KS</p>
	<p>SE/4 SW/4</p>	<p>SECTION 1-25S-14W</p>	<p>STAFFORD COUNTY, KS</p>
	<p>N/2 NE/4</p>	<p>SECTION 12-25S-14W</p>	<p>STAFFORD COUNTY, KS</p>
	<p>NW/4</p>	<p>SECTION 12-25S-14W</p>	<p>STAFFORD COUNTY, KS</p>
<p>NW/4 SW/4</p>	<p>SECTION 6-25S-13W</p>	<p>STAFFORD COUNTY, KS</p>	
<p>B. GREGORY FISHER 410 N. NUTTING ST. JOHN, KS 67576</p>	<p>N/2 SW/4 &amp; SW/4 SW/4</p>	<p>SECTION 1-25S-14W</p>	<p>STAFFORD COUNTY, KS</p>
<p>JEREMY FARMS INC 410 N. NUTTING ST. JOHN, KS 67576</p>	<p>NE/4 SW/4 &amp; S/2 SW/4</p>	<p>SECTION 6-25S-14W</p>	<p>STAFFORD COUNTY, KS</p>
<p>J&amp;C FARMS INC 122 S. MAIN ST. ST. JOHN, KS 67576</p>	<p>NW/4</p>	<p>SECTION 7-25S-14W</p>	<p>STAFFORD COUNTY, KS</p>
<p>CARL DUDREY ESTATE ATTN: MR. RICK BALL 2006 BROADWAY GREAT BEND, KS 67530</p>	<p>S/2 NE/4</p>	<p>SECTION 12-25S-14W</p>	<p>STAFFORD COUNTY, KS</p>