

Evergy proposes to build a new 3-phase overhead primary line and remove an old single phase overhead primary line in Coffey County. The removal will be along the south side of old Hwy 50 from the east side of Garner Rd to the east side Iris Rd. The new install we be along the north side of old Hwy 50 from the east side Garner Rd to the east side of Iris Rd to improve reliability. The new install we be approximately 2 miles. This will be worked with (M100748156) Sub Transmission job.

T19S R14E Sec. 11, 12, 13, 14

T19S R15E Sec. 07, 18

Work Request# M100748500

Application Sketch# 31889

Miriam Nickle



EL39705

12/18/2019

Kansas Corporation Commission
Utility Division
1500 SW Arrowhead Rd,
Topeka, KS 66604

Dear Kansas Corporation Commission :

Attached is an application of , a Evergy Company for approval of plans, specifications and location of a proposed electric line as follows:

Evergy proposes to build a new 3-phase overhead primary line and remove an old single phase overhead primary line in Coffey County. The removal will be along the south side of old Hwy 50 from the east side of Garner Rd to the east side Iris Rd. The new install we be along the north side of old Hwy 50 from the east side Garner Rd to the east side of Iris Rd to improve reliability. The new install we be approximately 2 miles. This will be worked with (M100748156) Sub Transmission job.

T19S R14E Sec. 11, 12, 13, 14

T19S R15E Sec. 07, 18

Work Request# M100748500
Application Sketch# 31889
Miriam Nickle

Also attached is a copy of our letter of notification to all of the other public utilities within one-half (1/2) mile of this proposed Electric Line, together with maps showing the location of the Electric Line.

Any questions concerning this application please contact Miriam R Nickle +1 (785) 587-2317 at our Manhattan Service Center office, or Scott Pfeiffer - 785-575-6019 , at our general office.

Sincerely,

A handwritten signature in black ink, appearing to read 'Scott Pfeiffer', written over a horizontal line.

Scott Pfeiffer

Form "EL"

BEFORE THE STATE CORPORATION COMMISSION OF THE STATE OF KANSAS

IN THE MATTER OF THE APPLICATION OF

"EL"-No. **EL39705**

Evergy Kansas Central, Inc

Assigned By Commission

Applicant

Appl: 31889

WR #: M100748500

Applicants Identification Number

FOR APPROVAL OF PLANS, SPECIFICATIONS AND LOCATION OF PROPOSED ELECTRIC LINE CONSTRUCTION

Evergy proposes to build a new 3-phase overhead primary line and remove an old single phase overhead primary line in Coffey County. The removal will be along the south side of old Hwy 50 from the east side of Garner Rd to the east side Iris Rd. The new install we be along the north side of old Hwy 50 from the east side Garner Rd to the east side of Iris Rd to improve reliability. The new install we be approximately 2 miles. This will be worked with (M100748156) Sub Transmission job.

T19S R14E Sec. 11, 12, 13, 14

T19S R15E Sec. 07, 18

Work Request# M100748500

Application Sketch# 31889

Miriam Nickle

HERE DESCRIBE THE LOCATION VERY BRIEFLY

COMES NOW EVERGY KANSAS CENTRAL INC.

APPLICATION

Applicant OF KANSAS A Corporation

Topeka, Kansas (Corporation, Partnership, Individual or Municipality)

REQUESTING THE COMMISSION TO APPROVE THE ATTACHED PLANS, SPECIFICATIONS AND LOCATION OF A PROPOSED ELECTRIC LINE, OR CHANGE IN ELECTRIC LINE CONSTRUCTION, LOCATED OUTSIDE THE CORPORATE LIMITS OF ANY CITY, AS SHOWN ON THE ACCOMPANYING MAP AND IS HEREINAFTER MORE FULLY DESCRIBED.

THE OPERATING CHARACTERISTICS OF THIS LINE ARE TO BE:

ELECTRIC 12,470 VOLTS, 3 PHASE, HERTZ, DESIGN LOAD Kw KILOWATTS

PROVIDE CONNECTION (e.g GROUNDE WYE), PHASE TO PHASE VOLTAGE, NUMBER OF CONDUCTORS, AND POINTS OF GROUNDING THE DESCRIPTION OF THE LOCATION AND POINTS BETWEEN WHICH SAID PROPOSED LINE IS TO BE INSTALLED AND OPERATED ARE AS FOLLOWS:

Evergy proposes to build a new 3-phase overhead primary line and remove an old single phase overhead primary line in Coffey County. The removal will be along the south side of old Hwy 50 from the east side of Garner Rd to the east side Iris Rd. The new install we be along the north side of old Hwy 50 from the east side Garner Rd to the east side of Iris Rd to improve reliability. The new install we be approximately 2 miles. This will be worked with (M100748156) Sub Transmission job.

T19S R14E Sec. 11, 12, 13, 14

T19S R15E Sec. 07, 18

Work Request# M100748500

Application Sketch# 31889

Miriam Nickle

as shown on application Sketch No 31889

PHYSICAL PROPERTIES OF LINE:

STRUCTURES:

Poles - Kind N/A, Height N/A, Class N/A, Conductor Size 1/0, Kind ACSR, Average Span (ft) 250' AvgSpan

HAS CLEARANCE BEEN PROVIDED FOR OTHER UTILITIES? Yes

Cost Estimate \$871,064.12

NUMBER AND TYPE OF CUSTOMERS Commercial

***NOTE: PLEASE USE THE FOLLOWING ABBREVIATIONS FOR PREDOMINANT STRUCTURE KIND:**

SPW-SINGLEPOLE, WOOD

SPF - SINGLEPOLE, FIBERGLASS

TS - TOWER STEEL

SPS-SINGLEPOLE, STEEL

HFW - H-FRAME, WOOD

O - OTHER, PLEASE EXPLAIN

SPC-SINGLEPOLE, CONCRETE

HFS - H-FRAME, STEEL

NA - NOT APPLICABLE

THE FOLLOWING IS A CORRECT LIST OF ALL THE UTILITIES WITHIN 1/2 MILE OF THE PROPOSED LINE. ABSENT A JOINT USE OR OTHER AGREEMENT, ALL UTILITIES LISTED BELOW SHALL BE NOTIFIED IN WRITING AS PROVIDED IN K.A.R 82-12-5, AND A COPY OF THE NOTICE SHALL BE ATTACHED. PLEASE INDICATE THOSE UTILITIES LISTED FOR WHICH A JOINT USE OR OTHER AGREEMENT HAS BEEN MADE WITH AN ASTERISK (*).

Company Name

Lyon-Coffey Electric Cooperative, Inc.
Sprint/Embarq Telephone
Coffey County RWD#3

Address

2501 W. 18th Ave # B, Emporia, KS - 66801
138 W 6th St., Junction City, KS - 664412939
235 North Main, New Strawn, KS - 66839

IS THIS LINE WITHIN THE APPLICANTS CERTIFICATE AREA? Yes

APPLICANT FURTHER SHOWS TO THE COMMISSION THAT THE CONSTRUCTION OF SAID PROPOSED LINE SHALL BE THROUGHOUT IN ACCORDANCE WITH THE KANSAS ADMINISTRATIVE REGULATIONS, ARTICLE 12, 82-12-1 TO 82-12-9, INCLUSIVE, ADOPTED PURSUANT TO K.S.A 1982 SUPP. 77-415 et seq.,

EXCEPT:

APPLICANT FURTHER STATES THAT:

WHENEVER PROPOSED LINE IS TO BE LOCATED ON PRIVATE RIGHT-OF-WAY, THE LANDOWNERS LAWFUL CONSENT WILL BE OBTAINED.

INDUCTIVE COORDINATION HAS BEEN OR WILL BE COMPLIED WITH AS RELATED SPECIFICALLY IN K.A.R 82-12-9.

ALL UTILITIES OR RAILROADS LISTED ABOVE HAVE BEEN NOTIFIED IN WRITING (A COPY OF WHICH IS ATTACHED) AS PROVIDED IN K.A.R 82-12-5 AND THAT SUCH NOTICE CONTAINS THE STATEMENT THAT "IF THERE IS ANY OBJECTION TO THE APPLICANT'S PROPOSED LINE CONSTRUCTION, SUCH OBJECTION SHALL BE FORWARDED TO THE STATE CORPORATION COMMISSION WITHIN THE TIME SPECIFIED IN K.A.R 82-12-5 FROM DATE OF NOTICE"

WHEREUPON, APPLICANT REQUESTS THAT THE STATE CORPORATION COMMISSION APPROVE THE OPERATING CHARACTERISTICS, PHYSICAL PROPERTIES AND LOCATION OF SAID PROPOSED LINE, AS HEREINBEFORE DESCRIBED.

DATED AT Topeka, KS THIS 18 DAY OF 12 2019
CITY, STATE DAY MONTH YEAR

APPLICANT

Evergy Kansas Central, Inc.

Scott Pfeiffer - Technical Specialist Tech Svcs



SIGNATURE AND TITLE OF OFFICER

SERVICES

APPLICANTS IDENTIFICATION AND APPLICATION OF RELATED PAPERS

INSTRUCTIONS

SUBMIT 1 COPY OF APPLICATION

2 COPIES OF MAPS, SCALE NOT LESS THEN 1 INCH PER MILE

PLOTTED _____

COPIES OF ALL NOTICES TO OTHER UTILITIES

COPIES BREAKDOWN OF "COST ESTIMATE" BY UNITS OF PROPERTY ON MAPS PLEASE PROVIDE
LOCATIONS OF EXISTING APPLICANT OWNED LINES IN SUFFICIENT DETAIL TO DETERMINE RELATIVE
LOCATION(S) OF PROPOSED LINE(S).

FOR OFFICE USE ONLY

CHECKED BY

DATE

APPROVED _____

REVISED

EL39705

S.C.C. Application Table

WR No. M100748500

Physical Properties of Line,

Pole: N/A Height: N/A Class: N/A Conductor Type: ACSR Size: 1/0 Average spans: 250 feetHas clearance been provided for other utilities, Yes: X No:

| Application for Primary construction to: | Cost Estimate | Miles of Primary Line | Number of New Customers |
|---|---------------|--------------------------|----------------------------|
| New Rural-Domestic | | | |
| New Commercial & Industrial | | | |
| New Lines to Improve Service | \$871,064.12 | 2.0 mi | |
| New Sub Transmission | | | |
| Retirement | | | |
| Conversion | | | |
| <u>TOTAL</u> | \$871,064.12 | 2.0 mi | |

For Official Use Only

Plotted _____

Checked by _____

Date
Approved _____

Remarks, Addresses & Etc.

Everygy proposes to build a new 3-phase overhead primary line and remove an old single phase overhead primary line in Coffey County. The removal will be along the south side of old Hwy 50 from the east side of Garner Rd to the east side Iris Rd. The new install we be along the north side of old Hwy 50 from the east side Garner Rd to the east side of Iris Rd to improve reliability. The new install we be approximately 2 miles. This will be worked with (M100748156) Sub Transmission job.

T19S R14E Sec. 11, 12, 13, 14

T19S R15E Sec. 07, 18

Work Request# M100748500

Application Sketch# 31889

Miriam Nickle

KCC Cost Report

Time run: 12/17/2019 11:08:05 AM

| | | |
|-------------------|---------------|----------|
| Work Order Number | Tech ID | Location |
| M100748500 | Miriam Nickle | LEBO |

| | | |
|-----------------|-----------------|--------------------------------------|
| Est Request Num | Est Version Num | Work Order Description |
| 84612 | 5 | MP East Street to Waverly 12kv; Ph 6 |

| FERC Acct | Action | Description | Quantity | Material | Labor | Additional Items | Transportation | OH Cost | Total Cost |
|-----------|---------|---|----------|-----------|-----------|------------------|----------------|---------|------------|
| 3640 | INSTALL | Fiberglass Cross Arm | 53 | 6709.56 | 92539.20 | 7500.00 | 78658.32 | 0.00 | 185407.08 |
| 3650 | INSTALL | Cable - Aluminum | 102 | 67.32 | 40.30 | 0.00 | 34.26 | 0.38 | 142.26 |
| 3650 | INSTALL | Conductor - Aluminum | 43188 | 12072.04 | 33680.40 | 0.00 | 28628.34 | 0.00 | 74380.78 |
| 3650 | INSTALL | Switch - Disconnect - 15 Kv | 11 | 823.35 | 1430.00 | 0.00 | 1215.50 | 0.00 | 3468.85 |
| 3650 | REMOVE | Cable - Aluminum | 129 | 0.00 | 4068.40 | 0.00 | 3458.14 | 0.00 | 7526.54 |
| 3650 | REMOVE | Conductor - Aluminum | 21320 | 0.00 | 65087.70 | 0.00 | 55324.55 | 0.00 | 120412.25 |
| | INSTALL | TRANSFORMER-OVERHEAD, 1PH, 25KVA, CONV-A, PRIMARY: 7200/12470Y SECONDARY: 120/240 SIZE: 25 KVA TAPS: NO TAPS LEGACY TYPEKEY: 01110302 NOTE: NEW TRANSFORMERS PURCHASED TO CONFORM TO WESTAR SPECIFICATION 1P-OH XFMR, LATEST REVISION | 2 | 1606.96 | 0.00 | 0.00 | 0.00 | 0.00 | 1606.96 |
| | | TRANSFORMER-OVERHEAD, 1PH, 25KVA, CONV-A, PRIMARY: 7200/12470Y SECONDARY: 120/240 SIZE: 25 KVA TAPS: NO TAPS LEGACY TYPEKEY: 01110302 NOTE: NEW TRANSFORMERS PURCHASED TO CONFORM TO WESTAR SPECIFICATION 1P-OH XFMR, LATEST REVISION | 2 | 1606.96 | 0.00 | 0.00 | 0.00 | 0.00 | 1606.96 |
| | INSTALL | Stores Overhead | 0 | 0.00 | 0.00 | 0.00 | 0.00 | 192.84 | 192.84 |
| 5930000 | | O/H CONDUCT & DEVICE | 0 | 0.00 | 780.00 | 0.00 | 663.00 | 0.00 | 1443.00 |
| | | | 0 | 78689.08 | 0.00 | 0.00 | 0.00 | 0.00 | 78689.08 |
| | | SUBTOTAL | 0 | 124461.46 | 395252.00 | 15000.00 | 335964.20 | 386.44 | 871064.12 |
| | | CUSTOMER CONTRIBUTION | 0 | 0.00 | 0.00 | 0.00 | 0.00 | 0.00 | 0.00 |
| | | GRAND TOTAL | 0 | 124461.46 | 395252.00 | 15000.00 | 335964.20 | 386.44 | 871064.12 |



12/18/2019

Lyon-Coffey Electric Cooperative, Inc.
2501 W. 18th Ave # B
Emporia, KS 66801

To Whom It May Concern:

This is to advise you that Evergy is filing an "EL" application with the State Corporation Commission in accordance with the provisions of Kansas Administrative Regulations, article number 12, 82-12-1 thru 82-12-9, effective August 11, 1995, State Of Kansas for approval of plan, specifications, and location of an Electric Power Line.

Your companies facilities may be involved directly with our proposed "Electric Power Facilities" or your company is being notified because your facilities are within one-half (1/2) mile of the proposed Electric Line.

The attached sketch shows the location of our proposed Electric Power Line and your facilities. If there are any questions you may have concerning this Electric Power Line, or any problem regarding coordination of your facilities, we will be very glad to discuss the matter with you.

Please Notify Kansas Corporation Commission, Utilities Division, 1500 SW Arrowhead Road, Topeka, KS 66604-4027 and us of any objection that you may have to this proposed Electric Power Line within 10 days (Railroad 15).

Any questions concerning this application, please contact Miriam R Nickle +1 (785) 587-2317 at our Manhattan Service Center office, or Scott Pfeiffer - 785-575-6019 at our general office.

Sincerely,

Scott Pfeiffer

Attachment's

IDENTIFICATION INFORMATION

Application Sketch No 31889, Work Request No M100748500 Section

(s) 11,12,3,14 07,18 T19S T19S R14E R15E located in Coffey County, Kansas

THE OPERATING CHARACTERISTICS OF THIS POWER LINE ARE TO BE:

12,470 Volts, 3 Phase, 4 Wires.

PHYSICAL PROPERTIES OF ELECTRIC LINE:

Poles - Kind N/A, Height N/A, Class N/A, Conductor - Size 1/0, Kind ACSR



12/18/2019

Sprint/Embarq Telephone
Gerry Jones
138 W 6th St.
Junction City, KS 664412939

To Whom It May Concern:

This is to advise you that Evergy is filing an "EL" application with the State Corporation Commission in accordance with the provisions of Kansas Administrative Regulations, article number 12, 82-12-1 thru 82-12-9, effective August 11, 1995, State Of Kansas for approval of plan, specifications, and location of an Electric Power Line.

Your companies facilities may be involved directly with our proposed "Electric Power Facilities" or your company is being notified because your facilities are within one-half (1/2) mile of the proposed Electric Line.

The attached sketch shows the location of our proposed Electric Power Line and your facilities. If there are any questions you may have concerning this Electric Power Line, or any problem regarding coordination of your facilities, we will be very glad to discuss the matter with you.

Please Notify Kansas Corporation Commission, Utilities Division, 1500 SW Arrowhead Road, Topeka, KS 66604-4027 and us of any objection that you may have to this proposed Electric Power Line within 10 days (Railroad 15).

Any questions concerning this application, please contact Miriam R Nickle +1 (785) 587-2317 at our Manhattan Service Center office, or Scott Pfeiffer - 785-575-6019 at our general office.

Sincerely,

Scott Pfeiffer

Attachment's
IDENTIFICATION INFORMATION
Application Sketch No 31889, Work Request No M100748500 Section
(s) 11,12,3,14 07,18 T19S T19S R14E R15E located in Coffey County, Kansas

THE OPERATING CHARACTERISTICS OF THIS POWER LINE ARE TO BE:
12,470 Volts, 3 Phase, 4 Wires.

PHYSICAL PROPERTIES OF ELECTRIC LINE:
Poles - Kind N/A, Height N/A , Class N/A , Conductor - Size 1/0 , Kind ACSR



12/18/2019

Coffey County RWD#3
235 North Main
New Strawn, KS 66839

To Whom It May Concern:

This is to advise you that Evergy is filing an "EL" application with the State Corporation Commission in accordance with the provisions of Kansas Administrative Regulations, article number 12, 82-12-1 thru 82-12-9, effective August 11, 1995, State Of Kansas for approval of plan, specifications, and location of an Electric Power Line.

Your companies facilities may be involved directly with our proposed "Electric Power Facilities" or your company is being notified because your facilities are within one-half (1/2) mile of the proposed Electric Line.

The attached sketch shows the location of our proposed Electric Power Line and your facilities. If there are any questions you may have concerning this Electric Power Line, or any problem regarding coordination of your facilities, we will be very glad to discuss the matter with you.

Please Notify Kansas Corporation Commission, Utilities Division, 1500 SW Arrowhead Road, Topeka, KS 66604-4027 and us of any objection that you may have to this proposed Electric Power Line within 10 days (Railroad 15).

Any questions concerning this application, please contact Miriam R Nickle +1 (785) 587-2317 at our Manhattan Service Center office, or Scott Pfeiffer - 785-575-6019 at our general office.

Sincerely,



Scott Pfeiffer

Attachment's

IDENTIFICATION INFORMATION

Application Sketch No 31889, Work Request No M100748500 Section
(s) 11,12,3,14 07,18 T19S T19S R14E R15E located in Coffey County, Kansas

THE OPERATING CHARACTERISTICS OF THIS POWER LINE ARE TO BE:
12,470 Volts, 3 Phase, 4 Wires.

PHYSICAL PROPERTIES OF ELECTRIC LINE:

Poles - Kind N/A, Height N/A , Class N/A , Conductor - Size 1/0 , Kind ACSR

Form No. 604-1A
Rev. (8/93)

S.C.C. FORM "EL" Application Sketch

List all public utilities (electric, pipe, railroads, & other facilities) within ½ mile of proposed line

| Code | Ownership | Length | OH/UG | #Wires | Kind | Size | Phase | Neut/Shld | Grounded/ Ungrounded | Oper. Volts |
|---------------|--------------------|---------|-------|--------|------|------|-------|-----------|-------------------------|----------------|
| A B _____ | Evergy Proposed | 10,560' | OH | 4 | ACSR | 1/0 | 3 | 1/0 ACSR | Grounded | 12,470kV |
| C D XXXXXX | Evergy Removal | 10,560' | OH | 2 | ACSR | 2 | 1 | 2 ACSR | Grounded | 7,200kV |
| XXXXXX | Evergy Removal | | | | | | | | Grounded | 7,200kV |
| _____ | Evergy Proposed | | | | | | | | Grounded | 7,200kV |
| XXXXXX | Evergy Removal | | | | | | | | Grounded | 7,200kV |
| _____ | Evergy Proposed | | | | | | | | Grounded | 12,470kV |
| _____ | Evergy Proposed | | | | | | | | Grounded | 12,470kV |
| _____ | Evergy Proposed | | | | | | | | Grounded | 12,470kV |
| _____ | Evergy Proposed | | | | | | | | Grounded | 12,470kV |

Lyon-Coffey Electric Coop
Sprint/Embarq Telephone
Coffey County RWD# 3

Evergy proposes to build a new 3-phase overhead primary line and remove an old single phase overhead primary line in Coffey County. The removal will be along the south side of old Hwy 50 from the east side of Garner Rd to the east side Iris Rd. The new install we be along the north side of old Hwy 50 from the east side Garner Rd to the east side of Iris Rd to improve reliability. The new install we be approximately 2 miles. This will be worked with (M100748156) Sub Transmission job.

T19S R14E Sec. 11, 12, 13, 14

T19S R15E Sec. 07, 18

Work Request# M100748500
Application Sketch# 31889
Miriam Nickle

SCC FORM "EL" APPLICATION SKETCH

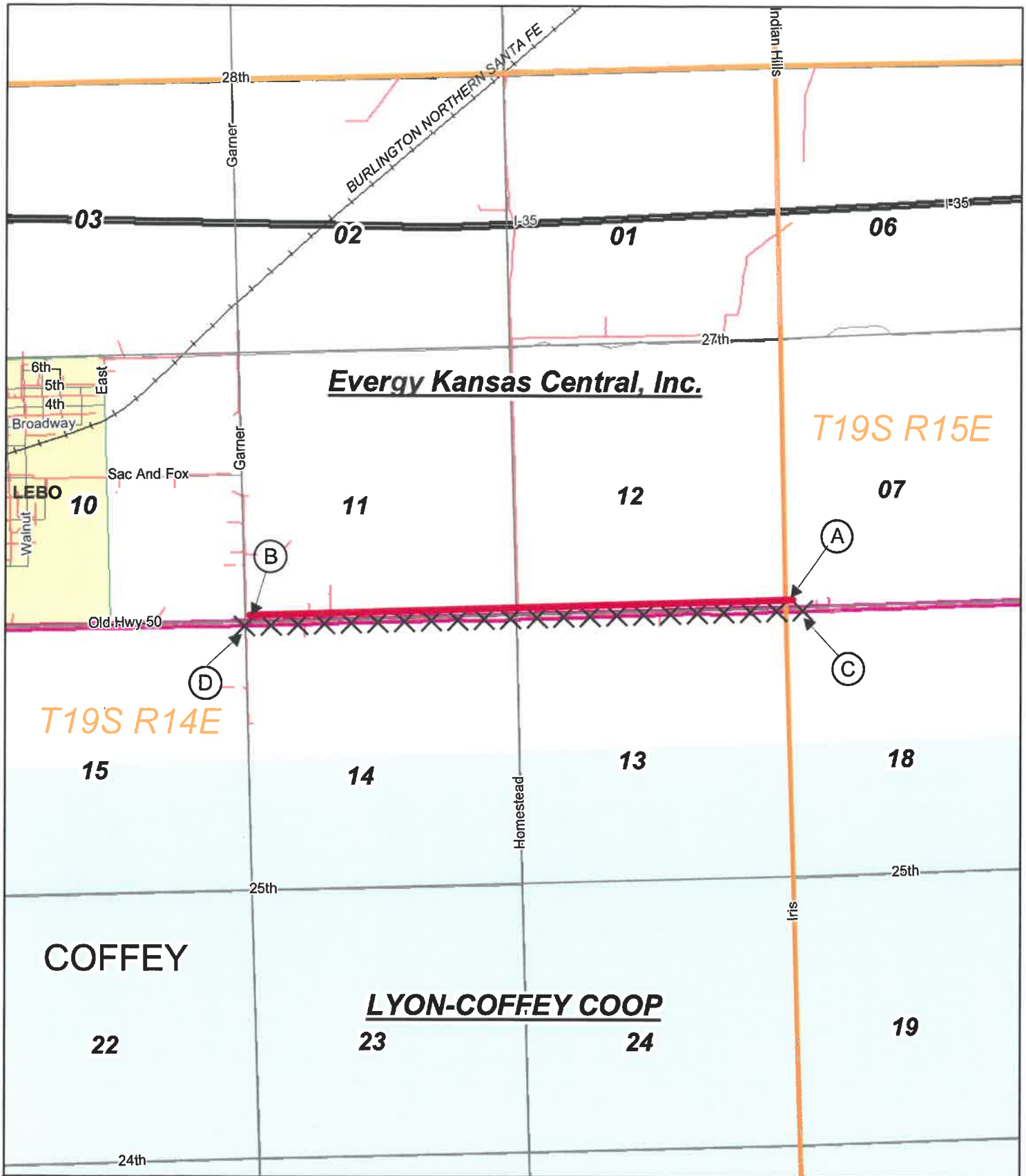

Think Safety!



Removal & Installation of Overhead Primary.

BY Miriam Nickle

WR # M100748500

Crew HQ 2401

Date 12/18/2019

Scale 1" = 2,640'

Page 1

Proposed

Application Number 31889