

FORM CO
BEFORE THE STATE CORPORATION COMMISSION OF THE STATE OF KANSAS

IN THE MATTER OF THE APPLICATION OF

City of Garnett

for permission to CEASE OPERATING as a(n) Electric

(Tel., Gas, Elec. etc.)

Public Utility in the State of Kansas.

(Common carrier or public utility)

parcel# 087-36-0-00-00-014.000, City of Garnett

DOCKET NO.

26-GARE-127-CCS

APPLICATION TO CEASE OPERATION

Comes now City of Garnett and respectfully

represents to the Commission that they operate(s) a(n) Electric Public Utility
(it, they) (Tel., Gas, Elect., Etc.) (Common carrier or public utility)

in Kansas under authority of a Certificate granted to them on _____ 200____ in Docket
(it, them)
Number _____ (if operating prior to 1911, please so state).

1. Said applicant desires and herein seeks the approval of the Commission to cease operating as a(n)

Electric Public Utility in the following described territory:
(Tel., Gas, Elect., Etc.) (Common carrier or public utility)

The City of Garnette and the landowner requests that 4 Rivers Electric Cooperative, Inc. be given authority to serve the below described area from an existing utility line adjacent to the above mentioned parcel.

The area measures 250 Feet in width, being 125 Feet on each side of the following described line. Commencing at S41°31'58.227"W a distance of 170 Feet, more or less, to the POINT OF BEGINNING from EXISTING ELECTRIC POLE at approximately 38°16'11.980"N, 95°15'12.322"W, thence N88°43'6.314"E a distance of 1205 Feet, more or less, thus to the end point.

The above described is for Application to Cease Operation to an area approximately 250ft x 1205ft, more or less.

2. That attached hereto and marked "Exhibit A" is a detail map showing the above-described territory.

3. That simultaneously herewith, 4 Rivers Electric Cooperative, Inc., has filed an application for a Certificate of
(corporation, partnership, individual)

Convenience and Authority to serve the above-described territory.

4. That applicant further states:

The City of Garnett has no electric power line facilities in the immediate area, and that they request to transfer the above mentioned service territory to 4 Rivers Electric Cooperative, Inc. in order to serve electric power to the land owner/owners from an existing electric power line currently situated adjacent to the above mentioned area.

WHEREFORE, Applicant requests permission to cease operating as a(n) Electric
(Tel., Gas, Elec., etc.)

Public Utility in the above-described territory upon completion of the transfer of its physical property therein.
(Common carrier or public utility)

City of Garnett
Applicant

By Travis Wilson

STATE OF KANSAS)
Anderson) ss. COUNTY,)

City of Garnett, Travis Wilson, of lawful age, being duly sworn deposes and
says that he is the City Manager of the above-named, that he has read the above and
foregoing application and knows the contents thereof, and that the matters and information therein stated are true.

SUBSCRIBED AND SWORN to before me this 30th day of September, 2025

Patricia Brewer
Notary Public.

My Commission Expires 3-15-2027

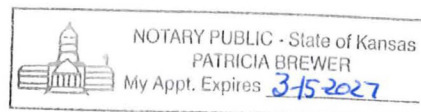

TROYER TERRITORY EXCHANGE

WO#:
TROYER
TERRITORY

CITY OF GARNETT

T20S, R19E, Anderson County, Section 36:

Bearing and distances are approximated based
on GPS data gathered and projected into
NAD_1983_StatePlane_Kansas_South_FIPS_1502_Feet

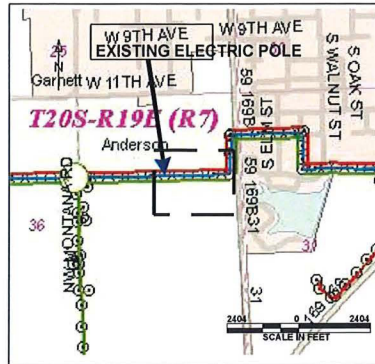

An area 250 Feet in width,
being 125 Feet on each side of the
following described line. Commencing
at S41°31'58.227\"W a distance of
170 Feet, more or less, to the POINT
OF BEGINNING from EXISTING
ELECTRIC POLE at approximately
38°16'11.980\"N, 95°15'12.322\"W, thence
N88°43'6.314\"E a distance of 1205 Feet,
more or less, thus to the end point.

The above described is for
Certificate of Convenience and Authority
extending over an area approximately
250ft x 1205ft, more or less.

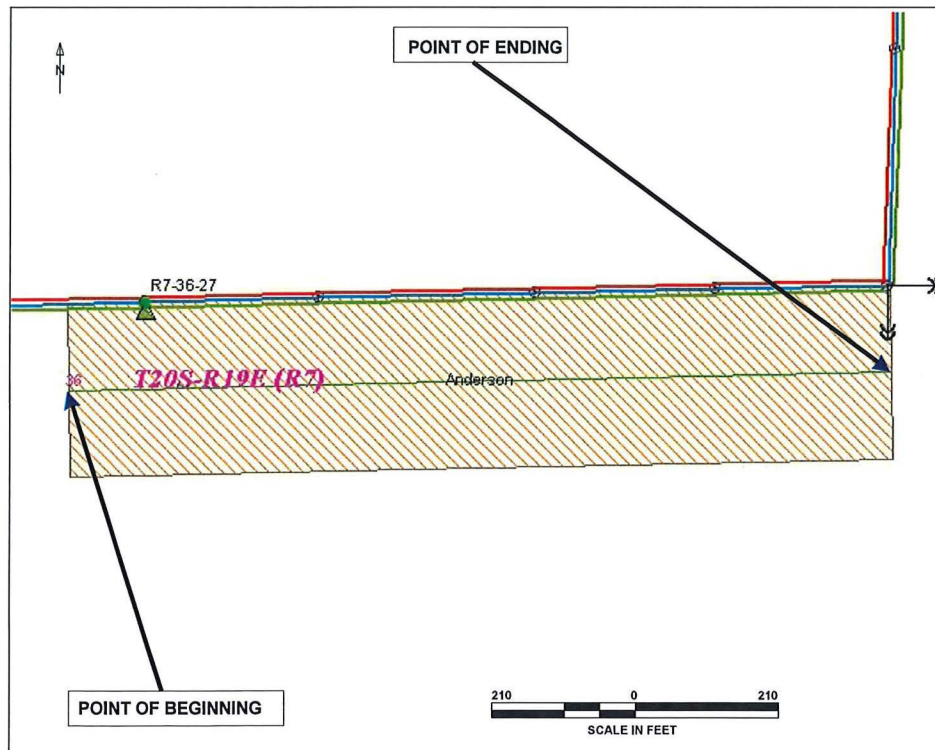

WO#:
TROYER
TERRITORY

T20S, R19E, Anderson County, Section 36:

W 11th Ave

S Oak St

S Walnut St

S 1st St

S 2nd St

S 3rd St

S 4th St

S 5th St

S 6th St

S 7th St

S 8th St

S 9th St

S 10th St

S 11th St

S 12th St

S 13th St

S 14th St

S 15th St

S 16th St

S 17th St

S 18th St

S 19th St

S 20th St

S 21st St

S 22nd St

S 23rd St

S 24th St

S 25th St

S 26th St

S 27th St

S 28th St

S 29th St

S 30th St

S 31st St

S 32nd St

S 33rd St

S 34th St

S 35th St

S 36th St

S 37th St

S 38th St

S 39th St

S 40th St

S 41st St

S 42nd St

S 43rd St

S 44th St

S 45th St

S 46th St

S 47th St

S 48th St

S 49th St

S 50th St

S 51st St

S 52nd St

S 53rd St

S 54th St

S 55th St

S 56th St

S 57th St

S 58th St

S 59th St

S 60th St

S 61st St

S 62nd St

S 63rd St

S 64th St

S 65th St

S 66th St

S 67th St

S 68th St

S 69th St

S 70th St

S 71st St

S 72nd St

S 73rd St

S 74th St

S 75th St

S 76th St

S 77th St

S 78th St

S 79th St

S 80th St

S 81st St

S 82nd St

S 83rd St

S 84th St

S 85th St

S 86th St

S 87th St

S 88th St

S 89th St

S 90th St

S 91st St

S 92nd St

S 93rd St

S 94th St

S 95th St

S 96th St

S 97th St

S 98th St

S 99th St

S 100th St

North Oak Station

Source: Esri, Mapbox, Earthstar Geography, and the City of Denver

0 200 FEET

The above described is for
Certificate of Convenience and Authority
extending over an area approximately
250ft x 1205ft, more or less.

